

# **Indicator Light Module**

**for Yard Tractor**

**Part No. 92-6831**

**Part No 92-6897**

---

## **Installation Instructions**

## Loose Parts

The Indicator Light Module Kit includes:

- Indicator Light Module
- Lens
- Lens Decal (1 or 2)

## Prepare the Tractor

1. On a level surface, stop the tractor, shift into neutral, set the parking brake, and shut the engine off.
2. Open the hood.
3. Disconnect the negative (-) cable from the battery to prevent an electrical short.

## Remove the Solenoid Plate

1. Loosen two lock nuts and carriage bolts retaining solenoid plate to the top of the dash (Fig. 1).
2. Remove two lock nuts and carriage bolts securing bottom of the solenoid plate (Fig. 1).

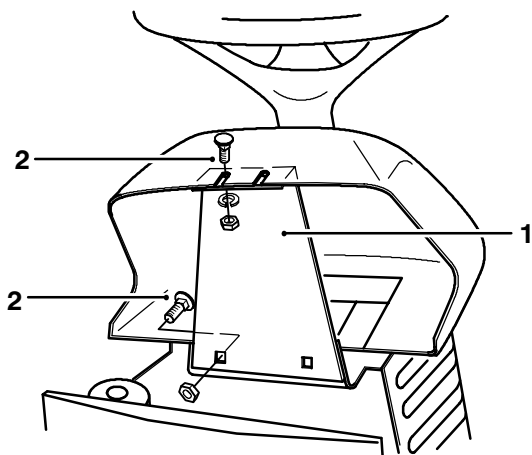

Figure 1

- 1 Solenoid plate      2 Carriage bolts and lock nuts

1386

## Remove Original Dash Insert

1. Disconnect connectors from the hour meter mounted on the tractor (Fig. 2).
2. Remove three Phillips screws securing original dash insert and lens (Fig. 2). Slide the insert and lens out of the dash.

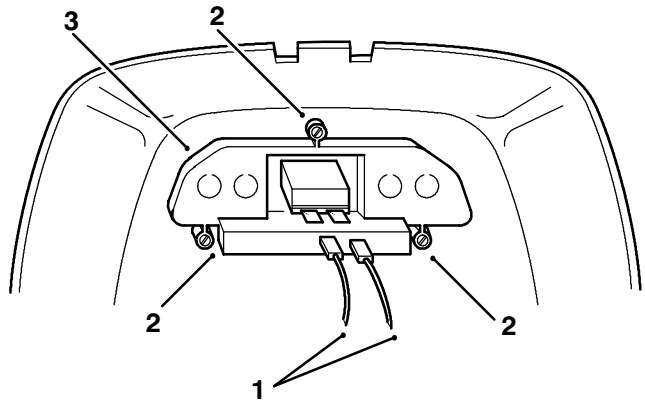

Figure 2

- 1 Hour meter connectors      3 Dash insert and lens  
2 Phillips screws

1387

3. If an hour meter was previously mounted in the original dash insert, remove it now.
  - A. Hold the dash insert face down.
  - B. Using your thumbs, pull out on the locking tabs and push the hour meter out of the dash insert (Fig. 3).

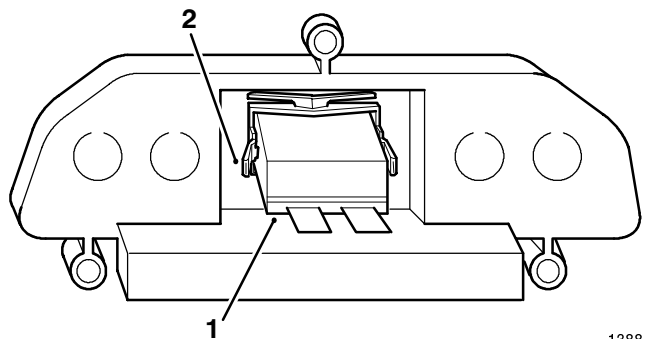

Figure 3

- 1 Hour meter      2 Locking tabs

1388

## Install Indicator Light Module

1. If the tractor was originally equipped with an hour meter, install it in the new indicator light module using the retaining bracket (Fig. 3). Otherwise, go to step 2.
  - A. Slide the hour meter into the module, making sure the meter is right side up.
  - B. Push the retaining bracket completely onto the back of the hour meter until it is locked in place.
2. Install appropriate decal onto the flat side of new lens (Fig. 4).
3. Place the lens onto the indicator light module. Insert the module and lens assembly into the opening in the dash and secure in place with three Phillips screws (Fig. 4).

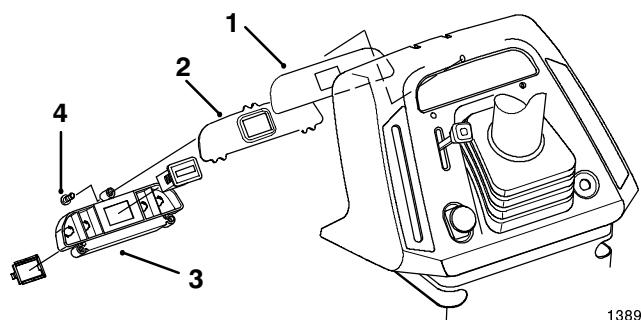

Figure 4

- |         |                   |
|---------|-------------------|
| 1 Decal | 3 Module          |
| 2 Lens  | 4 Phillips screws |

4. Push together the indicator light wire connector and the mating connector in the tractor wire harness (Fig. 5). If the tractor was equipped with an hour meter, push both wire connectors onto the terminals of the hour meter.

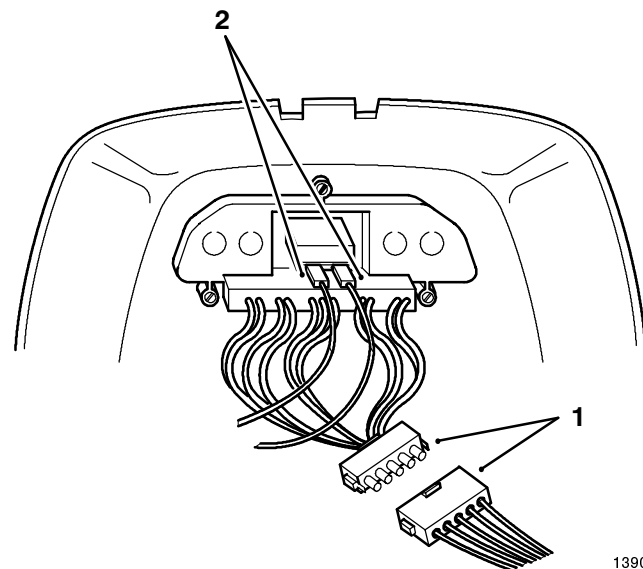

Figure 5

- |                              |                         |
|------------------------------|-------------------------|
| 1 Indicator light connectors | 2 Hour meter connectors |
|------------------------------|-------------------------|

## Install the Solenoid Plate

1. Mount the solenoid plate to the dash and steering tower with the four carriage bolts and lock nuts.
2. Connect the negative (-) cable to the battery.
3. Close the hood.

## Check Indicator Lights

Check the indicator lights to assure they come on and shut off when required. The engine will only start when the PTO control is OFF and the parking brake is engaged with the lever.

1. Turn the ignition key to “LIGHTS” or “RUN” position, engage the parking brake with the lever and pull the PTO control out to the “ON” position. Check the lights.
  - A. Parking Brake Light - must be on
  - B. PTO Light - must be on
  - C. Oil Light - must be on
  - D. Battery Light - must be on.
  - E. Hour Meter - must be operating.

2. Push the PTO control to the “OFF” position and engage the parking brake with the lever. Start the engine and run it at maximum speed. While parked on a level surface, disengage the parking brake and check the lights.

- A. Parking Brake Light - must be off
- B. PTO Light - must be off
- C. Oil Light - must be off

**IMPORTANT: If the oil light comes on when the engine is running, shut the engine off immediately because oil pressure is low (below a safe level). Make all necessary repairs before resuming operation.**

- D. Battery Light - must be off

**IMPORTANT: If the battery light comes on when the engine is running at maximum speed, shut the engine off because there is a problem with the charging system or the battery. Make all necessary repairs before resuming operation. When the engine idles, the battery light may come on if the battery is only partially charged.**

- E. Hour Meter - must be operating