



# Cutter-Motor Drain-Line Kit for T4240 4-Wheel Drive 5-Plex 5 Mower Traction Unit

Model No. 111-8082

## Installation Instructions

This kit reroutes the cutter-motor drain-line directly back to the tank to prepare for potential cutter motor replacements.

Before installing this kit, refer to your machine's *Operator's Manual* for safety instructions and the product overview.

**Important:** If after reading these instructions you are still unsure of how to install this kit, contact your Authorized Toro Dealer for help.

## Installation

### Loose Parts

Use the chart below to verify that all parts have been shipped.

| Description                  | Qty. | Use              |
|------------------------------|------|------------------|
| Blanking cap                 | 3    | Install the kit. |
| 1/4 inch to 3/8 inch adaptor | 1    |                  |
| 1/4 inch cross adaptor       | 1    |                  |
| 3/8 inch hose                | 1    |                  |
| Cable tie                    | 3    |                  |
| 3/8 inch tee adaptor         | 1    |                  |

1. Lower the cutting units, stop the engine, remove the key, and ensure that there is no remaining pressure in the hydraulic circuit.
2. Raise and support the operator's platform.
3. Disconnect the center, right, and left 1/4 inch cutter-motor hoses from the bottom of the return manifold ([Figure 1](#)).

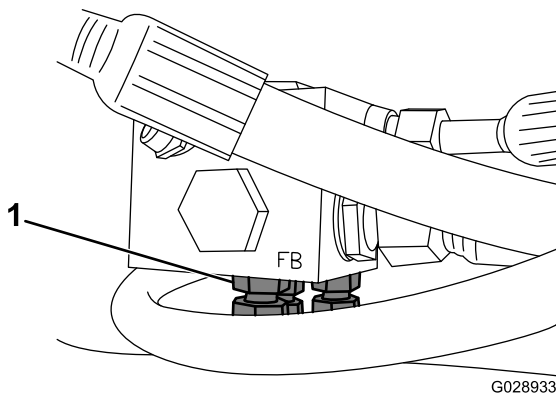
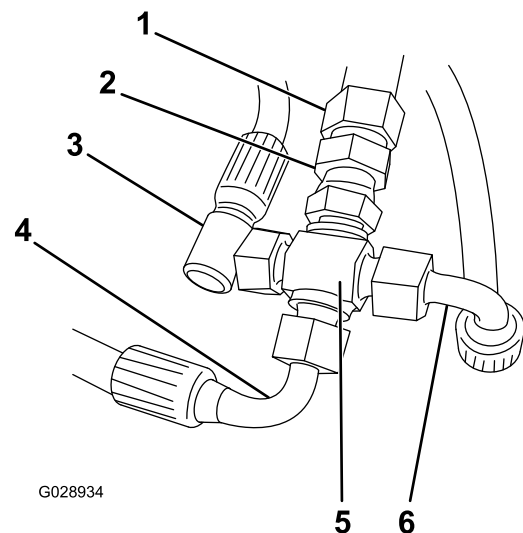

**Figure 1**

1. 1/4 inch cutter motor hoses

4. Insert 3 blanking caps into the openings in the return manifold.

5. Connect the 1/4 inch to 3/8 inch adaptor to the 1/4 inch cross adaptor ([Figure 2](#)).



**Figure 2**

1. New 3/8 inch hose
2. 1/4 to 3/8 inch adaptor
3. Center motor hose
4. Left wing motor hose
5. 1/4 inch cross adaptor
6. Right wing motor hose

6. Connect the new 3/8 inch hose to the adaptor ([Figure 2](#)).



7. Connect the hoses removed in step 3 to the cross adaptor as shown in Figure 2.

**Note:** The center cutter-motor hose should be routed forward over the 2 hoses (1/2 inch) for the center motor.

8. Ensure that the left and right wing motor hoses are flush to the chassis cross member, and secure the cross adaptor and hoses to the frame using 3 cable ties (Figure 3).

**Note:** Ensure that the lower hose is clear of the center head.

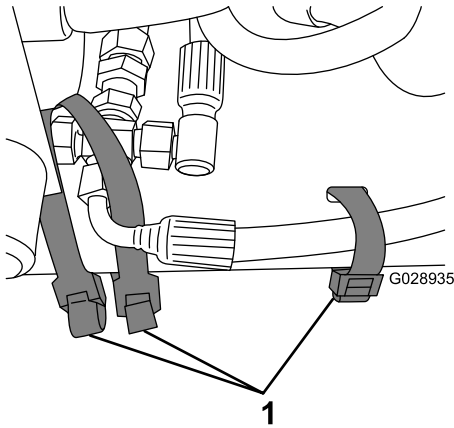

**Figure 3**

1. Cable ties

---

9. Disconnect the 3/8 inch hose from the top left of the oil tank.
10. Attach the 3/8 inch tee adaptor to the tank.
11. Attach the previously removed hose to the top of the tee adaptor.
12. Route and attach the new hose from step 6 to the tee adaptor.
13. Run the machine to check for any leaks.