



Rear Discharge Kit

Heavy-Duty Recycler®/Rear Bagger Lawn Mowers

Model No. 130-9734

Installation Instructions

Save these instructions with the *Operator's Manual* for your machine.

⚠ WARNING

CALIFORNIA Proposition 65 Warning

This product contains a chemical or chemicals known to the State of California to cause cancer, birth defects, or reproductive harm.

Installing the Rear-Discharge Deflector

⚠ WARNING

The blades are sharp; contacting the blades can result in serious personal injury.

Stop the engine and wait for all moving parts to stop before leaving the operating position.

⚠ WARNING

An uncovered discharge opening will allow objects to be thrown at you or bystanders. Also, contact with the blade could occur. Thrown objects or blade contact can cause serious injury or death.

Never operate the machine without the rear-discharge deflector or rear-discharge plug in place and working properly.

1. Stop the engine and wait for all moving parts to stop.
2. Raise and hold up the rear door (Figure 1).

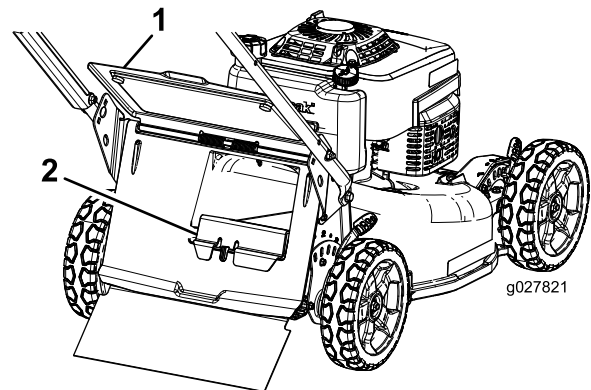

Figure 1

1. Rear door
2. Rear-discharge plug

Note: If the rear-discharge plug is installed in the opening, remove it (Figure 1).

3. Install the rear-discharge deflector (Figure 2).

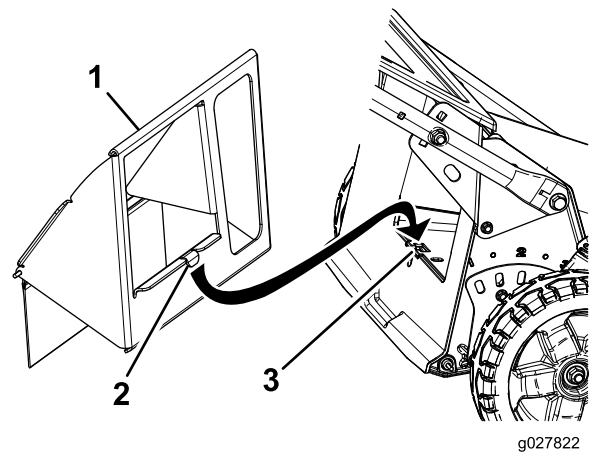

Figure 2

1. Rear-discharge deflector
2. Tab
3. Slot in the bottom of the opening



Note: Insert the tab of the rear-discharge deflector into the slot in the bottom of the opening (Figure 2).

4. Lower the rear door onto the rear-discharge deflector.
5. Inspect the installation to ensure that the rear deflector is properly installed as shown in Figure 3.

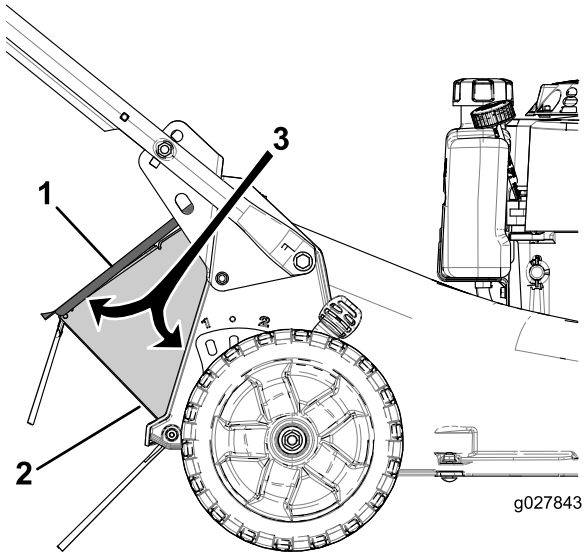

Figure 3

1. Rear door
2. Rear deflector
3. Ensure that there are no gaps here.

Removing the Rear-Discharge Deflector

To remove the rear-discharge deflector, reverse the steps in Installing the Rear-Discharge Deflector.