



Seat Kit

TITAN® Zero-Turn-Radius Riding Mower

Model No. 130-0788

Installation Instructions

⚠ WARNING

CALIFORNIA Proposition 65 Warning

This product contains a chemical or chemicals known to the State of California to cause cancer, birth defects, or reproductive harm.

Installation

Loose Parts

Use the chart below to verify that all parts have been shipped.

Procedure	Description	Qty.	Use
1	No parts required	–	Remove the seat and the seat belt.
2	Seat Seat support Bolt (thread forming) (1/4 x 1/2 inch) Flange nut (3/8 inch) Seat latch Shoulder bolt (3/8 x 1-1/8 inch) Spring	1 1 2 2 1 2 1	Install the seat.
3	No parts required	–	Test the safety interlock system.

1

Removing the Seat and the Seat Belt

No Parts Required

Procedure

1. Tilt the seat up.
2. Unplug the harness connector from the seat switch located under the seat (Figure 1).



2

Installing the Seat

Parts needed for this procedure:

1	Seat
1	Seat support
2	Bolt (thread forming) (1/4 x 1/2 inch)
2	Flange nut (3/8 inch)
1	Seat latch
2	Shoulder bolt (3/8 x 1-1/8 inch)
1	Spring

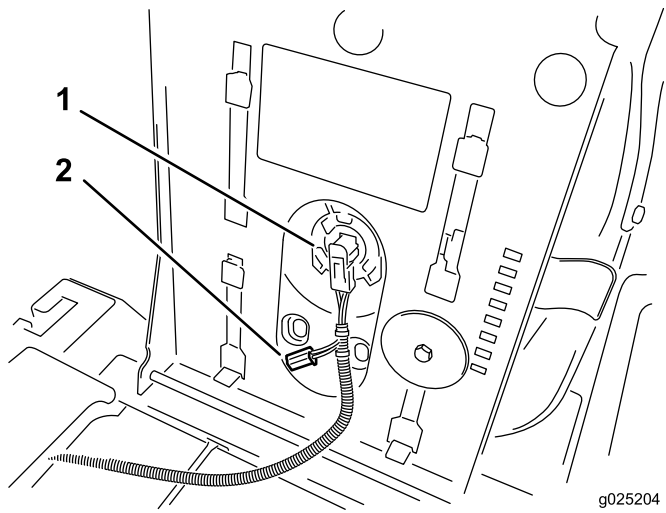

Figure 1

- Existing seat switch
- Use this connector for the new seat switch

- At the seat pivot, remove the hairpin cotter pins and rod at the seat hinge. Retain the hairpin cotter pins and rod for installing the new seat.
- Remove the seat from the machine.
- Remove the 3 springs from the machine frame (Figure 2).
- Remove the existing seat-belt receiver and retractor from the brackets (Figure 2).

Note: Do not remove the brackets. Remove only the seat-belt receiver and retractor.

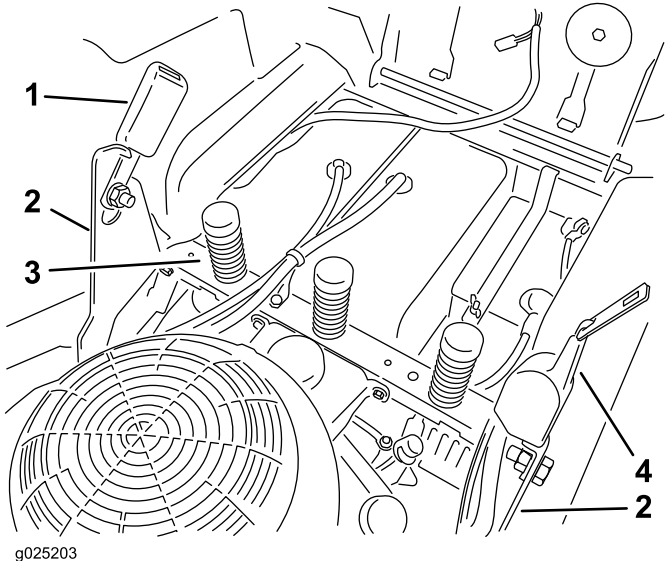

Figure 2

- Remove the existing seat-belt receiver
- Bracket
- Remove the springs from the frame
- Remove the existing seat-belt retractor

Procedure

- Install the seat latch and spring onto the seat with 2 shoulder bolts (3/8 x 1-1/8 inch) and 2 flange nuts (3/8 inch) (Figure 3).
- Torque the shoulder bolts to 36.6 to 44.7 N-m (27 to 33 ft-lbs).

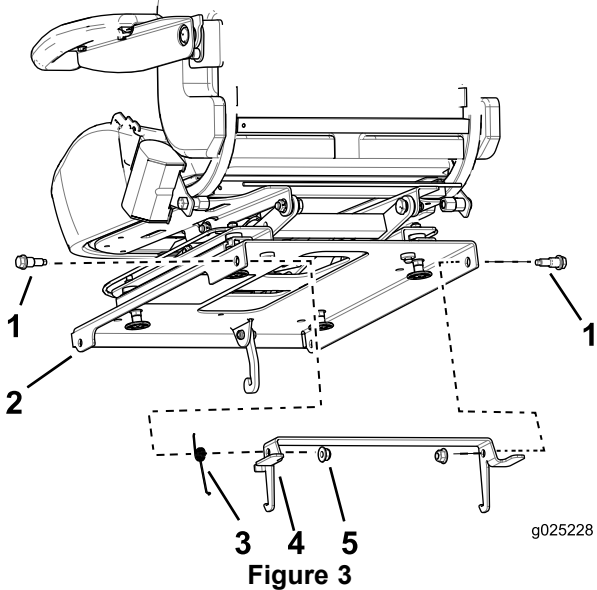

Figure 3

- Shoulder bolt (3/8 x 1-1/8 inch)
- Seat
- Spring
- Seat latch
- Flange nut (3/8 inch)

- Move the long end of the spring around the back of the latch (Figure 4).

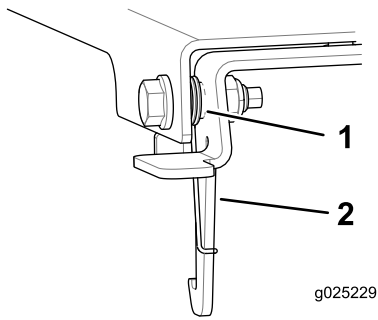

Figure 4

1. Spring installed 2. Seat latch

-
4. Install the seat support to the frame of the machine with 2 thread-forming bolts (1/4 x 1/2 inch) (Figure 5).
 5. Torque the thread-forming bolts to 5.2 to 6.8 N-m (46 to 60 in-lbs).
 6. At the seat pivot, install the seat to the hinge with the previously removed hairpin cotter pins and rod.

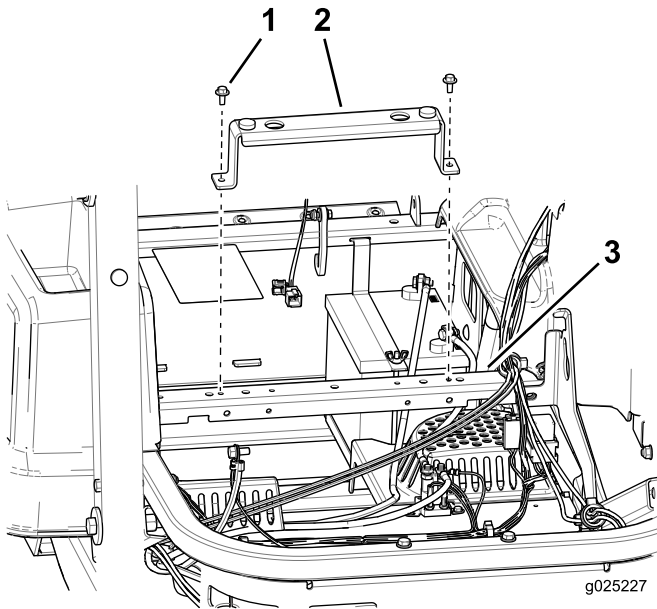

Figure 5

1. Thread-forming bolt (1/4 x 1/2 inch) 3. Frame
2. Seat support

-
7. Using the connector previously not used in the harness, plug the connector into the seat switch located under the seat (Figure 1).

3

Testing the Safety Interlock System

No Parts Required

Procedure

⚠ CAUTION

If safety interlock switches are disconnected or damaged the machine could operate unexpectedly causing personal injury.

- Do not tamper with the interlock switches.
- Check the operation of the interlock switches daily and replace any damaged switches before operating the machine.

Test the safety interlock system before you use the machine each time. If the safety system does not operate as described below, have an Authorized Service Dealer repair the safety system immediately.

1. While sitting on the seat, engage the parking brake and move the blade control switch to On. Try starting the engine; the engine should not crank.
2. While sitting on the seat, engage the parking brake and move the blade control switch to Off. Move either motion control lever (forward or reverse). Try starting the engine; the engine should not crank. Repeat with the other motion control lever.
3. While sitting on the seat, engage the parking brake, move the blade control switch to Off, and lock the motion control levers in neutral. Start the engine. While the engine is running, release the parking brake, engage the blade control switch, and rise slightly from the seat; the engine should stop.
4. While sitting on the seat, engage the parking brake, move the blade control switch to Off, and lock the motion control levers in neutral. Start the engine. While the engine is running, center the motion controls; the engine should stop.

Operation

Positioning the Seat

The seat can move forward and backward. Position the seat where you have the best control of the machine and are most comfortable.

To adjust, move the lever sideways to unlock seat (Figure 6).

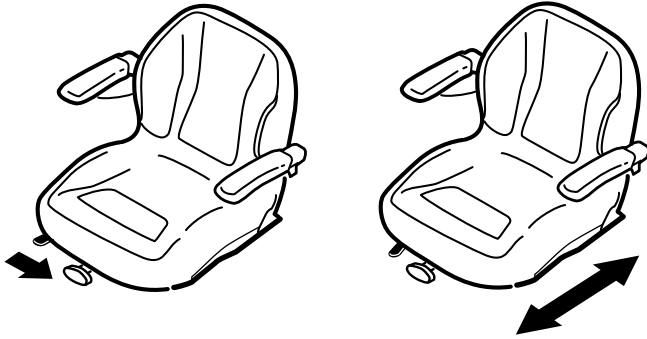

Figure 6

g024881

Changing the Seat Suspension

The seat is adjustable to provide a smooth and comfortable ride. Position the seat where you are most comfortable.

To adjust it, turn the knob in front either direction to provide the best comfort (Figure 7).

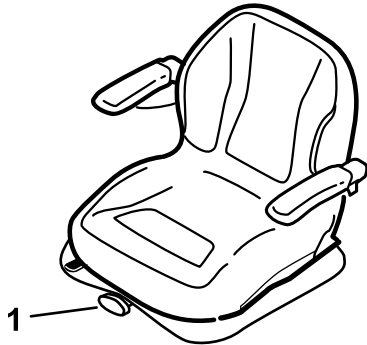

Figure 7