



# Z Master® Professional Series Riding Mower

Model No. 74942—Serial No. 314000001 and Up

Model No. 74942TE—Serial No. 314000001 and Up

Model No. 74944—Serial No. 314000001 and Up

Addendum

## Setup

### Loose Parts

Use the chart below to verify that all parts have been shipped.

Procedure	Description	Qty.	Use
1	Skid	1	Install the right-hand skid.
	Carriage bolt (3/8-16 x 2-1/4 inches)	3	
	Nyloc nut (3/8 inch)	3	

# 1

## Installing the Right-hand Skid

### Parts needed for this procedure:

1	Skid
3	Carriage bolt (3/8-16 x 2-1/4 inches)
3	Nyloc nut (3/8 inch)

### Procedure

Mount the skid in the lower position when operating in height of cuts higher than 64 mm (2-1/2 inches) and in the higher position when operating in height of cuts lower than 64 mm (2-1/2 inches).

1. Raise the deck to the 14 cm (5-1/2 inches) height-of-cut position (also known as the transport position).
2. Remove and discard the zip ties from the right-hand skid.
3. Move the skid to the desired position and secure it with 3 carriage bolts (3/8-16 x 2-1/4 inches) and 3 nyloc nuts (3/8 inch) as shown in Figure 1.
4. To prevent damaging the skid, torque the carriage bolts and nuts for the skid to 12.4 to 14.7 N-m (110 to 130 in-lb).

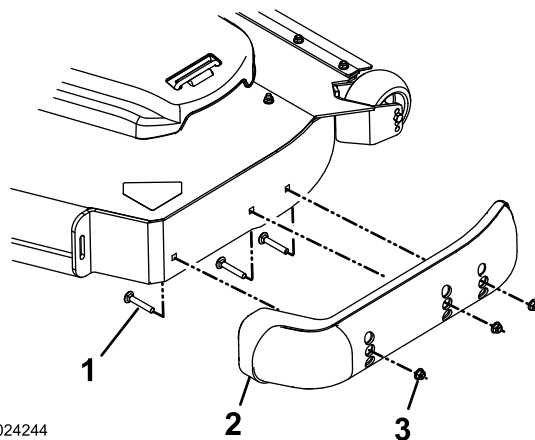

g024244

Figure 1

1. Carriage bolt
2. Skid
3. Nyloc nut

