



RECYCLER[®] KIT

for 42" Rear Discharge GT & ZRT Mowers

Model No. 86001

**INSTALLATION
INSTRUCTIONS**

Loose Parts

Note: Use the chart below to identify parts used for assembly.

| DESCRIPTION | QTY. | USE |
|------------------------------|------|----------------------------------|
| Baffle | 1 | |
| Bolt 3/8-16 x 1-1/4" (32 mm) | 2 | Install under mower |
| Locknut 5/16" | 4 | |
| Recycler [®] blade | 3 | Replace standard blades on mower |
| Decal | 2 | Install on sides of mower |

Installing the Recycler[®] Baffle

1. Remove mower from traction unit; see traction unit Operator's Manual for instructions.
2. Thoroughly clean the mower. All debris must be removed to ensure baffle fits tightly against mower.
3. Repair any dents or damaged areas on the mower. Replace any missing parts.
4. Remove the front bolt from each of four (4) linkage brackets (Fig. 1).
5. Tip mower upside down and remove standard blades from spindles.

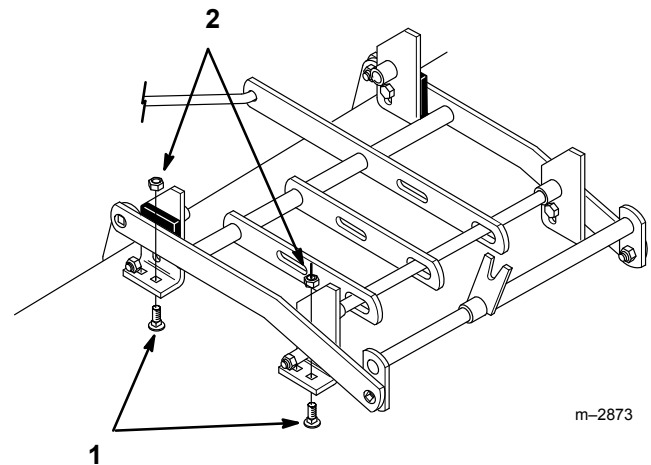

m-2873

Figure 1

1. Bolt 3/8-16 x 1-1/4"
(32 mm)

2. Lock nut 3/8"

6. Place baffle inside mower location two (2) studs on baffle, into front linkage bracket holes (Fig. 2).
7. Place (2) 3/8 x 1-1/4" (32 mm) carriage bolts through rear linkage bracket holes. Secure carriage bolts and studs with (4) 3/8" locknuts (Fig. 2).
8. Tighten all mounting hardware securely.

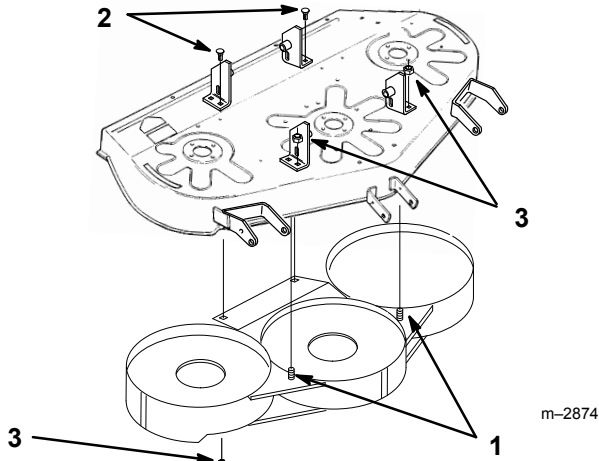

Figure 2

1. Stud
2. Bolt 3/8-16 x 1-1/4" (32 mm)
3. Lock nut 3/8"

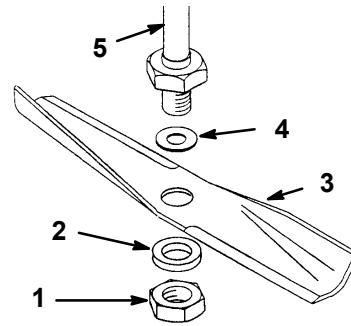

Figure 3

1. Nut
2. Flat washer – thick
3. Blade
4. Washer – thin
5. Spindle

Install Recycler® Decal

1. Remove backing paper and apply decal to both sides of mower (Fig. 4). Smooth from center to edges to remove air bubbles.

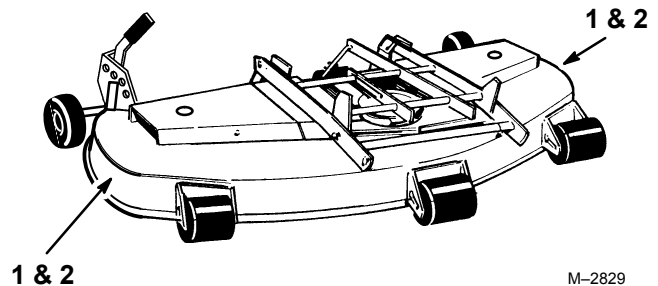

Figure 4

1. Mower side
 2. Apply decal
2. Install mower onto traction unit; refer to traction unit Operator's Manual.

Install Recycler® Blades

1. Install Recycler® blades from kit. Secure with washer, blade, flat washer, and the blade nut (Fig. 3).

Note: Do not install anti-scalp cups as they interrupt the airflow for Recycling.

IMPORTANT: The curved part of the blade must be pointing toward the inside of the mower to assure proper cutting.

2. Tighten the blade nut to 80-100 ft-lb (109-136 Nm).
3. Rotate blades to assure there is at least 1/8" clearance between blades and baffle.

Removing the Recycler® Baffle

1. Thoroughly clean the mower.
2. Remove Recycler® blades from mower (Fig. 3).
3. Remove lock nuts from studs and carriage bolts (Fig. 5). Lower baffle and slide out.
4. Install previously removed 3/8 x 1-1/4" (32 mm) bolts and 3/8" lock nuts to secure linkage brackets (Fig. 5).
5. Install standard blades, previously removed. Secure with washer, blade, flat washer, and the blade nut (Fig. 3).
6. Install mower onto traction unit; refer to traction unit Operator's Manual.

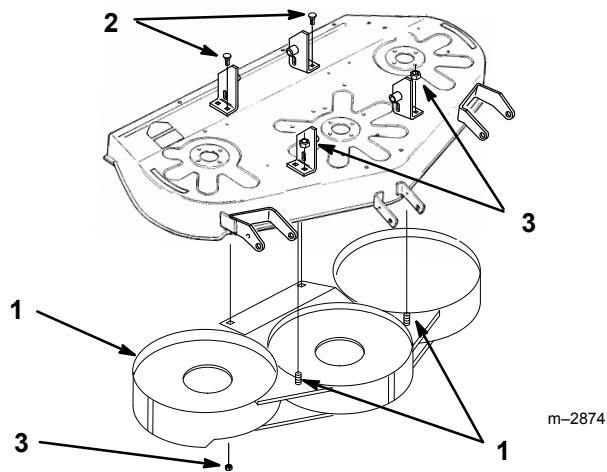

Figure 5

- | | |
|-----------|---------------------------------|
| 1. Baffle | 3. Bolt 3/8-16 x 1-1/4" (32 mm) |
| 2. Stud | 4. Lock nut 3/8" |

DANGER

POTENTIAL HAZARD

- Open holes in the mower expose you and others to thrown debris.

WHAT CAN HAPPEN

- Debris thrown out of holes in the mower can cause injury.

HOW TO AVOID THE HAZARD

- Never operate mower without hardware mounted in all holes in mower.
- Install hardware in mounting holes when recycle baffle is removed.

Tips for Mowing Grass

Fast Throttle Setting

For best mowing and maximum air circulation, operate the engine at “FAST.” Air is required to thoroughly cut grass clippings, so do not set the height-of-cut so low, as to totally surround the mower by uncut grass. Always try to have one side of the mower free from uncut grass, which allows air to be drawn into the mower.

Cutting a Lawn for the First Time

Cut grass slightly longer than normal to ensure the cutting height of the mower does not scalp any uneven ground. However, the cutting height used in the past is generally the best one to use. When cutting grass longer than six inches tall, you may want to cut the lawn twice to assure an acceptable quality-of-cut.

Cut 1/3 of the Grass Blade

It is best to cut only about 1/3 of the grass blade. Cutting more than that is not recommended, unless grass is sparse or it is late fall when grass grows more slowly.

Mowing Direction

Alternate mowing direction to keep the grass standing straight. This also helps disperse clippings which enhances decomposition and fertilization.

Mow at Correct Intervals

Normally, mow every 4 days. But remember, grass grows at different rates at different times. So to maintain the same cutting height, which is a good practice, mow more often in early spring. As the grass growth rate slows in mid summer, mow less frequently. If you cannot mow for an extended period, first mow at a high cutting height; then mow again 2 days later at a lower height setting.

Ground Speed

To improve cut quality, use slower ground speed.

Avoid Cutting Too Low

If the cutting width of the mower is wider than the mower you previously used, raise the cutting height to ensure uneven turf is not cut too short.

Long Grass

If the grass is ever allowed to grow slightly longer than normal, or if it contains a high degree of moisture, raise the cutting height higher than usual and cut the grass at this setting. Then cut the grass again using the lower, normal setting.

When Stopping

If the machine’s forward motion must be stopped while mowing, a clump of grass clippings may drop onto your lawn. To avoid this:

1. With the blade(s) “ENGAGED,” move onto a previously cut area.
2. To disperse the clippings evenly, raise the mower one or two height-of-cut settings while driving forward with the blade(s) “ENGAGED.”

Keep the Underside of the Mower Clean

Clean clippings and dirt from the underside of the mower after each use. If grass and dirt build up inside the mower, cutting quality will eventually become unsatisfactory.

Blade Maintenance

Maintain a sharp blade throughout the cutting season because a sharp blade cuts cleanly without tearing or shredding the grass blades. Tearing and shredding turns grass brown at the edges, which slows growth and increases the chance of disease. Every 30 days, check the cutter blade(s) for sharpness and file down any nicks.