

TORO[®]

PART NO. 95-1625

**INSTALLATION
INSTRUCTIONS****FRONT BRUSH/SCRAPER KIT
GREENSMaster[®] 3200****CAUTION**

Before servicing or making adjustments to the machine, stop engine and remove key from the switch.

1. Loosen capscrews securing each end of roller shaft to front roller brackets.
2. Remove capscrews and locknuts securing left front roller bracket to side plate.
3. Slide a clamp block onto each end of roller shaft. Position clamp blocks on roller shaft so slot is up and threaded portion of hole is rearward.

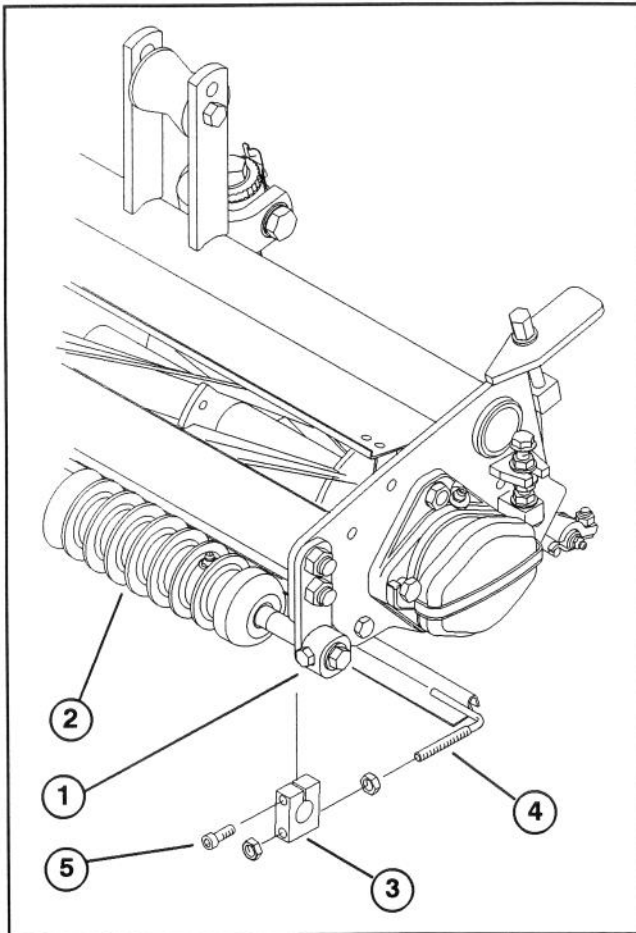
**Figure 1**

- | | |
|--------------------------------|-------------------------|
| 1. Front roller bracket (left) | 4. Scraper rod |
| 2. Front roller | 5. Socket head capscrew |
| 3. Clamp block | |

4. Thread a nut onto each scraper rod.
 5. Insert both scraper rods thru clamp blocks. Loosely secure scraper rods to clamp blocks with a nut.
 6. Partially thread a socket head capscrew into front of each clamp block.
 7. Reinstall roller and Brush/scraper to cutting unit with front roller bracket and fasteners previously removed. Brush/scraper to be positioned with scraper to rear of roller and brush downward.
 8. Level front roller and set height-of-cut. Refer to Cutting Unit Operator's Manual for adjustment procedures.
 9. Adjust the aggressiveness of the brush as follows:
 - A. Bristles touching the adjusting gauge bar gives you an aggressive setting.
 - B. Adjusting the brush assembly so it is midway between the adjusting gauge bar and the cutting edge of the bedknife will provide a medium setting.
 - C. Adjusting the brush assembly so it is even with the cutting edge of the bedknife will provide a light setting.
- Note: Securing one end of the brush assembly at a time simplifies the above procedure.**
10. Tighten socket head capscrews securing clamp blocks to roller shaft.
 11. Adjust nuts on each scraper rod until there is a clearance of approximately 1/32" between scraper and roller. Make sure scraper is parallel to roller.