



# Bagger Adapter Kit

Model 30104 Bagger for 36in GrandStand® Mower

Model No. 121-7515

## Installation Instructions

### ▲ WARNING

#### CALIFORNIA Proposition 65 Warning

This product contains a chemical or chemicals known to the State of California to cause cancer, birth defects, or reproductive harm.

## Installation

### Loose Parts

Use the chart below to verify that all parts have been shipped.

Description	Qty.	Use
Adapter	1	Install the adapter.
Lock nut (1/4 inch)	3	
Bolt (1/4 x 3/4)	3	
Lock nut (3/8 inch)	1	
Bolt (3/8 x 2-1/2 inches)	1	

### Installing the Adapter

1. Install the adapter to the bagger-back plate with 3 bolts (1/4 x 3/4) and lock nuts (1/4 inch).

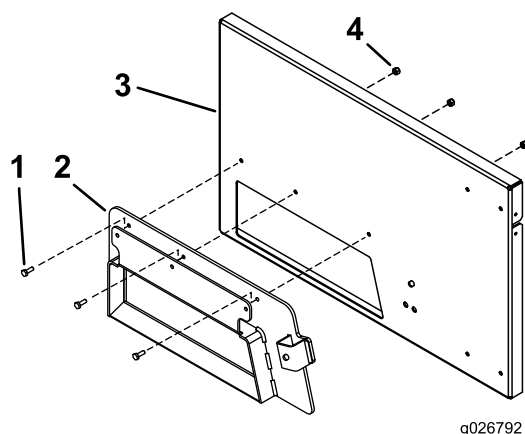

Figure 1

- |                     |                        |
|---------------------|------------------------|
| 1. Bolt (1/4 x 3/4) | 3. Bagger-back plate   |
| 2. Adapter          | 4. Lock nut (1/4 inch) |

3. Install the bagger clamp to the bagger and adapter with a bolt (3/8 x 2-1/2 inches) and lock nut (3/8 inch).

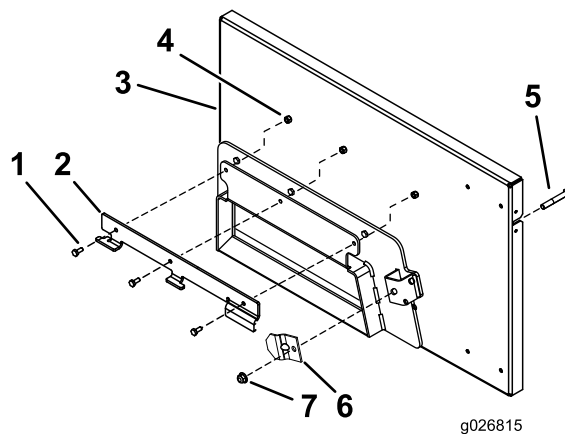

Figure 2

- |                         |                              |
|-------------------------|------------------------------|
| 1. Bolt from bagger     | 5. Bolt (3/8 x 2-1/2 inches) |
| 2. Mounting bracket     | 6. Bagger clamp              |
| 3. Bagger-back plate    | 7. Lock nut (3/8 inch)       |
| 4. Lock nut from bagger |                              |

2. Install the mounting bracket to the adapter with the bolts and nuts provided with the bagger.





**Count on it.**