



# Deluxe Seat Kit

## Z Master® 2000 Series Riding Mower

Model No. 121-4812

### Installation Instructions

**Note:** For machines with 48 inch mower decks, the weight kit must be installed to the machine for performance and safety after the deluxe seat kit is installed. Obtain the correct weight kit (No. 121-7576) from an Authorized Service Dealer.

## Installation

### Loose Parts

Use the chart below to verify that all parts have been shipped.

Procedure	Description	Qty.	Use
<b>1</b>	No parts required	–	Remove the seat.
<b>2</b>	Deluxe suspension seat Seat plate Fan cover plate Flange nut (5/16 inch) Carriage bolt (5/16 x 3/4 inch)	1 1 2 8 4	Install the seat.
<b>3</b>	Decal	1	Install the decal.

# 1

## Removing the Seat

### No Parts Required

#### Procedure

1. Move the seat the furthest rear position to expose the front nuts.
2. Loosen the front nuts. The nuts do not need to be removed.
3. Move the seat to the furthest forward position to expose the rear nuts.
4. Loosen the rear nuts. The nuts do not need to be removed.
5. Slide the seat and seat plate forward to allow the front nuts to go through the key hole (Figure 1).
6. Remove the seat and base from the machine.
7. Unplug the harness connector from the seat switch located under the seat.

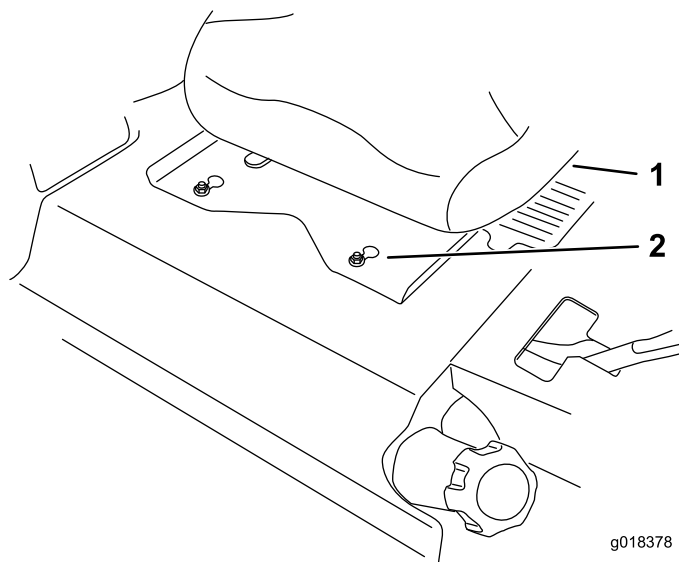

Figure 1

1. Existing seat
2. Front nuts with key hole



# 2

## Installing the Seat

### Parts needed for this procedure:

1	Deluxe suspension seat
1	Seat plate
2	Fan cover plate
8	Flange nut (5/16 inch)
4	Carriage bolt (5/16 x 3/4 inch)

### Procedure

1. Remove the plastic packing covers guarding the seat studs.  
**Note:** Do not remove the spacers on the seat studs.
2. Secure the seat plate to the seat with 4 flange nuts (5/16 inch) (Figure 2).  
Torque the nuts to 22.5 ft-lb (30.5 N-m).
3. Install the fan cover plates to the seat plate with 4 carriage bolts (5/16 x 3/4 inch) and 4 flange nuts (5/16 inch).

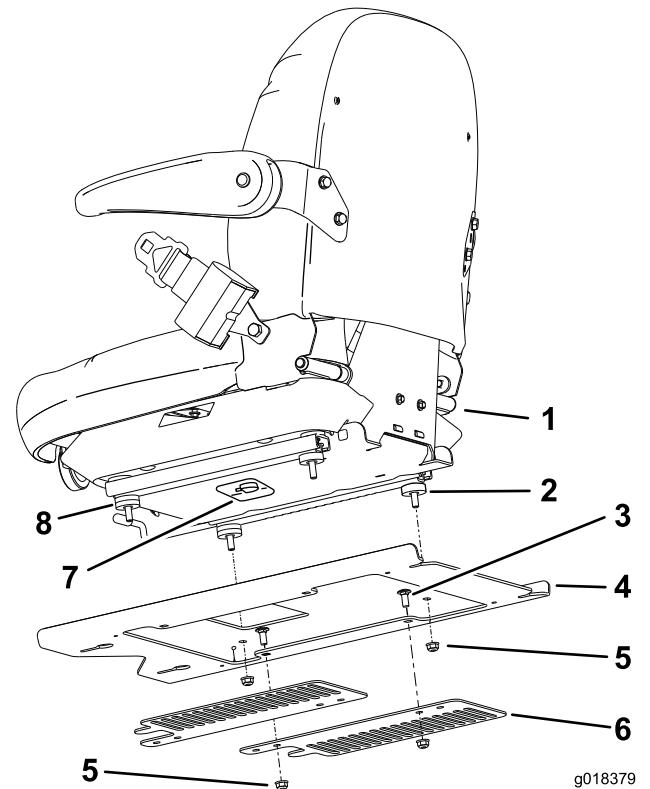
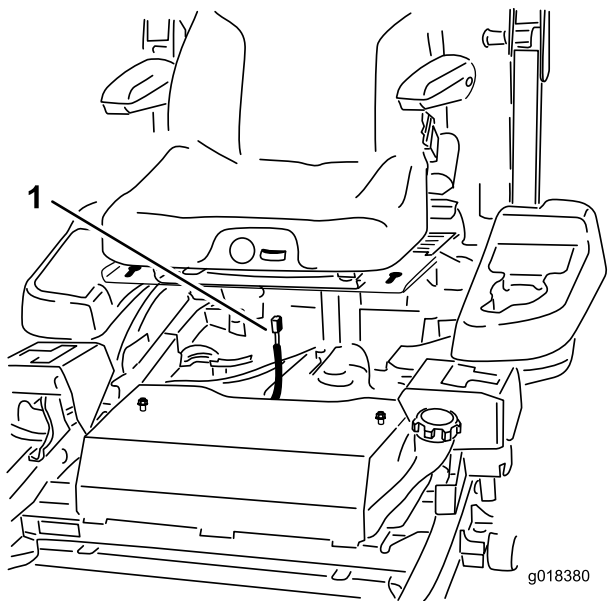

Figure 2

- |  |  |
|--|--|
| 1. Seat  | 5. Flange nut (5/16 inch)                                |
| 2. Do not remove the spacer from each rear seat stud | 6. Fan cover plate                                       |
| 3. Carriage bolt (5/16 x 3/4 inch)                   | 7. Seat switch   |
| 4. Seat plate  | 8. Do not remove the 2 spacers from each front seat stud |

4. Plug the harness connector into the seat switch located under the seat towards the front (Figure 3).
5. Carefully lower the seat down and ensure the harness does not get pinched.
6. Install the seat to the machine frame by aligning the front nuts with the key hole in the seat plate.
7. Slide the seat and seat plate rearward to lock the front nuts into the key hole and the rear nuts into the slots (Figure 2).
8. Torque the nuts to 35 ft-lb (47.5 N-m).



**Figure 3**

- 1. Harness connector

# 3

## Installing the Decal

### Parts needed for this procedure:

1	Decal
---	-------

### Procedure

Remove the backing off the decal and place the decal on the back of the seat as shown in Figure 4.

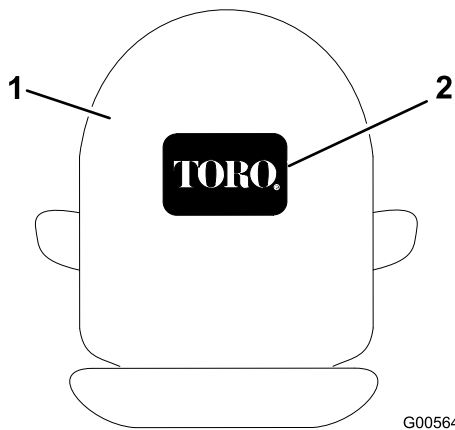

**Figure 4**

- 1. Back of seat
- 2. Decal

# Operation

## Positioning the Seat

### Changing the Seat Position

The seat can move forward and backward. Position the seat where you have the best control of the machine and are most comfortable.

1. To adjust, push the lever downward to unlock seat (Figure 5).
2. Slide the seat to the desired position and release lever to lock in position.

### Changing the Seat Suspension

The seat can be adjusted to provide a smooth and comfortable ride. Position the seat where you are most comfortable.

To adjust it, turn the knob in front either direction to provide the best comfort (Figure 5).

### Changing the Armrest Position

The armrests can be adjusted to provide a comfortable ride. Position the armrests where you are most comfortable.

To adjust it, raise the armrest and turn the knob in either direction to provide the best comfort (Figure 5).

### Changing the Back Position

The back of the seat can be adjusted to provide a comfortable ride. Position the back of the seat where it is most comfortable.

To adjust it, turn the knob, under the right-side arm rest, in either direction to provide the best comfort (Figure 5).

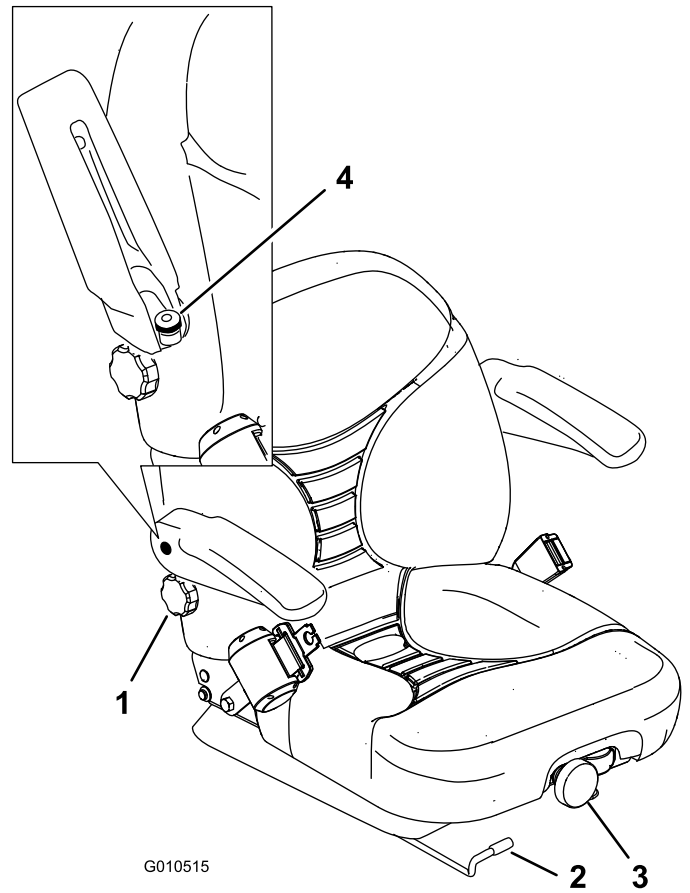

**Figure 5**

- |                                   |                            |
|-----------------------------------|----------------------------|
| 1. Back rest knob                 | 3. Seat suspension knob    |
| 2. Seat position adjustment lever | 4. Armrest adjustment knob |