



Replacement Hood Kit

XLS Lawn Tractor

Model No. 121-4011

Installation Instructions

Installation

Loose Parts

Use the chart below to verify that all parts have been shipped.

Procedure	Description	Qty.	Use
1	Hood	1	Install hood
	Flat washer	2	
	Screw self tapping 1/4 x 0.75	12	



Parts needed for this procedure:

1	Hood
2	Flat washer
12	Screw self tapping 1/4 x 0.75

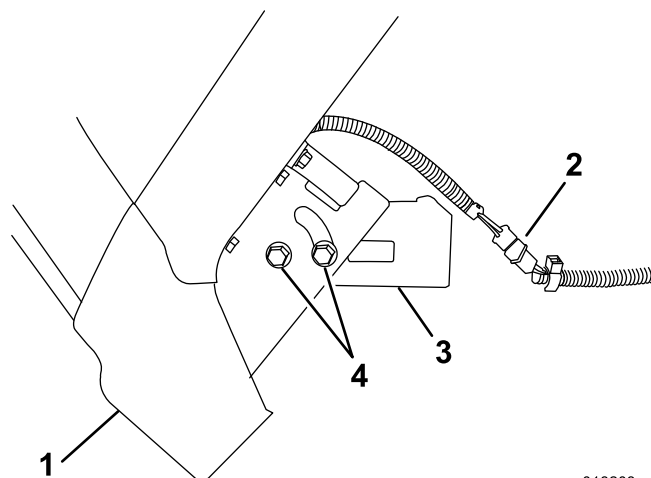

g018208

Figure 1

Procedure

1. Raise the existing hood (Figure 1).
2. Disconnect the wire harness located on the left side.
3. Remove the 4 screws securing the hood to the frame.
Remove the hood. Save these screws.

1. Raised hood
2. Wire harness
3. Frame
4. Screws securing the hood

4. Remove the 4 screws securing the air duct to the existing hood. Remove the air duct and discard screws (Figure 2).

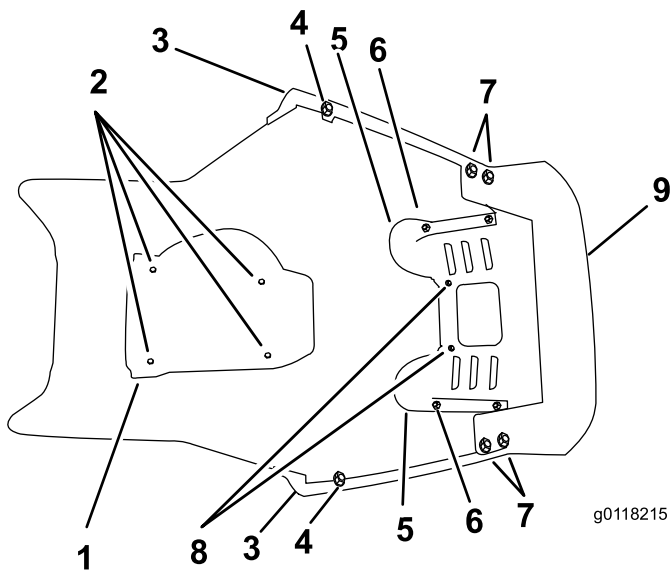

Figure 2

- | | |
|---|--|
| 1. Air duct | 6. Outside screw securing the headlight (save these existing screws) |
| 2. Self tapping screw | 7. Self tapping screw securing the trim and the front end assembly |
| 3. Trim | 8. Inside screw securing the headlight (discard these screws) |
| 4. Self tapping screw securing the trim (install the new flat washers here) | 9. Front end assembly |
| 5. Headlight | |

-
5. Remove the 6 screws securing the trim and front end assembly. Discard the screws and remove the trim.
 6. Remove the 2 outside screws securing the headlights. Save these screws.
 7. Remove the 2 inside screws and discard the screws.
 8. Remove the head lights and front end assembly.
 9. Install the existing air duct to the new hood using the 4 new self-tapping screws.
 10. Install the existing trim, headlights, and front grill assembly to the new hood using the 2 new flat washers, 8 new self tapping screws, and two existing screws securing the outside area of the head lights.

Note: Install the new self-tapping screws only in places that thread directly into the hood. Use the existing hardware in the other areas.

11. Tighten all of the screws securing the air duct, trim, front end assembly, and headlights to 20–28 in-lb.
12. Install the new hood to the frame using the existing screws.
13. Install the wire harness.
14. Close the hood.