



Sand Pro/Infield Pro 3040 and 5040 Traction Units

Model No. 08703 —Serial No. 290000001 and Up

Model No. 08705 —Serial No. 290000001 and Up

Setup Instructions

Loose Parts

Use the chart below to verify that all parts have been shipped.

Description	Qty.	Use
Push nuts	2	Install the push nuts

Installing the Push Nuts

- Loosen the two bolts securing the center shroud to the frame (Figure 1). Do not remove the bolts and the washers from the shroud.
- Lift the center shroud off the machine frame.

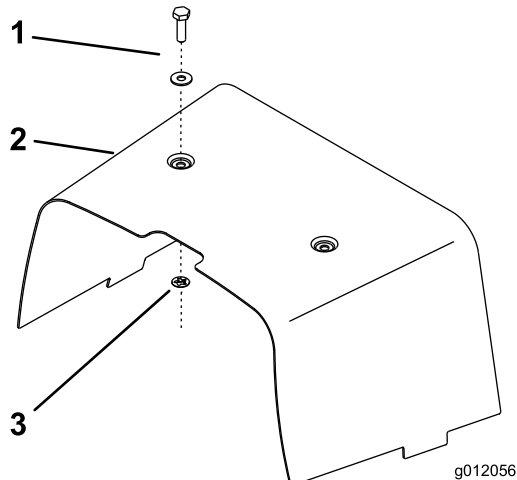

Figure 1

- Bolts and washers (2)
- Center shroud
- Push nut (2)

- Inside the shroud, install a push nut onto each bolt (Figure 1).
- Place the shroud onto the machine and secure it to the frame with the bolts.