



Backup Alarm Kit for 2004 and After Workman Heavy-Duty Utility Vehicles Model No. 107-8037

Form No. 3351-789 Rev A

Installation Instructions

Installation



If you leave the key in the ignition switch, someone could accidentally start the engine and seriously injure you or other bystanders.

Remove the key from the ignition switch before you do any maintenance.

1. Raise the bed and install the safety support on the fully extended lift cylinder rod (if so equipped).
2. Stop the engine, set the parking brake and remove the key from the ignition switch.
3. On vehicles with serial numbers prior to 289999999, remove the hood as follows:
 - Remove the (6) screws and nuts securing the bumper to the vehicle frame and remove the bumper.
 - Remove the (7) screws securing the front hood to the vehicle frame.
 - Remove the hood.
4. On vehicles with serial numbers 290000001 and up, remove the hood as follows:
 - While grasping the hood in the headlight openings, lift up on the hood to release the lower mounting tabs from the frame slots.
 - Pivot the bottom of the hood upward until the top mounting tabs can be pulled from the frame slots.
 - Pivot the top of the hood forward and unplug the wire connectors from the head lights
 - Remove the hood.
5. Mount the backup alarm to the mounting bracket with (2) 1/4 x 3/4 inch flange head capscrews, flat washers and 1/4 inch flange nuts. Position the fasteners as shown in Figure 1.

6. Secure the mounting bracket to the rear frame tube with (2) 1/4 x 3/4 inch flange head capscrews and 1/4 inch flange nuts. Position the fasteners as shown in Figure 1.

Note: If the vehicle is equipped with a rear PTO shield, mount the bracket on top of the PTO shield.

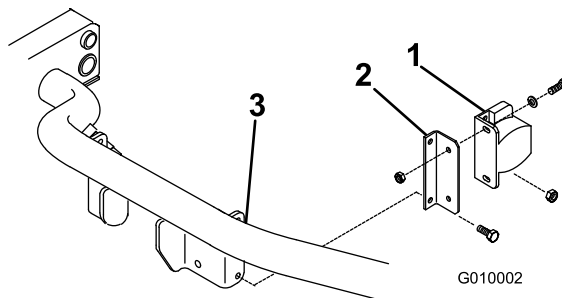

Figure 1

1. Backup alarm
2. Mounting bracket
3. Rear frame tube bracket

7. Loosely secure the micro switch to the switch bracket with (2) #10 x 3/4 inch carriage screws and flange locknuts. Position the fasteners as shown in Figure 2.

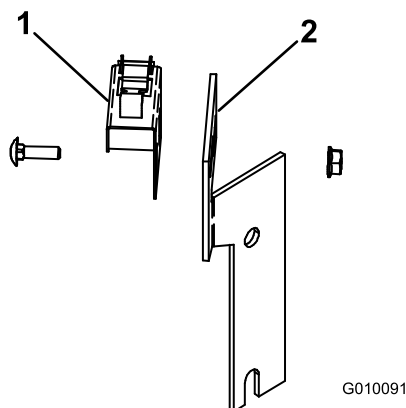

Figure 2

1. Micro switch
2. Switch bracket

8. Remove the upper transmission bolt shown in Figure 3.

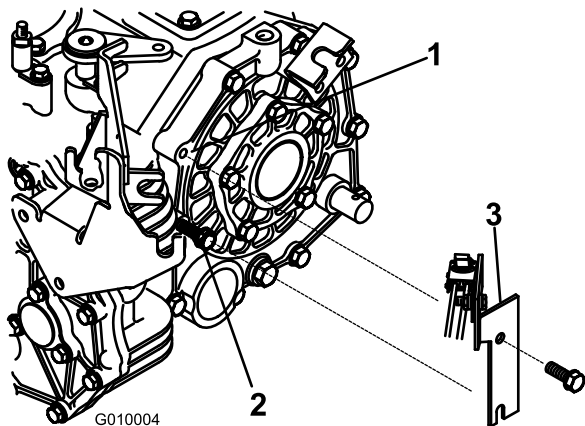

Figure 3

- | | |
|-------------------------------------|--------------------------------|
| 1. Upper transmission bolt location | 3. Switch and bracket assembly |
| 2. Lower transmission bolt location | |

9. Loosen the lower transmission bolt shown in Figure 3.
10. Secure the switch bracket to the transmission with the bolts loosened and removed (Figure 3). Torque the bolts to 16 ft-lb (N-m).

If the vehicle has a serial number prior to 289999999, use the following steps thru 21, otherwise proceed to step 25.

Note: If the vehicle is equipped with an Accessory Wire Harness Kit, part no. 107-7987, proceed to the next step and do not use the wire harness supplied with the kit, otherwise proceed to step 16.

11. Plug the micro switch connector into the wire harness connector.
12. Secure the ring terminal connector from the harness (green wire) to the alarm mounting post with a nut.
13. Disconnect the orange wire from the "L" terminal on the back of the fuel gauge.
14. Plug the spade terminal of the orange wire from the Accessory Wire Harness into the "L" terminal on the back of the fuel gauge.
15. Plug the orange wire, previously disconnected from fuel gauge, into the male spade terminal of the orange wire form the Accessory Wire Harness. Proceed to step 26.

If the vehicle is not equipped with an Accessory Wire Harness Kit, part no. 107-7987, use the wire harness supplied with the kit.

16. Plug the micro switch connector into the wire harness connector.

17. Secure the ring terminal connector from the harness to the alarm mounting post with a nut.
18. Disconnect the orange wire from the "L" terminal on the back of the fuel gauge.
19. Plug the spade terminal of the orange wire from the Backup Alarm Wire Harness into the "L" terminal on the back of the fuel gauge.

20. Plug the orange wire, previously disconnected from fuel gauge, into the male spade terminal of the orange wire form the Backup Alarm Wire Harness.

Use steps 22 thru 25 on vehicles with serial numbers greater than 290000001.

21. Plug the micro switch connector into the wire harness connector.
22. Secure the ring terminal connector from the harness (green wire) to the alarm mounting post with a nut.
23. Route the wire harness to the fuse block.

Note: If an open fuse spot is not available, install an additional fuse block.

24. Plug the harness connector into the back of an open fuse slot.
25. Plug the 10 amp fuse into the fuse slot
26. Secure the wire harness to the frame or to the stationary cable to prevent it from being damaged by hot or rotating components.
27. Reinstall the front hood and the bumper to the vehicle if they were removed.
28. Route the harness rear ward and proceed with the installation of the other light kits per the instructions supplied with the specific kit or coil up the excess harness and secure it to the frame with a cable tie.
29. Connect the positive (+) battery cable to the battery.
30. Turn the ignition key to the "ON" position but do not start the vehicle.
31. Shift the vehicle into reverse.
32. Move the micro switch until a position is located that activates the switch and sounds the alarm. Tighten the switch mounting nut.
33. Shift the vehicle into any forward gear or neutral, the alarm should stop. If the alarm continues, loosen the switch mounting nuts and readjust until the switch functions properly.