



Standard Suspension Seat Kit

For Compact and Mid-Size Z Master® Mowers

Model No. 107–1892

Installation Instructions

Note: Determine the left and right sides of the machine from the normal operating position.

Loose Parts

Use the chart below to verify that all parts have been shipped.

Step	Description	Qty.	Use
1	Z100/400 Switch and actuator assembly	1	Install the seat switch assembly.
	Z200/500 Actuator assembly	1	
	Bolt, (1/4 x 3/4 inch)	2	
	Flange nut, (5/16 inch)	2	
2	Z100/400 Switch and actuator assembly	1	Install the seat switch for an EFI Z Master.
	Z200/500 Actuator assembly	1	
	Bolt, (1/4 x 3/4 inch)	2	
	Flange nut, (5/16 inch)	2	
3	No parts required	–	Remove the seat.
4	Seat suspension assembly	1	Install the pulley assembly.
	Bolt, (5/16 x 1 inch)	4	
	Washer, (3/8 inch)	4	
	Locknut, (5/16 inch)	4	
	Seat stop	2	
	Flange nut, (5/16 inch)	4	

Step

1

Installing the Seat Switch Assembly

Parts needed for this step:

1	Z100/400 Switch and actuator assembly
1	Z200/500 Actuator assembly
2	Bolt, (1/4 x 3/4 inch)
2	Flange nut, (5/16 inch)

Procedure

Installation of a seat suspension requires a new, longer seat switch actuator that has a stronger

spring. It is necessary to install the seat switch assembly included in this kit to ensure the proper function of the safety interlock system.



If safety interlock switches are disconnected or damaged the machine could operate unexpectedly causing personal injury.

- Do not tamper with the interlock switches.
- Check the operation of the interlock switches daily and replace any damaged switches before operating the machine.

1. Stop the engine, wait for all moving parts to stop, and remove the ignition key.
2. Tip the seat forward and disconnect the negative battery cable.

- The switch is located on the rear frame of the seat compartment.
- Disconnect the electrical wire harness from the existing seat switch assembly by pulling firmly on the connector. Use Figure 1 for Z100/400 series mowers and Figure 2 for Z200/500 series mowers.

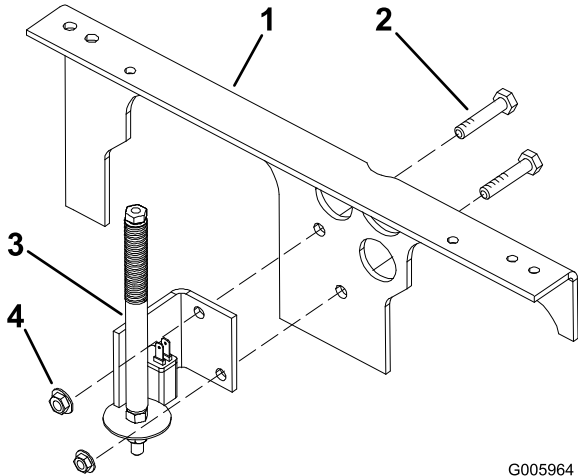

G005964

Figure 1

Z100/400 Series Only

- | | |
|---|---------|
| 1. Frame | 3. Bolt |
| 2. Switch and actuator assembly for Z100/400 Series | 4. Nut |

Note: The Z100/400 series switch assembly varies from the Z200/500 series actuator assembly.

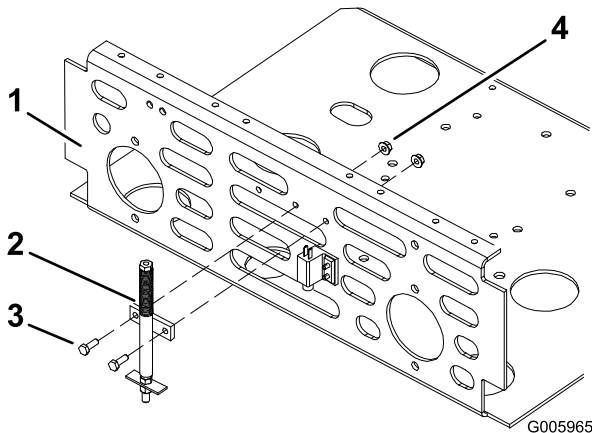

G005965

Figure 2

Z200/500 Series Only

- | | |
|---|---------|
| 1. Frame | 3. Bolt |
| 2. Switch and actuator assembly for Z200/500 Series | 4. Nut |

- Remove the seat switch assembly by removing the two bolts and nuts that secure the switch to the frame. Retain the fasteners for later use (Figure 1 or Figure 2).
 - Install the new seat switch assembly using the fasteners removed previously.
- Note:** On the Z200/500 series only the actuator is replaced and fasteners provided in the assembly can be used (Figure 2).
- Install the electrical wire harness connector to the seat switch.

Step

2

Installing the Seat Switch for an EFI Z Master

Parts needed for this step:

1	Z100/400 Switch and actuator assembly
1	Z200/500 Actuator assembly
2	Bolt, (1/4 x 3/4 inch)
2	Flange nut, (5/16 inch)

Procedure

If you are replacing a deluxe seat with a standard seat and suspension on a Z Master unit with a Kohler EFI engine, an actuator assembly and switch will not be present. Use the Z100/400 switch and actuator assembly and the Z200/500 actuator included with this kit to install a new actuator and switch.

- Stop the engine, wait for all moving parts to stop, and remove the ignition key.
- Tip the seat forward and disconnect the negative battery cable.
- Disconnect the electrical wire harness from the operator presence switch in the seat by pulling firmly on the connector.
- Remove the switch from Z100/400 actuator and switch assembly. Remove the two screws and tapped plate to separate the switch from the assembly (Figure 3).

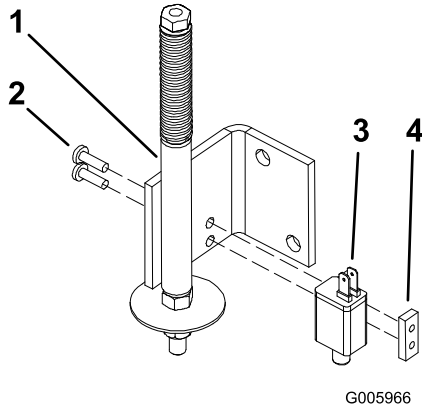

Figure 3

- | | |
|--|-----------------|
| 1. Actuator assembly for Z100/400 Series | 3. Switch |
| 2. Screw | 4. Tapped plate |

-
5. Using the screws and the tapped plate, attach the switch to the vertical frame panel at the rear of the compartment under the seat as shown in Figure 4.

Unlatch and remove the right belt cover. Save this hardware.

6. Attach the Z200/500 actuator assembly to the vertical frame panel at the rear of the compartment under the seat (Figure 4) using the two bolts (1/4 x 3/4 inch) and two flange nuts (1/4 inch) included in the assembly.

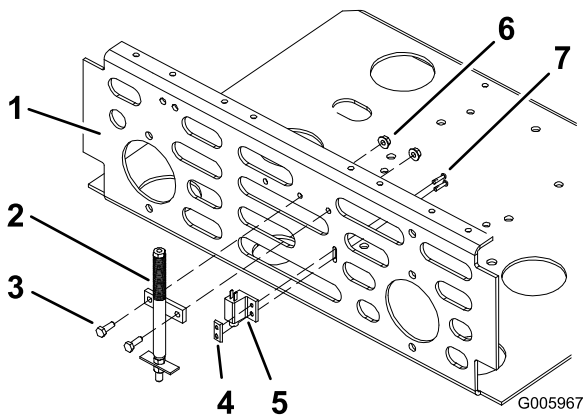

Figure 4

- | | |
|-------------------------------|----------------------------|
| 1. Frame | 5. Switch |
| 2. Z200/500 actuator assembly | 6. Flange nuts, (1/4 inch) |
| 3. Bolt, (1/4 x 3/4 inch) | 7. Screws |
| 4. Tapped plate | |

-
7. Install the wire harness connector to the switch.

Step **3**

Removing the Seat

No Parts Required

Procedure

Note: Clean the area around the right, rear anti-scalp wheel.

1. Tip the seat forward and remove the two bolts and washers holding the seat cushion to the seat pan (Figure 5). Retain the seat cushion fasteners for later use.

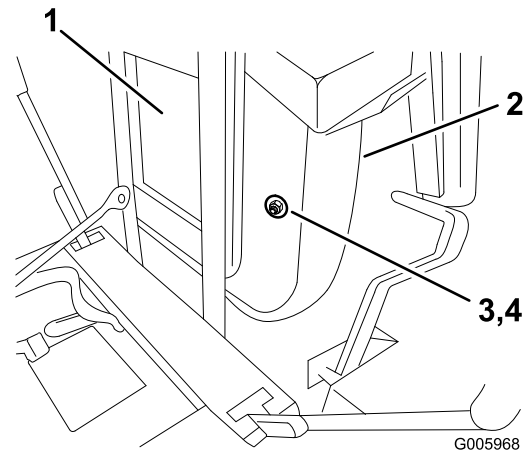

Figure 5

- | | |
|-----------------|--------------------------------|
| 1. Seat cushion | 3. Bolt, left and right side |
| 2. Seat pan | 4. Washer, left and right side |

-
2. Remove the seat cushion and tip the seat back down.
 3. Remove the nuts holding seat pan to the seat tracks (Figure 6). Remove the seat and set aside. Retain the seat pan fasteners for later use. Discard the conical spacers.

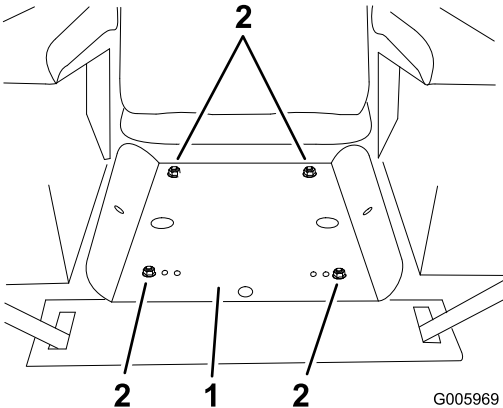

Figure 6

1. Seat pan
2. Flange nuts

4. Remove the nuts holding the seat track to the seat mounting frame. Retain the seat tracks and fasteners for later use (Figure 7).

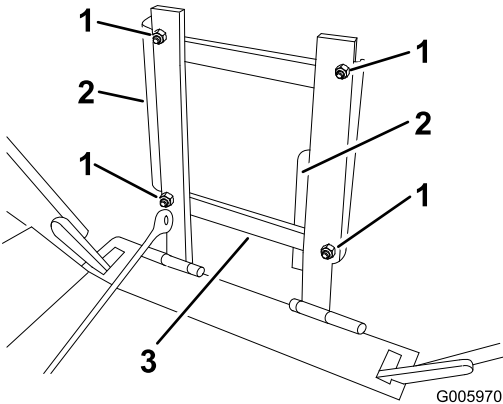

Figure 7

1. Flange nuts
2. Seat track
3. Seat mounting frame

Step
4

Installing the Suspension and Seat

Parts needed for this step:

1	Seat suspension assembly
4	Bolt, (5/16 x 1 inch)
4	Washer, (3/8 inch)
4	Locknut, (5/16 inch)
2	Seat stop
4	Flange nut, (5/16 inch)

Procedure

- Place the seat stops on the seat mounting frame so that the bent ends are facing up and the slots are forward (Figure 8).
 - Install the seat tracks onto the seat stops and mounting frame (Figure 8).
- Note:** Make sure the seat track with the adjustment lever is on the right side of the seat.
- Use the four flange nuts removed previously to secure the tracks and stops to the seat frame.
 - Tip the seat frame down.
- Note:** If the pulley does not turn, loosen the bolts to raise the bolt heads and allow the pulley to lock into position.
- Position the seat suspension assembly with the front holes onto the studs in the seat tracks and the weight adjustment knob facing the front (Figure 8). Use the four flange nuts removed previously to secure the seat suspension to the tracks. Note: If the seat suspension has two sets of mounting holes, use the outside set of mounting holes.
 - Install the seat pan to the seat suspension with four bolts (5/16 x 1 inch), four washers (3/8 inch), and four lock nuts (5/16 inch) included in the suspension assembly.
 - Tilt the seat frame and suspension up.
 - Install the seat cushion to the seat pan using the existing bolts and washers removed previously.
 - After the suspension and seat are installed, check for proper adjustment of the seat switch

actuator rod length. See Adjusting the Seat Actuator.

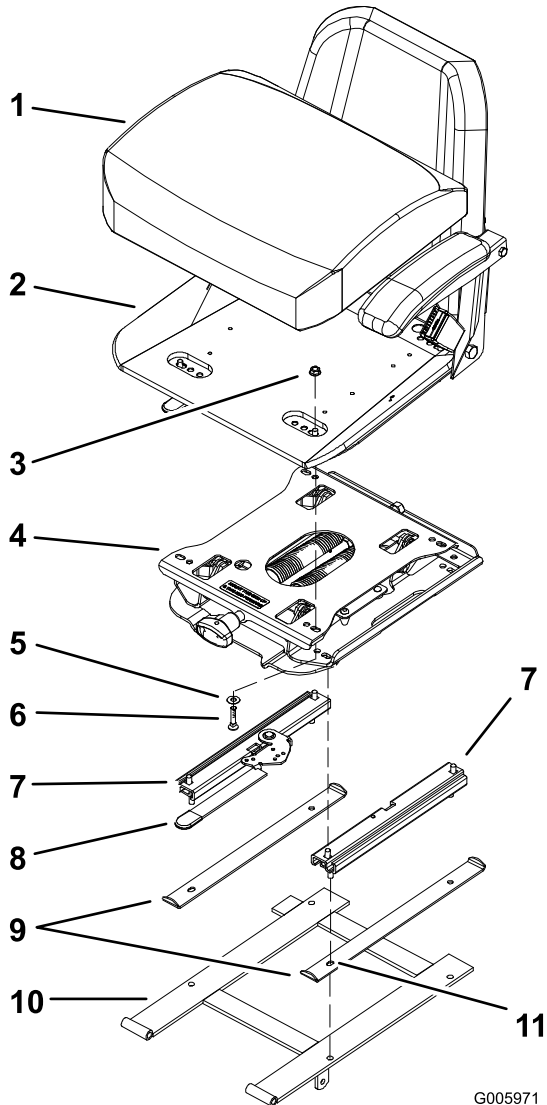

Figure 8

G005971

- | | |
|----------------------------|---------------------|
| 1. Seat cushion | 7. Seat tracks |
| 2. Seat pan | 8. Adjustment lever |
| 3. Flange nut, (5/16 inch) | 9. Seat stops |
| 4. Suspension | 10. Seat frame |
| 5. Washer, (3/8 inch) | 11. Slot |
| 6. Bolts, (5/16 x 1 inch) | |

1. Pull the suspension adjustment knob out (forward) to adjust the seat.
2. Turn the knob in the direction indicated on the label to achieve the desired level of suspension.

Note: Initially adjust the setting so that the seat barely moves when the operator slowly sits down.

3. Push the knob back in (rearward) when adjustment is completed.

Adjusting the Seat Actuator

If necessary, adjust the length of the seat actuator rod so that the safety interlock system functions properly. The machine, with the brake disengaged or the PTO engaged, should shut off when the operator rises of the seat, but will continue to run when the operator shifts their weight while in the seat.

1. Tip the seat forward to access the seat switch and actuator.
2. Loosen the bottom lock nut of the actuator rod.
3. Loosen the top nut and move the washer/plate to the desired position.
4. Tighten the nuts.
5. Test the seat to ensure the safety system functions properly.

Note: Repeat the adjustment procedure if necessary.

Operation

Adjusting the Suspension Seat

There are approximately 40 revolutions needed to change the suspension setting from the softest to the most stiff setting.



Count on it.