



# Rear Scraper Kit

## For Reelmaster® 5010 Series Cutting Unit

Model No. 107-3280

### Installation Instructions

**Note:** Determine the left and right sides of the machine from the normal operating position.

## Installation

### Step

# 1

### Installing the Scraper Kit

#### Parts needed for this step:

1	Right hand scraper bracket
1	Scraper rod
1	Left hand scraper bracket
4	Flange nut (3/8 inch)
4	Flange nut (5/16 inch)

#### Procedure

- Place the mower on a level surface.
- Remove the 2 flange lock nuts securing each roller bracket to the side plates (Figure 1). Do not remove the bolts.

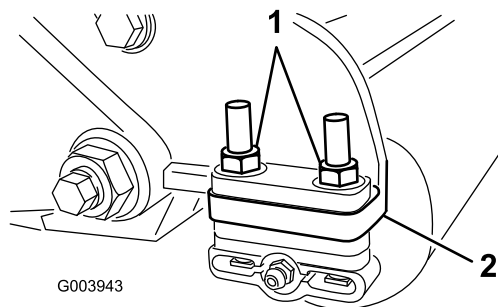

**Figure 1**

- Remove nuts securing each end of roller
- Side plate mounting flange
- Mount the appropriate scraper bracket (right hand or left hand) to each roller bracket with 2 flange nuts (5/16 inch). Position the brackets as shown in Figure 3. Make sure the roller is secure in the roller brackets.

**Note:** When operating in higher heights of cut, it may be necessary to remove the 1/4 inch spacer from on top of the side plate mounting flange and to reposition it under the side plate mounting flange. When operating in lower heights of cut, it may be necessary to remove the 1/4 inch spacer from under the side plate mounting flange and to reposition it on top of the side plate mounting flange (Figure 2). Make sure the scraper is always positioned on the top.

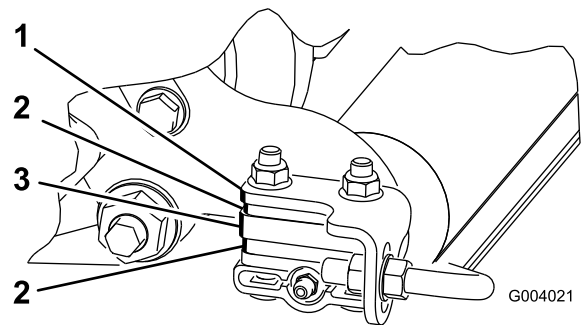

**Figure 2**

- Scraper bracket
- 1/4 inch spacer
- Side plate mounting flange
- Thread a flange nut (3/8 inch) onto each end of the scraper rod as shown in Figure 3.
- Insert the scraper rod into the scraper brackets and loosely secure it with 2 flange nuts (3/8 inch) as shown in Figure 3.
- Adjust the locknuts to attain a .030 inch -.060 inch clearance between the scraper bar and the roller. The distance between the bottom of the bar and the level surface should be slightly higher than the height of cut.
- Ensure the scraper bar is parallel to the roller and the level surface.
- Note:** When the scraper is properly installed, the bottom of the bar should just brush the turf.
- Tighten all fasteners.

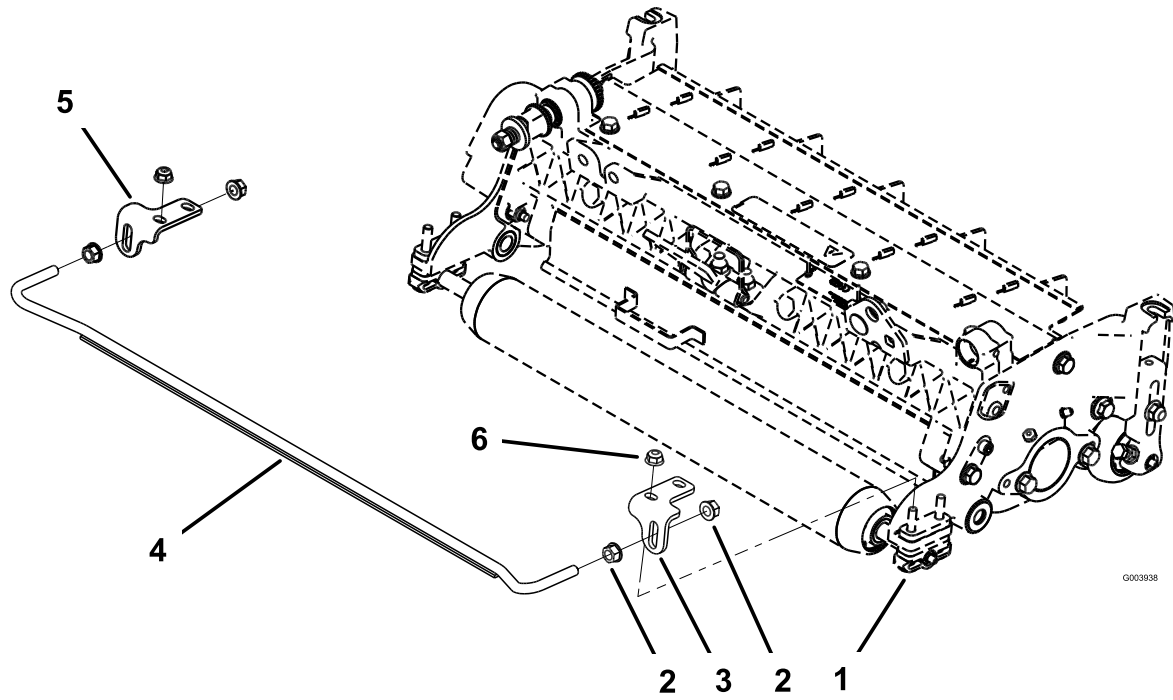

**Figure 3**

- |                          |                               |                              |
|--------------------------|-------------------------------|------------------------------|
| 1. Cutting unit          | 3. Right hand scraper bracket | 5. Left hand scraper bracket |
| 2. Flange nut (3/8 inch) | 4. Scraper rod                | 6. Flange nut (5/16 inch)    |