



Road Wheel Kit

for 413, 420, and 425 TX Compact Utility Loaders

Part No. 106-7620

Form No. 3353-879 Rev A

Installation Instructions

Loose Parts

Description	Qty.	Use
Road wheel	1	Install the road wheel
Gasket	1	
Road wheel cap	1	
Snap ring	1	

Replacing the Road Wheels

1. Lower the loader arms, stop the engine, and remove the key.
2. Remove the tracks; refer to Replacing the Tracks in your *Operator's Manual*.
3. If you are replacing one of the inner road wheels, remove the 4 bolts securing the lower track guide which contains the road wheels, and remove it (Fig. 1).

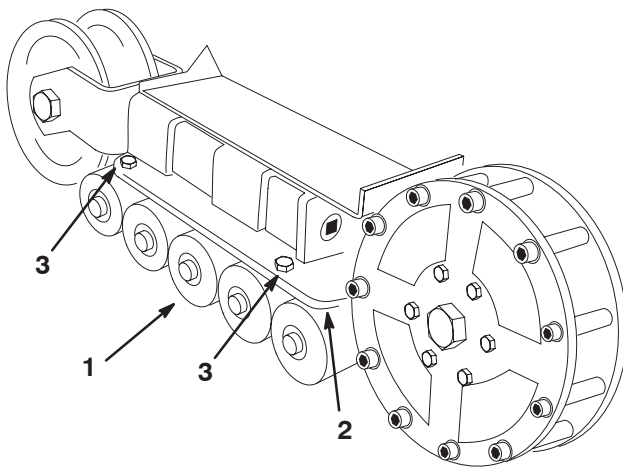
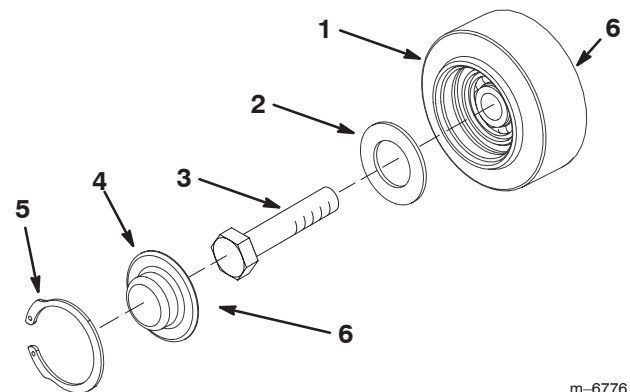

Figure 1

1. Road wheels
2. Lower track guide
3. Track guide bolts (only two shown)



m-6776

Figure 2

1. Road wheel
2. Gasket
3. Bolt
4. Road wheel cap
5. Snap ring
6. Add grease under the cap
7. Add grease behind the wheel between the bearing and the seal.

4. Remove the damaged road wheel and discard it, saving the bolt for later use (Fig. 1).
5. Add grease between the bearing and the seal behind the wheel (Fig 2).

6. Install the new road wheel onto the track guide using the gasket in the kit and the bolt you removed previously (Fig. 2).
7. Torque the road wheel bolt to 135 to 165 ft-lb (183 to 223 N·m).
8. Fill the road wheel cap with grease and place it over the bolt head (Fig 2).
9. Secure the road wheel cap with a snap ring (Fig 2).
10. If you removed it, install the track guide to the traction unit frame using the fasteners you removed previously. Torque the bolts to 67 to 83 ft-lb (91 to 112 N·m).
11. Install the tracks; refer to Replacing the Tracks in your *Operator's Manual*.

Maintaining the Road Wheels

Check and grease the road wheels every 250 operating hours or yearly.

1. Remove the tracks; refer to Replacing the Tracks in your *Operator's Manual*.
2. Remove the 4 bolts securing each lower track guide which contains the road wheels, and remove them (Fig. 1).
3. Remove the snap ring and cap from a road wheel (Fig 2).
4. Check the grease under the cap and around the gasket (Fig 2). If it is dirty, gritty, or depleted, clean out all of the grease, replace the gasket, and add new grease.
5. Ensure that the road wheel turns smoothly on the bearing. If it is frozen, replace the road wheel or contact your Authorized Service Dealer for repair.
6. Place the greased road wheel cap over the bolt head (Fig 2).
7. Secure the road wheel cap with the snap ring (Fig 2).
8. Repeat steps 3 through 7 for the other road wheels.
9. Install each track guide to the traction unit frame using the fasteners you removed previously. Torque the bolts to 67 to 83 ft-lb (91 to 112 N·m).
10. Install the tracks; refer to Installing the Track in your *Operator's Manual*.