



# Roll Over Protection System Kit

## 400 Series Z Masters

Part No. 107-8093

Form No. 3353-236

### Installation Instructions

**Note:** This kit is used for replacing an existing ROPS.

## Loose Parts

**Note:** Use the chart below to identify parts for assembly.

Step	Description	Qty.	Use
<b>1</b>	No parts needed	–	Removing the existing seat
<b>2</b>	Seat frame	1	Installing the new seat frame
<b>3</b>	Seat latch catch Bolt, 5/16 x 7/8 inch Locknut, 5/16 inch	1 2 2	Installing the new seat latch catch
<b>4</b>	Seat belt Bolt, 7/16 x 1 inch Locknut, 7/16 inch	1 2 2	Installing the seat belt
<b>5</b>	Roll bar, right section Roll bar, left section Roll bar, center section Bolt, 3/8 x 1 inch Curved washer, 3/8 inch Flange nut, 3/8 inch Bolt, 1/2 x 3-1/4 inches Flange nut, 1/2 inch Lanyard	1 1 1 8 8 8 2 2 2	Installing the roll over protection system (ROPS)
<b>6</b>	No parts needed	–	Checking the tire pressure



## Step

## 1

## Removing the Existing Seat Frame

### Parts needed for this step:

None

### Procedure

1. Remove the nut and bolt from the seat retaining rod.

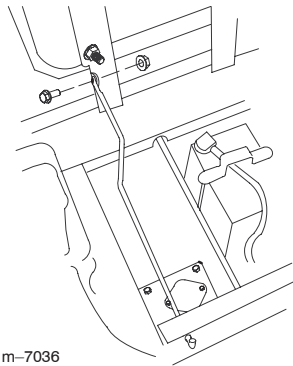

m-7036

2. Remove the 2 bolts and 2 locknuts at the front of the seat where it is hinged. Save the hardware.

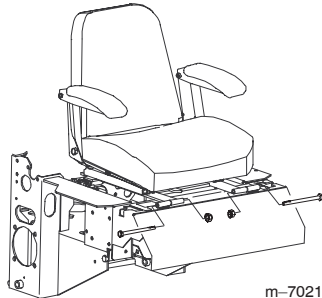

m-7021

3. Remove the seat assembly from the machine.

m-7023

4. Remove the seat frame from the existing seat by removing the four locknuts. Discard the seat frame.



5. Install the seat retaining rod with the nut and bolt previously removed.

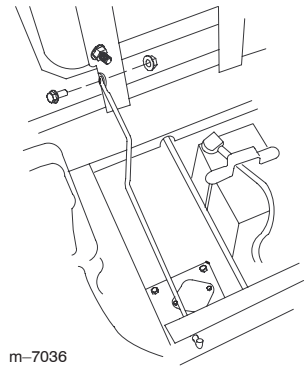

m-7036

Step

2

## Installing the New Seat Frame

Parts needed for this step:

Qty.	Part
1	Seat frame

### Procedure

1. Install the seat to the new seat frame with the four locknuts previously removed.



2. Install the seat at the hinges with the 2 bolts and 2 locknuts previously removed.

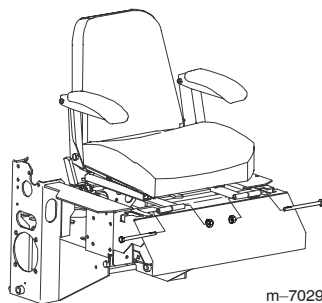

Step

3

## Installing the Seat Latch Catch

Parts needed for this step:

Qty.	Part
1	Seat latch catch
2	Bolt, 5/16 x 7/8 inches
2	Locknut, 5/16 inch

### Procedure

1. Remove the existing seat latch from the machine.
2. Install the new seat latch catch under the frame with 2 bolts (5/16 x 7/8 inch) and 2 locknuts (5/16 inch).

**Note:** The bent part of the latch catch should point downward.

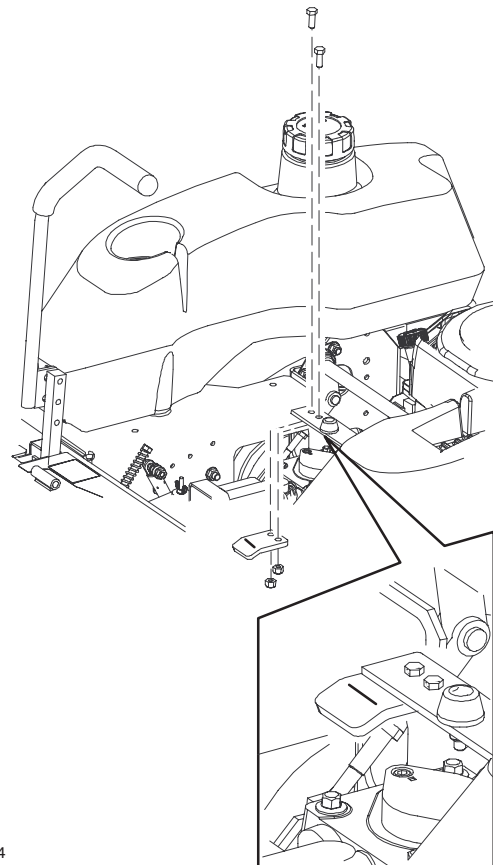

m-8224

## Step

## 4

## Installing the Seat Belt

## Parts needed for this step:

Qty.	Part
2	Seat belt
2	Bolt, 7/16 x 1 inch
2	Locknut, 7/16 inch

## Procedure

1. Install the receiver part of the seat belt between the cushion and the metal seat frame with 1 bolt (7/16 x 1 inch) and 1 locknut (7/16 inch).

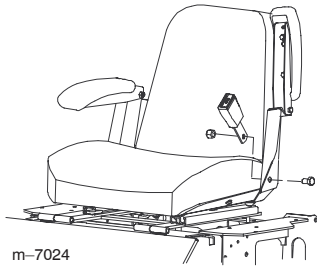

2. Install the long seat belt strap between the cushion and the metal seat frame with 1 bolt (7/16 x 1 inch) and 1 locknut (7/16 inch).

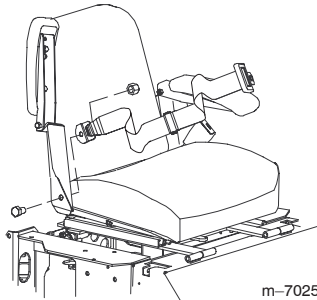

## Step

## 5

## Installing the Roll Over Protection System (ROPS)

## Parts needed for this step:

Qty.	Part
1	Roll bar, right section
1	Roll bar, left section
1	Roll bar, center section
8	Bolt, 3/8 x 1 inch
8	Curved washer
8	Flange nut, 3/8 inch
2	Bolt, 1/2 x 3-1/4 inches
2	Flange nut, 1/2 inch
2	Lanyard

## Procedure

1. **Loosely** install the right and left roll bar sections to the frame, using 8 bolts (3/8 x 1 inch), 8 curved washers, and 8 flange nuts (3/8 inch).

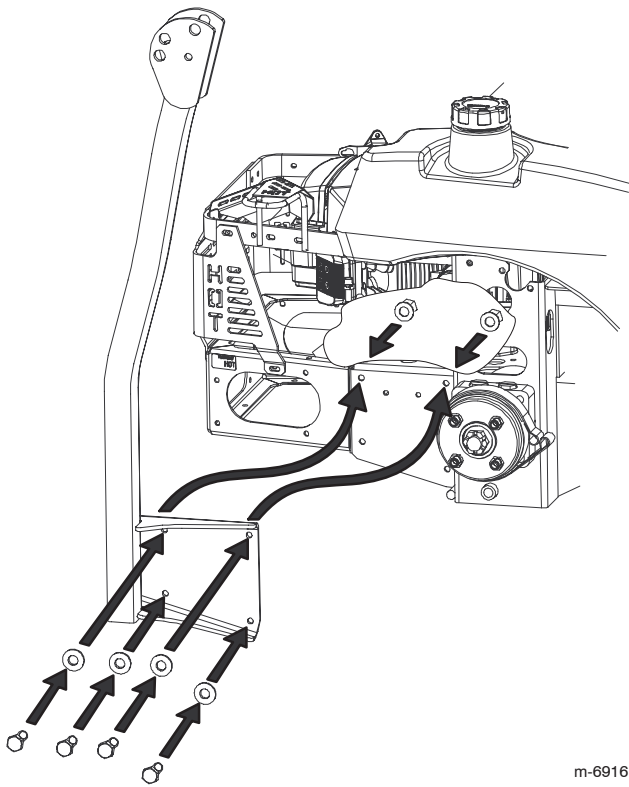

m-6916

2. Install the lanyard clips onto the 2 bolts (1/2 x 3-1/4 inches).

**Note:** Make sure the bent tab points toward the head of the bolt.

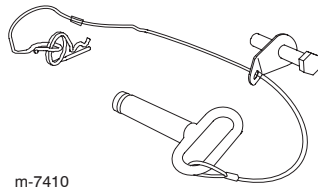

m-7410

3. Lightly oil the ends of the center roll bar section.

4. Loosely install the center roll bar section, using 2 bolts (1/2 x 3-1/4 inches) and 2 flange nuts (1/2 inch).

**Note:** Make sure the bolts are installed on the outside of the roll bar.

**Note:** Make sure the lanyard tab is installed as shown and points forward.

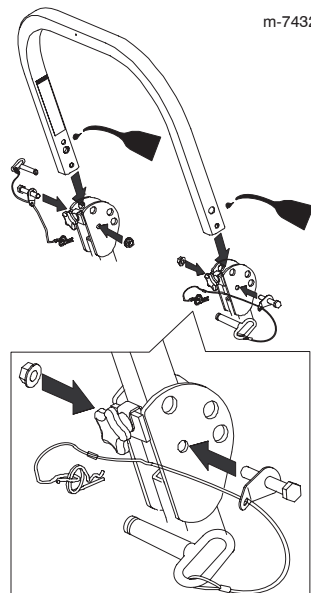

m-7432

5. Raise the roll bar into the upright position and secure it with the pins and hairpin cotter pins fastened to the lanyards.

6. Torque all the lower fasteners that are attached to the machine frame to 30 ft-lb.

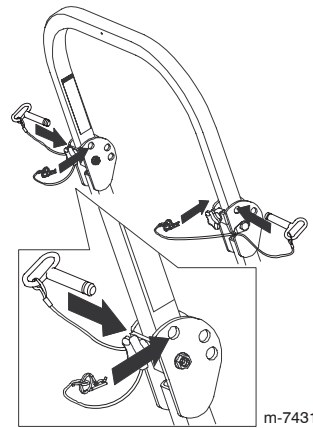

m-7431

7. Tighten the center roll bar bolts (1/2 x 3-1/4 inches) so that the roll bar rotates freely with some resistance.

**Note:** Make sure that no more than one thread is exposed outside the nut.

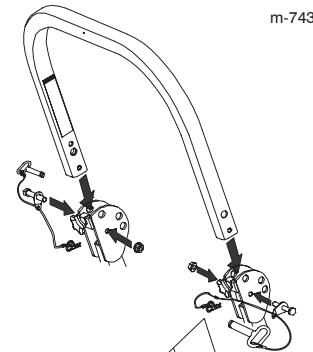

m-7432

8. Tighten the front handles against the center roll bar ends.

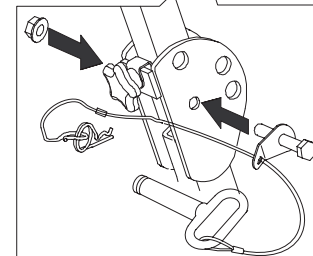

m-7406

**Step****6**

## Checking the Tire Pressure

### Parts Needed for This Step

None

### Procedure

Check the air pressure in the front and rear tires and make sure that they are set to 13 psi (90 kPa).

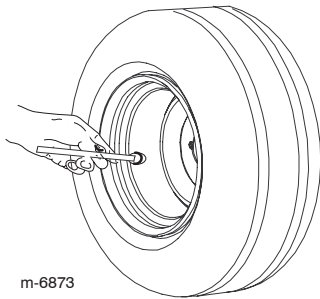

m-6873



