



Clutch Retainer Kit

Groundsmaster® 3200, 3300, or 3310 Series Traction Unit

Model No. 161-5097

Installation Instructions

Installation

1

Preparing the Machine

No Parts Required

Procedure

1. Park the machine on a level surface.
2. Engage the parking brake.
3. Lower the cutting unit.
4. Shut off the engine and remove the key.

2

Installing the Kit

Parts needed for this procedure:

1	Clutch strap
1	Bumper
2	Bolt
3	Nut

Removing the Existing Clutch Straps

Remove the hardware that secures the existing metal and rubber straps on the frame (Figure 1) and remove the straps.

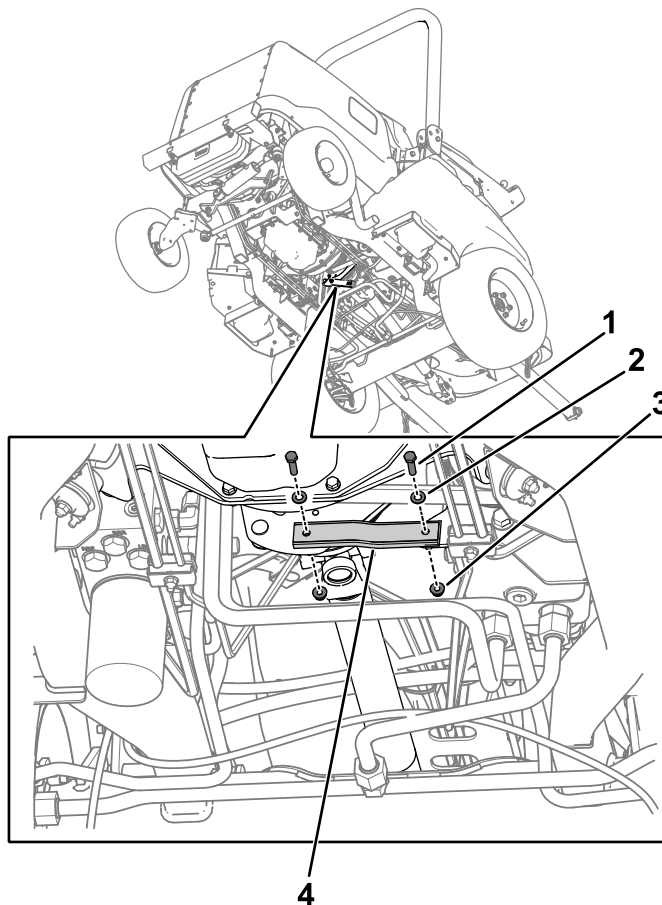

Figure 1

g506866

- | | |
|-----------|------------------|
| 1. Bolt | 3. Nut |
| 2. Washer | 4. Clutch straps |



Installing the New Clutch Strap

1. Use a nut to secure the bumper to the clutch (Figure 2).

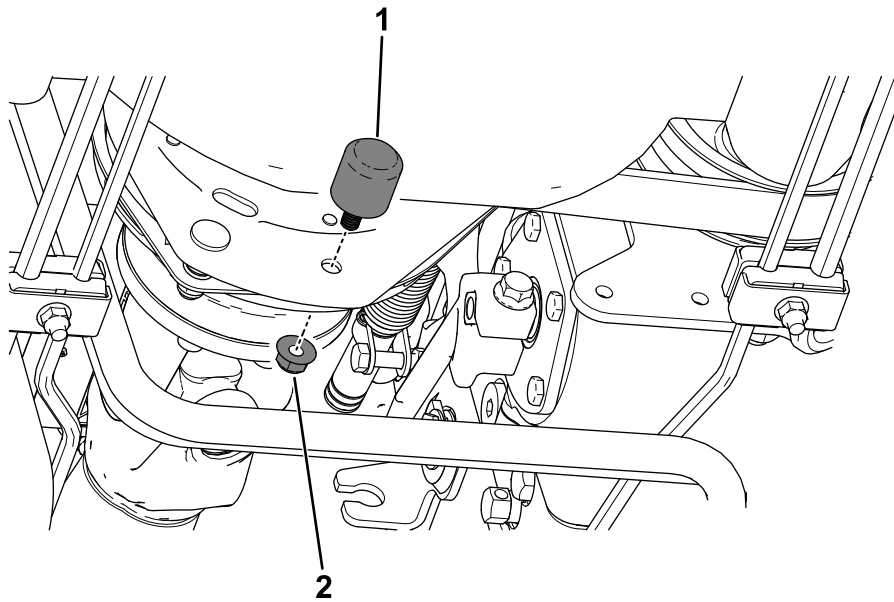

Figure 2

g506880

1. Bumper
2. Nut

-
2. Install the clutch strap to the bumper (Figure 3).

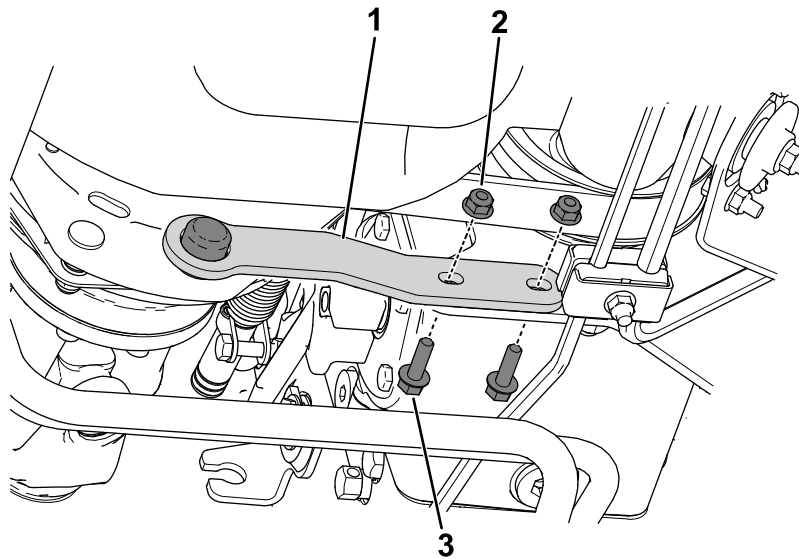

Figure 3

g507062

1. Clutch strap
2. Nut
3. Bolt

-
3. Use 2 nuts and 2 bolts to secure the clutch strap to the pump-mount bracket (Figure 3).