



TimeCutter[®] Z Mower

Setup Instructions

Form No. 3329-408

Use these instructions and procedures below when setting up this mower.

Important Refer to the *Operator's Manual* for complete details on safety, operation, maintenance, and the warranty.

Setup

- 1. Lift the seat and verify that the positive battery cable (red) is attached to the positive (+) battery terminal. This will require slightly lifting the red terminal boot on the battery end of the positive cable.
- 2. Attach the negative battery cable (black) to the negative (-) battery terminal with the bolt and wing nut supplied.

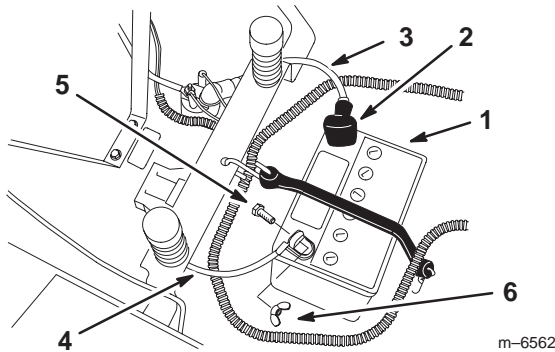

Figure 1

- | | |
|---------------------------|---------------------------|
| 1. Battery | 4. Negative battery cable |
| 2. Red terminal boot | 5. Bolt |
| 3. Positive battery cable | 6. Wing nut |

- 3. Check engine oil level and verify that oil level is close to, but not over the full mark on the engine dipstick.

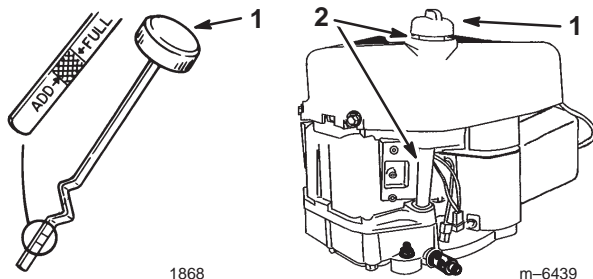

Figure 2

- | | |
|------------------------|----------------|
| 1. Engine oil dipstick | 2. Filler tube |
|------------------------|----------------|

- 4. Raise the mower height-of-cut lever to the highest height-of-cut position for easier removal from wooden skid.

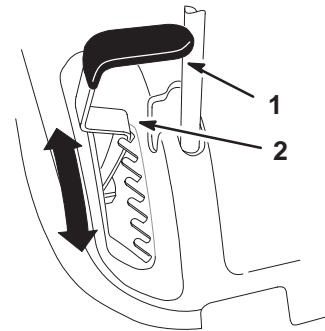

Figure 3

- | | |
|------------------------|---------------------|
| 1. Height-of-cut lever | 2. Highest position |
|------------------------|---------------------|

- 5. On the rear of the unit, push **both** hydro bypass levers forward, and then outward. Place the motion control levers in the center, unlocked position. Manually push the unit to the desired location. Never tow the Toro TimeCutter Z.

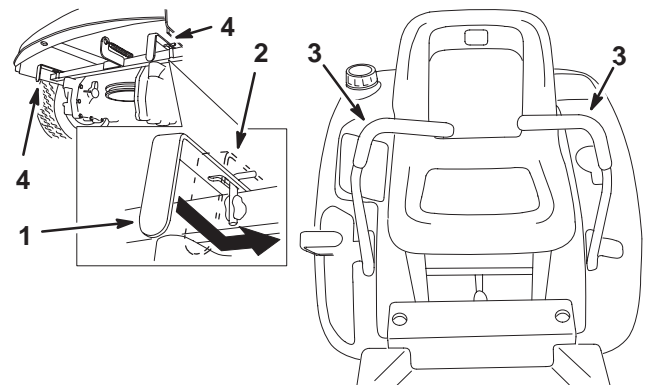

Figure 4

- | | |
|---------------------------------------|--|
| 1. Position for operating the machine | 3. Control levers in the center, unlocked position |
| 2. Position for pushing the machine | 4. Bypass lever |

- 6. Lower the height-of-cut lever to the lowest position.