



Striping Kit

44 inch and 52 inch Mid Size and Z Master[®] Mowers

Part No. 106-3370

Form No. 3329-363

Installation Instructions

Loose Parts

Note: Use the chart below to identify parts used for assembly.

Description	Qty.	Use
Mounting bracket	8	Installation of kit
Wiper	1	
Hex lock nut, 1/4 inch	8	
Hex head screw, 1/4 x 3/4 inch (19mm)	16	
Flat washer, 1/4 inch	8	
Speed nut, 1/4 inch	8	
Parts catalog	1	
Installation instructions	1	Read before installing

Modifying the Wiper

Use this procedure and appropriate figure for modifying the wiper for installation on each specific mower.

- Using the dimensions shown in the appropriate figure, locate, mark, and cut off excess material on wiper. Note the position and location of holes.

Note: Make sure to cut a 1/2 inch wide notch at locations specified.

Z Master Wipers

Z Master 100 Series 44 inch Mower

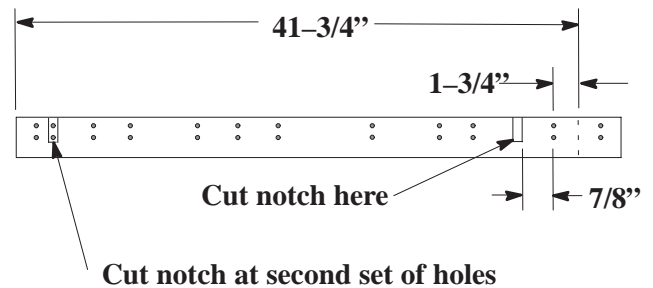

Figure 1

Z Master 100 and 200 Series 52 inch Mower

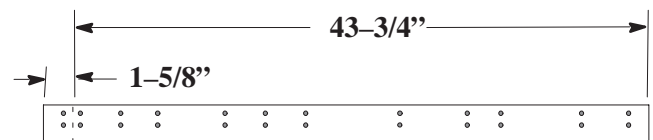

Figure 2

Mid Size Mower Wipers

If your Mid Size mower has a carrier frame and adjusting rod shown in Figure 3, use Figures 4 and 5 for modifying the wiper.

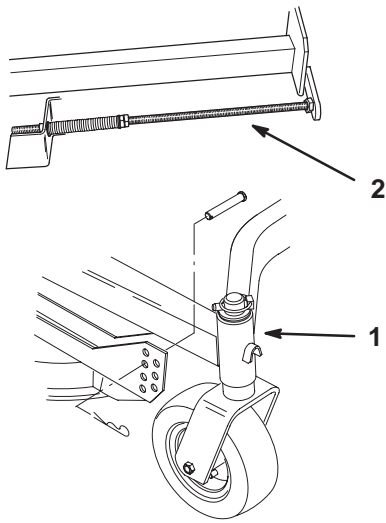

Figure 3

- 1. Carrier frame
- 2. Adjusting rod

44 inch Mid Size Mower (Mowers with serial numbers in the range of 21000000 thru 21999999)

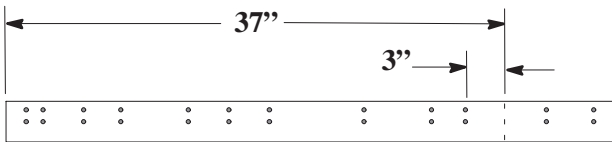

Figure 4

52 inch Mid Size Mower

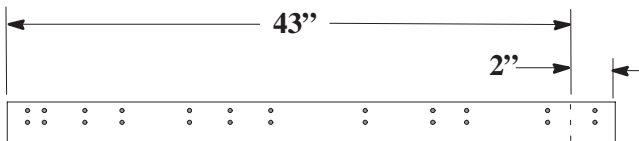

Figure 5

If your Mid Size mower has height-of-cut pegs as shown in Figure 6, use Figures 7, 8, and 9 for modifying the wiper.

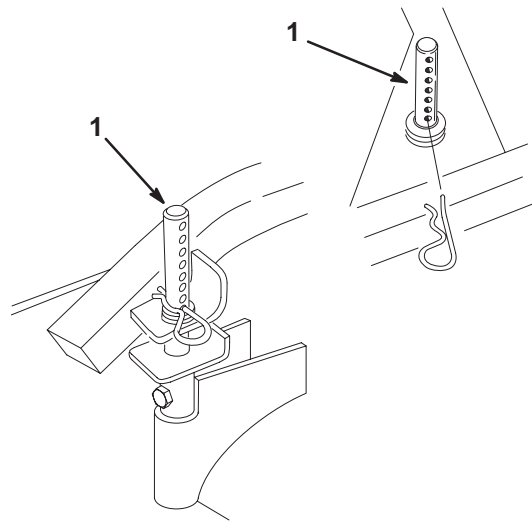

Figure 6

- 1. Height-of-cut peg

m-6365

44 inch Mid Size Mower (Serial No. 23000001 and up)

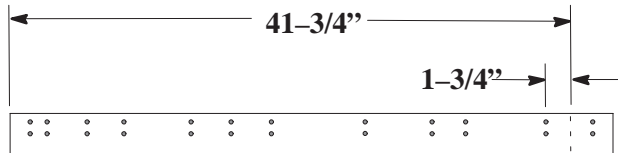

Figure 7

52 inch Mid Size Mower (Serial No. 23000001 and up)



Cut notch here (third set of holes)

Figure 8

52 inch Mid Size Mower (Mowers with serial numbers in the range of 21000000 thru 21999999)



Cut notch here

Figure 9

Installing the Wiper to Mower

1. Install the speed nuts on each of the mounting brackets as shown in Fig. 10.

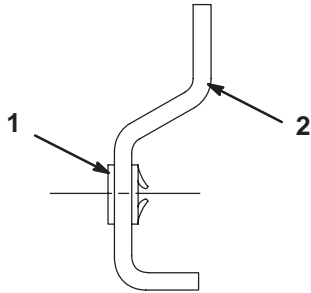

Figure 10

1. 1/4-20 Speed nut
2. Mounting bracket

2. Use the following list to determine which mounting holes are to be used for installing mounting brackets to wiper.

Note: Hole numbers are determined from left end of wiper.

Mower Type	Wiper Holes Used
Z Master 200 –52 inch Mower	1, 3, 5, 7, 9,10 and 11
Z Master 100 –44 inch Mower	1, 4, 6, 8, 9 and 11
Z Master 100 –52 inch Mower	1, 3, 4, 6, 7, 9, 10 and 11
44 inch Mid Size Mower (Serial numbers 210000000 thru 219999999)	1, 3, 5, 7, 8 and 10
44 inch Mid Size Mower (Serial Number 230000001 and Up)	1, 3, 5, 7, 8, 10 and 11
52 inch Mid Size Mower (Serial numbers 210000000 thru 219999999)	1, 3, 4, 5, 7, 8, 10 and 11
52 inch Mid Size Mower (Serial Number 230000001 and Up)	1, 4, 5, 7, 8, 10, 11 and 12

3. Using flat washers and 1/4 x 3/4 inch (19 mm) screws, loosely attach the mounting brackets (with speed nuts assembled) to the appropriate holes in wiper (Fig. 11)

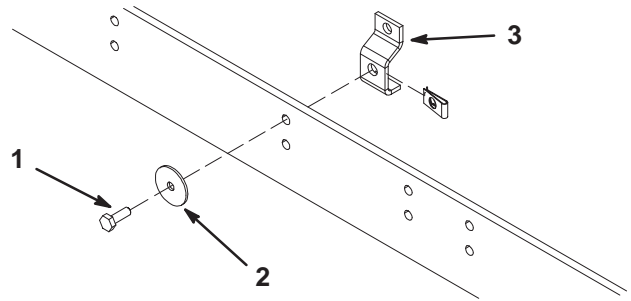

Figure 11

1. 1/4-20 x 3/4" (19 mm) screw
2. Flat washer
3. Mounting bracket w/speed nut

4. Align the brackets vertical to the wiper and tighten the screws.

Note: Use the upper holes for greater striping effect and the lower holes for less effect.

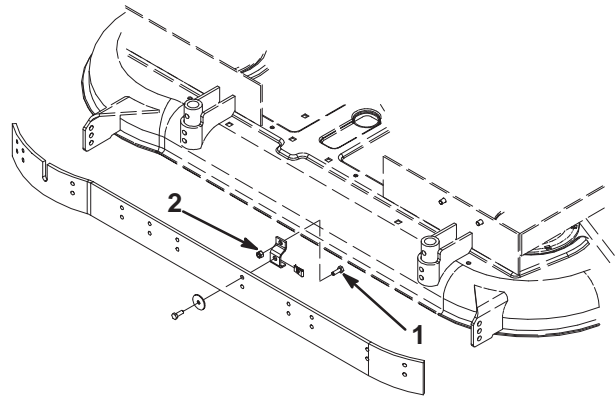

Figure 12

1. 1/4-20 x 3/4" (19 mm) screw
2. 1/4-20 lock nut

5. Center the wiper, with the mounting brackets assembled, against the rear of the deck. Position the lower leg of each mounting bracket under and up tight against the bottom lip of the rear deck wall.
6. Using each mounting bracket as a template, locate, mark and drill 9/32 inch diameter holes in the mower deck.
7. Secure mounting brackets to mower deck with 1/4 x 3/4 inch (19 mm) screws and 1/4 inch lock nuts. Screw heads to be positioned so the heads are on the inside of the deck and nuts to the outside as shown in Fig. 12.

