



12V Power Adapter Kit

Model No. 161-6720

Installation Instructions

Installation

Loose Parts

Use the chart below to verify that all parts have been shipped.

Procedure	Description	Qty.	Use
1	Receptacle harness Power port	1 1	Install the Power Adapter Kit.

▲ WARNING

While maintenance or adjustments are being made, someone could start the engine. Accidental starting of the engine could seriously injure you or other bystanders.

Remove the key from the ignition switch, engage parking brake, and pull the wire(s) off the spark plug(s) before you do any maintenance. Also push the wire(s) aside so it does not accidentally contact the spark plug(s).

Note: Determine the left and right sides of the machine from the normal operating position.

Note: Park the unit on a level surface. Ensure that all moving parts have stopped, the parking brake is engaged, the key has been removed, and the spark-plug wire has been disconnected. Allow the unit to cool before starting these instructions.



1

Installing the Power Adapter Kit

Parts needed for this procedure:

1	Receptacle harness
1	Power port

Procedure

1. Ensure that all moving parts have stopped, the parking brake is engaged, and the key has been removed.
2. Lower the platform.
3. Lift and lock the thigh pad into place.
4. Remove the knockout from the control panel.

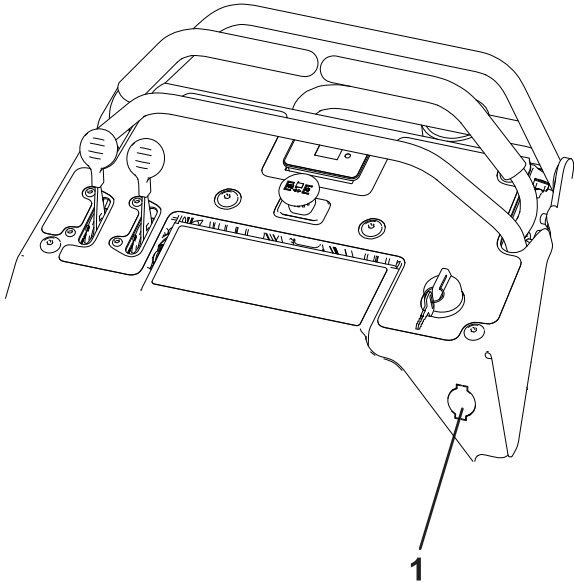

Figure 1

g479752

1. Knockout

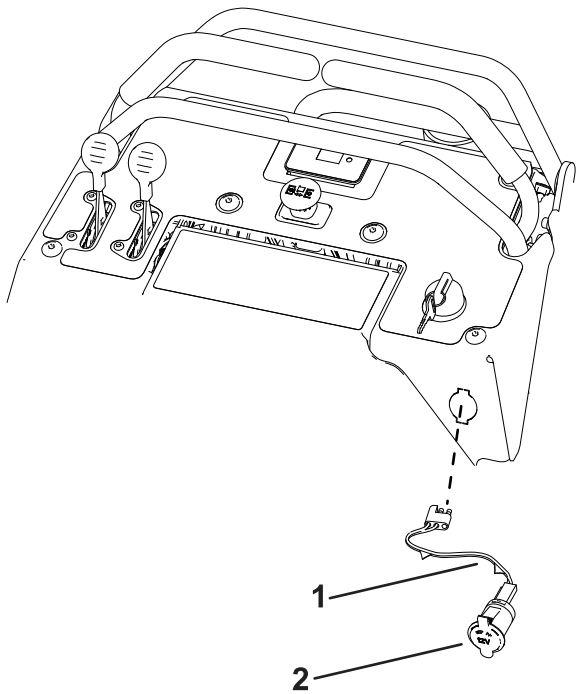

Figure 2

g479748

1. Receptacle harness
2. Power port

6. Seat the receptacle and push it into the control panel.
7. Locate the accessory end of the main wire harness and remove the cap.
8. Plug the receptacle harness into the accessory end of the main harness.
9. Lower the thigh pad.

5. Insert the receptacle harness through the control panel opening.