

# Caster Wheel Kit

Model No. 147-8772

## Installation Instructions

# Installation

## Preparing the Machine

1. Park the machine on a level surface.
2. Disengage the blade-control switch.
3. Move the motion-control levers outward to the PARK position.
4. Shut off the engine and remove the key.
5. Wait for all moving parts to stop.
6. Raise the front of the machine so that the casters are off the ground. Support the machine using jack stands.

**Note:** Use jack stands rated for your machine. Refer to the *Operator's Manual* for your machine to determine the weight.

### **⚠ WARNING**

**Mechanical or hydraulic jacks may fail to support the machine and cause serious injury.**

**Use jack stands when supporting the machine.**

## Installing the Kit

1. Remove the existing caster wheel from the fork.
2. Use the fasteners to install the new caster wheel.

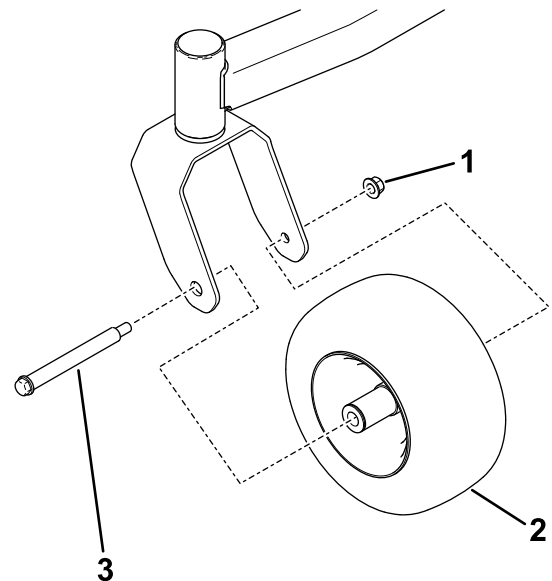

Figure 1

g468134

1. Existing nut
2. Caster wheel
3. Existing bolt

3. Torque the nut to 37 to 50 N·m (27 to 37 ft·lb).
4. Repeat the procedure for the other caster wheel.

