



# Transport Lock

## TimeCutter® Riding Mower

Model No. 161-4510

### Installation Instructions

## Installation

### Preparing the Machine

1. Park the machine on a level surface.
2. Disengage the blade-control switch.
3. Move the motion-control levers outward to the PARK position.
4. Shut off the engine and remove the key.
5. Wait for all moving parts to stop.
6. Allow machine components to cool.
7. Disconnect the spark plug.

### Removing the Floor Pan (MyRide® Machines Only)

Remove the floor pan before installing the kit (Figure 1).

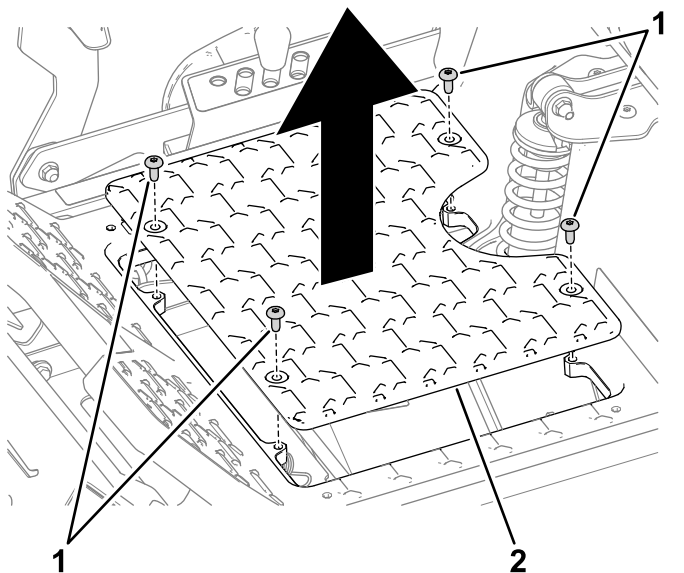

Figure 1

1. Remove Torx-head bolts
2. Floor pan

### Installing the Kit

**Note:** Determine the left and right sides of the machine from the normal operating position.

1. Set the height of cut of the machine to 102 mm (4 inches) or lower.
2. Remove the existing bolt from the height-of-cut bracket on the right side of the machine.

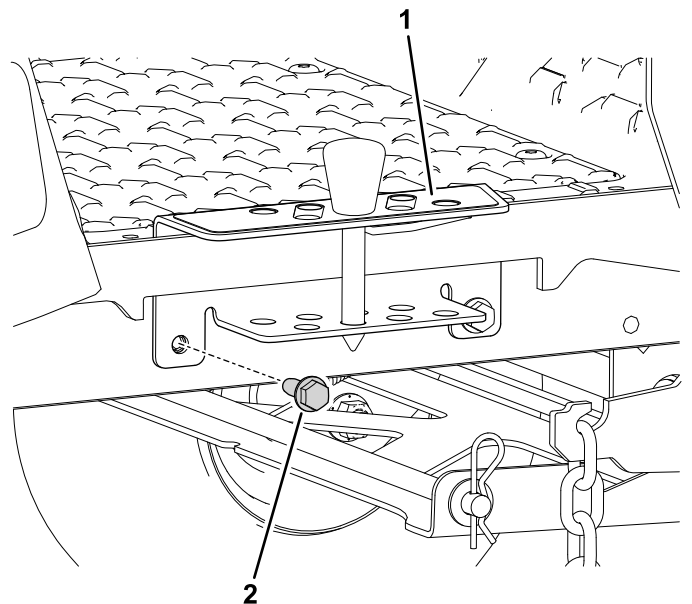
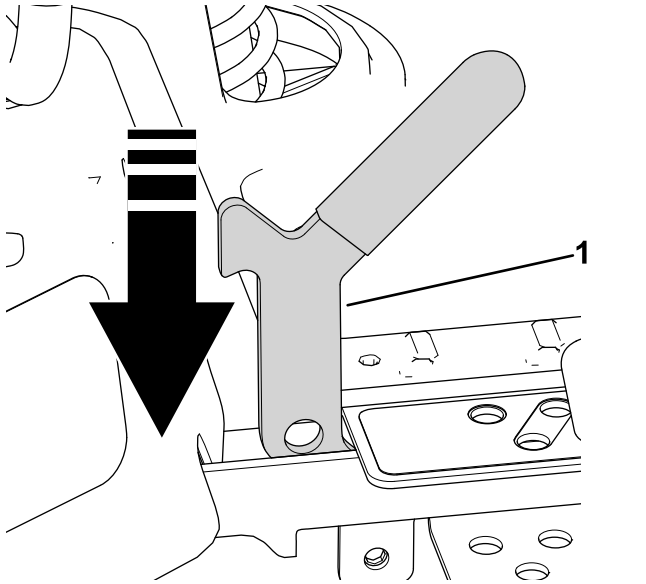

Figure 2

1. Height-of-cut bracket
2. Remove the existing bolt.



3. Insert the transport lock between the height-of-cut arm and the right side frame. Secure it using the provided fasteners (Figure 3).



g468167

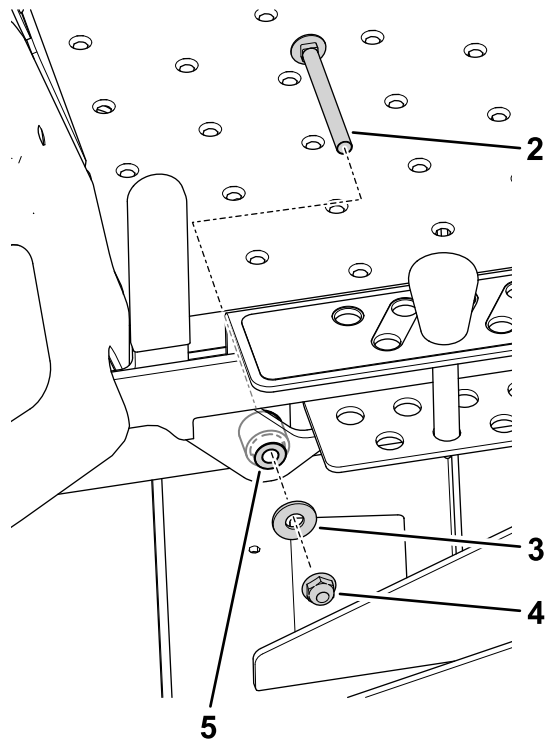

g468168

**Figure 3**

- |                   |            |
|-------------------|------------|
| 1. Transport lock | 4. Locknut |
| 2. Carriage bolt  | 5. Spacer  |
| 3. Washer         |            |

4. Torque the locknut to 20 to 25 N·m (175 to 225 in-lb).

## Installing the Floor Pan (MyRide® Machines Only)

Reverse the process in [Removing the Floor Pan \(MyRide® Machines Only\)](#) (page 1).

## Operation

### Engaging the Transport Lock

1. Push the deck-lift pedal with your foot all the way forward to raise the mower deck.
2. Lower the deck slowly until the transport lock is engaged.

### Releasing the Transport Lock

1. Push the deck-lift pedal forward with your foot.
2. Push and hold the transport lock forward to free the locking mechanism.
3. Lower the deck slowly until the lever contacts the height-of-cut pin.