



Assist Bar Kit

TimeCutter®/Titan® Riding Mower

Model No. 161-4450

Installation Instructions

Installation

Loose Parts

Use the chart below to verify that all parts have been shipped.

Description	Qty.	Use
No parts required	–	Prepare the machine.
Assist handle	1	Assemble the assist handle.
Pin (grooved)	1	
Washer (3/8 inch)	1	
Retaining ring	1	
Assist-handle bracket	1	Install the assist-handle bracket.
Hex flange-head bolt (thread-forming—5/16 x 3/4 inch)	2	
Pin (grooved)	1	Install the assist handle.
Washer (3/8 inch)	1	
Retaining ring	1	
Handle retainer	1	Install the handle retainer.
Shoulder screw (1/4 x 1/2 inch)	1	

Preparing the Machine

1. Park the machine on a level surface.
2. Disengage the blade-control switch.
3. Move the motion control levers outward to the PARK position.
4. Shut off the engine and remove the key.



Assembling the Assist Handle

1. Assemble the grooved pin through the hole in the assist handle as shown in [Figure 1](#).

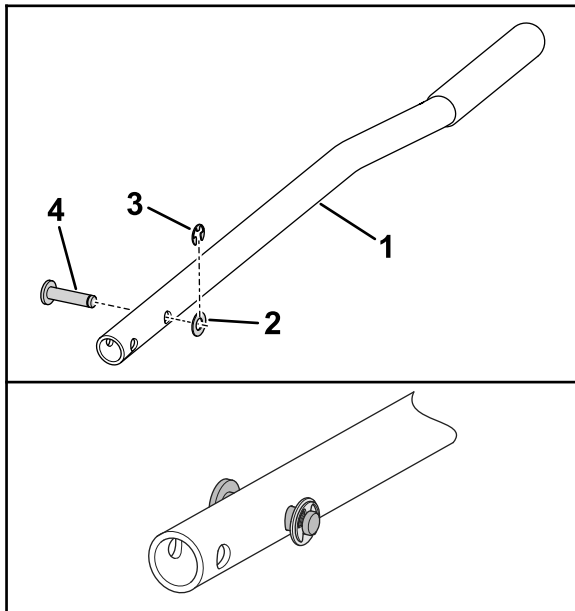

g464941

Figure 1

- | | |
|----------------------|-------------------|
| 1. Assist handle | 3. Retaining ring |
| 2. Washer (3/8 inch) | 4. Pin (grooved) |

2. Secure the pin to the handle with the washer (3/8 inch) and the retaining ring ([Figure 1](#)).

Installing the Assist-Handle Bracket

Measuring and Drilling Holes into the Frame Rail

1. Hold the assist-handle bracket against the left frame rail and position it according to the measurement for your particular model ([Figure 2](#)).

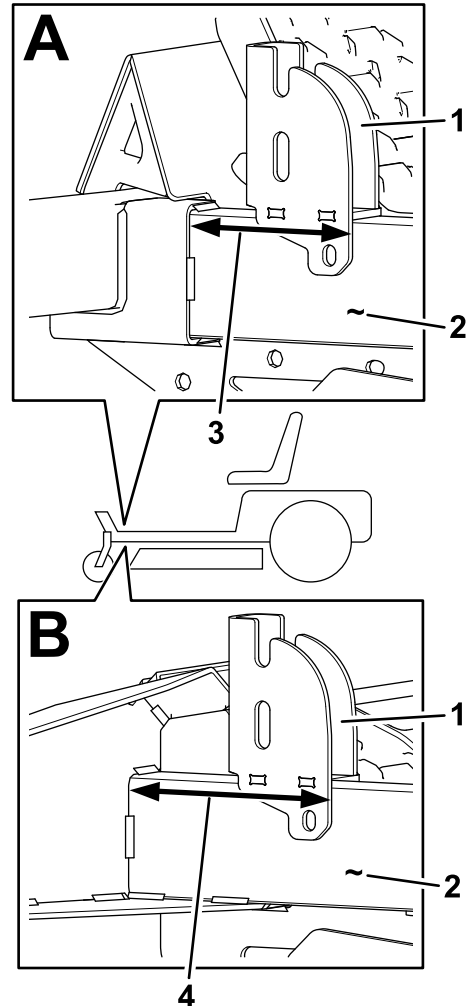

g464996

Figure 2

A: TimeCutter models. B: Titan models.

- | | |
|--------------------------|---------------------------|
| 1. Assist-handle bracket | 3. 113 mm (4-7/16 inches) |
| 2. Left frame rail | 4. 146 mm (5-3/4 inches) |

2. Using the assist-handle bracket as a template, draw marks through the holes onto the frame rail ([Figure 3](#)).

Installing the Assist Handle

1. Align the lower hole in the assist handle with the closed slot in the assist-handle bracket as shown in [Figure 5](#).

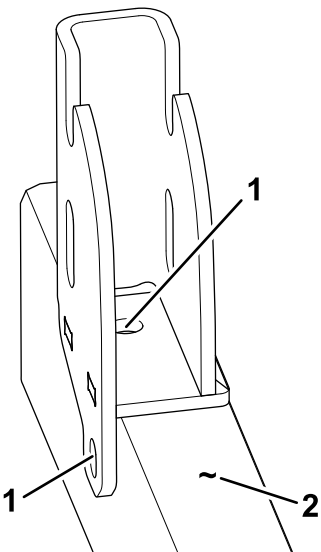

Figure 3

g465023

1. Mark and drill holes here. 2. Left frame rail

3. Drill holes at the marked locations using a drill bit (9/32 inch) as shown in [Figure 3](#).

⚠ WARNING

Using a drill without proper eye protection may allow debris to enter the eye, causing injury.

When drilling, always wear eye protection.

Securing the Bracket to the Frame Rail

Secure the bracket to the side of the left frame rail using 2 thread-forming hex flange-head bolts.

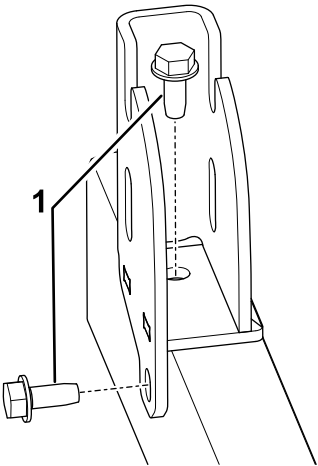

Figure 4

g465027

1. Hex flange-head bolt (thread-forming—5/16 x 3/4 inch)

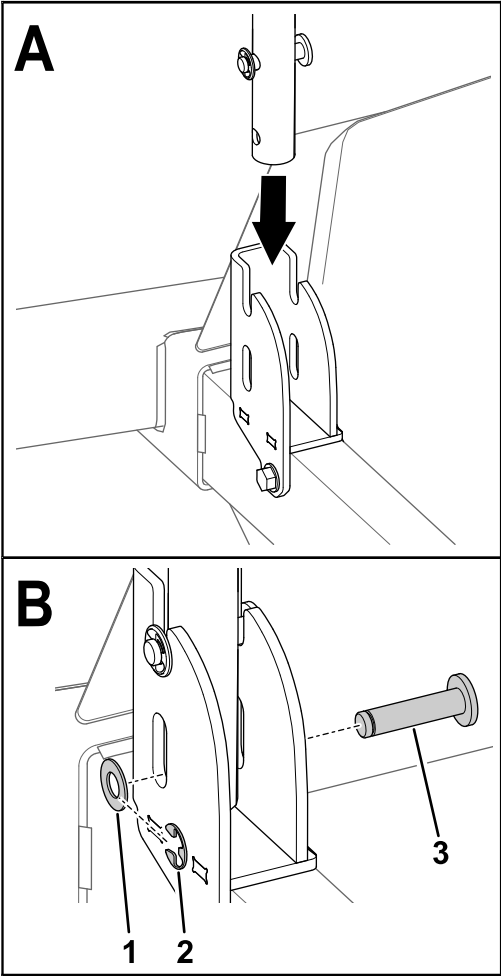

Figure 5

TimeCutter model shown

g465144

1. Washer (3/8 inch)
2. Retaining ring
3. Pin (grooved)

2. Assemble the grooved pin through the slot in the bracket and the hole in the assist handle ([Figure 5](#)).
3. Secure the pin to the bracket and handle with the washer (3/8 inch) and the retaining ring ([Figure 5](#)).

Installing the Handle Retainer

1. Remove the existing shoulder screw that secures the left pod the machine (Figure 6).

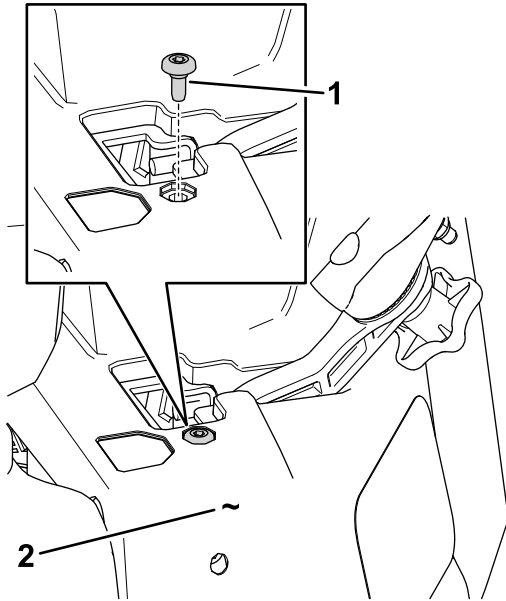

Figure 6

g465175

1. Existing shoulder screw
2. Left pod

2. Align the handle retainer to the left pod as shown in Figure 7.

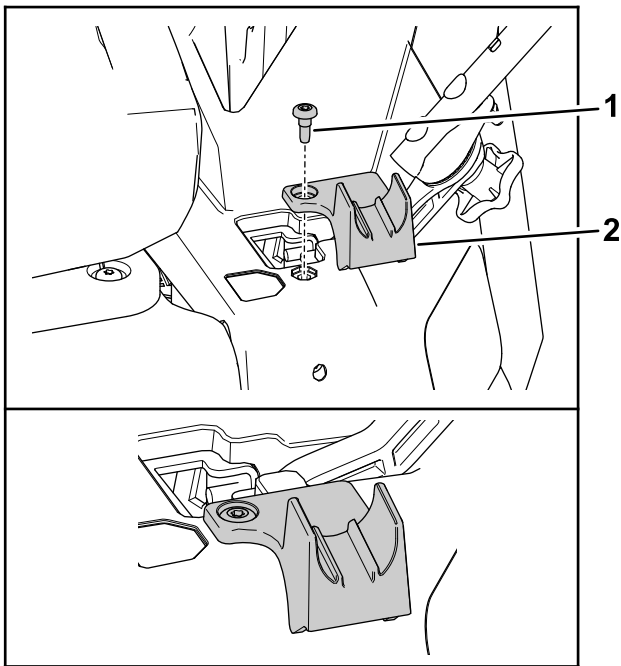

Figure 7

g465176

1. Shoulder screw (1/4 x 1/2 inch)
2. Retainer

Operation

Extending the Assist Handle

Rotate the assist handle to the extend position when the machine is stationary and you are getting on and off the machine.

1. Rotate the assist handle as shown in [Figure 8](#).

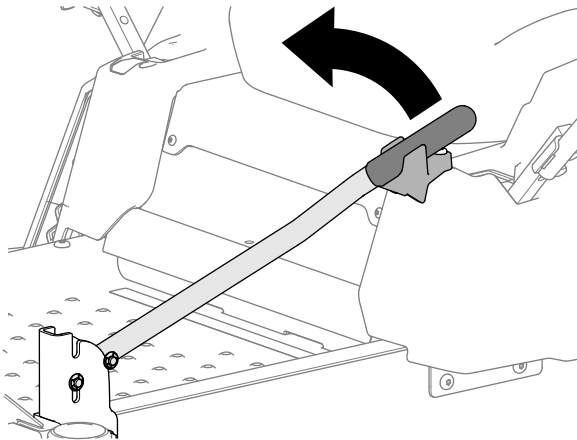

Figure 8

g465177

2. Lower the assist handle as shown in [Figure 9](#).

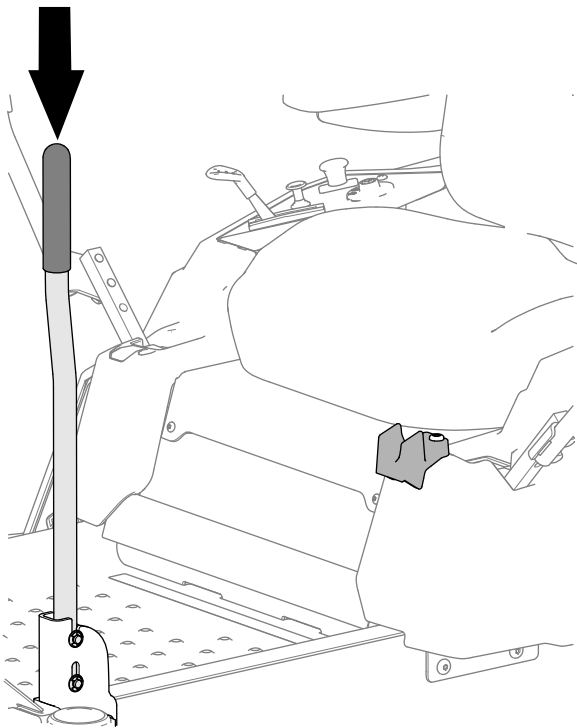

Figure 9

g465178

3. Ensure that the assist handle is fully seated in the bracket slots as shown in [Figure 10](#).

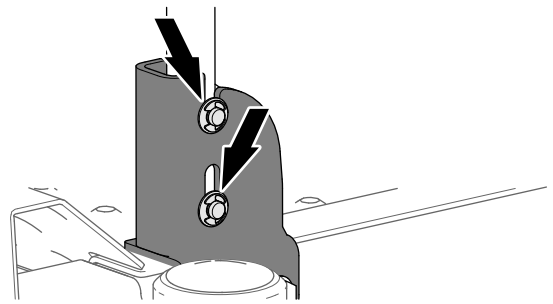

Figure 10

g465179

Stowing the Assist Handle

Important: Rotate the assist handle to the stow position when operating the machine.

1. Lift the assist handle as shown in [Figure 11](#).

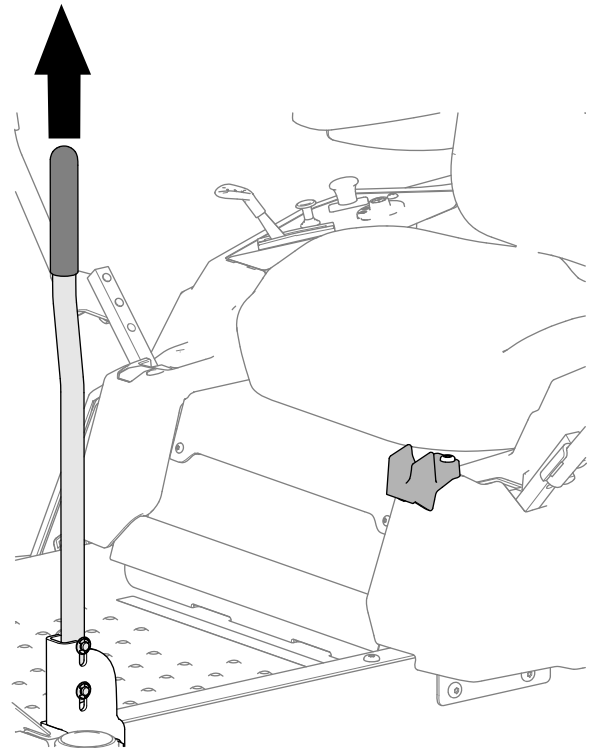

Figure 11

g465190

2. Fully rotate the assist handle as shown in [Figure 12](#).

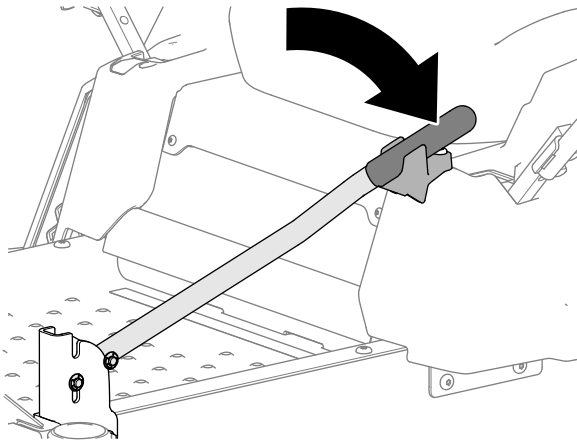

Figure 12

g465191

Notes:



Count on it.