



LED Light Kit

TimeCutter® Max or TITAN® Riding Mower

Model No. 147-8757

Installation Instructions

Installation

Loose Parts

Use the chart below to verify that all parts have been shipped.

Description	Qty.	Use
No parts required	–	Prepare the machine.
Light bracket	1	Install the LED Light Kit.
Hex-washer-head thread forming screw (5/16 x 3/4 inch)	2	
LED light	1	
Hex-washer-head screw	2	
Wire harness	1	
Cable tie	1	

Preparing the Machine

Gas Models Only

1. Park the machine on a level surface.
2. Disengage the blade-control switch.
3. Move the motion-control levers outward to the PARK position.
4. If equipped, engage the parking brake.
5. Shut off the machine and remove the key.
6. Wait for all moving parts to stop.
7. Allow machine components to cool.

Electric Models Only

1. Park the machine on a level surface.
2. Disengage the blade-control switch.
3. Move the motion-control levers outward to the NEUTRAL position.
4. Engage the parking brake.
5. Shut off the machine and remove the key.
6. Wait for all moving parts to stop.
7. Allow machine components to cool.
8. Remove the battery packs from the machine.



Installing the LED Light Kit

Note: For installation assistance, contact an Authorized Service Dealer.

1. Install the light bracket onto the front of the machine using the 2 hex-washer-head thread forming screws (5/16 x 3/4 inch).

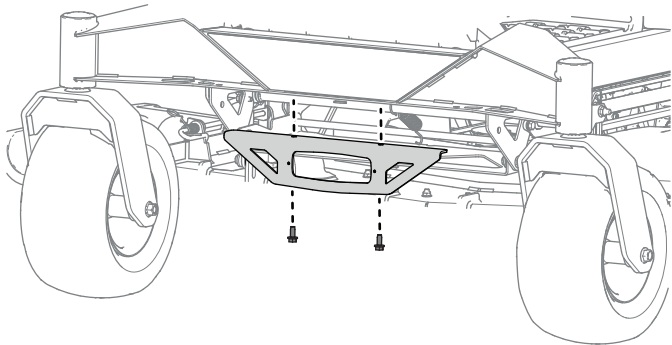

Figure 1

g468945

2. Install the light to the light bracket using the 2 hex-washer-head screws.

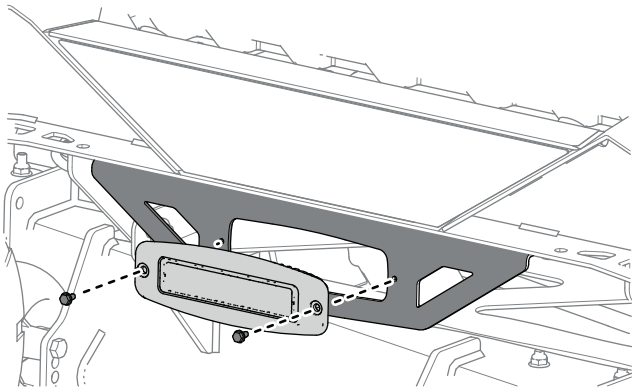

Figure 2

g468946

3. Connect the wire harness to the back of the lights and secure the harness to the front frame rail using the harness clip.

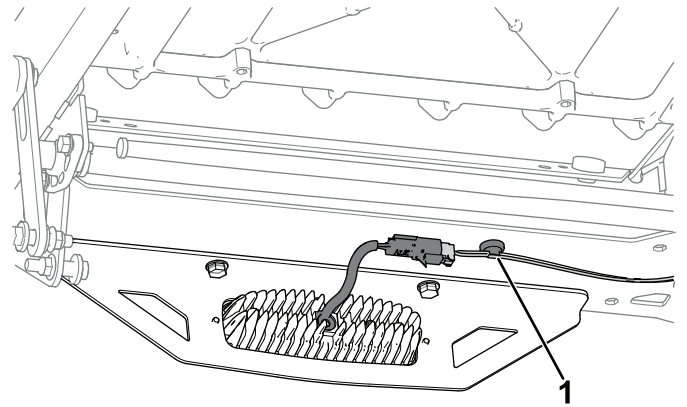

Figure 3

g468947

1. Harness clip

4. Route the wire harness along the right frame rail, while securing the harness clips to the rail.

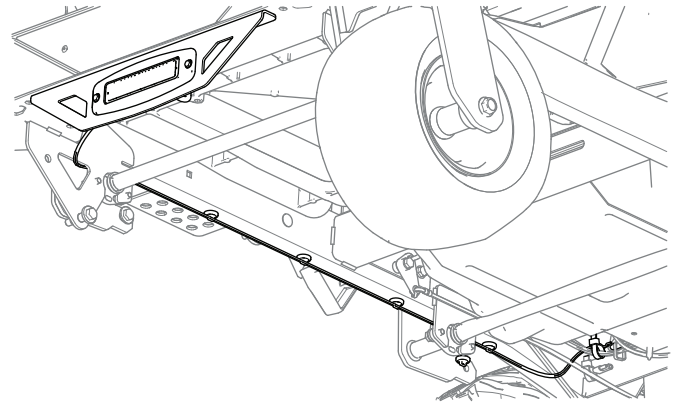

Figure 4

g468948

5. Cut the cable tie securing the auxiliary connector off the main harness and remove the auxiliary end plug.
6. Connect the light harness to the auxiliary connector.
7. Secure the kit wire harness to the machine wire harness using the cable tie.
8. **Electric machines only:** install the batteries.