



# Switch Panel

## Groundsmaster® e3200 2-Wheel Drive Traction Unit with Universal Sunshade

Model No. 32314

### Installation Instructions

# Installation

## Loose Parts

Use the chart below to verify that all parts have been shipped.

Procedure	Description	Qty.	Use
<b>1</b>	No parts required	–	Prepare the machine.
<b>2</b>	No parts required	–	Remove the sunshade.
<b>3</b>	Decal Switch panel Plug	1 1 4	Prepare the switch panel.
<b>4</b>	Wire harness Carriage bolt Nut Cable tie	1 4 4 6	Install the switch panel to the sunshade frame.
<b>5</b>	No parts required	–	Install the sunshade.
<b>6</b>	No parts required	–	Complete the installation.



# 1

## Preparing the Machine

No Parts Required

### Procedure

1. Park the machine on a level surface.
2. Ensure that the parking brake is engaged; refer to your *Operator's Manual*.
3. Lower the cutting unit (if equipped).
4. Shut off the machine and remove the key.
5. Turn the battery-disconnect switch to the OFF position.

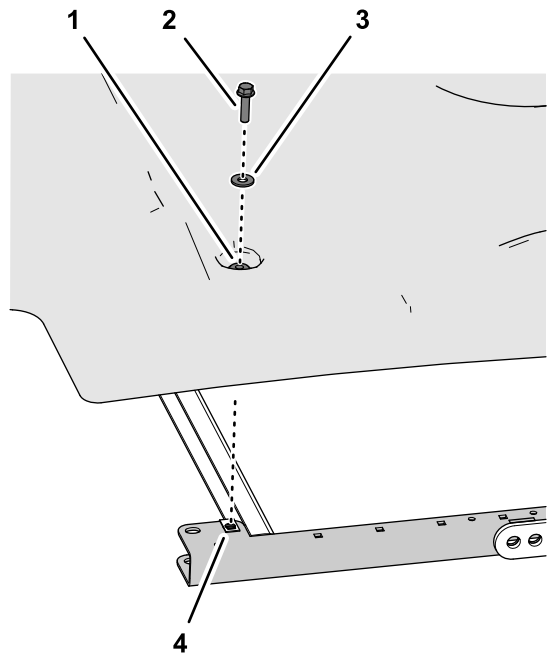

Figure 2

g244328

- |   |                                  |
|---|----------------------------------|
| 1. Grommet                                | 3. Washer (5/16 inch)            |
| 2. Flange-head bolt (5/16 x 1-1/4 inches) | 4. Clip nut (side-frame channel) |

# 2

## Removing the Sunshade

No Parts Required

### Procedure

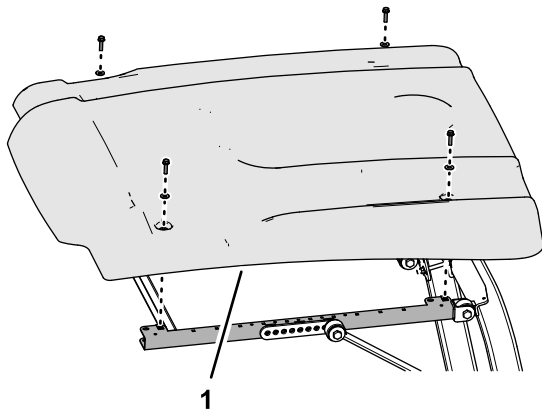

Figure 1

g244329

1. Sunshade

2. Remove the sunshade from the machine (Figure 1).

# 3

## Preparing the Switch Panel

Parts needed for this procedure:

1	Decal
1	Switch panel
4	Plug

### Installing the Decal to the Switch Panel

1. Carefully remove the backing from the decal (Figure 3).

1. Remove the 4 flange-head bolts (5/16 x 1-1/4 inches) and 4 washers (5/16 inch) that secure the sunshade to the side-frame channels (Figure 1 and Figure 2).

**Note:** Do not remove the grommets from the sunshade.

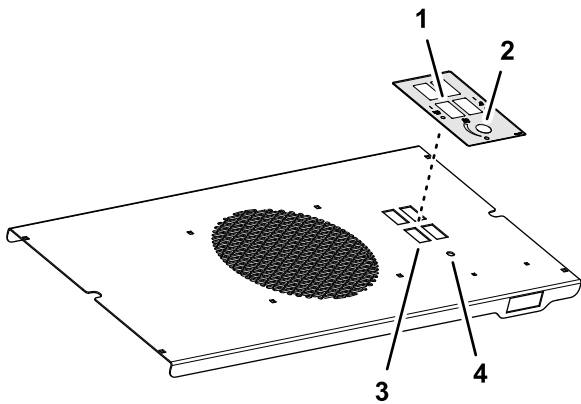

**Figure 3**

g245155

1. Rectangular opening (decal)
2. Hole (decal)
3. Rectangular opening (switch panel)
4. Hole (switch panel)

2. Align the rectangular openings and hole in the decal with the rectangular openings and hole in the switch panel as shown in [Figure 3](#).
3. Apply the decal to the switch panel.

## Installing the Plugs to the Switch Panel

1. Align the plug to the rectangular openings in the switch panel ([Figure 4](#)).

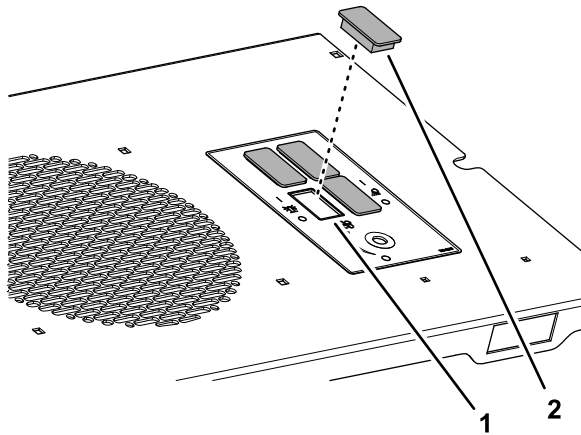

**Figure 4**

g245156

1. Rectangular opening (switch panel)
2. Plug

2. Insert the plug into the opening until the plug snaps securely into the panel ([Figure 4](#)).
3. Repeat step 1 and 2 for the 3 other plugs ([Figure 4](#)).

# 4

## Installing the Switch Panel to the Sunshade Frame

Parts needed for this procedure:

1	Wire harness
4	Carriage bolt
4	Nut
6	Cable tie

## Aligning the Wire Harness to the Switch Panel

Align the wire harness to the switch panel as shown in [Figure 5](#).

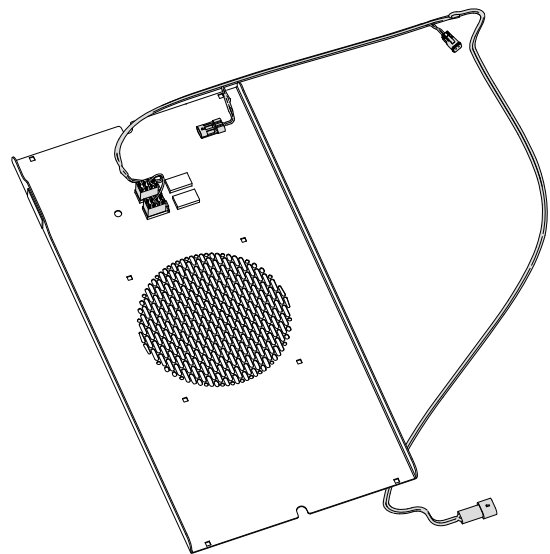
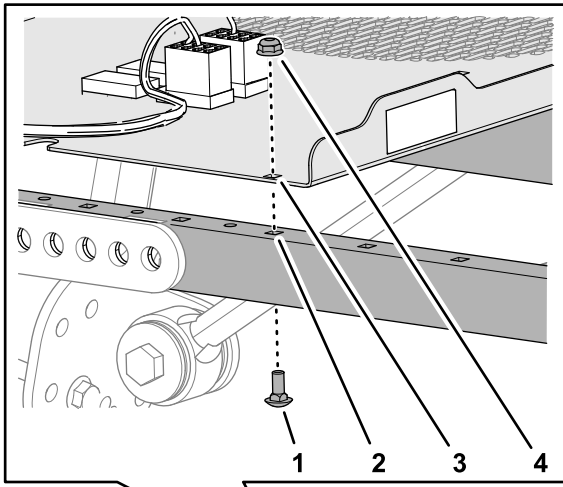

**Figure 5**

g466095

## Assembling the Switch Panel to the Sunshade Frame

1. Align the square holes in the switch panel with the square holes in the 2 side-frame channels of the sunshade as shown in [Figure 6](#).



**Figure 6**

g465133

- |                                     |                               |
|-------------------------------------|-------------------------------|
| 1. Carriage bolt                    | 3. Square hole (switch panel) |
| 2. Square hole (side-frame channel) | 4. Nut                        |

2. Assemble the switch panel to the side-frame channels (Figure 6) with the 4 carriage bolts and 4 nuts.
3. Torque the nuts to 419 to 513 N·cm (37 to 47 in-lb).

## Routing the Wire Harness

1. Route the wire harness of the switch panel kit along the roll-bar tube as shown in Figure 7.

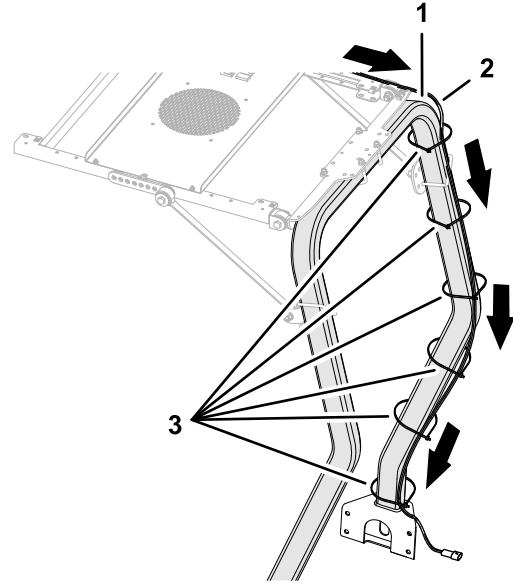
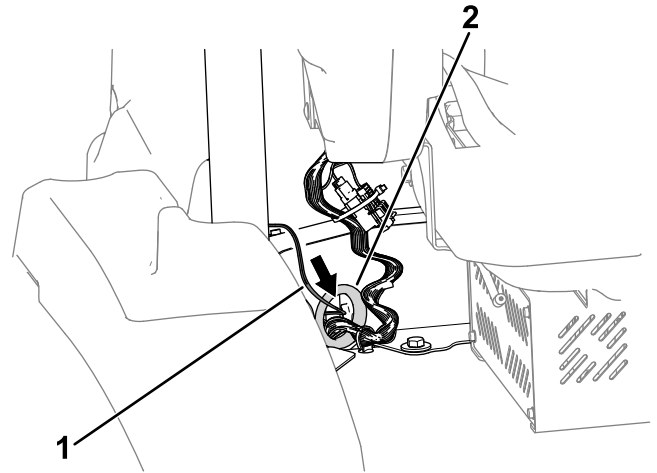

**Figure 7**

g245157

- |                     |               |
|---------------------|---------------|
| 1. Roll-bar tube    | 3. Cable ties |
| 2. Kit wire harness |               |

2. Route the wire-harness end labeled P08 through the platform grommet (Figure 8).



**Figure 8**

g453224

- |                 |                     |
|-----------------|---------------------|
| 1. Wire harness | 2. Platform grommet |
|-----------------|---------------------|

3. Secure the wire harness to the roll-bar tube with the cable ties as needed (Figure 7).
4. Raise the hood and connect the kit wire-harness connector labeled P08—WORK LIGHT KIT POWER to the machine wire-harness connector labeled P19—WORK LIGHT KIT POWER.

**Note:** The P19 connector is located above the hydraulic-tank cap.

# 5

## Installing the Sunshade

No Parts Required

### Procedure

1. Align the holes in the grommets of the sunshade with the 4 clipnuts of the side-frame channels.
2. Assemble the sunshade to the frame channels (Figure 9) with the 4 flange-head bolts (5/16 x 1-1/4 inches) and 4 washers (5/16 inch) that you removed in [2 Removing the Sunshade \(page 2\)](#).

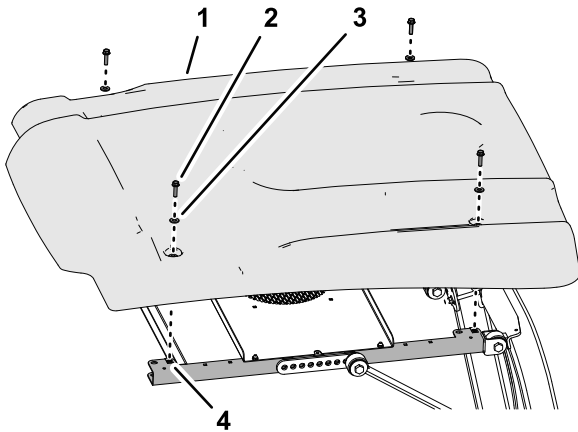

g245179

Figure 9

- |   |                                  |
|---|----------------------------------|
| 1. Sunshade                               | 3. Washer (5/16 inch)            |
| 2. Flange-head bolt (5/16 x 1-1/4 inches) | 4. Clip nut (side-frame channel) |

- 
3. Torque the flange-head bolts to 1017 to 1355 N·cm (90 to 120 in-lb).

# 6

## Completing the Installation

No Parts Required

### Procedure

Turn the battery-disconnect switch to the ON position.

# Notes:

**Notes:**



**Count on it.**