



# Multi Pro® 1750 Turf Sprayer

Model No. 41188—417400000 and Up

## Software Guide

The InfoCenter display shows information about your machine such as the operating status, various diagnostics and other information about the machine. There are multiple screens on the display. You can switch between the screens, at any time, by pressing the back button and then using the up and down directional buttons.

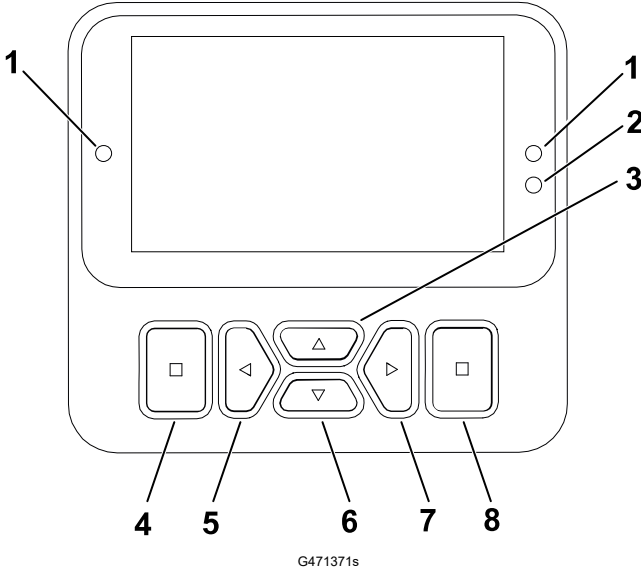

- ① Indicator light
- ② Display brightness sensor
- ③ Navigation button—up
- ④ Back button
- ⑤ Navigation button—decrease/left
- ⑥ Navigation button—down
- ⑦ Navigation button—increase/right
- ⑧ Enter button

**Note:** The purpose of each button may change depending on what is required at the time. Each button is labeled with an icon displaying its current function.



# InfoCenter Display Icons

	Menu
	Scroll up/down
	Scroll left/right
	Previous screen
	Decrease value
	Increase value
	Accept
	Save
<b>PIN</b>	PIN passcode
	Exit (faults) menu
	Battery voltage
	The parking brake is on.
	Sit in the seat.
	Hour meter
	Locked
	Brake lock
	Speed lock

	Tank is empty (less than 10% volume)
	Tank volume is low (10% to 29%)
	Tank volume is half full (30% to 69%)
	Tank volume is full (70% to 100%)
<b>±1</b>	Increase the tank volume by 1 gallon
<b>±10</b>	Increase the tank volume by 10 gallons
<b>±25</b>	Increase the tank volume by 25 Liters
	Boom is off
	Boom is active
	Clear all areas
	Clear active area
	Areas sprayed
	All areas screen
	Navigate to a sprayer area
	Throttle lock

# Overview of the Menus

To access the InfoCenter display menu system, press the back button while at the main screen. This brings you to the main menu. Refer to the following tables for a synopsis of the options available from the menus.

🔒 Protected under Protected Menus—accessible only by entering PIN

## Main Menu

Menu Item	Description
Calibration	The Calibration menu assists in calibration of the flow meter and speed sensor; refer to your <i>Multi Pro Operator's Manual</i> .
Settings	The Settings menu allows you to customize and modify the display configuration variables.
Machine Settings	The Machine Settings menu allows you to configure machine variables.
Service	The Service menu contains information on the machine such as hours of use and machine faults.
Diagnostics	The Diagnostics menu displays the state of each machine switch, sensor, and control output. You can use this to troubleshoot certain issues as it quickly tells you which machine controls are on and which are off.
About	The About menu lists the model number, serial number, and software version of your machine.



## Calibration

Menu Item	Description
Test Speed	Sets the test speed for calibration.
Flow Cal	Calibrates the flow meter.
Speed Cal	Calibrates the speed sensor.
Use Flow Cal Default	Resets the flow calibration to the default calculated average, not the actual volume.
Use Speed Cal Default	Resets the speed calibration to the default calculated average, not the actual speed.





## Settings

Menu Item	Description
Enter PIN	Allows a person (superintendent/mechanic) authorized by your company with the PIN code to access protected menus.
Backlight	Controls the brightness of the LCD display.



## Settings (continued)

Menu Item	Description
Language	Controls the language used on the display*.
Units	Controls the units used on the display (Imperial, Turf, or Metric).
Protected Menus 	Grants access to protected menus.
Protect Settings 	Allows the ability to change the settings in the protected settings.

## Machine Settings

Menu Item	Description
Tank Alert	Sets the low tank volume alert.
Hill Assist	Enables or disables the hill assist feature.
Geolink 	Satellite navigation option
Left Boom 	Adjusts the width of the left section.
Center Boom 	Adjusts the width of the center section.
Right Boom 	Adjusts the width of the right section.
Reset Defaults 	Resets the default values.



## Service

Menu Item	Description
Faults	The Faults menu contains a list of the recent machine faults. Refer to the <i>Service Manual</i> or contact your authorized Toro distributor for more information on the Faults menu and the information contained there.
Hours	Lists the total number of hours that the machine, engine and PTO have been on, as well as the number of hours the machine has been transported and service due.
Flow Rate 	Displays the current flow rate.
Flow Cal Value 	Displays the current multiplier used to calculate the difference between the assumed flow and the calibrated flow.
Speed Cal Value 	Displays the current multiplier used to calculate the difference between the assumed speed and the calibrated speed.

## Diagnostics

Menu Item	Description
Pumps	Accesses the pump inputs, momentary rinse, and time rinse options.
Booms	Accesses the boom inputs and outputs.
Throttle Lock	Accesses the throttle lock inputs and outputs.
Engine Run	Accesses the engine run inputs and outputs.

## About

Menu Item	Description
Model	Lists the model number of the machine.
SN	Lists the serial number of the machine.
S/W Revision	Lists the software revision of the primary controller.
InfoCenter S/W Revision 	Lists the software revision of the InfoCenter.
ICAN Bus 	Lists the CAN Bus

## Protected Menus

There are operating configuration settings that are adjustable within **Settings** of the display. To lock these settings, use the **Protected Menu**.

**Note:** At the time of delivery, the initial password code is programmed by your distributor.

## Accessing Protected Menus

**Note:** The factory default PIN code for your machine is either 0000 or 1234.

If you changed the PIN code and forgot the code, contact your authorized Toro distributor for assistance.

1. From the **Main Menu**, scroll down to **Settings** and press the select button.

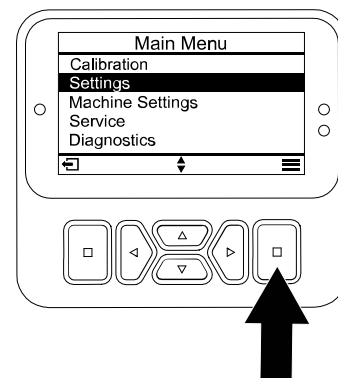

G510565

## Accessing Protected Menus (continued)

2. In **Settings**, scroll to **Enter PIN** and press the select button (A).
3. To enter the PIN code, press the up/down navigation buttons (B) until the correct first digit appears, then press the right navigation button (C) to move on to the next digit. Repeat this step until the last digit is entered.
4. Press the select button (D).

**Note:** If the display accepts the PIN code and the protected menu is unlocked, the word "PIN" displays in the upper right corner of the screen.

5. To lock the protected menu, rotate the key switch to the OFF position and then to the ON position.

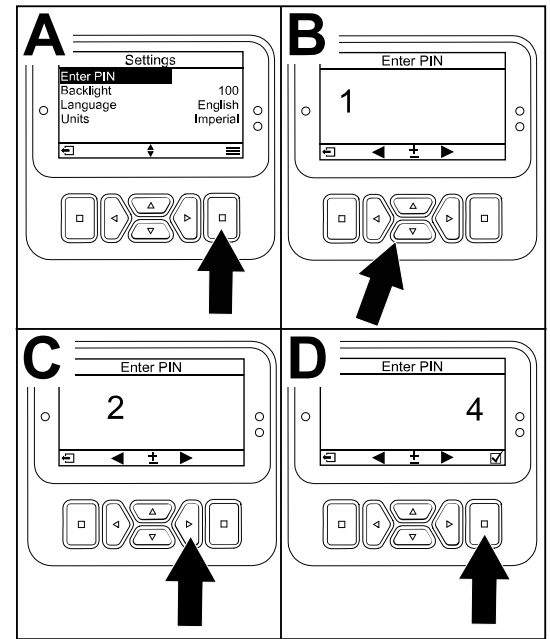

G510564

## Viewing and Changing the Protected Menu Settings

1. In **Settings**, scroll down to **Protect Settings**.
2. To view and change the settings without entering a PIN code, use the select button to change the **Protect Settings** to  (Off).
3. To view and change the settings with a PIN code, use the select button to change the **Protect Settings** to  (On), set the PIN code, and turn the key in the ignition switch to the OFF position and then to the ON position.

## Setting the Spray Tank Alert

1. Select **Machine Settings**.
2. Select **Tank Alert**.
3. Use the directional buttons to enter the minimum quantity in the tank when the alert displays during sprayer operation.

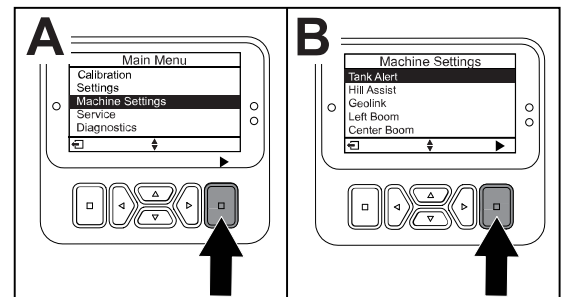

G511350

# Setting the Boom Sizes

1. Select **Machine Settings**.
2. Select the boom you would like to update.
3. Use the directional buttons to change the boom size in increments of 1 inch (2.5 cm).

# Resetting the Default Settings

Setting	Default Value
Test Speed	0.0
Hill Assist	enabled
Spray Tank Alert	1 gal/ltr
L Boom	80 in
C Boom	60 in
R Boom	80 in

1. Select **Machine Settings**.
2. Select **Reset Defaults**.

# Entering the Spray Tank Volume

**Note:** Changing the volume will reset the tank alert.

1. Press the ENTER (A) button to navigate to the right.  
The display will show the current tank volume.
2. Press the button to increase or decrease the tank volume.
  - A. Press the up/down directional buttons (2) to jump to  $\pm 10$  (for US units) or  $\pm 25$  (for metric units).

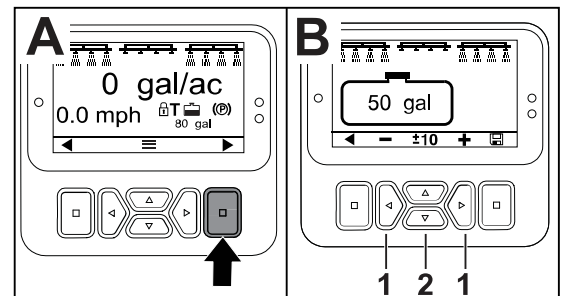

G511620

- B. Press the left/right directional buttons (1) to change the volume by 1 increment.

# The Total and Sub Area Screens

These screens display:

- Area sprayed (acres, hectares, or 1000 ft<sup>2</sup>)
- Volume sprayed (US gallon or liters)

The area and volume information accumulates until you reset it.

Use an individual sub area for each sprayer task at your site. You can use up to 20 sub areas.

**Note:** Ensure that you navigate to the sub area you are working on before you begin spraying. The sub area shown on the screen is the active sub area for coverage accumulation.

## Resetting the Total Area and Volume Data

1. Press the BACK button to navigate to the Total Area screen.
2. Press the RIGHT button to reset the Total Area data.

**Note:** Resetting the total area and total volume information at the total area screen resets **all** of the data for every sub area.

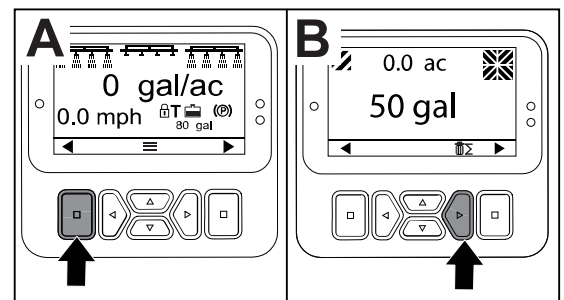

G511618

## Resetting a Sub Area and Volume Data

1. Press the BACK button to navigate to a Sub Area screen.
2. Press the UP button to reset the sub area data

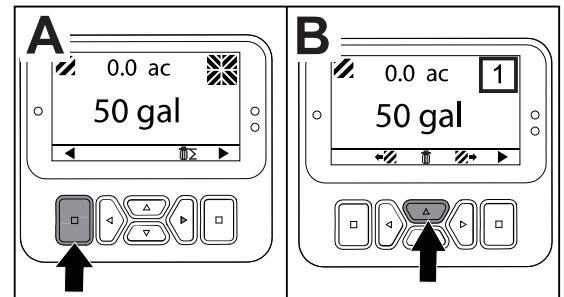

G511619



# Advisories

Operator advisories automatically display on the InfoCenter screen when a machine function requires additional action. For example, if you attempt to start the engine while pressing the traction pedal, an advisory displays, indicating that the traction pedal must be in the NEUTRAL position.

Press any buttons on the display to clear the advisory.

200	Start Prevented—Pump switch active
201	Start Prevented—Not in NEUTRAL
202	Start Prevented—Out of seat
203	Start Prevented—Throttle pedal is not home
204	Start Prevented—Starter engage timeout
205	Parking brake is engaged
206	Pump Start Prevented—Boom active
207	Pump Start Prevented—Engine rpm high
208	Throttle/Speed Lock Prevented—Pump is not active
209	Throttle Lock Prevented—Parking brake is not engaged
210	Speed Lock Prevented—Operator not in seat or parking brake in engaged
211	Throttle/Speed Lock Prevented—Clutch or service brake is engaged
212	Tank low volume alert
213	Rinse pump is On
220	Flow sensor calibration
221	Flow sensor calibration—Fill water in tank and enter volume filled
222	Flow sensor calibration—Turn on the pump
223	Flow sensor calibration—Turn on all of the booms
224	Flow sensor calibration—Calibration commenced
225	Flow sensor calibration—Calibration complete
226	Flow sensor calibration—Exiting calibration mode
231	Speed sensor calibration
232	Speed sensor calibration—Fill the fresh water tank, press next
233	Speed sensor calibration—Fill the sprayer half full with water, press next
234	Speed sensor calibration—Enter the calibration distance, press next
235	Speed sensor calibration—Mark and drive the entered distance with sprayer sections off
236	Speed sensor calibration—Speed sensor calibration in progress
237	Speed sensor calibration—Speed sensor calibration complete

238	Speed sensor calibration—Turn off the booms
241	Calibration out of bounds, using default

## Service Fault Codes

The list below identifies the fault codes that are generated by the Electronic Controller (TEC) to identify an electrical system malfunction that occurred during machine operation.

If you see faults listed in the viewer, contact your Authorized Service Dealer.

Code	Description
1	TEC is faulty
2	One or more of the TEC output fuses (7.5 A) is faulty
3	Main power relay or circuit wiring is faulty
4	Charging system or circuit wiring is faulty
5	Start relay or circuit wiring is faulty
6	Kill relay circuit is faulty
7	Spray pump clutch or circuit wiring is faulty
8	Spray pump indicator light or circuit wiring is faulty
9	Throttle lock or circuit wiring is faulty
10	Throttle lock indicator or circuit wiring is faulty
11	Master boom valve actuator or circuit wiring is faulty
12	Rinse pump relay, optional rinse pump, or circuit wiring is faulty
13	Brake hold solenoid or circuit wiring is faulty
14	InfoCenter software is not recognized by TEC
15	Brake pressure switch or circuit wiring is faulty (circuit is closed even though the brake pedal has been released)
16	Service brake or throttle home sensor, or circuit wiring, is faulty (circuit is open even though the brake or accelerator pedal has been released)
17	Starter timeout (starter has been engaged for more than 30 seconds)

# Diagnostic Inputs and Outputs

Diagnostics are used to troubleshoot machine operation issues and ensure that necessary components and circuit wiring are functioning correctly.

## Pump Parameters

Inputs	Outputs
Pump Switch	Main Pump
Momentary Rinse	Rinse Pump
Timed Rinse	
Throttle Home	
Timer	

## Boom Parameters

Inputs	Outputs
Left Boom	Master Boom
Center Boom	
Right Boom	
Master Boom	

## Engine Parameters

Inputs	Outputs
Key Start	OK Run
Key Run	Engine Output
Neutral	
Seat or Parking Brake	
Pump Off	

## Throttle Lock Parameters

Inputs	Outputs
Throttle/Speed Lock Switch	Throttle/Speed Lock
Neutral	
Parking Brake	
Main Pump	
Clutch Off	

