



# Customer Service Bulletin

## Commercial Business Group

---

### Greensmaster<sup>®</sup> 3200-D

<u>Model/Serial Range:</u>	<u>Model Number:</u>	<u>Serial Numbers :</u>
	04381	50001-90400
	04381	90901-91086

**Subject: NEUTRAL RETURN SPRING PIN REWORK**

The Pin that connects the neutral Spring to the frame, may wear through. If the pin wears through, the transmission will not automatically return to neutral and could result in personal injury, equipment damage or turf damage.

**WARNING: Failure to comply with this bulletin may result in personal injury.**

Replace the parts (Spring and Pin) identified below. These parts are located on the top of the transmission. Best access for the Locknut is with a deep well socket wrench and extension inserted over the top surface of the muffler. Allow muffler to cool.

1. Replace Spring (94-1369) and Pin (99-8194). Position jam nut at similar position on new pin so spring tension does not change.
2. Test unit to ensure neutral return mechanism works correctly. If neutral adjustment is required, follow printed instructions found in appropriate Toro operators manual.

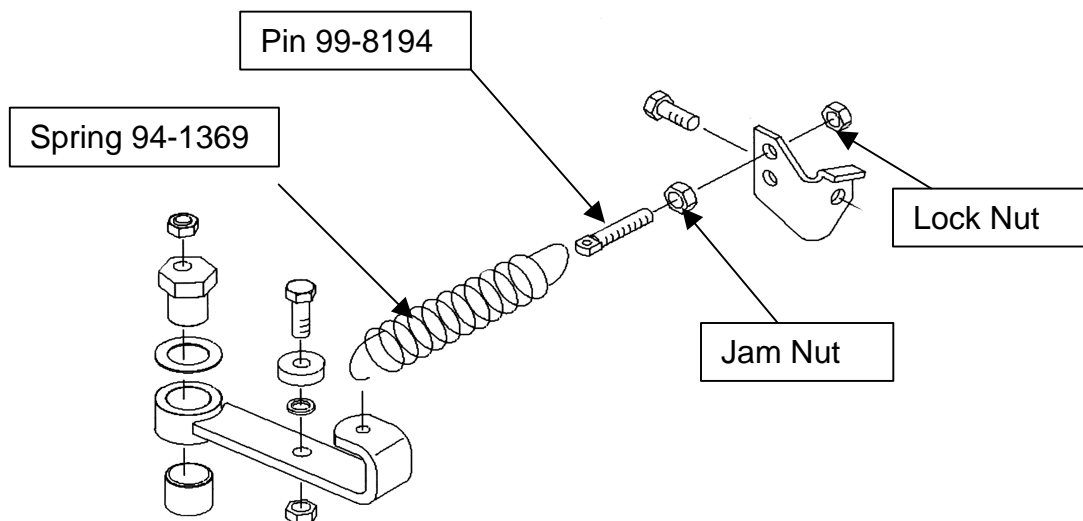

Contact your Toro commercial distributor for additional information and direction on this rework.