



Work Light Kit

Workman® GTX/MD/MDE/MDX/HDX Cab Kit

Model No. 130-5485

Installation Instructions

Safety

Safety and Instructional Decals



Safety decals and instructions are easily visible to the operator and are located near any area of potential danger. Replace any decal that is damaged or missing.

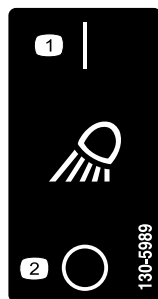

130-5989

decal130-5989

1. Work lights—on
2. Work lights—off



145-7727

decal145-7727

1. Work lights



Installation

Loose Parts

Use the chart below to verify that all parts have been shipped.

Procedure	Description	Qty.	Use
1	No parts required	–	Prepare the machine.
2	Left mount Right mount Bolt (M6) Nut Extension plate (GTX machines only) Rear mount Hex-head bolt (1/4 x 7/8 inch) Speed nut Tie clip	1 1 8 8 2 1 1 1 3	Install the mounts.
3	Fuse (5 A) Switch Decal 130-5989 Decal 145-7727 Wire harness Magnet tie wrap (GTX machines only)	1 1 1 1 1 7	Install the fuse, switch, and wire harness.
4	Work-light assembly	3	Install the work lights.

1

Preparing the Machine

No Parts Required

Procedure

1. Park the machine on a level surface.
2. Engage the parking brake.
3. Shut off the engine and remove the key.
4. Disconnect the negative battery cable from the battery post.
5. Remove the bolts securing the top of the cab (Figure 1) and carefully lift off the top of the cab.

Note: Your cab may not look exactly like the figure. You may need to remove more bolts than shown in Figure 1.

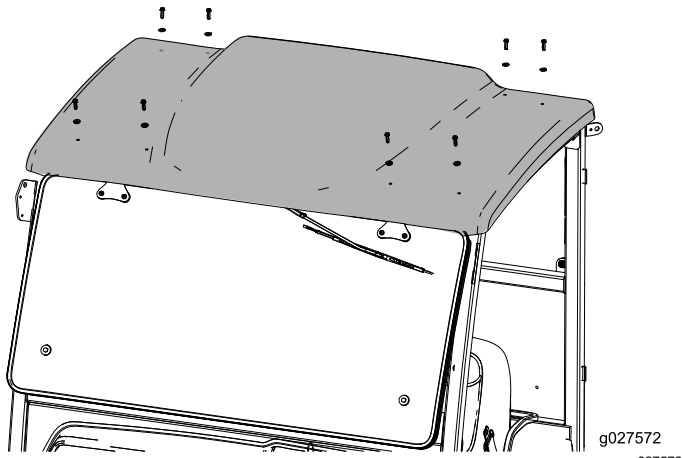

Figure 1

2

Installing the Mounts

Parts needed for this procedure:

1	Left mount
1	Right mount
8	Bolt (M6)
8	Nut
2	Extension plate (GTX machines only)
1	Rear mount
1	Hex-head bolt (1/4 x 7/8 inch)
1	Speed nut
3	Tie clip

Installing the Front Mounts

Workman MD/MDE/MDX/HDX Machines Only

1. Secure the right mount to the front, right lifting point of the cab using 2 bolts (M6) and 2 nuts (Figure 2).

Note: If your cab is equipped with the Side Mirror Kit, remove the hardware that is securing the mirror brackets onto the lifting points and use the hardware included in this kit.

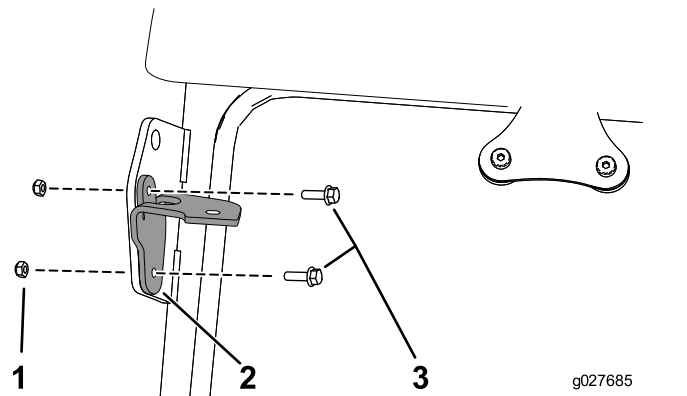

Figure 2

1. Nut
2. Right mount
3. Bolts

2. Secure the left mount to the front, left lifting point of the cab using 2 bolts (M6) and 2 nuts (Figure 2).

Installing the Front Mounts

Workman GTX Machines Only

1. Install a tie clip to the right mount (Figure 3).

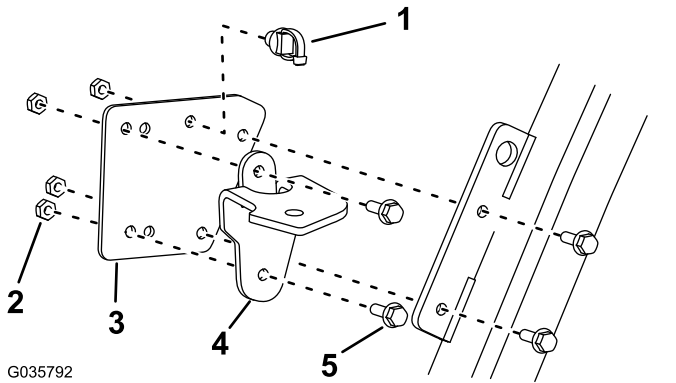

Figure 3

- | | |
|--------------------|----------------|
| 1. Tie clip | 4. Right mount |
| 2. Nut | 5. Bolt |
| 3. Extension plate | |

2. Install the right mount to 1 extension plate using 2 bolts and 2 nuts (Figure 3).
3. Secure the extension plate to the front, right lifting point of the cab using the 2 bolts and 2 nuts (Figure 3).

Note: If your cab is equipped with the Side Mirror Kit, remove the hardware that is securing the mirror brackets onto the lifting points and use the hardware included in this kit.

4. Repeat steps 1 through 3 to install the left mount onto the front, left lifting point.

Installing the Rear Mount

For All Machines

1. Drill a hole (3/8 inch) in the rear of the roof (Figure 4).

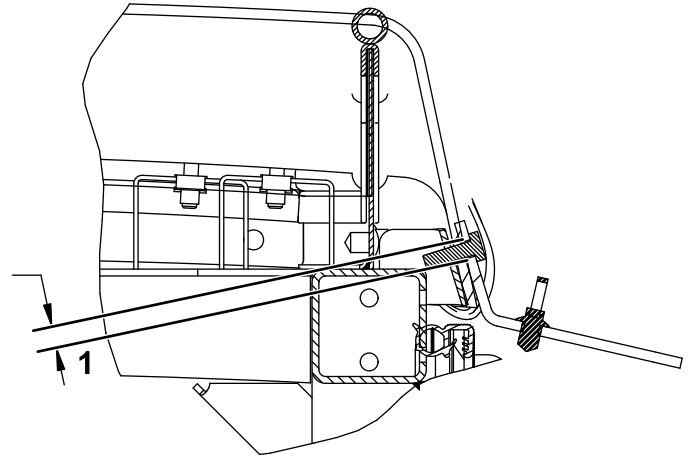

Figure 4

1. Drill a hole (3/8 inch) in the rear of the roof.

2. Secure the rear mount to the roof mount bracket using the hex-head bolt (1/4 x 7/8 inch) and speed nut (Figure 5).

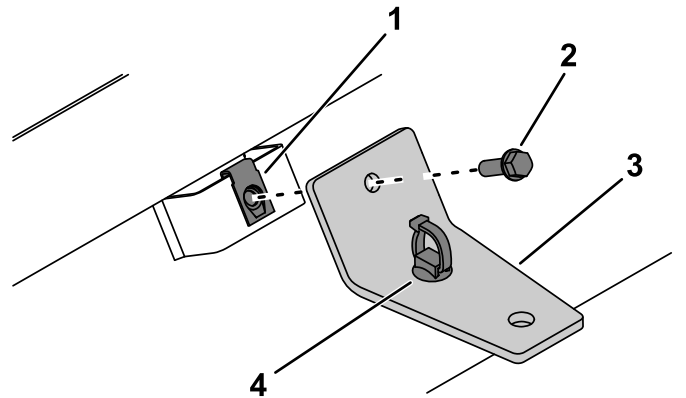

Figure 5

- | | |
|-----------------------------------|---------------|
| 1. Speed nut | 3. Rear mount |
| 2. Hex-head bolt (1/4 x 7/8 inch) | 4. Tie clip |

3. Install the tie clip to the rear mount (Figure 5).

3

Installing the Fuse, Switch, and Wire Harness

Parts needed for this procedure:

1	Fuse (5 A)
1	Switch
1	Decal 130-5989
1	Decal 145-7727
1	Wire harness
7	Magnet tie wrap (GTX machines only)

Applying the Decals

Apply decals 130-5989 and 145-7727 to the console panel assembly as shown in [Figure 8](#).

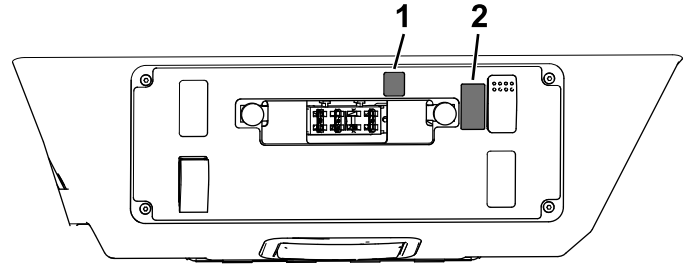

Figure 8

1. Decal 145-7727
2. Decal 130-5989

Installing the Fuse

Install the fuse into the opening in the fuse block as shown in [Figure 6](#).

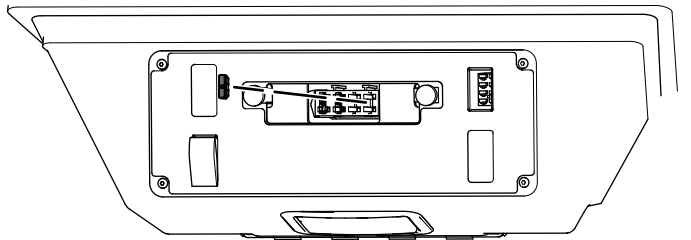

Figure 6

Installing the Switch

From the underside of the cab control panel, push the plug out of the hole shown in [Figure 7](#) and install the work-light switch into this hole.

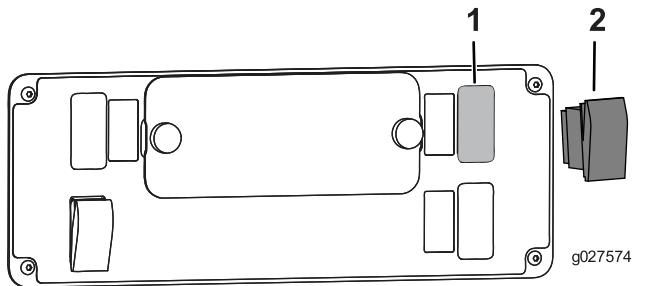

Figure 7

1. Plug
2. Switch

Routing the Wire Harness

Workman MD/MDE/MDX/HDX Machines Only

1. Install the wire harness as shown in [Figure 9](#).

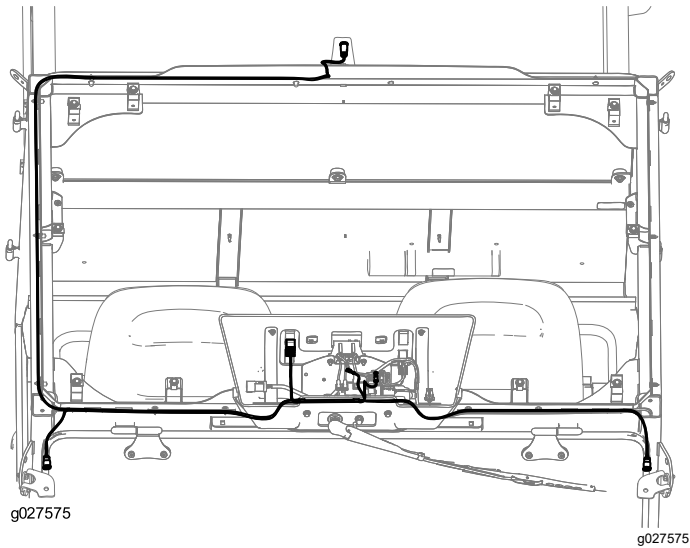

Figure 9
View from above

2. Connect the wire harness to the switch, fuse block, and ground terminal ([Figure 10](#)).

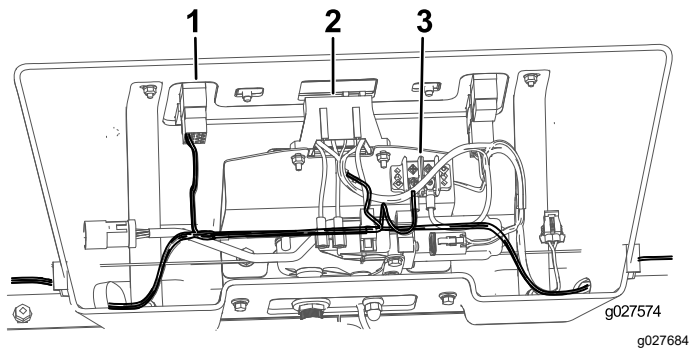

Figure 10

- | | |
|----------------------|--------------------|
| 1. Work-light switch | 3. Ground terminal |
| 2. Fuse block | |

Routing the Wire Harness

GTX Machines Only

1. Install the wire harness as shown in [Figure 11](#).

Note: Slit the foam at the locations shown in [Figure 11](#) to route the harness.

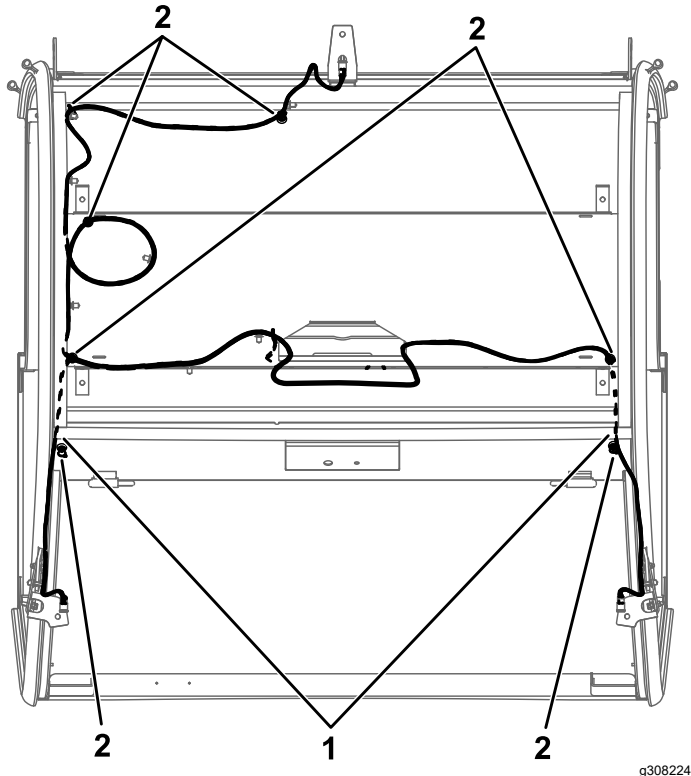

Figure 11
View from above

g308224

1. Slit foam here.
2. Magnet tie wrap

2. Secure the wire harness to the machine using the tie clips in the extension plates and using 7 magnet tie wraps in the locations shown in [Figure 11](#).
3. Connect the wire harness to the switch, fuse block, and ground terminal ([Figure 12](#)).

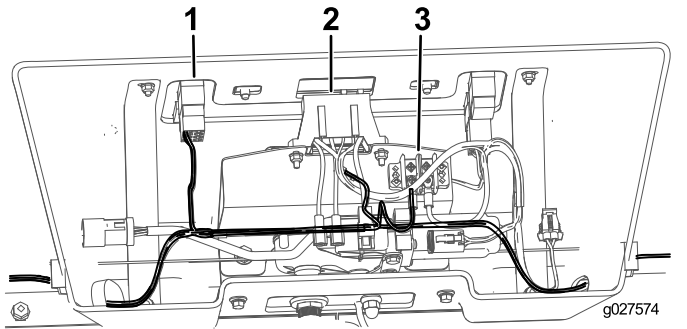

Figure 12

g027574
g027684

1. Work-light switch
2. Fuse block
3. Ground terminal

4

Installing the Work Lights

Parts needed for this procedure:

3	Work-light assembly
---	---------------------

Procedure

1. Install the top of the cab that was removed in [1 Preparing the Machine \(page 3\)](#) onto the machine.
2. Remove the nut and bolt from each work-light assembly and secure them to the brackets as shown in [Figure 13](#).

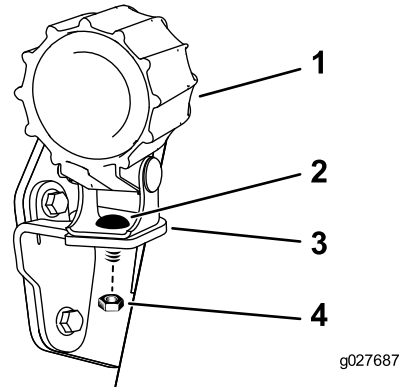

Figure 13

g027687

g027687

1. Work light
2. Bolt
3. Work-light mount
4. Nut

3. Plug the wire harness into the work-light assemblies.

5

Connecting the Battery

No Parts Required

Procedure

Connect the negative battery cable to the battery post.

Operation

Controls

Work-Light Switch

Press the work-light switch to the ON position to activate the work lights.