



Bag Kit

21in 60V Lawn Mower

Model No. 161-3137

Installation Instructions

Safety

Safety and Instructional Decals



Safety decals and instructions are easily visible to the operator and are located near any area of potential danger. Replace any decal that is damaged or missing.

⚠ WARNING

TO REDUCE THE RISK OF INJURY, INSPECT CATCHER ASSEMBLY FREQUENTLY AND REPLACE WITH RECOMMENDED REPLACEMENT IF THERE ARE SIGNS OF WEAR OR DETERIORATION.

⚠ ADVERTENCIA

PARA REDUCIR EL RIESGO DE LESIONES, INSPECCIONE FRECUENTEMENTE EL ENSAMBLAJE DEL RECEPTOR Y CAMBIELO POR LA PIEZA DE REPUESTO RECOMENDADA SI HAY SEÑALES DE DESGASTE O DETERIORO.

⚠ AVERTISSEMENT

POUR RÉDUIRE LES RISQUES DE BLESSURE, INSPECTER SOUVENT L'ENSEMBLE SAC COLLECTEUR D'HERBE ET REMPLACER AVEC DES PIÈCES RECOMMANDÉES CELLES QUI SEMBLENT USÉES OU DÉTÉRIORÉES.

139-8986

SEMBLANT USÉES OU DÉTÉRIORÉES.
DES PIÈCES RECOMMANDÉES CELLES QUI COLLECTEUR D'HERBE ET REMPLACER AVEC INSPECTER SOUVENT L'ENSEMBLE SAC POUR RÉDUIRE LES RISQUES DE BLESSURE.

⚠ AVERTISSEMENT

DES GASTE O DETERIORO.
INSPECCIONE FRECUENTEMENTE EL ENSAMBLAJE DEL RECEPTOR Y CAMBIELO POR LA PIEZA DE REPUESTO RECOMENDADA SI HAY SEÑALES DE PARA REDUCIR EL RIESGO DE LESIONES.

⚠ ADVERTENCIA

IF THERE ARE SIGNS OF WEAR OR DETERIORATION, REPLACE WITH RECOMMENDED REPLACEMENT CATCHER ASSEMBLY FREQUENTLY AND TO REDUCE THE RISK OF INJURY, INSPECT

⚠ WARNING

139-8986

decal139-8986

Installation

Assembling the Grass Bag

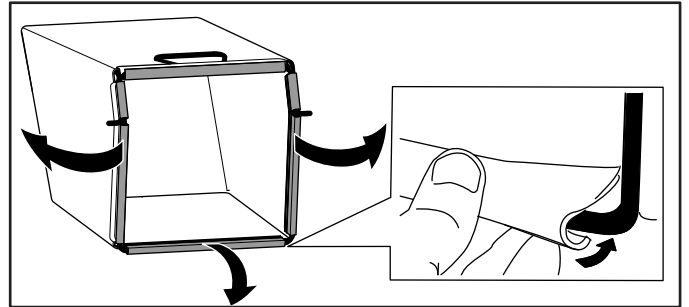

g409809

Figure 1



Installing the Grass Bag

1. Shut off the machine and wait for all moving parts to stop.
2. Remove the battery pack from the machine.
3. Raise and hold up the rear deflector (A of [Figure 2](#)).
4. Remove the rear-discharge plug by pushing in the latch with your thumb and pulling the plug out from the machine (B and C of [Figure 2](#)).
5. Install the bag rod ends into the notches at the base of the handle (D of [Figure 2](#)).
6. Lower the rear deflector until it rests on the grass bag.

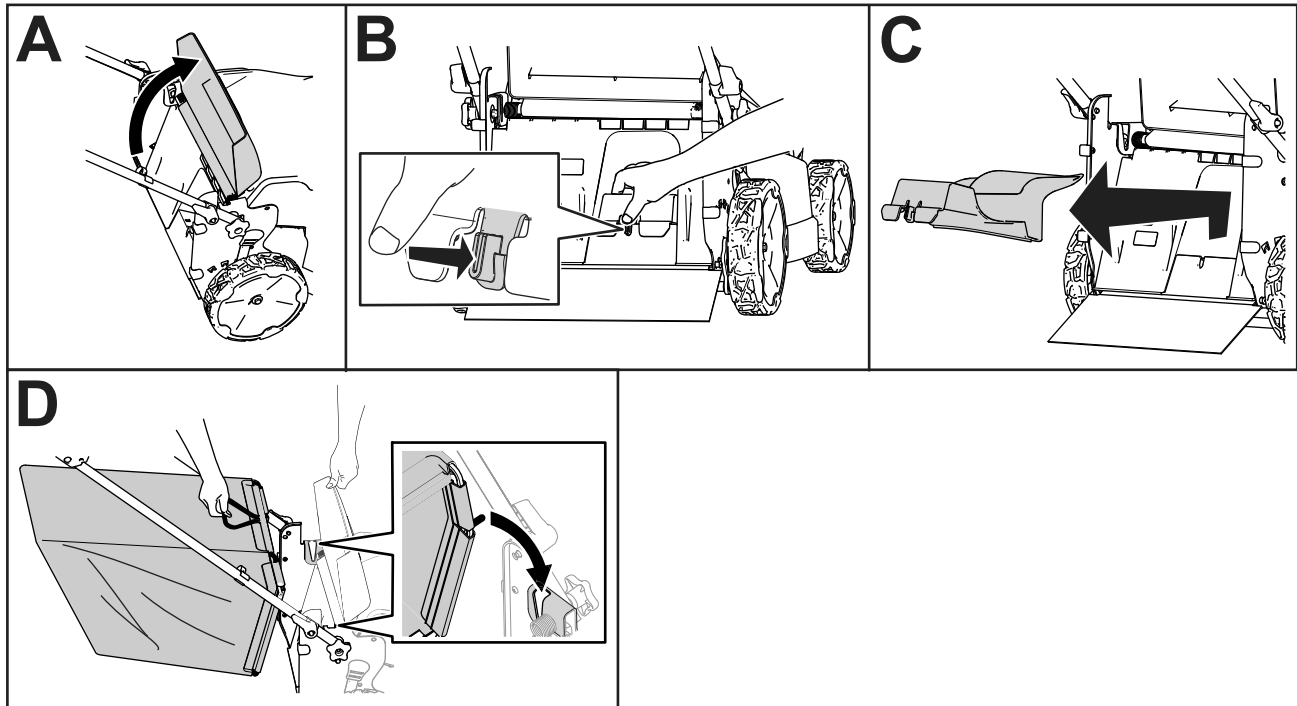

Figure 2

g443724

Removing the Grass Bag

⚠ DANGER

The machine can throw grass clippings and other objects through an opening in the machine housing. Objects thrown with enough force could cause serious personal injury or death to you or to bystanders.

- Never remove the grass bag and then start the machine without the discharge plug installed on the machine.
- Never open the rear deflector on the machine when the machine is running.

Reverse the steps in [Installing the Grass Bag \(page 2\)](#).