



Headlight Kit

SnowMaster® e24 60V Snowthrower

Model No. 147-9472

Installation Instructions

Installation

Loose Parts

Use the chart below to verify that all parts have been shipped.

Description	Qty.	Use
No parts required	–	Prepare the machine.
Headlight	1	Install the kit.
Cable tie	3	



Preparing the Machine

1. Park the machine on a level surface.
2. Shut off the machine and remove the electric-start key.
3. Wait for all moving parts to stop.
4. Remove the battery packs.

Installing the Kit

1. Remove the 4 plastic screws that secure the top cover to the mount bracket. Remove the top cover.

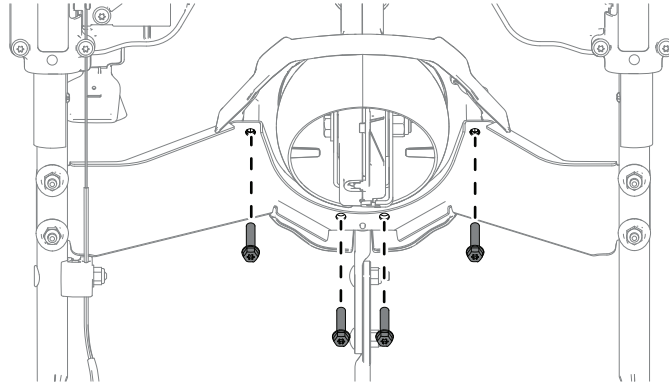

Figure 1

g445310

2. Secure the new headlight to the top cover with the 4 plastic screws.

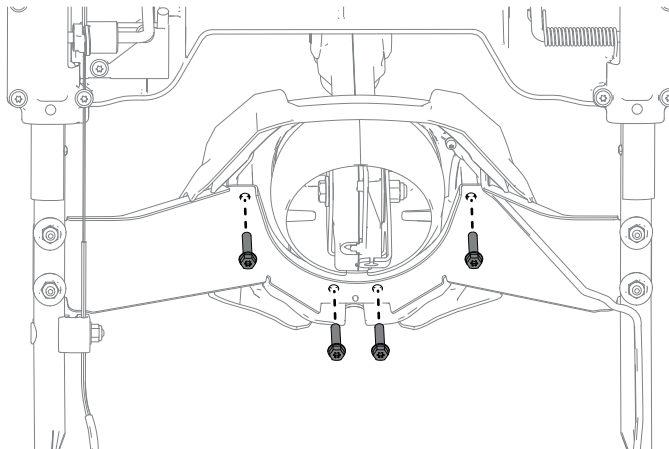

Figure 2

g445312

3. Route the wire harness to the bottom of the power head and attach the harness to the connector.

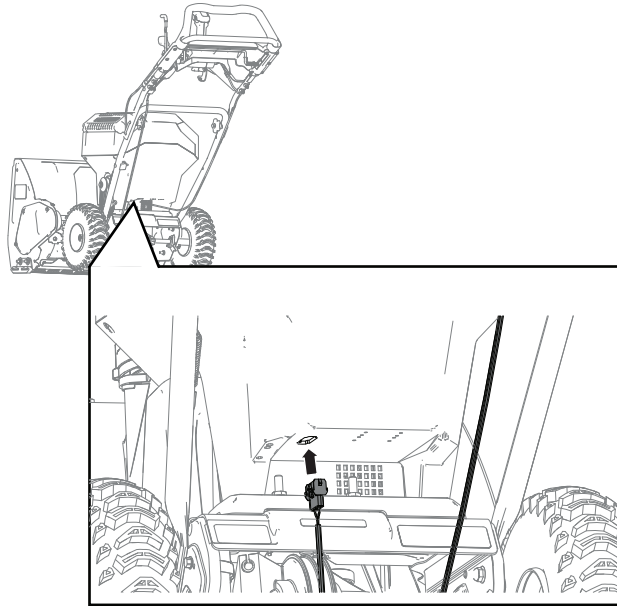

Figure 3

g445313

-
4. Install the 3 cable ties around the headlight harness and the handle as shown below.

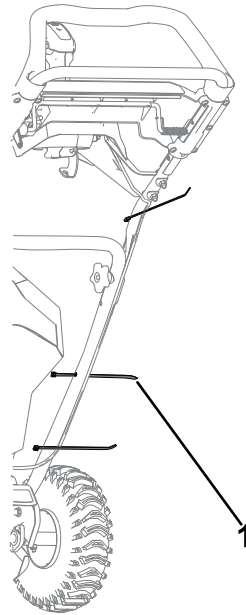

Figure 4

g445314

1. Cable tie that goes through the hole in the handle



Count on it.