



12V or 48V Electric Lift Kit

Workman® GTX Utility Vehicle

Model No. 07143—Serial No. 404500001 and Up

Model No. 07144—Serial No. 404500000 and Up

Installation Instructions

Note: Reuse any mounting hardware that you removed and is not replaced with hardware from the kit.

Preparing the Machine

1. Park the machine on a level surface.
2. Engage the parking brake.
3. Shut off the machine and remove the key.

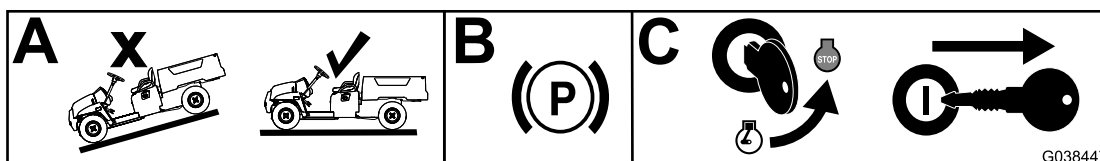

Figure 1

g038447



Placing the Bed into the Service Position

Note: If the draw bar is installed on the machine, you must remove it before placing the bed into the service position.

Insert the prop rod into the service position (Figure 2).

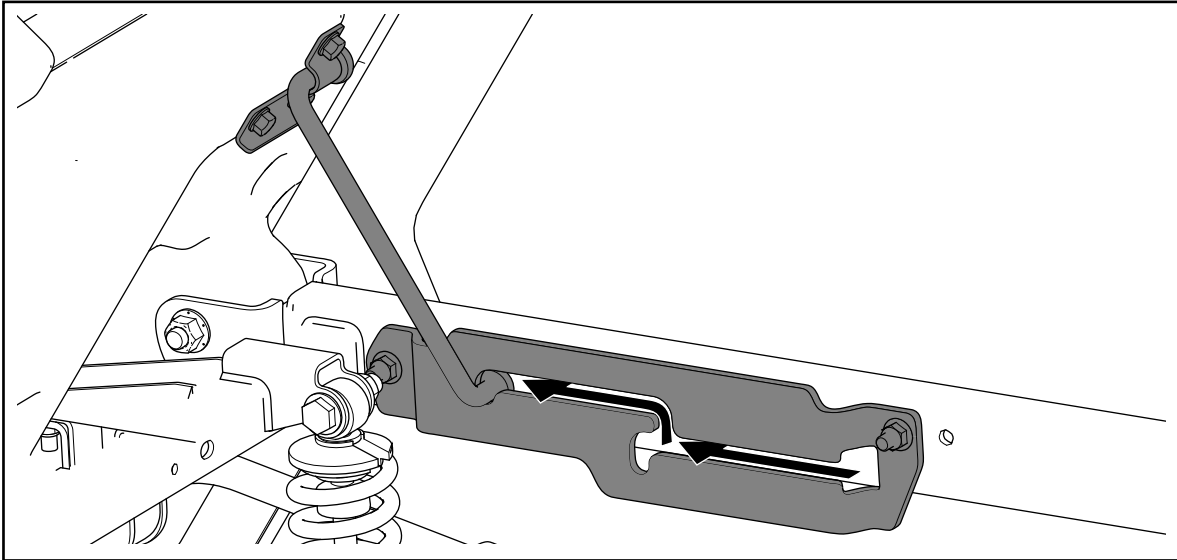
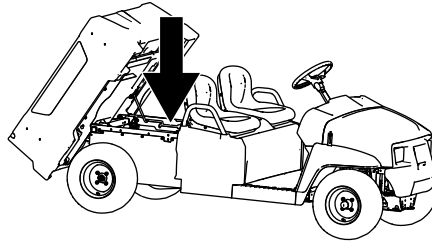

g036022

g036022

Figure 2

Installing the Lift Bracket

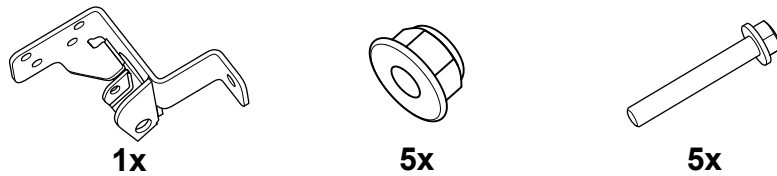

1. Remove the existing bolt and nut from the rear-frame tube (box A of [Figure 3](#)).
Note: Discard the bolt and nut.
2. Remove the 2 existing plastic rivets from the rear-frame tube (box B of [Figure 3](#)).
Note: Retain the 2 plastic rivets.
3. Install the lift bracket to the rear-frame tube using the 5 flange-head bolts ($3/8 \times 2\text{-}1/2$ inches) and 5 flange nuts ($3/8$ inch) as shown in box C of [Figure 3](#).
Torque the flange-head bolts ($3/8 \times 2\text{-}1/2$ inches) to 37 to 45 N·m (27 to 33 ft-lb).
4. Install the 2 previously removed plastic rivets into the rear frame tube (box D of [Figure 3](#)).

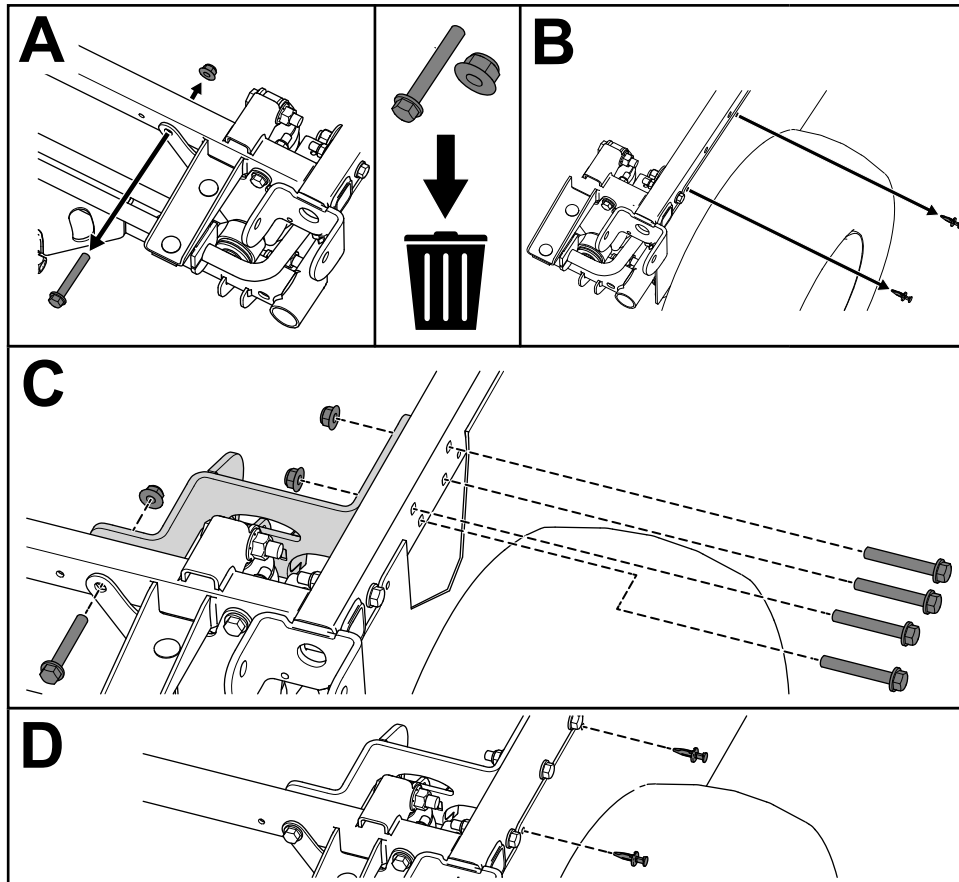
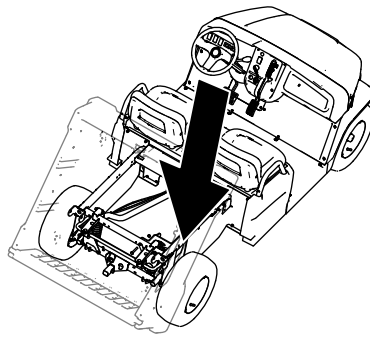
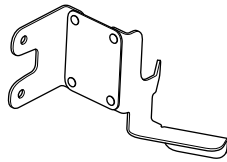

Figure 3

g381446

Installing the Lift Latch



1x

1. Remove the 2 existing bolts from the cargo bed lever (box A of [Figure 4](#)).
2. Install the lift latch to the cargo bed lever using the 2 previously removed bolts, and torque the bolts to 15 to 16 N·m (11 to 12 ft-lb) as shown in box B of [Figure 4](#).

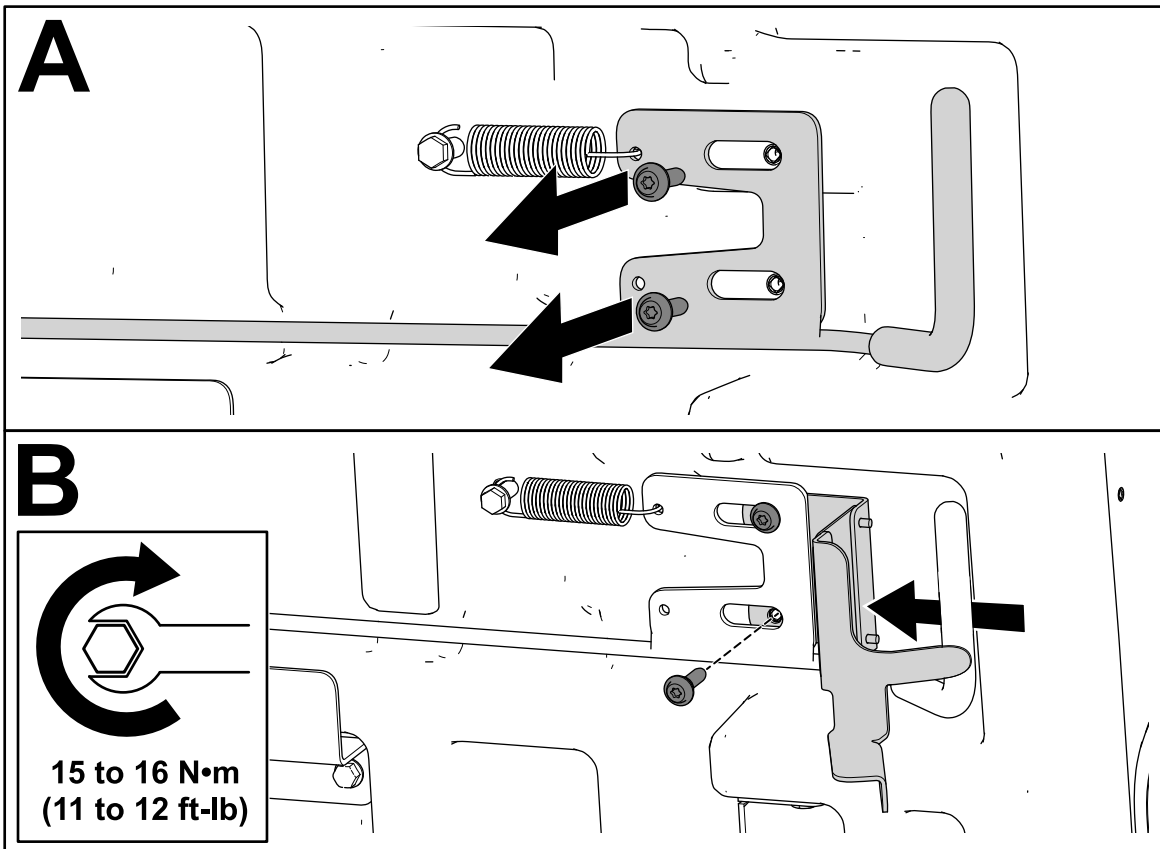
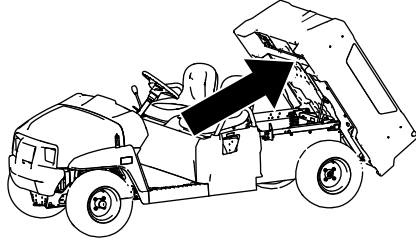

g035996

g035996

Figure 4

Installing the Lift Plate

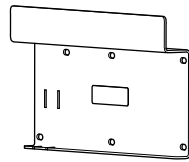

1x

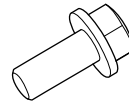

6x

1. Remove the 6 existing bolts and bed braces from the cargo bed (box A of [Figure 5](#)).

Note: Discard the bolts and bed braces.

2. Install the lift plate to the cargo bed using the 6 bolts, and torque the bolts to 15 to 16 N·m (11 to 12 ft-lb) as shown in box B of [Figure 5](#).

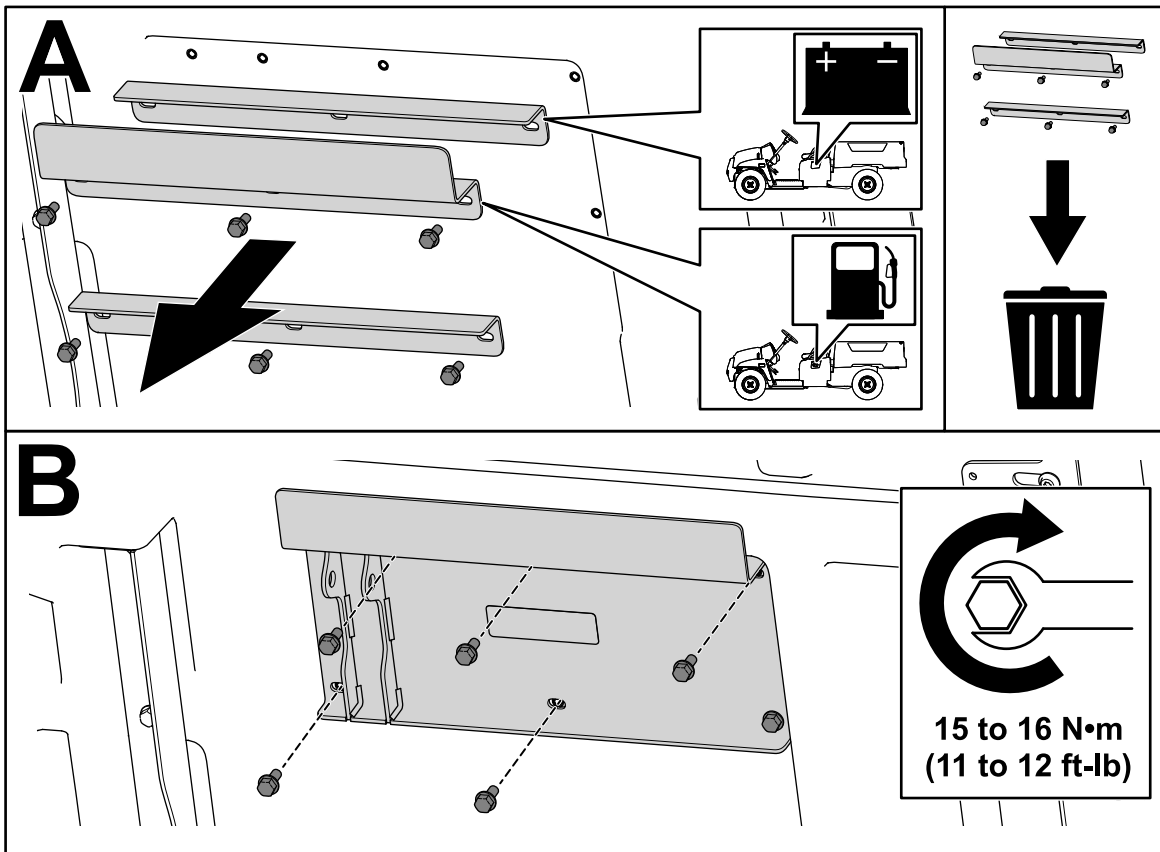
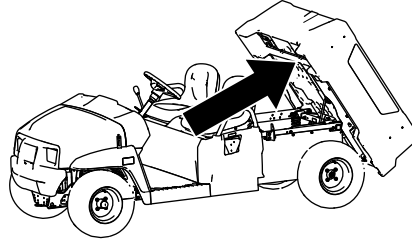

g035960

g035960

Figure 5

Installing the Actuator Stop

Lead-Acid Battery Machines Only

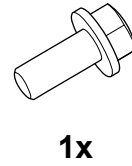
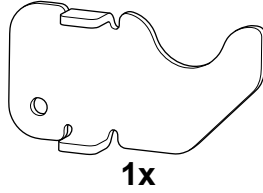

Important: Install the actuator stop on machines with lead-acid batteries only; do not install the actuator stop on lithium-ion battery machines.

Install the actuator stop to the battery tray mounting bracket using the bolt and nut (Figure 6).

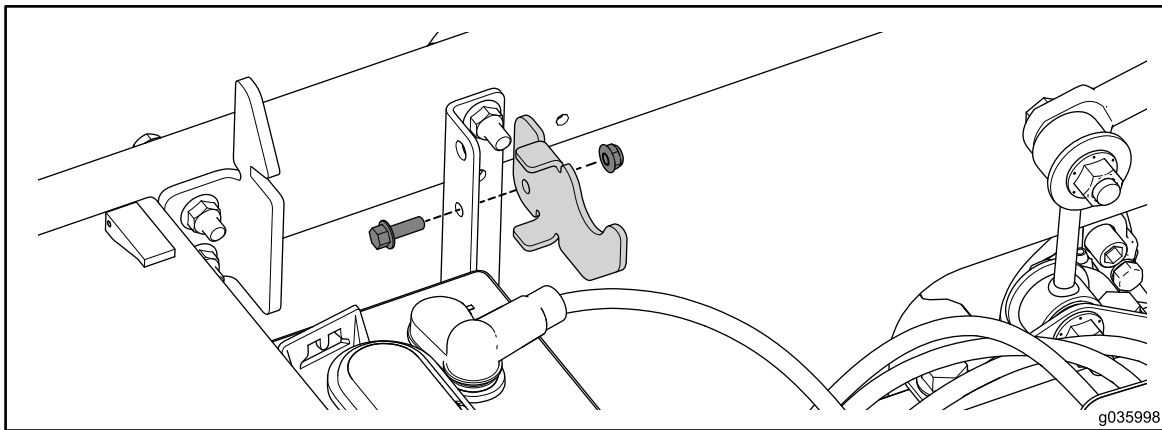
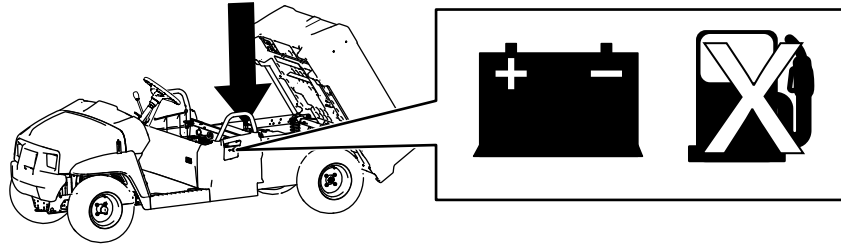
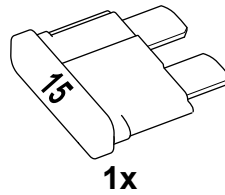

Figure 6
Lead-Acid Battery Machine Shown

g035998

Installing the Fuse



Install the fuse (15 A) into the fuse block (Figure 7, Figure 8, Figure 9, and Figure 10).

For Kit Model 07143 with Machine Serial Number 403448000 and Before

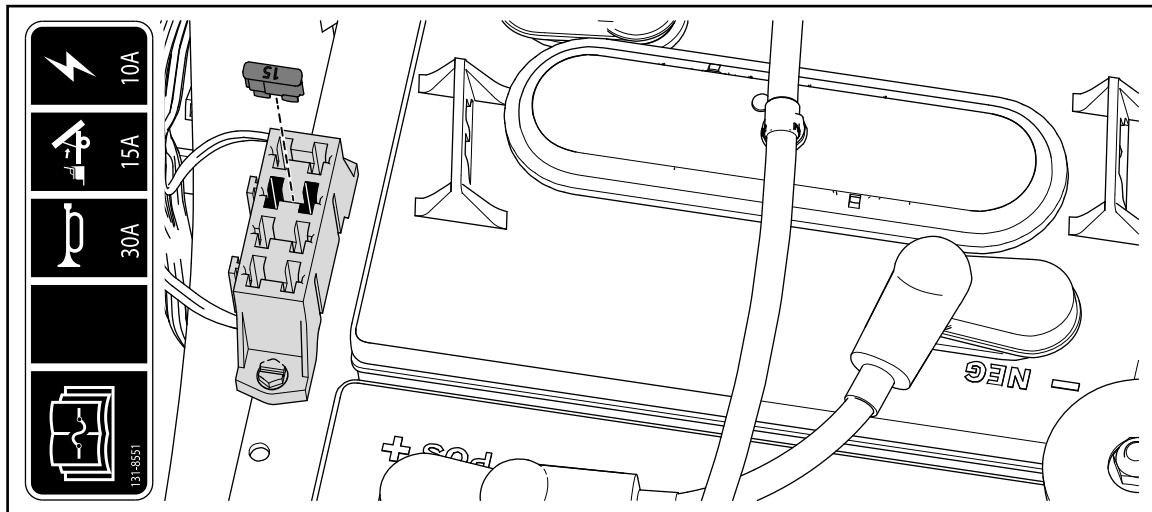
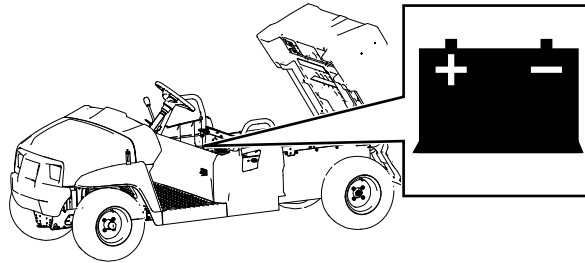

Figure 7

g379041

For Kit Model 07144 with Machine Serial Number 403446000 and Before

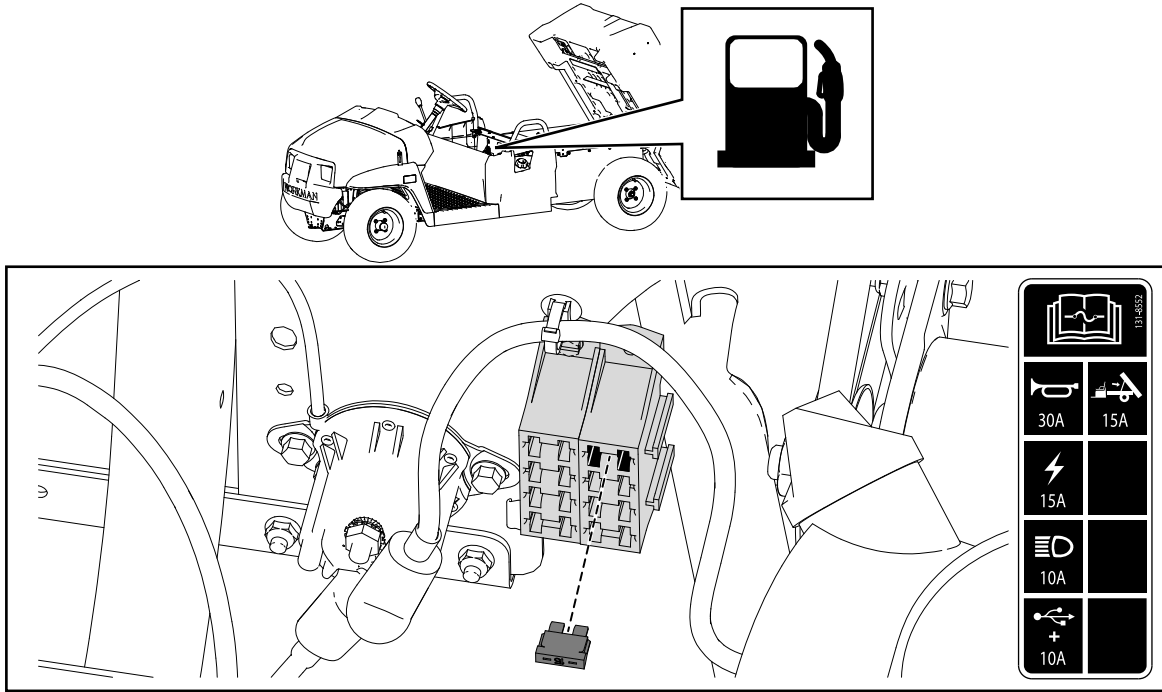

Figure 8

g282496

For Kit Model 07143 with Machine Serial Number 403448001 and After

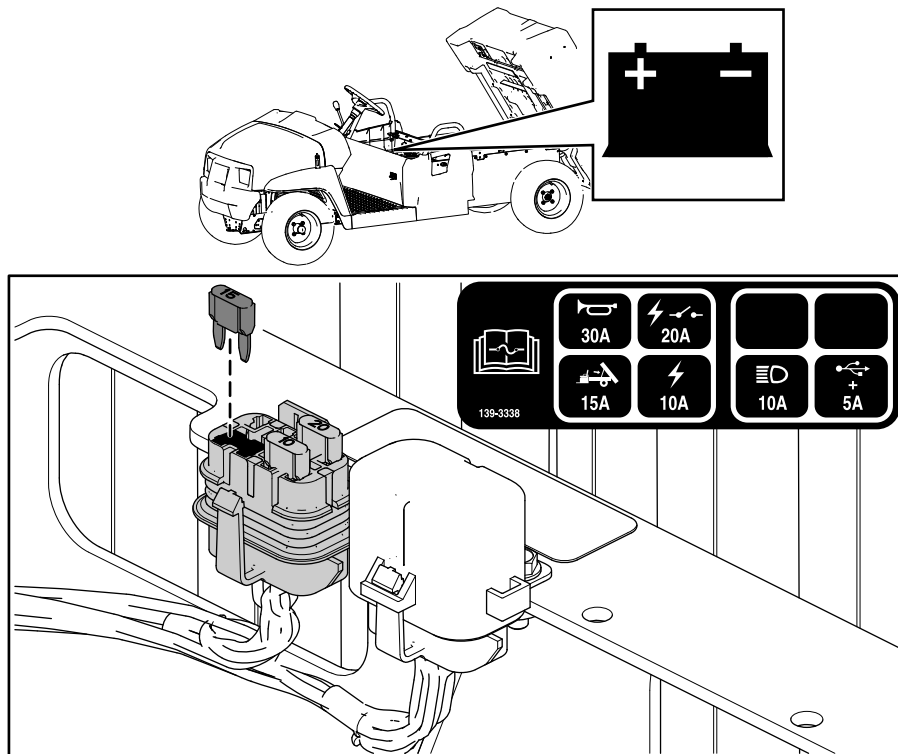

Figure 9

g282493

For Kit Model 07144 with Machine Serial Number 403446001 and After

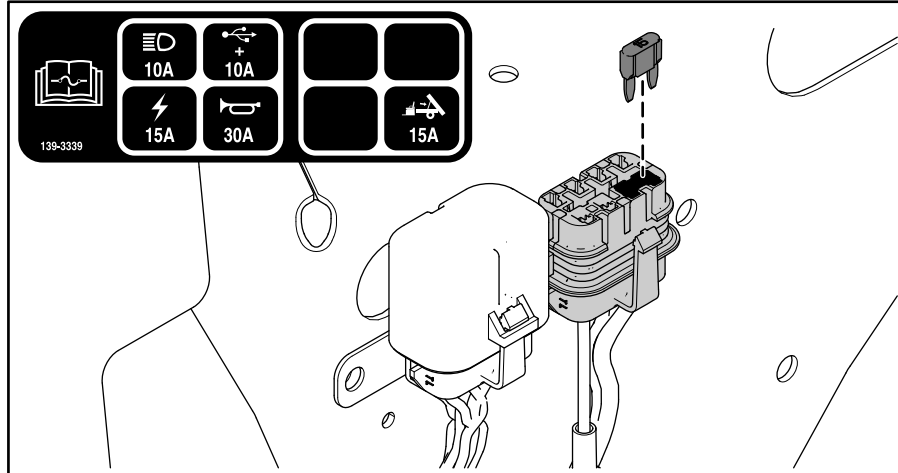
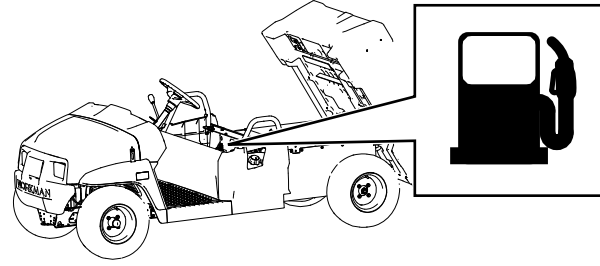
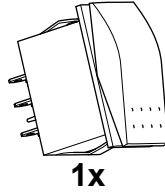

Figure 10

g282495

Installing the Switch

Machine Serial Number 411599999 and Before



1. Remove the plastic cover from the dashboard (box A of [Figure 11](#)).
- Note:** Discard the plastic cover.
2. Install the switch connector through the opening in the dashboard (box B of [Figure 11](#)).
 3. Install the switch to the switch connector (box C of [Figure 11](#)).
 4. Ensure that the switch is oriented properly (box D of [Figure 11](#)).

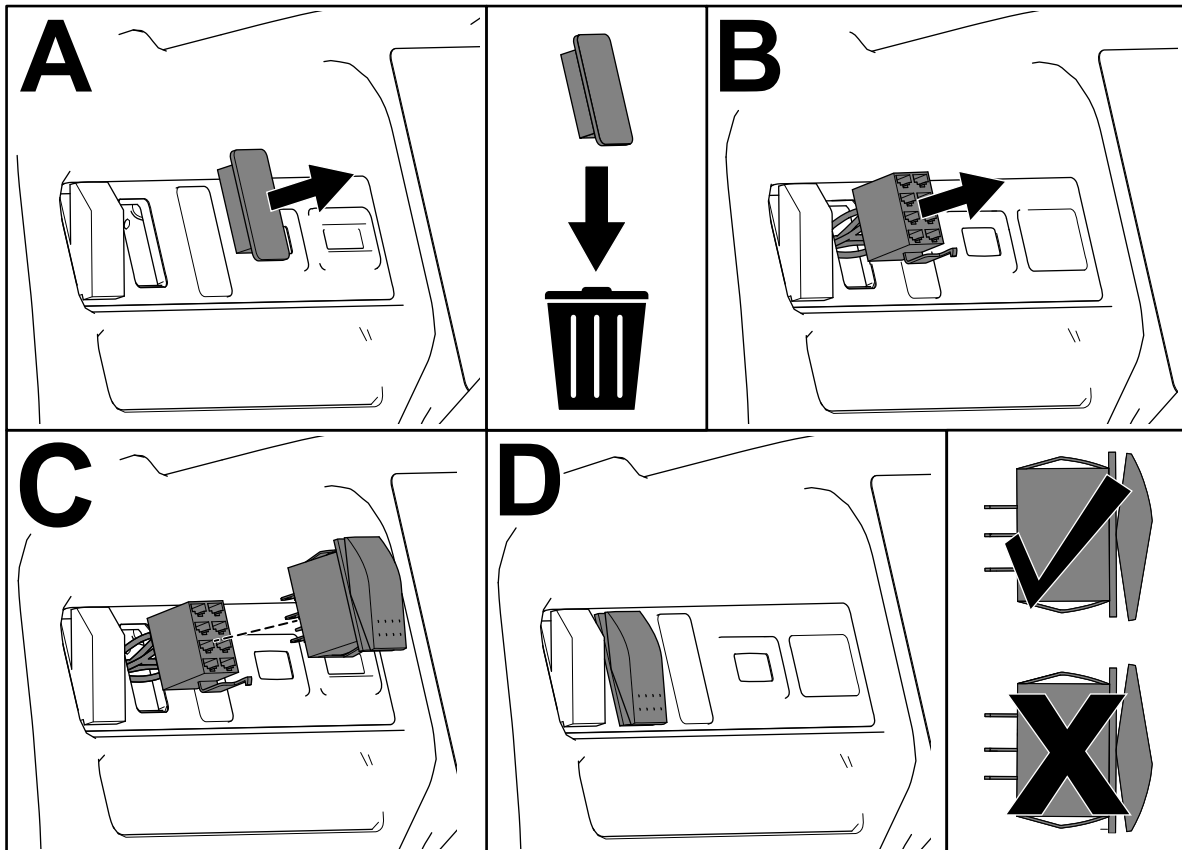
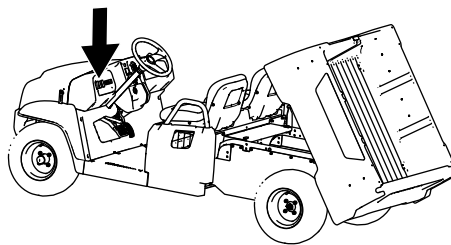

g036019

Figure 11

g036019

Machine Serial Number 411600000 and After

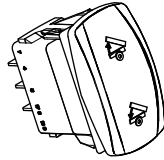

1x

1. Cut out the opening in the dashboard decal for the switch (box A of [Figure 12](#)).
2. Install the switch connector through the opening in the dashboard (box B of [Figure 12](#)).
3. Install the switch to the switch connector (box C of [Figure 12](#)).
4. Ensure that the switch is oriented properly (box D of [Figure 12](#)).

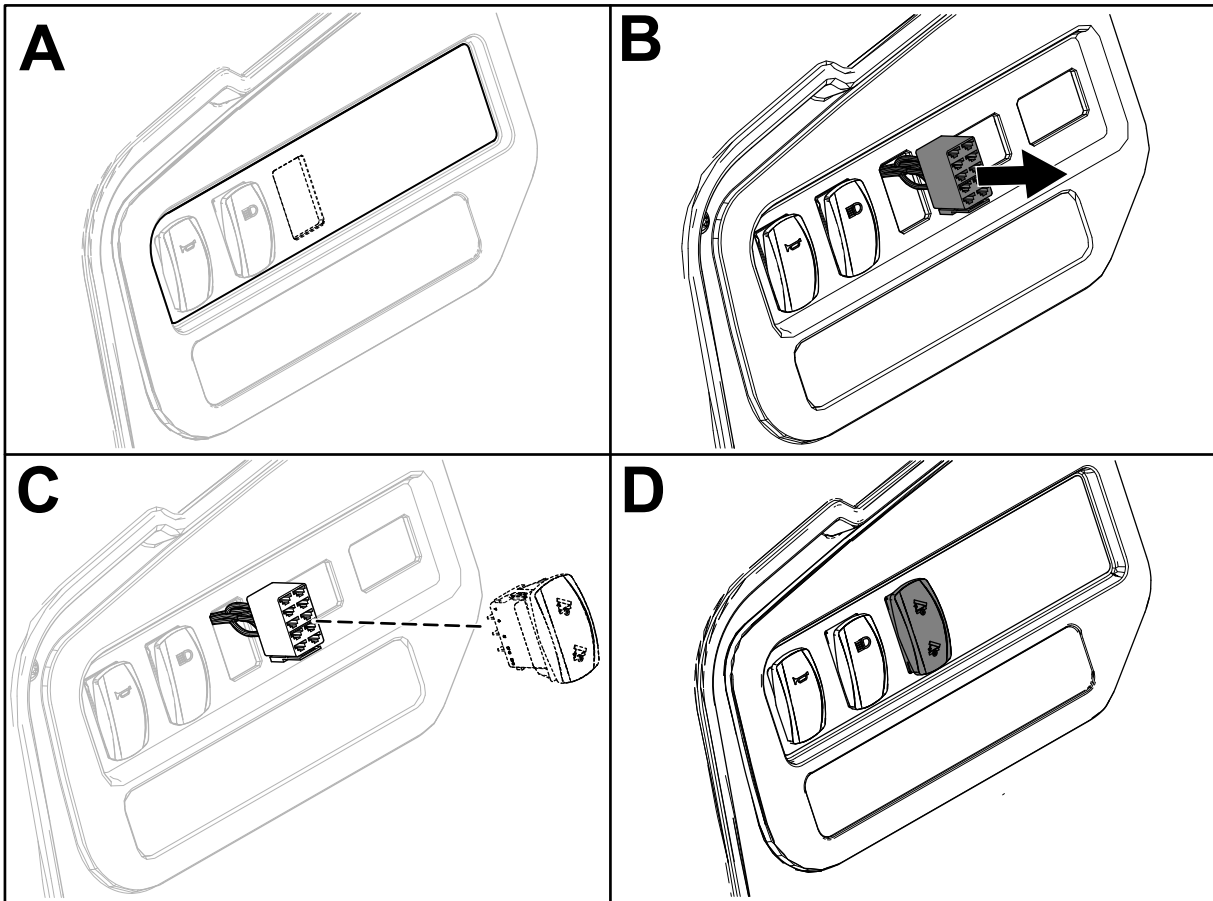
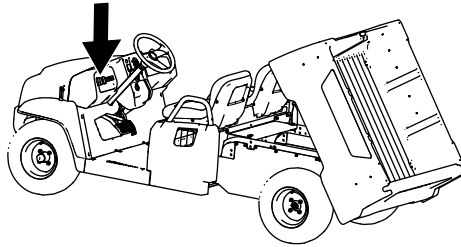
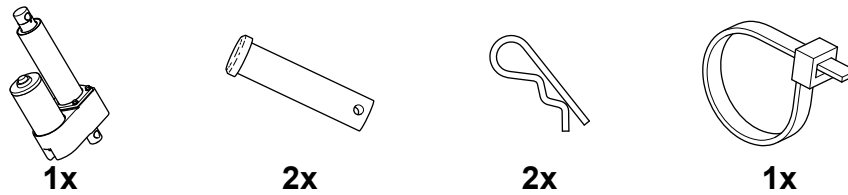

Figure 12

g378587

Installing the Lift Cylinder



Important: Use the cable tie to secure the lift-cylinder wire to the wire harness, away from sharp or moving parts. Ensure that you allow enough slack in the wire harness for its full range of motion.

1. Install the lift cylinder using a clevis pin and hairpin cotter (box A of [Figure 13](#)).
2. Connect the wire harness and secure it to the machine rail using the cable tie (box B of [Figure 13](#)).
3. Rotate the lift cylinder upward to a 45° angle, then use a block to support the lift cylinder (box C of [Figure 14](#)).
4. Press upward on the switch to extend the lift cylinder (box D of [Figure 14](#)).
5. Install the extended portion of the lift cylinder to the cargo bed using a clevis pin and hairpin cotter (box E of [Figure 14](#)).

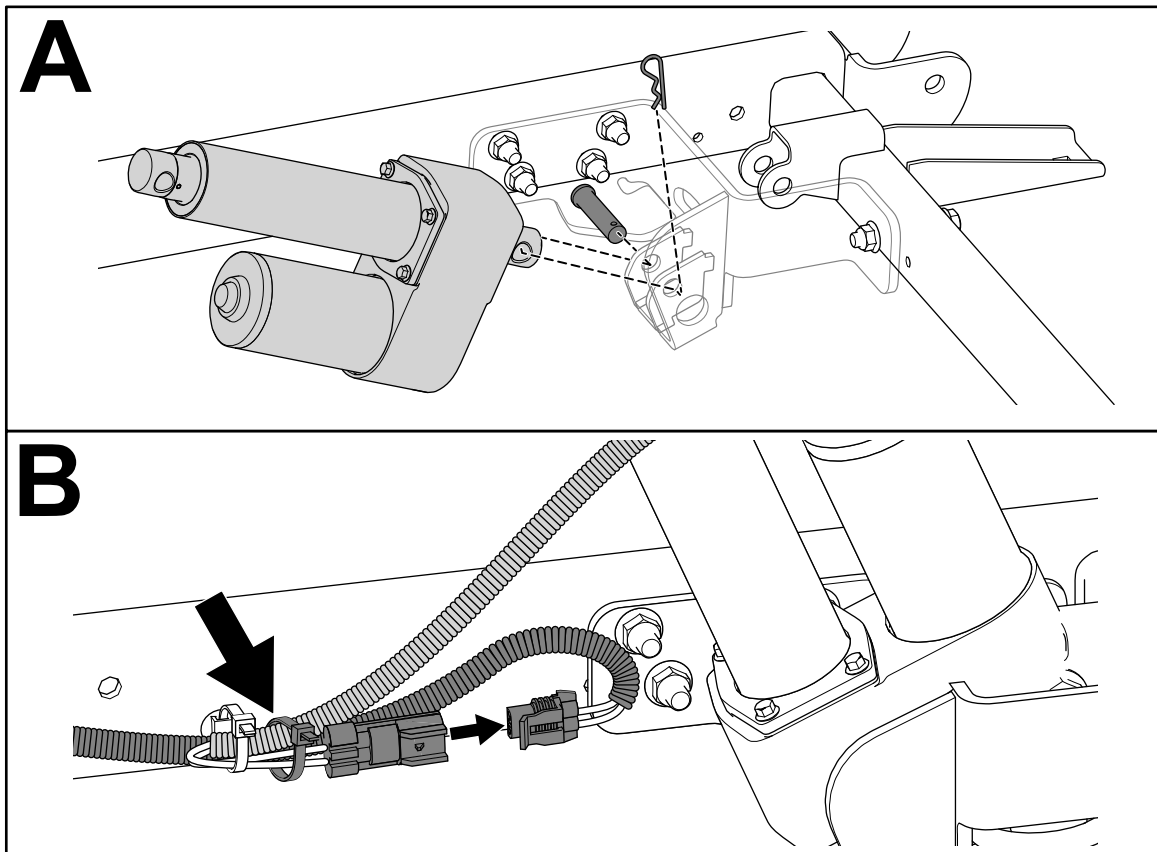
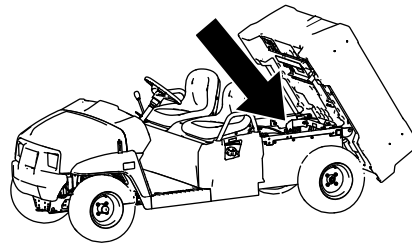

g036021

g036021

Figure 13

Important: Use a block to support the lift cylinder so that it extends upward at a 45° angle.

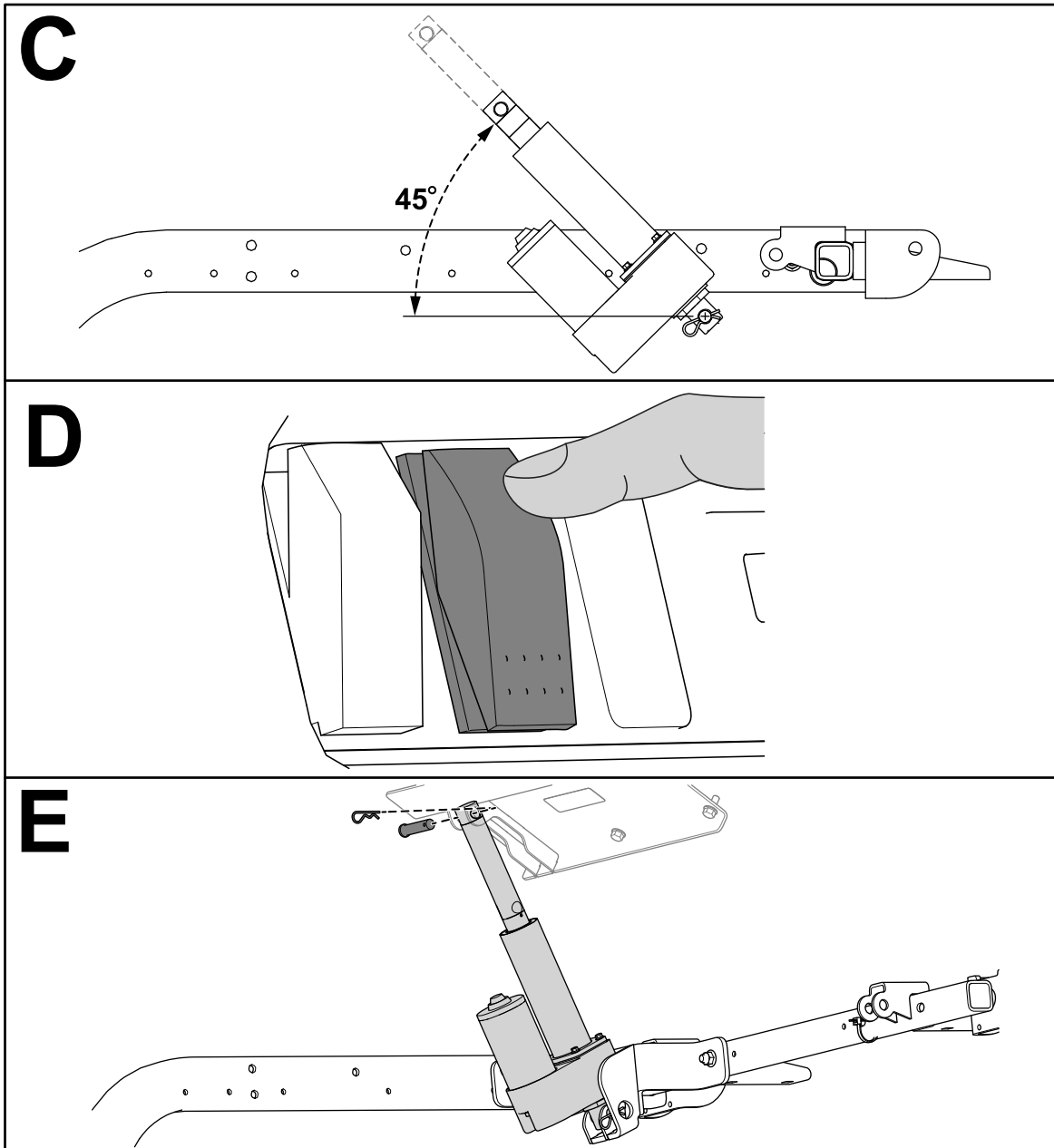
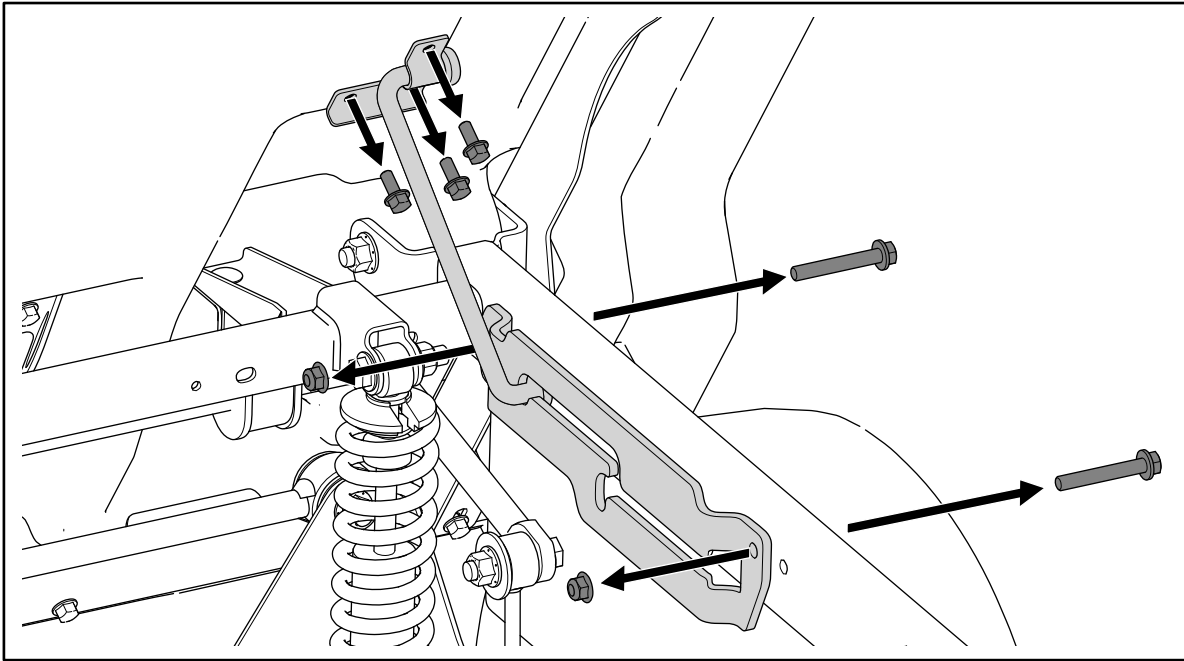
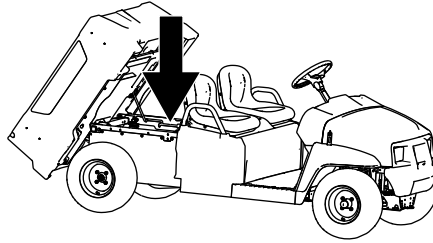

Figure 14

g185788

Removing the Prop Rod Assembly

Remove the 2 bolts (3/8 x 2-1/2 inches), 2 flange nuts (3/8 inch), and 3 bolts (5/16 x 3/4 inch) from the prop rod assembly, and remove the prop rod assembly (Figure 15).



g036807

Figure 15

g036807

Operation

Important: Driving the machine with the cargo bed raised may cause the machine to tip or roll easier. The bed structure may become damaged if you operate the machine with the bed raised.

- Operate the machine only when the cargo bed is down.
- After dumping the contents in the cargo bed, lower the bed.

⚠ CAUTION

The bed may be heavy and could crush your hands or other body parts. Keep your hands and other body parts clear when lowering the bed.

Unlocking and Locking the Bed Latch

Important: Unlock the bed latch when using the electric lift to raise and lower the bed.

Important: Lock the bed latch when using rear attachments.

To unlock the bed latch, pull the bed latch toward you (Figure 16).

To lock the bed latch, push the bed-latch bracket toward the center of the machine until you hear the bed latch lock into position (Figure 16).

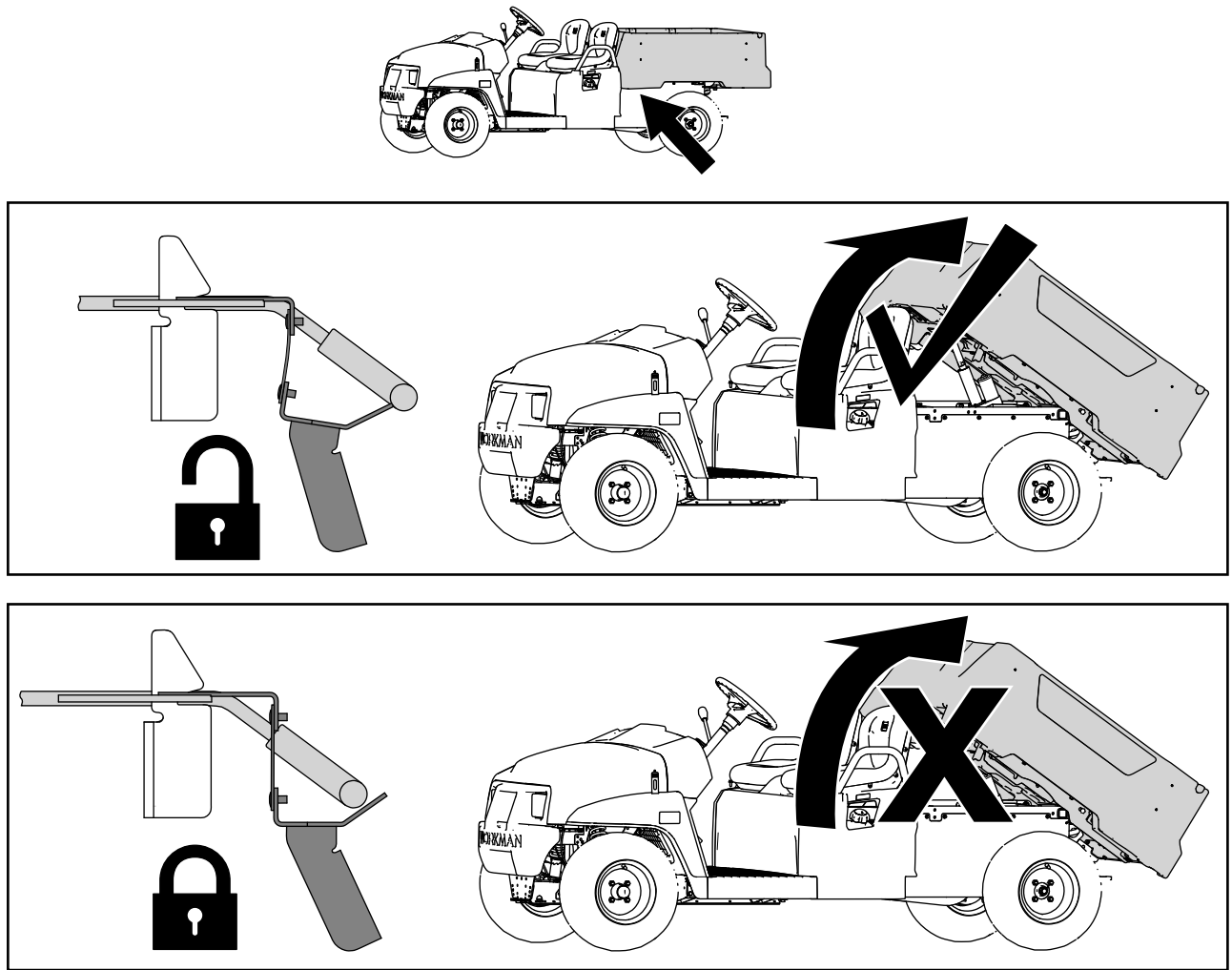

Figure 16

g037384

g037384

Raising and Lowering the Bed

Important: Unlock the bed latch when using the electric lift to raise and lower the bed.

Press upward on the switch to raise the bed (Figure 17).

Press downward on the switch to lower the bed (Figure 17).

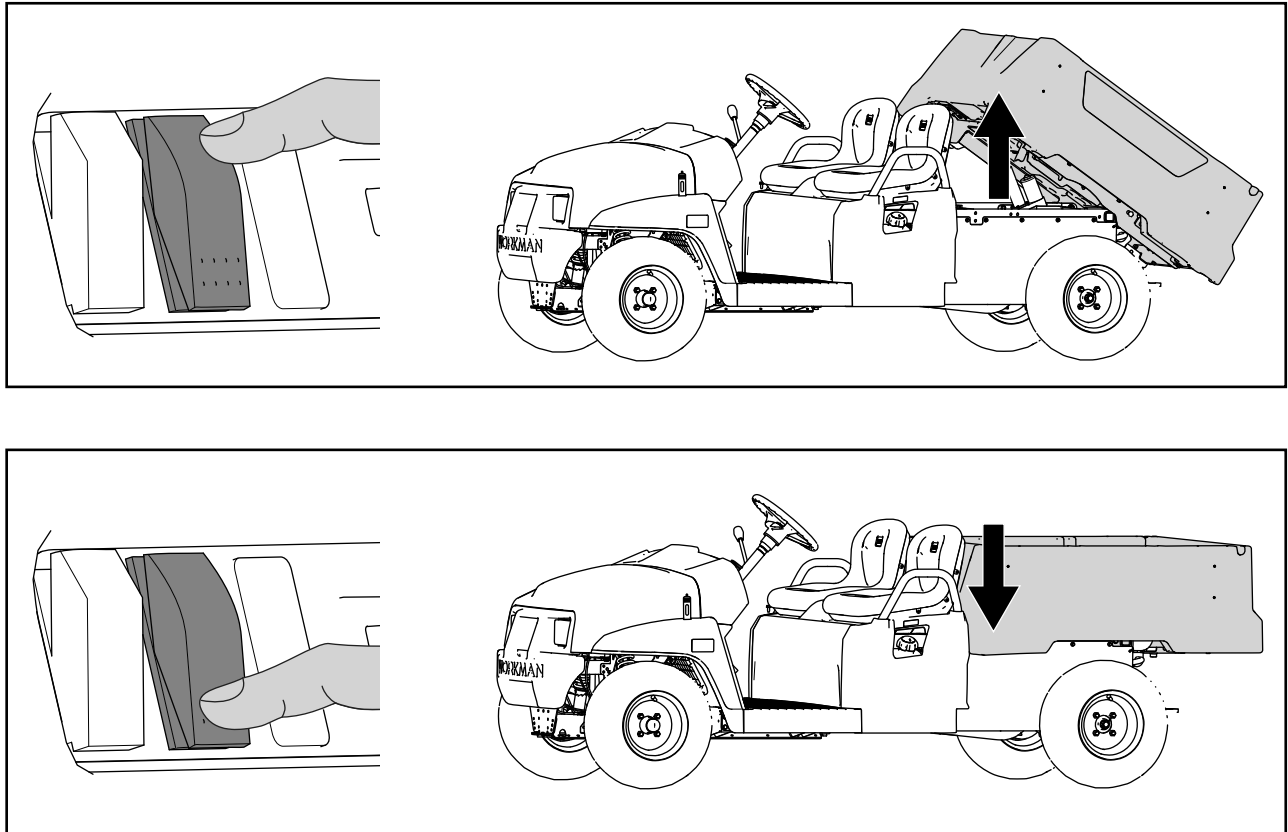

g036086

g036086

Figure 17

Declaration of Incorporation

Model No.	Serial No.	Product Description	Invoice Description	General Description	Directive
07143	404500001 and Up	48V Electric Lift Kit, Workman GTX Utility Vehicle	48V ELECTRIC LIFT KIT, WORKMAN GT	Utility Vehicle	2006/42/EC, 2014/30/EU
07144	404500000 and Up	12V Electric Lift Kit, Workman GTX Utility Vehicle	12V ELECTRIC LIFT KIT, WORKMAN GT	Utility Vehicle	2006/42/EC, 2014/30/EU

Relevant technical documentation has been compiled as required per Part B of Annex VII of 2006/42/EC.

We will undertake to transmit, in response to requests by national authorities, relevant information on this partly completed machinery. The method of transmission shall be electronic transmittal.

This machinery shall not be put into service until incorporated into approved Toro models as indicated on the associated Declaration of Conformity and in accordance with all instructions, whereby it can be declared in conformity with all relevant Directives.

Certified:



Tom Langworthy
Engineering Director
8111 Lyndale Ave. South
Bloomington, MN 55420, USA
October 25, 2022

Authorized Representative:

Marcel Dutrieux
Manager European Product Integrity
Toro Europe NV
Nijverheidsstraat 5
2260 Oevel
Belgium

UK Declaration of Incorporation

Model No.	Serial No.	Product Description	Invoice Description	General Description	Regulation
07143	404500001 and Up	48V Electric Lift Kit, Workman GTX Utility Vehicle	48V ELECTRIC LIFT KIT, WORKMAN GT	Utility Vehicle	S.I. 2008 No. 1597, S.I. 2016 No. 1091
07144	404500000 and Up	12V Electric Lift Kit, Workman GTX Utility Vehicle	12V ELECTRIC LIFT KIT, WORKMAN GT	Utility Vehicle	S.I. 2008 No. 1597, S.I. 2016 No. 1091

Relevant technical documentation has been compiled as required per Schedule 10 of S.I. 2008 No. 1597.

We will undertake to transmit, in response to requests by national authorities, relevant information on this partly completed machinery. The method of transmission shall be electronic transmittal.

This machinery shall not be put into service until incorporated into approved Toro models as indicated on the associated Declaration of Conformity and in accordance with all instructions, whereby it can be declared in conformity with all relevant Directives.

This declaration has been issued under the sole responsibility of the manufacturer.
The object of the declaration is in conformity with relevant UK legislation.



Tom Langworthy
Engineering Director
8111 Lyndale Ave. South
Bloomington, MN 55420, USA
October 25, 2022

Authorized Representative:

Marcel Dutrieux
Manager European Product Integrity
Toro U.K. Limited
Spellbrook Lane West
Bishop's Stortford
CM23 4BU
United Kingdom

EEA/UK Privacy Notice

Toro's Use of Your Personal Information

The Toro Company ("Toro") respects your privacy. When you purchase our products, we may collect certain personal information about you, either directly from you or through your local Toro company or dealer. Toro uses this information to fulfil contractual obligations - such as to register your warranty, process your warranty claim or to contact you in the event of a product recall - and for legitimate business purposes - such as to gauge customer satisfaction, improve our products or provide you with product information which may be of interest. Toro may share your information with our subsidiaries, affiliates, dealers or other business partners in connection these activities. We may also disclose personal information when required by law or in connection with the sale, purchase or merger of a business. We will never sell your personal information to any other company for marketing purposes.

Retention of your Personal Information

Toro will keep your personal information as long as it is relevant for the above purposes and in accordance with legal requirements. For more information about applicable retention periods please contact legal@toro.com.

Toro's Commitment to Security

Your personal information may be processed in the US or another country which may have less strict data protection laws than your country of residence. Whenever we transfer your information outside of your country of residence, we will take legally required steps to ensure that appropriate safeguards are in place to protect your information and to make sure it is treated securely.

Access and Correction

You may have the right to correct or review your personal data, or object to or restrict the processing of your data. To do so, please contact us by email at legal@toro.com. If you have concerns about the way in which Toro has handled your information, we encourage you to raise this directly with us. Please note that European residents have the right to complain to your Data Protection Authority.



The Toro Warranty

Two-Year or 1,500 Hours Limited Warranty

Conditions and Products Covered

The Toro Company warrants your Toro Commercial product ("Product") to be free from defects in materials or workmanship for 2 years or 1,500 operational hours*, whichever occurs first. This warranty is applicable to all products with the exception of Aerators (refer to separate warranty statements for these products). Where a warrantable condition exists, we will repair the Product at no cost to you including diagnostics, labor, parts, and transportation. This warranty begins on the date the Product is delivered to the original retail purchaser.

* Product equipped with an hour meter.

Instructions for Obtaining Warranty Service

You are responsible for notifying the Commercial Products Distributor or Authorized Commercial Products Dealer from whom you purchased the Product as soon as you believe a warrantable condition exists. If you need help locating a Commercial Products Distributor or Authorized Dealer, or if you have questions regarding your warranty rights or responsibilities, you may contact us at:

Toro Commercial Products Service Department
8111 Lyndale Avenue South
Bloomington, MN 55420-1196

952-888-8801 or 800-952-2740
E-mail: commercial.warranty@toro.com

Owner Responsibilities

As the product owner, you are responsible for required maintenance and adjustments stated in your *Operator's Manual*. Repairs for product issues caused by failure to perform required maintenance and adjustments are not covered under this warranty.

Items and Conditions Not Covered

Not all product failures or malfunctions that occur during the warranty period are defects in materials or workmanship. This warranty does not cover the following:

- Product failures which result from the use of non-Toro replacement parts, or from installation and use of add-on, or modified non-Toro branded accessories and products.
- Product failures which result from failure to perform recommended maintenance and/or adjustments.
- Product failures which result from operating the Product in an abusive, negligent, or reckless manner.
- Parts consumed through use that are not defective. Examples of parts which are consumed, or used up, during normal Product operation include, but are not limited to, brake pads and linings, clutch linings, blades, reels, rollers and bearings (sealed or greasable), bed knives, spark plugs, castor wheels and bearings, tires, filters, belts, and certain sprayer components such as diaphragms, nozzles, flow meters, and check valves.
- Failures caused by outside influence, including, but not limited to, weather, storage practices, contamination, use of unapproved fuels, coolants, lubricants, additives, fertilizers, water, or chemicals.
- Failure or performance issues due to the use of fuels (e.g. gasoline, diesel, or biodiesel) that do not conform to their respective industry standards.
- Normal noise, vibration, wear and tear, and deterioration. Normal "wear and tear" includes, but is not limited to, damage to seats due to wear or abrasion, worn painted surfaces, scratched decals or windows.

Countries Other than the United States or Canada

Customers who have purchased Toro products exported from the United States or Canada should contact their Toro Distributor (Dealer) to obtain guarantee policies for your country, province, or state. If for any reason you are dissatisfied with your Distributor's service or have difficulty obtaining guarantee information, contact your Authorized Toro Service Center.

Parts

Parts scheduled for replacement as required maintenance are warranted for the period of time up to the scheduled replacement time for that part. Parts replaced under this warranty are covered for the duration of the original product warranty and become the property of Toro. Toro will make the final decision whether to repair any existing part or assembly or replace it. Toro may use remanufactured parts for warranty repairs.

Deep Cycle and Lithium-Ion Battery Warranty

Deep cycle and Lithium-Ion batteries have a specified total number of kilowatt-hours they can deliver during their lifetime. Operating, recharging, and maintenance techniques can extend or reduce total battery life. As the batteries in this product are consumed, the amount of useful work between charging intervals will slowly decrease until the battery is completely worn out. Replacement of worn out batteries, due to normal consumption, is the responsibility of the product owner. Note: (Lithium-Ion battery only): Refer to the battery warranty for additional information.

Lifetime Crankshaft Warranty (ProStripe 02657 Model Only)

The ProStripe which is fitted with a genuine Toro Friction Disc and Crank-Safe Blade Brake Clutch (integrated Blade Brake Clutch (BBC) + Friction Disc assembly) as original equipment and used by the original purchaser in accordance with recommended operating and maintenance procedures, are covered by a Lifetime Warranty against engine crankshaft bending. Machines fitted with friction washers, Blade Brake Clutch (BBC) units and other such devices are not covered by the Lifetime Crankshaft Warranty.

Maintenance is at Owner's Expense

Engine tune-up, lubrication, cleaning and polishing, replacement of filters, coolant, and completing recommended maintenance are some of the normal services Toro products require that are at the owner's expense.

General Conditions

Repair by an Authorized Toro Distributor or Dealer is your sole remedy under this warranty.

The Toro Company is not liable for indirect, incidental or consequential damages in connection with the use of the Toro Products covered by this warranty, including any cost or expense of providing substitute equipment or service during reasonable periods of malfunction or non-use pending completion of repairs under this warranty. Except for the Emissions warranty referenced below, if applicable, there is no other express warranty. All implied warranties of merchantability and fitness for use are limited to the duration of this express warranty.

Some states do not allow exclusions of incidental or consequential damages, or limitations on how long an implied warranty lasts, so the above exclusions and limitations may not apply to you. This warranty gives you specific legal rights, and you may also have other rights which vary from state to state.

Note Regarding Emissions Warranty

The Emissions Control System on your Product may be covered by a separate warranty meeting requirements established by the U.S. Environmental Protection Agency (EPA) and/or the California Air Resources Board (CARB). The hour limitations set forth above do not apply to the Emissions Control System Warranty. Refer to the Engine Emission Control Warranty Statement supplied with your product or contained in the engine manufacturer's documentation.