



Hitch Kit

72in Z Master 4000 Series Riding Mower

Model No. 147-6292

Installation Instructions

Safety

Towing Safety

- Do not attach towed equipment except at the hitch point.
- Do not use the machine as a towing vehicle unless it has a hitch installed.
- Do not exceed the maximum gross towing weight.
- Never allow children or others near the towed equipment.
- On slopes, the weight of the towed equipment may cause loss of traction, increased risk of rollover, and loss of control. Reduce the towed weight and slow down.
- The stopping distance may increase with the weight of a towed load. Travel slowly and allow extra distance to stop.
- Make wide turns to keep the attachment clear of the machine.

Installation

Installing the Hitch

Parts Required

1	Muffler guard and hitch mount
4	Locknut

1. Park the machine on a level surface, disengage the blade-control switch, and engage the parking brake.
2. Shut off the engine, remove the key, and wait for all moving parts to stop before leaving the operating position.



3. Allow the machine to cool.



CAUTION



Contact with hot surfaces may cause personal injury.

Keep your hands, feet, face, clothing, and other body parts away the engine, muffler, and other hot surfaces.

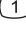
4. Remove the existing muffler guard  by removing the bolts and nuts.

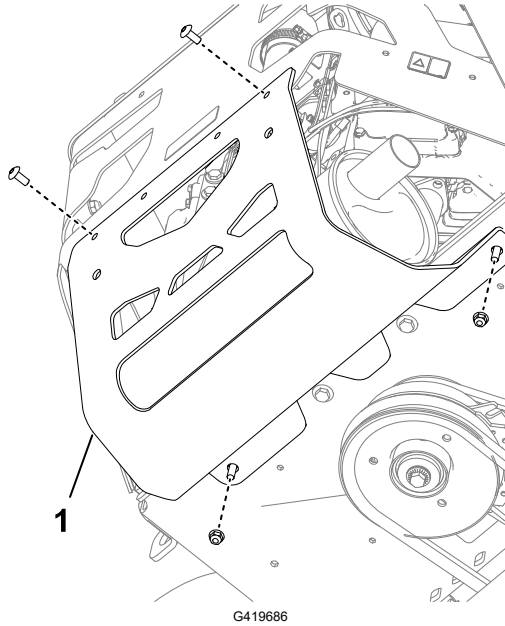

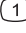
5. Install the new muffler guard and hitch mount  using the removed bolts and new locknuts.

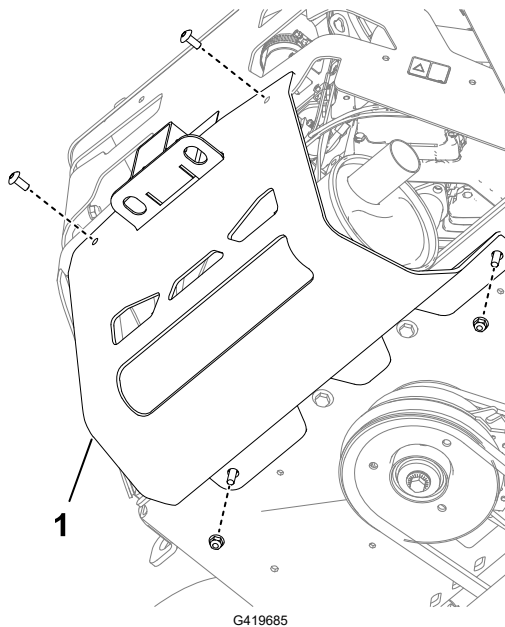

6. Torque the locknuts to **20 to 25 N·m (15 to 19 ft-lb)**.

Operation

Towing a Trailer

The machine is capable of pulling trailers and attachments. Contact your Authorized Service Dealer for the available tow hitches.

Your machine can tow loads with a maximum gross towing weight (GTW) of up to 113 kg (250 lb).

Do not exceed 22 kg (49 lb) of tongue weight on the tow hitch of the machine.

When hauling cargo or towing a trailer, do not overload the machine or trailer. Overloading can cause poor performance or damage to the hydraulic-drive units, tires, and frame.

1. Park the machine on a level surface, disengage the blade-control switch (PTO), and engage the parking brake.
2. Shut off the engine, remove the key, and wait for all moving parts to stop before leaving the operating position.
3. Insert the hitch ball mount into the receiver located at the rear of the machine.
4. Insert the hitch pin through the hole in the receiver and the hitch ball mount.
5. Secure the hitch using the hairpin cotter.

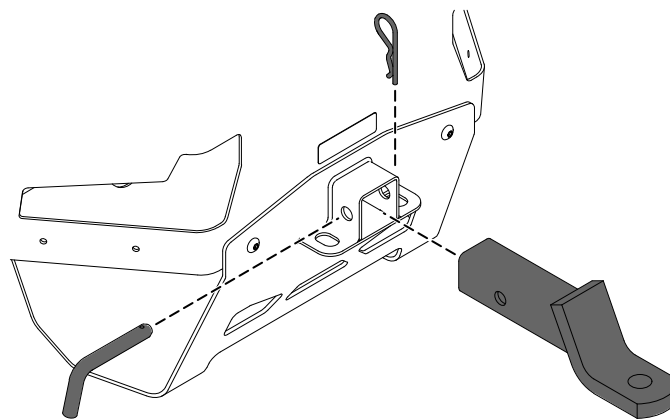

G419731

