

Traction Assist Handle Kit

Model No. 59196

Installation Instructions

Contents of the Kit

DESCRIPTION	QUANTITY
Traction assist handle	1
Carriage bolts	2
Locknuts	2

Installing the Traction Assist Handle

For Models without Pre-drilled Holes in the Handle

1. Stop the engine, wait for all moving parts to stop, and disconnect the wire from the spark plug.
2. Loosen the cable support nut (Fig. 1).

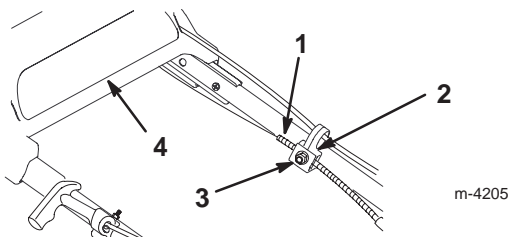

Figure 1

1. Cable jacket
2. Cable support
3. Nut
4. Upper handle

3. Remove the starter rope from the rope guide.
 4. Remove the upper handle from the lower handle.
- Note:** Do not disconnect the cables from the lawn mower.
5. Push the handle all the way inward (as shown in Figure 2), and lay the upper handle on a flat surface.

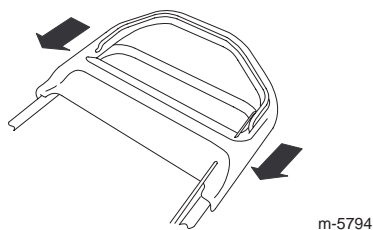

Figure 2

6. Center the traction assist handle on the upper handle bar, and ensure that the upper part of the handle curves rearward and touches the upper handle (Fig. 3).

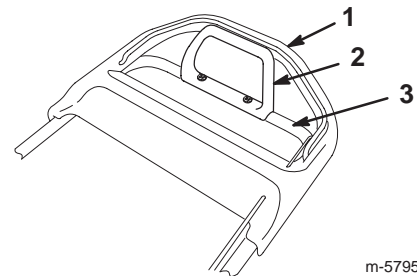

Figure 3

1. Upper handle
2. Traction assist handle
3. Upper handle bar

7. Punch a mark through each of the 2 traction assist handle holes and into the upper handle bar.
8. Drill 2 holes (5/16 in. diameter) through the punch marks and out the other side of the upper handle bar.
9. Install the upper handle onto the lawn mower.
10. Adjust the drive cable. Refer to your *Operator's Manual* for adjusting the drive cable.
11. Position the traction assist handle over the holes in the upper handle bar (Fig. 4).

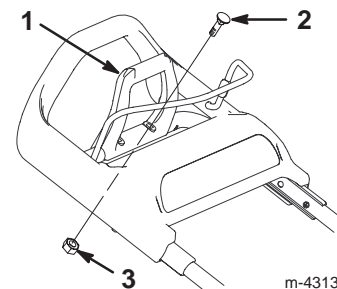

Figure 4

1. Traction assist handle
2. Carriage bolt (2)
3. Locknut (2)

12. Use the carriage bolts and locknuts supplied in the kit to fasten the traction assist handle to the upper handle bar (Fig. 4). Tighten the locknuts until the traction assist handle no longer flexes, but **do not overtighten**.
13. Install the starter rope in the rope guide, and connect the wire to the spark plug.

Installing the Traction Assist Handle

For Models with Pre-drilled Holes in the Handle

1. Stop the engine, and wait for all moving parts to stop, and disconnect the wire from the spark plug.
2. Remove the handle cover from the upper handle bar (Fig. 5).

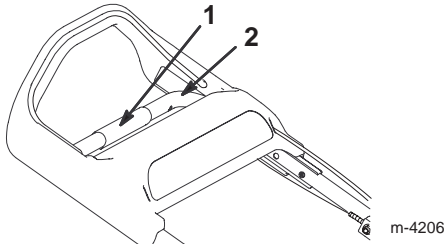

Figure 5

1. Handle cover
2. Upper handle bar

3. Position the traction assist handle over the holes in the upper handle bar (Fig. 6). Ensure that the upper part of the traction assist handle curves rearward.

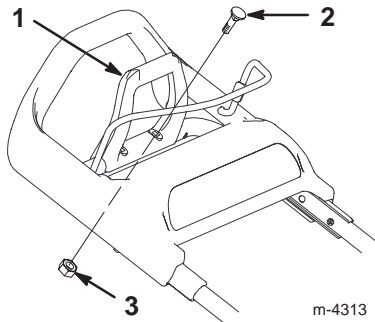

Figure 6

1. Traction assist handle
2. Carriage bolt (2)
3. Locknut (2)

4. Use the carriage bolts and locknuts supplied in the kit to fasten the traction assist handle to the upper handle bar (Fig. 6). Tighten the locknuts until the traction assist handle no longer flexes, but **do not overtighten**.
5. Connect the wire to the spark plug.

Using the Traction Assist Handle

1. Reach forward with your fingertips and grasp the corners of the traction assist handle (Fig. 7).

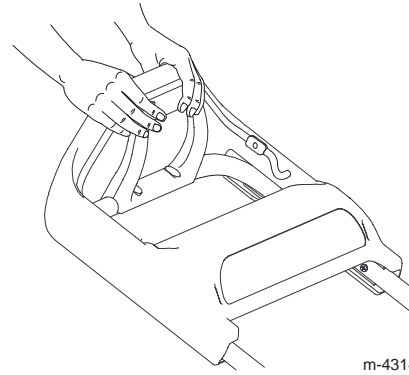

Figure 7

2. Squeeze the 2 handles together until the lawn mower achieves your desired ground speed. When you no longer need to use the traction assist feature, release your fingertips from the traction assist handle.

Important The lawn mower will continue to self-propel until you release the traction assist handle and stop walking.