



PART NO. 14-5159

INSTALLATION  
INSTRUCTIONS

## GAS STRUT DAMPER SYSTEM KIT

The Gas Strut Damper System Kit is for the following models of garden tractors:

YEAR	MODEL	IDENTIFICATION NUMBERS
1988-91	310-8	21-10K805, 21-10K806, 31-10K801, 31-10K802
1988-91	312-8	21-12K805, 21-12K806, 31-12K801, 31-12K802
1988-90	416-8	31-16K804, 31-160801, 31-160802
1990	520-8	41-200801

## KIT CONTENTS

PART NO.	PART DESCRIPTION	QUANTITY
78-3240	Gas Strut	1
78-3250	Spacer (long)	1
78-3260	Spacer (short)	1
908004	Bolt $\frac{1}{4}$ -20 x $\frac{7}{8}$	1
908007	Bolt $\frac{1}{4}$ -20 x $1\frac{1}{2}$	1
915661	E.S. Nut $\frac{1}{4}$ -20	1
915111	Nut $\frac{1}{4}$ -20	1
920081	Lockwasher $\frac{1}{4}$	1
920007	Washer $\frac{1}{4}$ SAE	2

### INSTALL GAS STRUT

1. Remove right hand footrest and belt cover.
2. Remove and discard hydraulic damper and mounting bracket.

3. Remove and discard hoodstand bolt (Fig. 1). Measure two inches from the hoodstand bolt hole and drill a  $1\frac{7}{64}$ " (.265"/6.75 mm) diameter hole through the hoodstand and frame as shown in Figure 1.

4. Remove the V-idler pulley (Fig. 1).

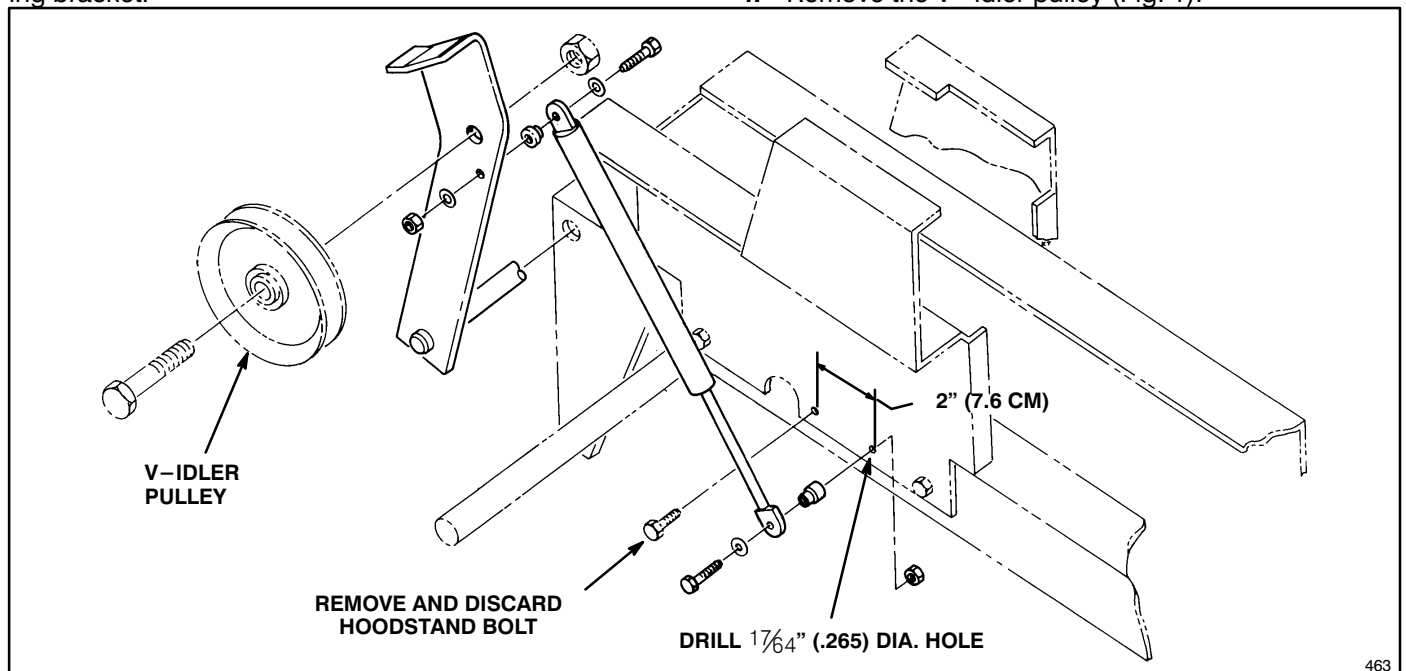

Figure 1  
© The TORO Company -1991

5. Locate and drill a  $1\frac{7}{64}$ " (.265"/6.75 mm) diameter hole through the idler arm as shown in Figure 2.

6. Assemble gas strut as shown in Figure 3.

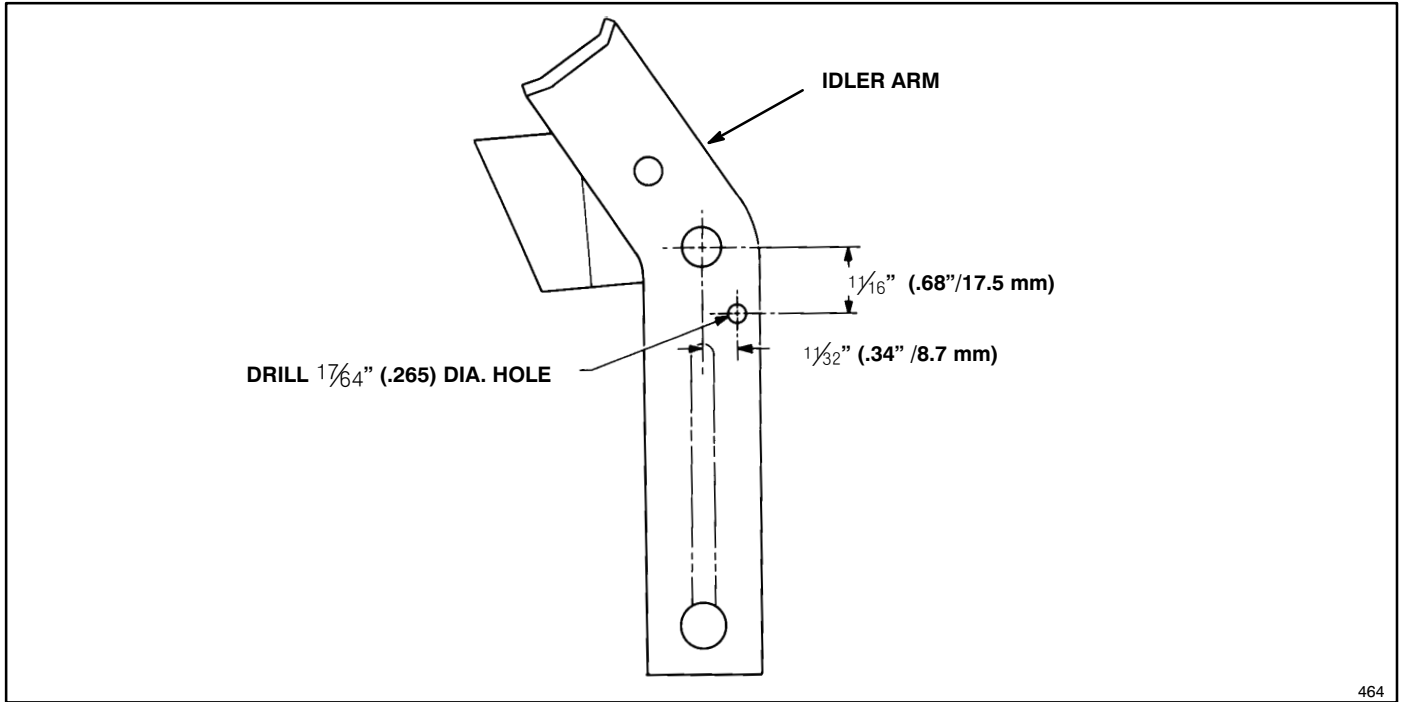

Figure 2

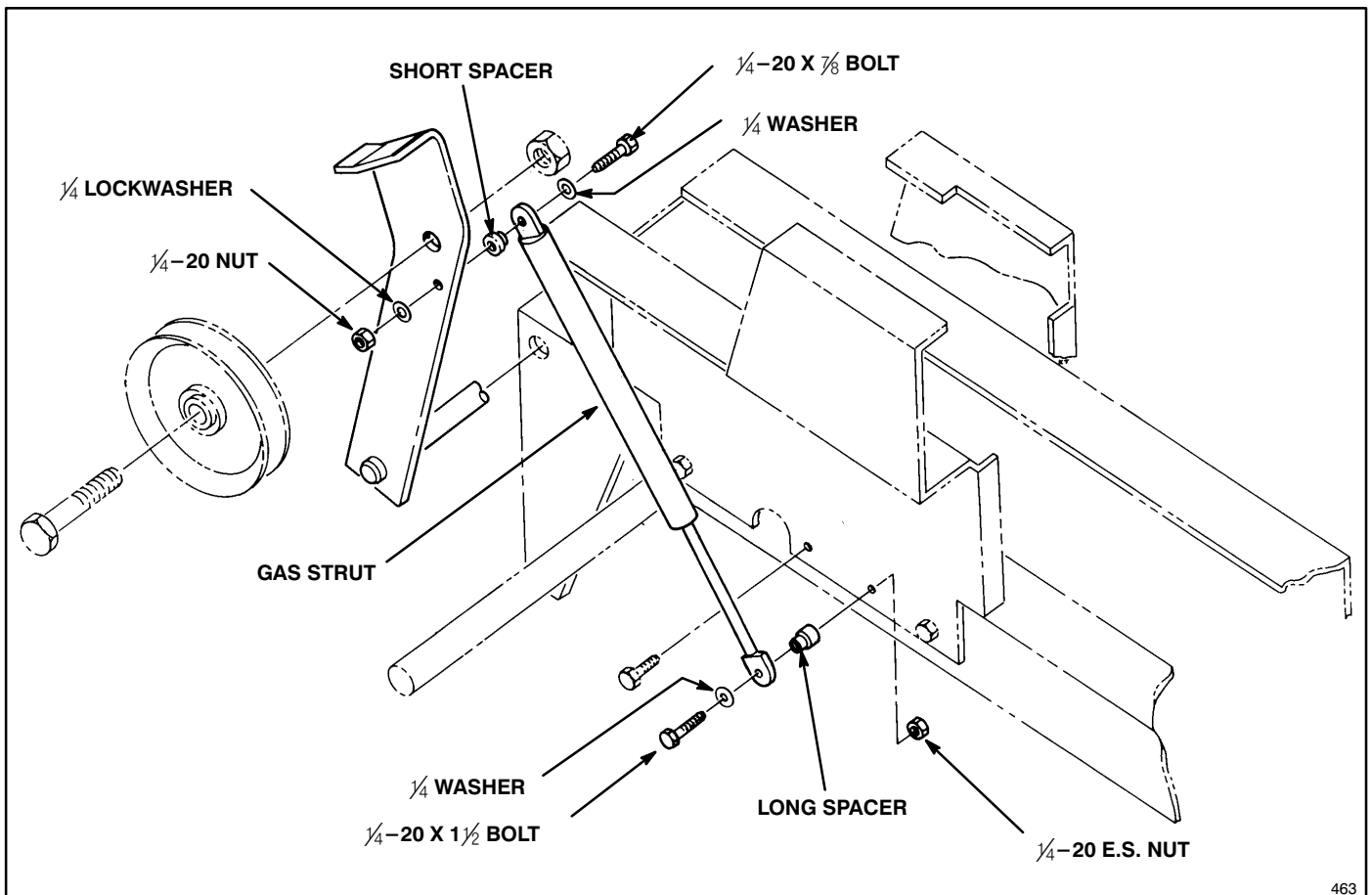

Figure 3

464

463