



Engine Service Kit

Commercial Mower Traction Units

Model No. 134-5005

Model No. 134-5127

Model No. 134-7567

Installation Instructions

Note: Your new engine is different than the original engine. Use these instructions to identify the changes to make the new engine compatible.

Installation

1

Preparing the Machine

No Parts Required

Procedure

Note: Determine the left and right sides of the machine from the normal operating position.

Note: You can use a hoist for better access under the machine.

1. Park the machine on a level surface.
2. Engage the parking brake.
3. Shut off the engine and remove the key.
4. Allow the machine to cool.

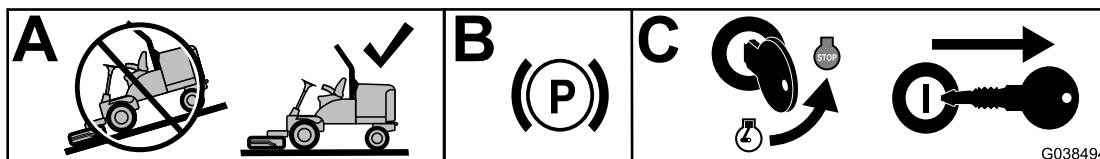

Figure 1

g387526



2

Disconnecting the Battery

No Parts Required

Procedure

⚠ WARNING

Incorrect battery cable routing could damage the machine and cables, causing sparks. Sparks can cause the battery gasses to explode, resulting in personal injury.

- Always disconnect the negative (black) battery cable before disconnecting the positive (red) cable.
- Always connect the positive (red) battery cable before connecting the negative (black) cable.
- Always keep the battery strap in place to protect and secure the battery.

⚠ WARNING

Battery terminals or metal tools could short against metal machine components, causing sparks. Sparks can cause the battery gasses to explode, resulting in personal injury.

- When removing or installing the battery, do not allow the battery terminals to touch any metal parts of the machine.
- Do not allow metal tools to short between the battery terminals and metal parts of the machine.

1. Disconnect the negative-battery cable from the terminal of the battery (Figure 2).
2. Disconnect the positive battery cable from the terminal of the battery (Figure 2).

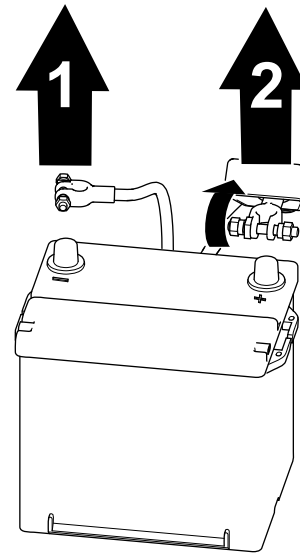

g289503

Figure 2

1. Negative battery cable
2. Positive battery cable

3

Configuring the Replacement Engine (Model V1505-NA) for the Groundsmaster® 3400 and LT3340 Traction Unit

No Parts Required

Procedure

Note: Ensure that all required Toro parts are removed from the old engine. The existing parts may include the throttle bracket, air cleaner bracket, fuel hoses, electrical connections, flywheel coupling, or bell-housing.

1. Remove the parts shown in [Figure 3](#) from the old engine and install them onto the new engine.

Note: If parts are not available from the old engine or are damaged, refer to your parts manual for ordering replacement parts.

2. Use the Kubota Engine *Service Manual* to install the new engine.
3. Set the low-idle engine speed to 1600 rpm.

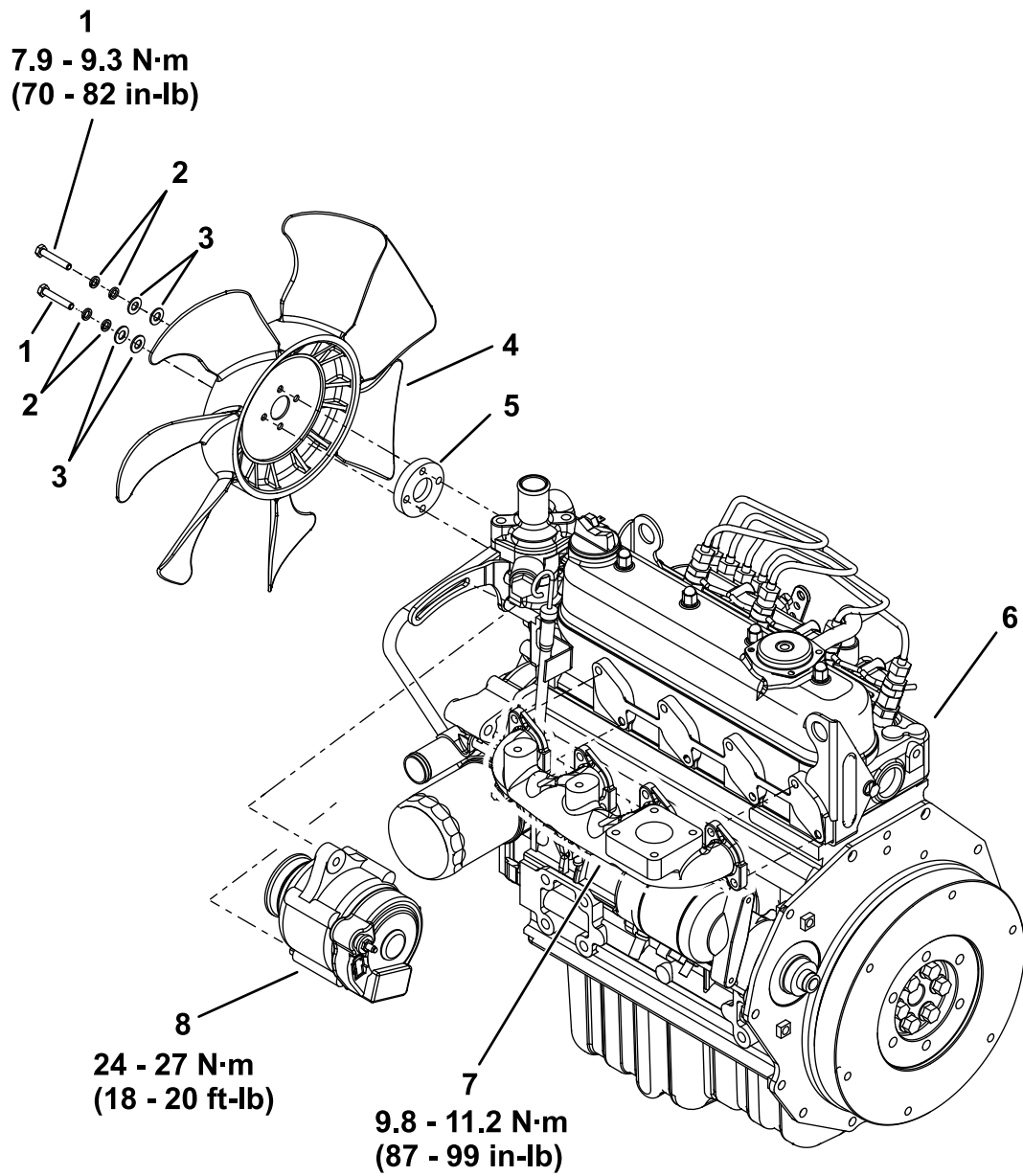

g386223

Figure 3

- | | | |
|--------------------------|---------------|---------------------|
| 1. Setscrew (M6 x 35 mm) | 4. Fan | 7. Exhaust manifold |
| 2. Spring washers (M6) | 5. Fan collar | 8. Alternator |
| 3. Washers (M6) | 6. Engine | |

4

Configuring the Replacement Engine (Model V1505-T) for the LT-F3000 Traction Unit

No Parts Required

Procedure

Note: Ensure that all required Toro parts are removed from the old engine. The existing parts may include the throttle bracket, air cleaner bracket, fuel hoses, electrical connections, flywheel coupling, or bell-housing.

1. Order a new oil filter and exhaust gasket ([Figure 4](#)). Refer to the Toro *Parts Manual* for the correct part numbers.
2. Other than the oil filter and exhaust gasket, remove the parts shown in [Figure 4](#) from the old engine and install them onto the new engine, including the new oil filter and exhaust gasket.

Note: If parts are not available from the old engine or are damaged, refer to your parts manual for ordering replacement parts.

3. Use the Kubota Engine *Service Manual* to install the new engine.
4. Set the low-idle engine speed to 2000 rpm.

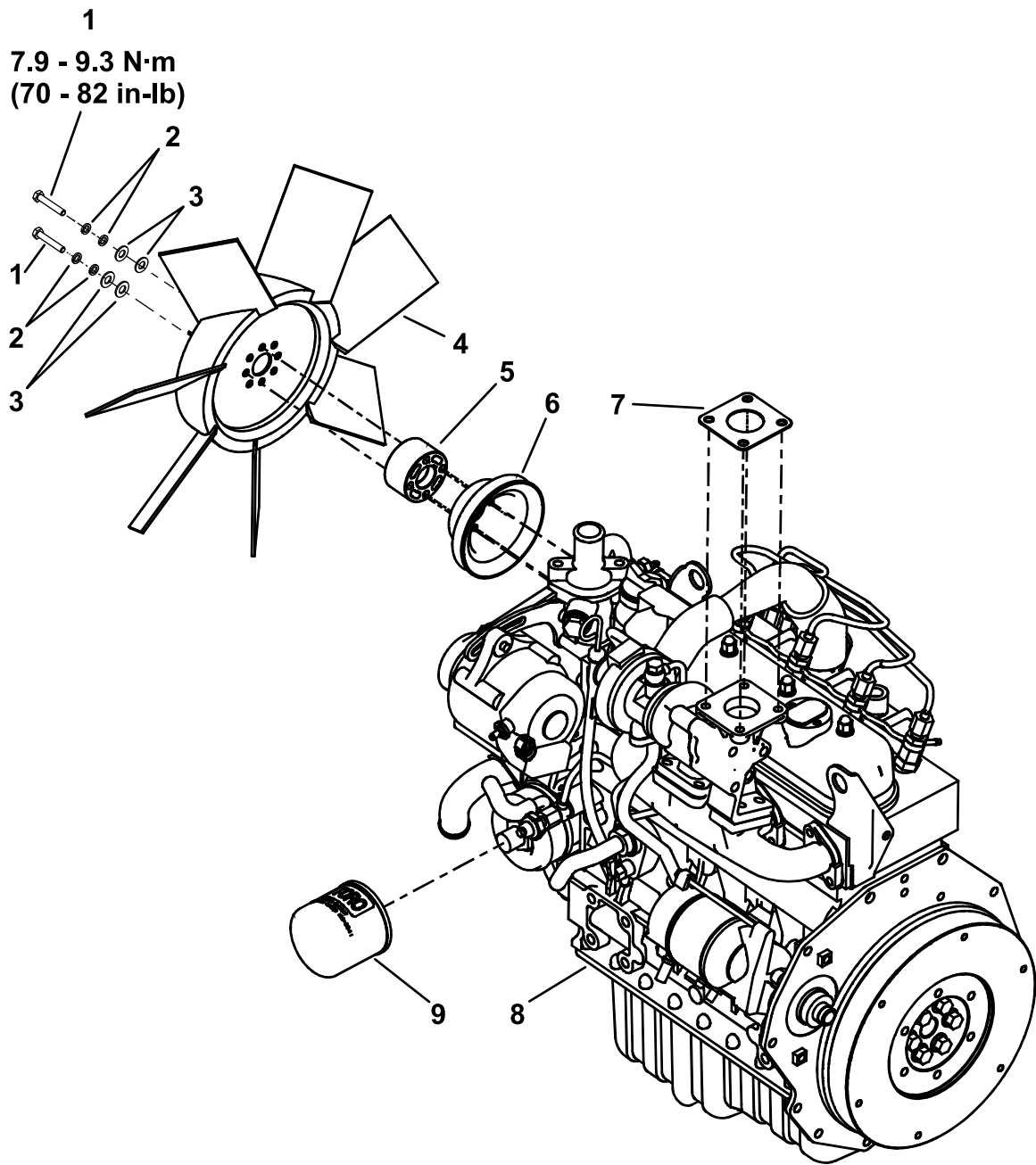

1
7.9 - 9.3 N·m
(70 - 82 in-lb)

Figure 4

g387403

- | | | |
|--------------------------|---------------|-----------------------|
| 1. Setscrew (M6 x 45 mm) | 4. Fan | 7. New muffler gasket |
| 2. Spring washers (M6) | 5. Fan spacer | 8. Engine |
| 3. Washers (M6) | 6. Fan pulley | 9. New oil filter |

5

Configuring the Replacement Engine (Model V2203-NA) for the T4240 Traction Unit

No Parts Required

Procedure

Note: Ensure that all required Toro parts are removed from the old engine. The existing parts may include the throttle bracket, air cleaner bracket, fuel hoses, electrical connections, flywheel coupling, or bell-housing.

1. Remove the parts shown in [Figure 5](#) from the old engine and install them onto the new engine.

Note: If parts are not available from the old engine or are damaged, refer to your parts manual for ordering replacement parts.

2. Use the Kubota Engine *Service Manual* to install the new engine.
3. Set the low-idle engine speed to 1200 rpm.

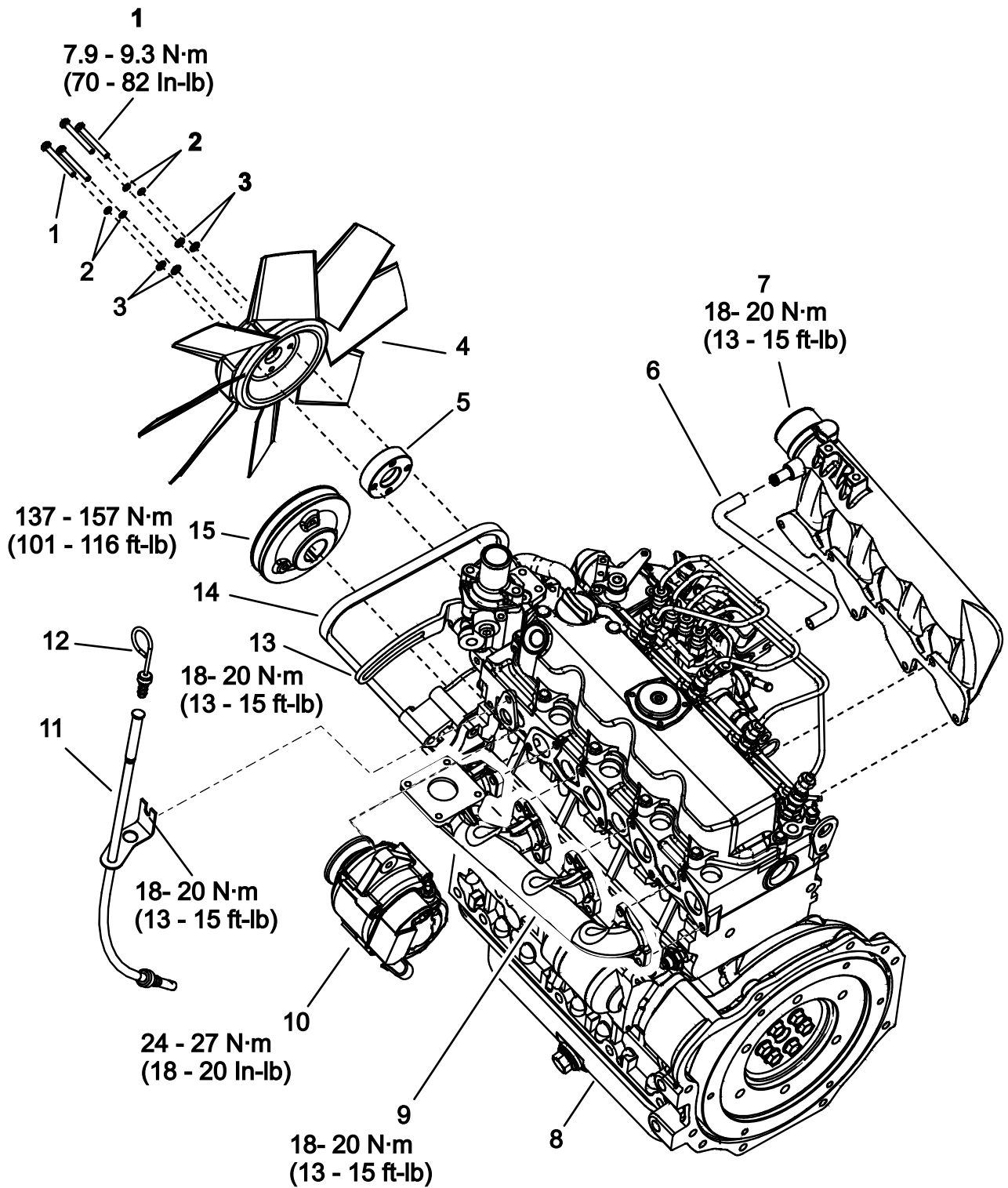

Figure 5

g387402

- | | | | |
|--------------------------|--------------------|---------------------|----------------------|
| 1. Setscrew (M6 x 50 mm) | 5. Fan spacer | 9. Exhaust manifold | 13. Bracket |
| 2. Spring washers (M6) | 6. Breather hose | 10. Alternator | 14. Belt |
| 3. Washers (M6) | 7. Intake manifold | 11. Dipstick tube | 15. Fan-drive pulley |
| 4. Fan | 8. Engine | 12. Dipstick gauge | |

6

Connecting the Battery

No Parts Required

Procedure

1. Connect the positive battery cable to the terminal of the battery (Figure 6).
2. Connect the negative battery cable to the terminal of the battery (Figure 6).

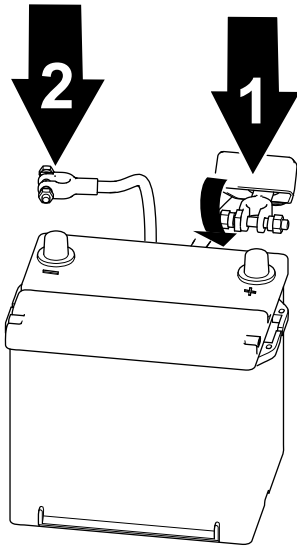

g289502

Figure 6

1. Positive battery cable
2. Negative battery cable

-
3. Install the battery cover.

Notes:

Notes:



Count on it.