



**Count on it.**

**Operator's Manual**

# Flex-Force Power System™ 60V MAX 36cm and 43cm Lawn Mower

- Model No. 21836—Serial No. 321000001 and Up
- Model No. 21836T—Serial No. 321000001 and Up
- Model No. 21843—Serial No. 321000001 and Up
- Model No. 21843T—Serial No. 321000001 and Up
- Model No. 21844—Serial No. 321000001 and Up
- Model No. 21844T—Serial No. 321000001 and Up

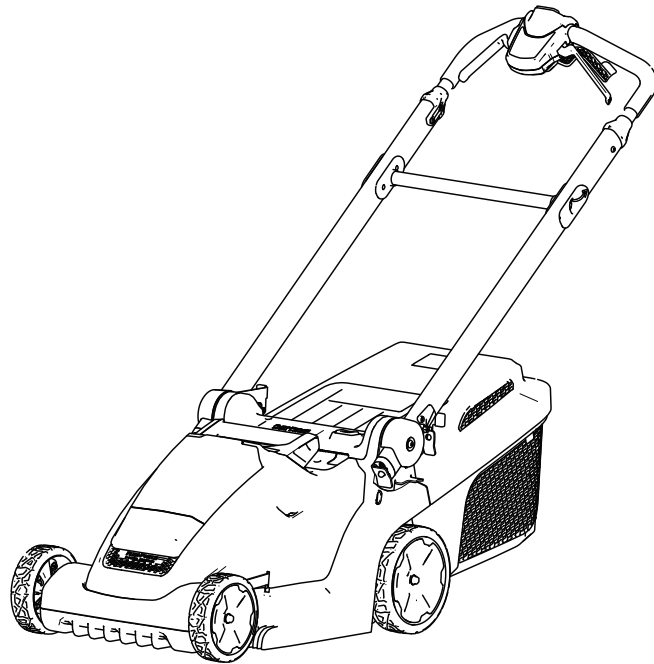

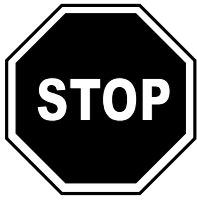

**For assistance, please see [www.Toro.com/support](http://www.Toro.com/support) or contact your Authorized Service Dealer before returning this product.**

This product complies with all relevant European directives; for details, please see the separate product specific Declaration of Conformity (DOC) sheet.

## Introduction

This rotary-blade, walk-behind lawn mower is intended to be used by residential homeowners. It is designed primarily for cutting grass on well-maintained lawns on residential properties. It is not designed for cutting brush or for agricultural uses. It is designed to use Toro Flex-Force lithium-ion battery pack Model 81825 (provided with Model 21836), Model 81850 (provided with Model 21843 and Model 21844) and 81860 or 81875. These battery packs are designed to be charged only by battery charger Model 81802 (provided with Models 21836, 21843, and 21844), or 81805. Using these products for purposes other than their intended use could prove dangerous to you and bystanders.

**Models 21836T, 21843T, and 21844T do not include a battery or a charger.**

Read this information carefully to learn how to operate and maintain your product properly and to avoid injury and product damage. You are responsible for operating the product properly and safely.

Visit [www.Toro.com](http://www.Toro.com) for more information, including safety tips, training materials, accessory information, help finding a dealer, or to register your product.

Whenever you need service, genuine the manufacturer parts, or additional information, contact an Authorized Service Dealer or the manufacturer Customer Service and have the model and serial numbers of your product ready. **Figure 1** identifies the location of the model and serial numbers on the product. Write the numbers in the space provided.

**Important:** With your mobile device, you can scan the QR code on the serial number decal (if equipped) to access warranty, parts, and other product information.

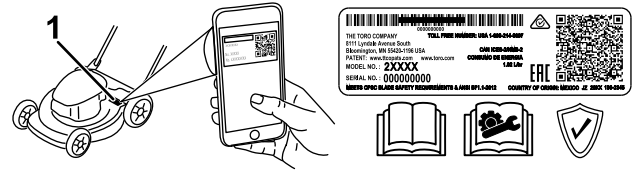

**Figure 1**

1. Model and serial number location

<p><b>Model No.</b> _____</p> <p><b>Serial No.</b> _____</p>
--

This manual identifies potential hazards and has safety messages identified by the safety-alert symbol (**Figure 2**), which signals a hazard that may cause serious injury or death if you do not follow the recommended precautions.



**Figure 2**

Safety-alert symbol

This manual uses 2 words to highlight information. **Important** calls attention to special mechanical information and **Note** emphasizes general information worthy of special attention.

# Contents

Safety .....	3
Safety and Instructional Decals .....	5
Setup .....	8
1 Mounting the Battery Charger (Optional) .....	8
2 Assembling the Handle .....	9
Product Overview .....	10
Specifications .....	10
Before Operation .....	11
Installing the Battery Pack .....	11
Adjusting the Cutting Height .....	12
During Operation .....	13
Starting the Machine .....	13
Using the Self-Propel Drive .....	13
Adjusting the Blade Speed .....	13
Recycling the Clippings .....	14
Bagging the Clippings .....	15
Shutting Off the Machine .....	17
Removing the Battery Pack from the Machine .....	17
Operating Tips .....	18
After Operation .....	18
Charging the Battery Pack .....	18
Cleaning the Machine .....	19
Folding the Handle .....	19
Storing the Machine in the Vertical-Stow Position .....	20
Maintenance .....	21
Lubricating the Machine .....	21
Replacing the Blade .....	21
Preparing the Battery Pack for Recycling .....	22
Storage .....	22
Service .....	22
Troubleshooting .....	23

# Safety

## IMPORTANT SAFETY INSTRUCTIONS

**WARNING**—When using an electric machine, always read and follow basic safety warnings and instructions to reduce the risk of fire, electric shock, or injury, including the following:

### I. Training

1. The operator of the machine is responsible for any accidents or hazards occurring to others or their property.
2. Do not allow children to use or play with the machine, battery pack, or the battery charger; local regulations may restrict the age of the operator.
3. Do not allow children or untrained people to operate or service the machine. Allow only people who are responsible, trained, familiar with the instructions, and physically capable to operate or service the machine.
4. Before using the machine, battery pack, and battery charger, read all the instructions and cautionary markings on these products.
5. Become familiar with the controls and proper use of the machine, battery pack, and battery charger.

### II. Preparation

1. Keep bystanders, especially children and pets, out of the operating area.
2. Do not operate the machine without all guards and safety devices, such as deflectors and grass catchers, in place and functioning properly on the machine.
3. Inspect the area where you will use the machine and remove all objects that could interfere with the operation of the machine or that the machine could throw.
4. Before using the machine, ensure that the blade, blade bolt, and blade assembly are not worn or damaged. Replace any damaged or unreadable labels.
5. Use only the battery pack specified by Toro. Using other accessories and attachments may increase the risk of injury and fire.
6. Plugging the battery charger into an outlet that is not 100 to 240 V can cause a fire or electric shock. Do not plug the battery charger into an outlet other than 100 to 240 V. For a different style of connection, use an attachment plug

adapter of the proper configuration for the power outlet if needed.

7. Do not use a damaged or modified battery pack or battery charger, which may exhibit unpredictable behavior that results in fire, explosion, or risk of injury.
8. If the supply cord to the battery charger is damaged, contact an Authorized Service Dealer to replace it.
9. Do not use non-rechargeable batteries.
10. Charge the battery pack with only the battery charger specified by Toro. A charger suitable for 1 type of battery pack may create a risk of fire when used with another battery pack.
11. Charge the battery pack in a well-ventilated area only.
12. Do not expose a battery pack or battery charger to fire or to temperatures higher than 68°C (154°F).
13. Follow all charging instructions and do not charge the battery pack outside of the temperature range specified in the instructions. Otherwise, you may damage the battery pack and increase the risk of fire.
14. Dress properly—Wear appropriate clothing, including eye protection; long pants; substantial, slip-resistant footwear (not barefoot or wearing sandals); and hearing protection. Tie back long hair and do not wear loose clothing or loose jewelry that can get caught in moving parts. Wear a dust mask in dusty operating conditions.

### III. Operation

1. Contact with the moving blade will cause serious injury. Keep your hands or feet away from the cutting area and all moving parts of the machine. Keep clear of any discharge opening.
2. Using this machine for purposes other than its intended use could prove dangerous to you and bystanders.
3. Disengage the self-propel drive (if equipped) before starting the machine.
4. Do not tilt the appliance when starting the motor.
5. Prevent unintentional starting—Ensure that the safety key is removed from the machine before connecting the battery pack and handling the machine.
6. Use your full attention while operating the machine. Do not engage in any activity that causes distractions; otherwise, injury or property damage may occur.
7. Stop the machine, remove the safety key, remove the battery pack from the machine, and

wait for all movement to stop before adjusting, servicing, cleaning, or storing the machine.

8. Remove the battery pack and safety key from the machine whenever you leave it unattended or before changing accessories.
9. Do not force the machine—Allow the machine to do the job better and safer at the rate for which it was designed.
10. Stay alert—Watch what you are doing and use common sense when operating the machine. Do not use the machine while ill, tired, or under the influence of alcohol or drugs.
11. Operate the machine only in good visibility and appropriate weather conditions. Do not operate the machine when there is the risk of lightning.
12. Use extreme caution when reversing or pulling the machine toward you.
13. Keep proper footing and balance at all times, especially on slopes. Mow across the face of slopes, never up and down. Use extreme caution when changing directions on slopes. Do not mow exceedingly steep slopes. Walk, never run with the machine.
14. Do not direct the discharge material toward anyone. Avoid discharging material against a wall or obstruction; material may ricochet toward you. Stop the blade(s) when crossing surfaces other than grass.
15. Watch for holes, ruts, bumps, rocks, or other hidden objects. Uneven terrain could cause you to lose your balance or footing.
16. Wet grass or leaves can cause serious injury if you slip and contact the blade. Avoid mowing in wet conditions or when it is raining.
17. If the machine strikes an object or starts to vibrate, immediately shut off the machine, remove the safety key, remove the battery pack, and wait for all movement to stop before examining the machine for damage. Make all necessary repairs before resuming operation.
18. Stop the machine and remove the safety key before loading the machine for hauling.
19. Under abusive conditions, the battery pack may eject liquid; avoid contact. If you accidentally come into contact with the liquid, flush with water. If the liquid contacts your eyes, seek medical help. Liquid ejected from the battery pack may cause irritation or burns.

### IV. Maintenance and Storage

1. Stop the machine, remove the safety key, remove the battery pack from the machine, and wait for all movement to stop before adjusting, servicing, cleaning, or storing the machine.

2. Do not attempt to repair the machine except as indicated in the instructions. Have an Authorized Service Dealer perform service on the machine using identical replacement parts.
3. Wear gloves and eye protection when servicing the machine.
4. Replace the blade if it is bent, worn, or cracked. An unbalanced blade causes vibration, which could damage the motor or cause personal injury.
5. When servicing the blade, be aware that the blade can still move even though the power source is off.
6. Check the grass collection bag frequently for deterioration or wear, and replace a worn bag with a Toro [replacement] bag.
7. For best performance, use only genuine Toro replacement parts and accessories. Other replacement parts and accessories could be dangerous, and such use could void the product warranty.
8. Maintain the machine—Keep cutting edges sharp and clean for the best and safest performance. Keep handles dry, clean, and free from oil and grease. Keep guards in place and in working order. Keep blades sharp. Use identical replacement blades only.
9. Check the machine for damaged parts—If there are damaged guards or other parts, determine whether the machine will operate properly. Check for misaligned and binding moving parts, broken parts, mounting, and any other condition that may affect its operation. Unless indicated in the instructions, have an Authorized Service Dealer repair or replace a damaged guard or part.
10. When the battery pack is not in use, keep it away from metal objects such as paper clips, coins, keys, nails, and screws that can make a connection from 1 terminal to another. Shorting the battery terminals may cause burns or a fire.
11. Check the blade and motor mounting bolts frequently for tightness.
12. When you are not using the machine, store it indoors in a dry, secure place out of the reach of children.
13. CAUTION—A mistreated battery pack may present a risk of fire or chemical burn. Do not disassemble the battery pack. Do not heat the battery pack above 68°C (154°F) or incinerate it. Replace the battery pack with a genuine Toro battery pack only; using another type of battery pack may cause a fire or explosion. Keep battery packs out of the reach of children and in the original packaging until you are ready to use them.
14. Do not dispose of the battery in a fire. The cell may explode. Check with local codes for possible special disposal instructions.

## SAVE THESE INSTRUCTIONS

## Safety and Instructional Decals



Safety decals and instructions are easily visible to the operator and are located near any area of potential danger. Replace any decal that is damaged or missing.



decal134-6016

134-6016

1. Engine speed—slow
2. Engine speed—fast

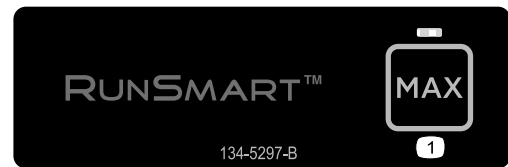

134-5297-B

134-5297

decal134-5297

1. Max Power Mode

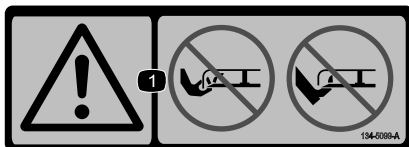

decal134-5099

134-5099

1. Warning—keep hands and feet away from the mower blade.

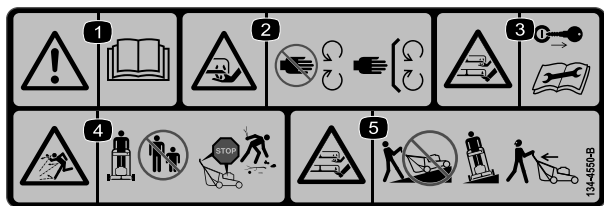

decal134-4550

**134-4550**

1. Warning—read the *Operator's Manual*.
2. Cutting/dismemberment hazard of hand, mower blade—stay away from moving parts; keep all guards and shields in place.
3. Cutting/dismemberment hazard of hand or foot, mower blade—remove the key and read the *Operator's Manual* before performing maintenance.
4. Thrown object hazard—keep bystanders away; shut off the engine before leaving the operating position; pick up any debris before mowing.
5. Cutting/dismemberment hazard of hand or foot, mower blade—do not operate up and down slopes; operate side to side on slopes; look behind you when moving in reverse.



decal137-9487

**137-9487**

1. Read the *Operator's Manual*.
2. Recycle the battery properly.
3. Do not discard.
4. Do not expose to flame.
5. Do not expose to rain.

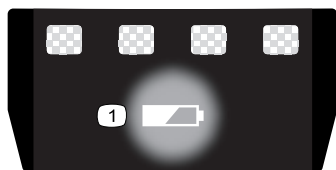

decal137-9461

**137-9461**

1. Battery charge status



decal140-2158

**140-2158**

1. Read the *Operator's Manual*.
2. Recycle the battery properly.
3. Do not discard.
4. Do not expose to flame.
5. Do not expose to rain.

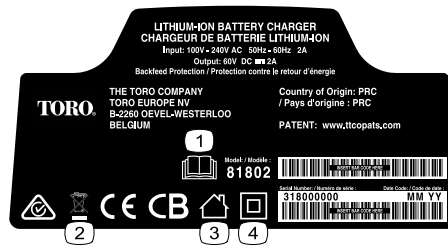

decal137-9495

**137-9495**

1. Read the *Operator's Manual*.
2. Do not discard.
3. For indoor use.
4. Double insulated.



decal137-9463

**137-9463**

1. The battery pack is charging.
2. The battery pack is fully charged.
3. The battery pack is over or under the appropriate temperature range.
4. Battery pack charging fault

# Setup

**Important:** The battery pack is not fully charged when it is purchased. Before using the machine for the first time, refer to [Charging the Battery Pack \(page 18\)](#).

**Note:** The safety key and all other loose parts have been placed in the battery compartment for safe delivery; ensure that you remove them from the compartment and store them in a safe place prior to assembly.

## 1

### Mounting the Battery Charger (Optional)

Parts needed for this procedure:

2	Mounting hardware (not included)
---	----------------------------------

#### Procedure

If desired, mount the battery charger securely on a wall using the wall-mount key holes on the back of the charger.

Mount it indoors (such as a garage or other dry place), near a power outlet, and out of the reach of children.

Refer to [Figure 3](#) for assistance in mounting the charger.

Slide the charger over the appropriately positioned hardware to secure the charger in place (hardware not included).

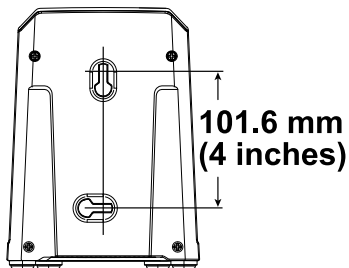

Figure 3

g290534



# 2

## Assembling the Handle

Parts needed for this procedure:

1	Upper handle assembly
2	Bolt
2	Locknut

### Procedure

**Important:** Remove and discard the protective plastic sheet that covers the mower and any other plastic or wrapping on the machine.

**Note:** Remove the rubber end-cap from the handle assembly prior to inserting the upper handle bar into the lower handle bar. These are added during manufacturing to prevent damage to the cables.

### ⚠ WARNING

Folding or unfolding the handle improperly can damage the cables, causing an unsafe operating condition.

- Do not damage the cables when folding or unfolding the handle.
- If a cable is damaged, contact an Authorized Service Dealer.

1. Install the upper handle assembly to the lower handle and secure it using 2 bolts and 2 locknuts as shown in [Figure 4](#).

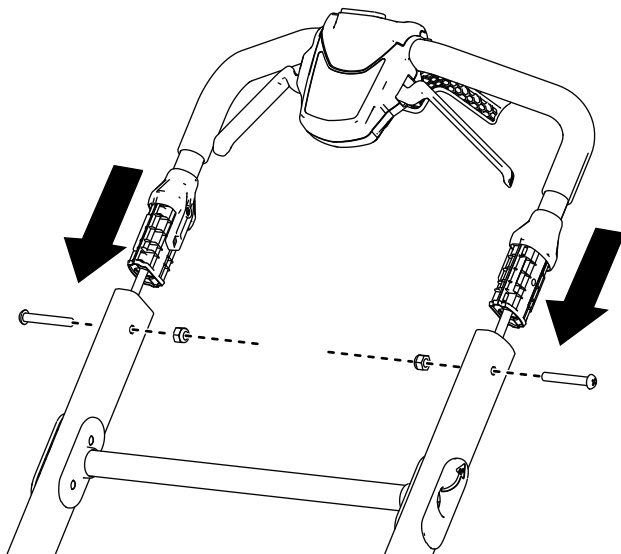

Figure 4

g342173

2. Pull the handlebar release brace toward the upper handle to release the handle lock ([Figure 5](#)).
3. Move the handle rearward to the operating position and let go of the handlebar release brace ([Figure 5](#)).

**Note:** Ensure that the handle clicks into place.

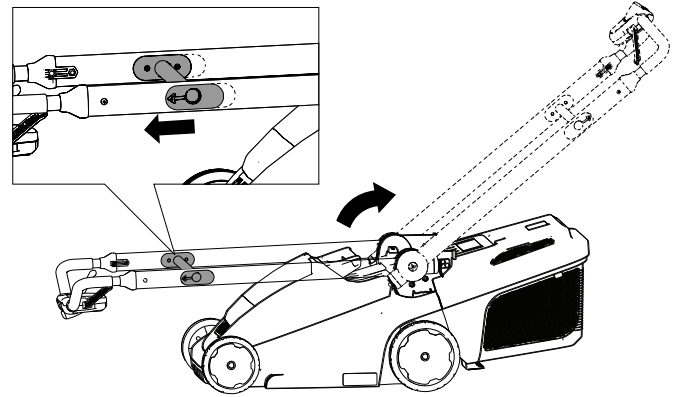

Figure 5

g341335

# Product Overview

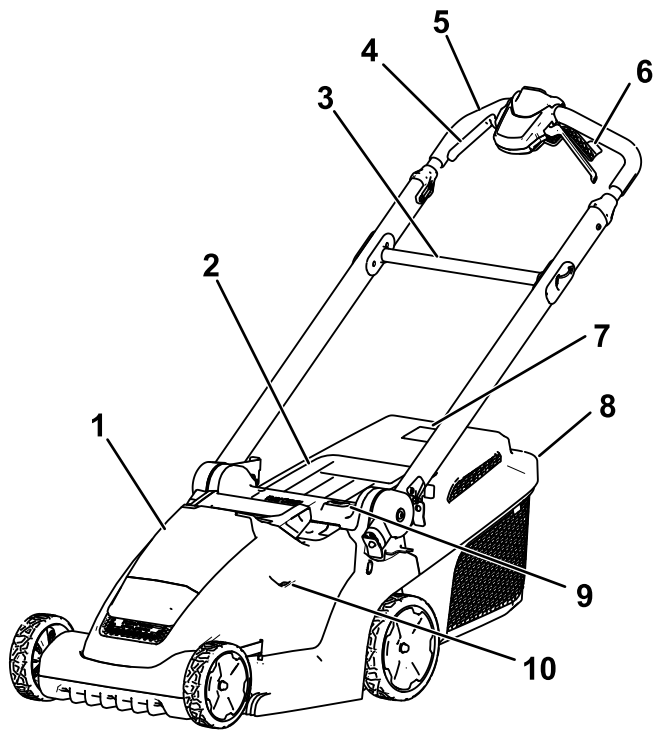

Figure 6

g364064

- |                            |   |
|----------------------------|---|
| 1. Battery compartment     | 6. Self-propel drive handles (Model 21844 only) |
| 2. Rear deflector          | 7. Grass box full indicator                     |
| 3. Handlebar release brace | 8. Grass box                                    |
| 4. Blade-control handles   | 9. Height-of-cut button                         |
| 5. Handlebar               | 10. Height-of-cut indicator window              |

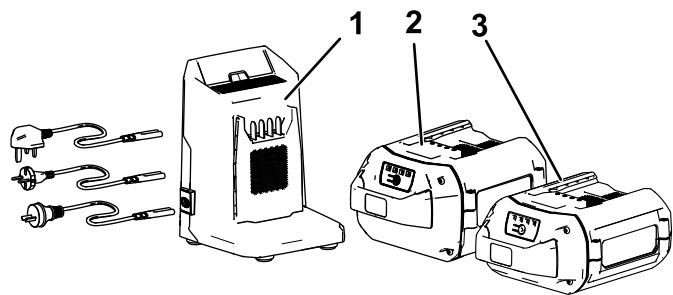

Figure 7

g342171

- |   |   |
|---|---|
| 1. Battery charger Model 81802 (included with Models 21836, 21843, and 21844) | 3. Battery pack Model 81825 (included with Model 21836) |
| 2. Battery pack Model 81850 (included with Models 21843 and 21844)            |   |

# Specifications

Model	Weight (without a battery)	Length	Width	Height
21836/T	20.2 kg (44.5 lb)	130.6 cm (51.4 inches)	41.7 cm (16.4 inches)	107.3 cm (42.2 inches)
21843/T	22.1 kg (48.7 lb)	136.2 cm (53.6 inches)	48.5 cm (19.1 inches)	108.5 cm (42.7 inches)
21844/T	24.0 kg (52.9 lb)	136.2 cm (53.6 inches)	48.5 cm (19.1 inches)	108.5 cm (42.7 inches)

## SmartStow Dimensions

Model	Length	Width	Height
21836/T	41.2 cm (16.2 inches)	41.7 cm (16.4 inches)	113.5 cm (44.7 inches)
21843/T	41.0 cm (16.1 inches)	48.5 cm (19.1 inches)	114.0 cm (44.9 inches)
21844/T	41.0 cm (16.1 inches)	48.5 cm (19.1 inches)	114.0 cm (44.9 inches)

## Battery Pack

Model	81825	81850
Battery pack capacity	2.5 Ah	4.0 Ah
	135 Wh	216 Wh
Battery manufacturer rating = 60V maximum and 54V nominal. Actual voltage varies with load.		

## Battery Charger

Model	81802
Type	60V MAX Lithium-Ion Battery Charger
Input	100 to 240V AC 50/60Hz Max 2.0A
Output	60V MAX DC 2.0A

## Appropriate Temperature Ranges

Charge/store the battery pack at	5°C (41°F) to 40°C (104°F)*
Use the battery pack at	-30°C (-22°F) to 49°C (120°F)*
Use the machine at	0°C (32°F) to 49°C (120°F)*

\*Charging time will increase if you do not charge the battery pack within this range.

Store the machine, battery pack, and battery charger in an enclosed clean, dry area.

# Operation

**Note:** Determine the left and right sides of the machine from the normal operating position.

## Before Operation

### Installing the Battery Pack

**Important:** Operate the battery pack only in temperatures that are within the appropriate range; refer to [Specifications \(page 10\)](#).

1. Ensure that the safety key is not installed to the machine.
2. Ensure that the vents on the battery are clear of any dust and debris.
3. Lift up the battery-compartment lid (A of [Figure 8](#)).
4. Line up the cavity in the battery pack with the tongue on the machine and slide the battery pack into the compartment until it locks into place (B of [Figure 8](#)).
5. Close the battery-compartment lid (C of [Figure 8](#)).

**Note:** If the battery-compartment lid does not close completely, the battery is not fully installed.

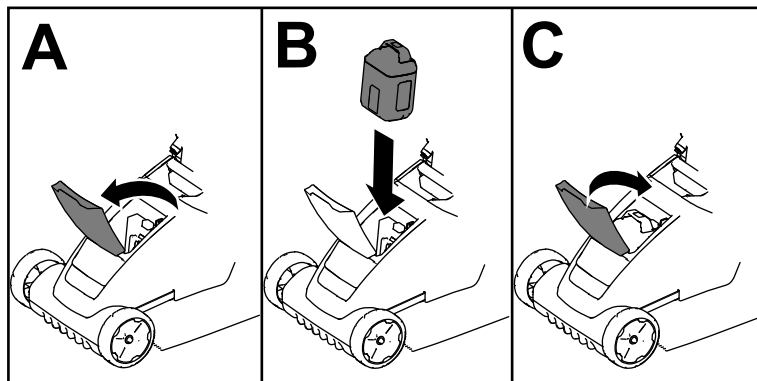

Figure 8

g341293

# Adjusting the Cutting Height

## ⚠ WARNING

Adjusting the height-of-cut could bring your hands into contact with a moving blade and result in serious injury.

- Shut off the motor, remove the battery, and wait for all moving parts to stop before adjusting the cutting height.
- Do not put your fingers under the housing when adjusting the cutting height.

To adjust the cutting height, press down on the height-of-cut button and raise or lower the deck until the desired height-of-cut setting is shown in the height-of-cut window (Figure 9).

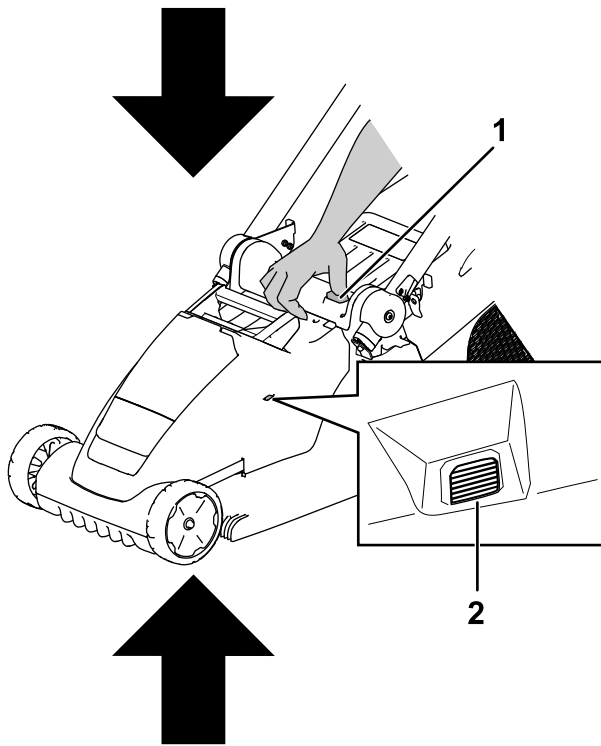

Figure 9

g364065

1. Height-of-cut button      2. Height-of-cut view window

The height of cut is adjustable in 6 increments between 19 mm (3/4 inch) and 70 mm (2-3/4 inches).

Indicator	Height of Cut Position
	1 (lowest)
	2
	3
	4
	5
	6 (highest)

# During Operation

## Starting the Machine

1. Ensure that the battery pack is charged and installed in the machine; refer to [Installing the Battery Pack \(page 11\)](#).
2. Install the safety key to the machine ([Figure 10](#)).

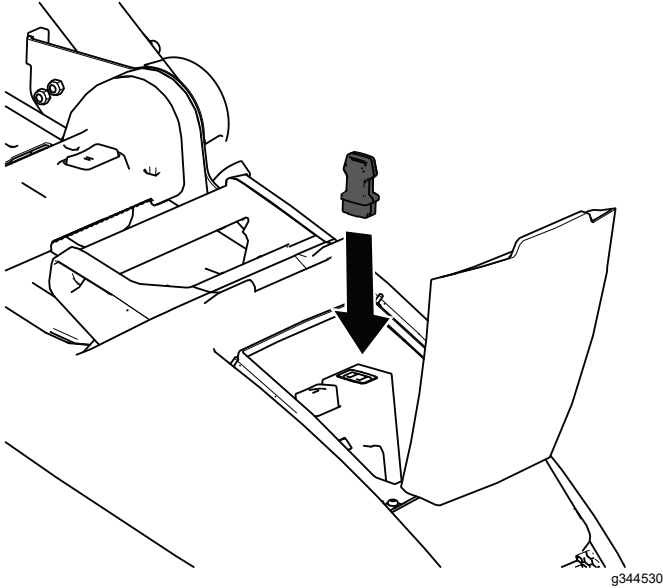

Figure 10

3. Press the Power button at the center of the upper handle to turn on the machine.
4. Squeeze the blade-control handles to start the machine.

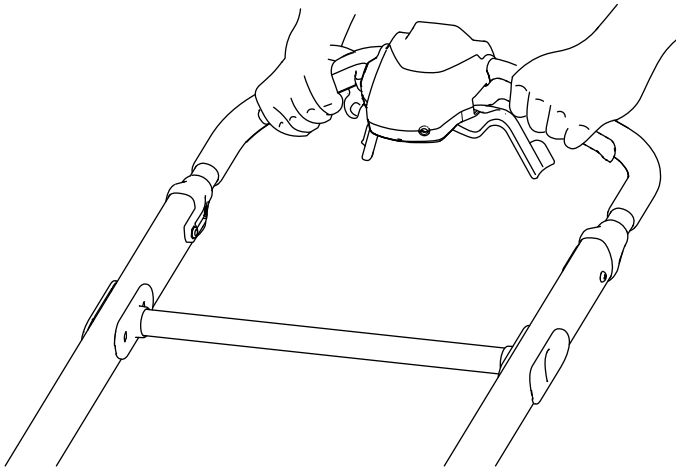

Figure 11

## Using the Self-Propel Drive Model 21844/T Only

- To adjust the self-propel movement speed, adjust the speed control ([Figure 12](#)).
- To engage the self-propel drive, pull the self-propel drive handles up to the handle and hold them ([Figure 12](#)).
- To disengage the self-propel-drive, release the self-propel drive handles.

**Note:** To reduce the ground speed, move the speed control to the left; to increase, move it to the right.

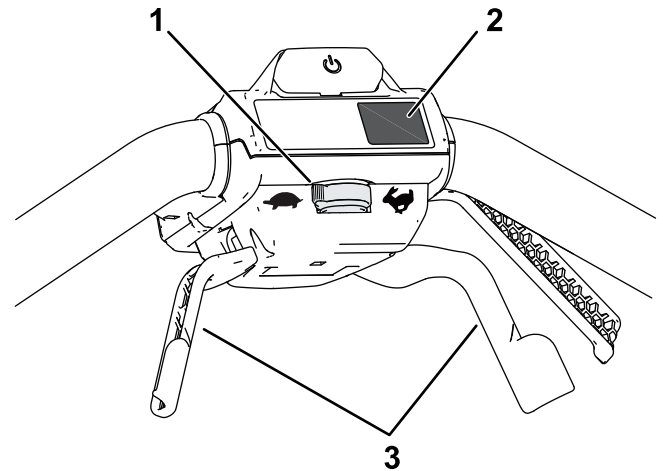

Figure 12

1. Self-propel speed control
2. MAX button
3. Self-propel drive handles

## Adjusting the Blade Speed

This machine has 2 blade-speed settings: RUNSMART and MAX.

- When set to RUNSMART, the blade speed is adjusted automatically for greater efficiency; changes in cutting conditions are detected and the blade speed increases when necessary to maintain quality of cut.
- When set to the MAX, the blade speed remains at the highest speed at all times.

Press the MAX button below the On button to set the machine to MAX speed ([Figure 12](#)).

# Recycling the Clippings

Your machine comes from the factory ready to recycle the grass and leaf clippings back into the lawn.

If the grass box is on the machine, remove it before recycling the clippings. Refer to [Removing the Grass Box \(page 16\)](#).

## Installing the Mulch Plug

1. Shut off the machine and remove the battery pack and safety key; refer to [Shutting Off the Machine \(page 17\)](#).
2. Place the machine in the vertical stow position; refer to [Storing the Machine in the Vertical-Stow Position \(page 20\)](#).
3. Clean the bottom of the deck to ensure the plug installs properly; refer to [Cleaning under the Machine \(page 19\)](#).
4. Align the mulch plug and push the bottom of the plug until it snaps into place onto the 2 retaining pins as shown in [Figure 13](#).

**Important:** The bottom of the mulch plug should be flush with the bottom of the deck when properly installed; if the mulch plug does not install correctly, do not use it; contact your Authorized Service Dealer.

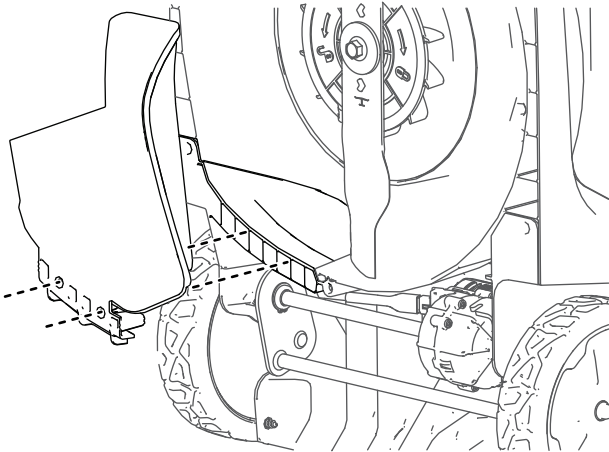

Figure 13

---

## Removing the Mulch Plug

To remove the mulch plug, remove the battery pack and then reverse the steps in [Installing the Mulch Plug \(page 14\)](#).

# Bagging the Clippings

Use the grass box when you want to collect grass and leaf clippings from the lawn.

If the mulch plug is on the machine, remove it before bagging the clippings. Refer to [Removing the Mulch Plug \(page 14\)](#).

## Installing the Grass Box

1. Move the handle into the upright position and lift up the rear deflector (A of [Figure 14](#)).
2. Install the hooks of the grass box into the notches on the rear of the machine (B of [Figure 14](#)).
3. Allow the rear deflector to rest on the box (C of [Figure 14](#)).
4. Return the handle back to the operating position; refer to [Folding the Handle \(page 19\)](#).

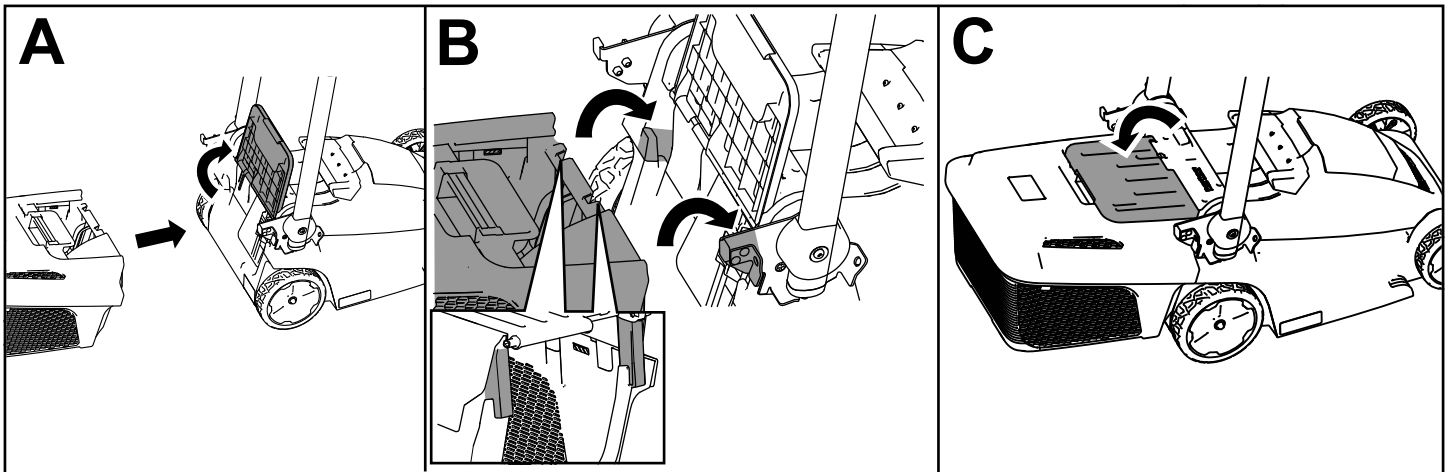

Figure 14

g341400

## Grass Box Full Indicator

The grass box is fitted with a full indicator at the rear of the hard top. While grass is being collected, air flows through the grass box, raising the indicator flap into the open position. When the grass box is full, the airflow is blocked, and the indicator flap closes.

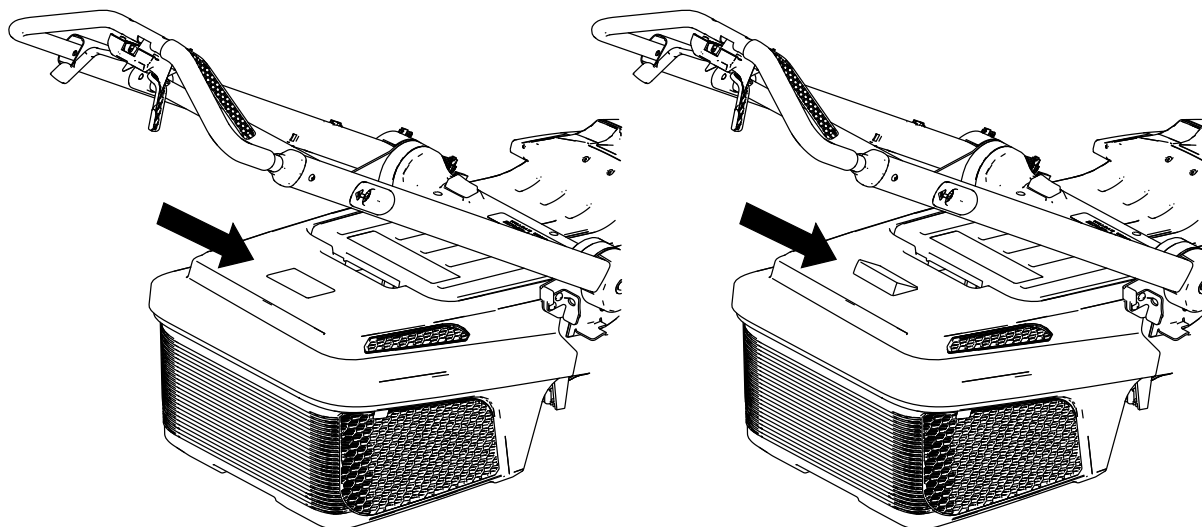

Figure 15

g363501

## Removing the Grass Box

To remove the box, reverse the steps in [Installing the Grass Box \(page 15\)](#).

Do not operate the machine with the grass box removed unless the mulch plug is installed. Remove the grass box only when mulching, transporting the machine, storing the machine, or emptying the grass box ([Figure 16](#)).

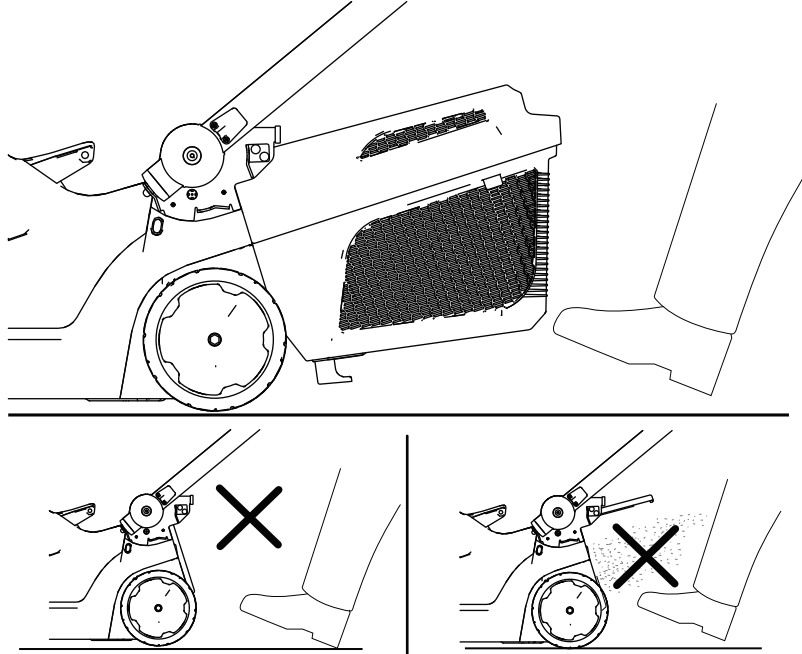

Figure 16

g356991



## Shutting Off the Machine

1. Release the blade-control bar ([Figure 10](#)).

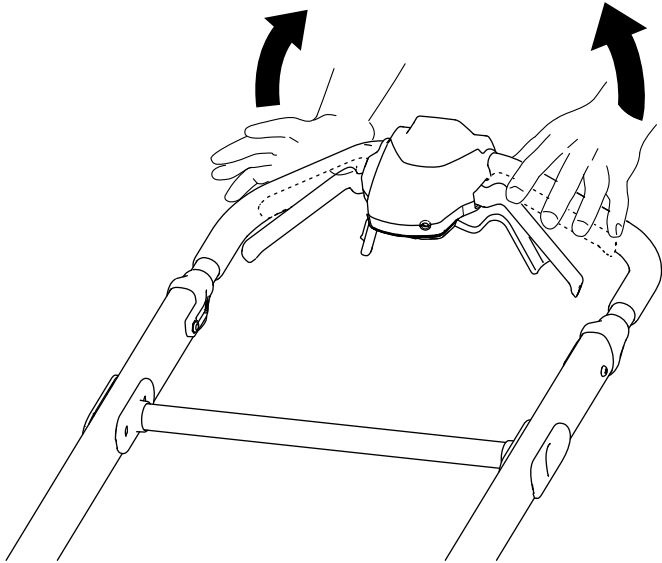

Figure 17

g341392

## Removing the Battery Pack from the Machine

1. Lift up the battery-compartment lid.
2. Press the battery-pack latch to release the battery pack and remove the battery pack.
3. Close the battery-compartment lid.

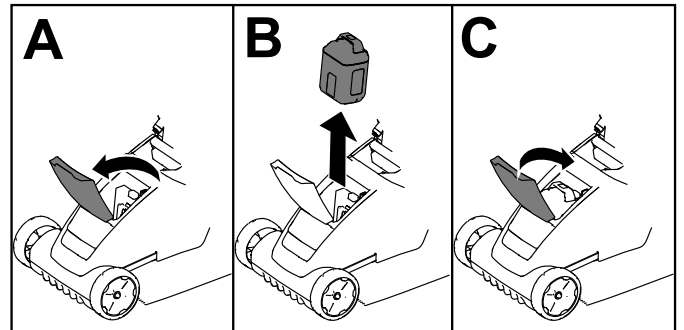

Figure 19

g341360

2. Remove the safety key from the machine ([Figure 10](#)).

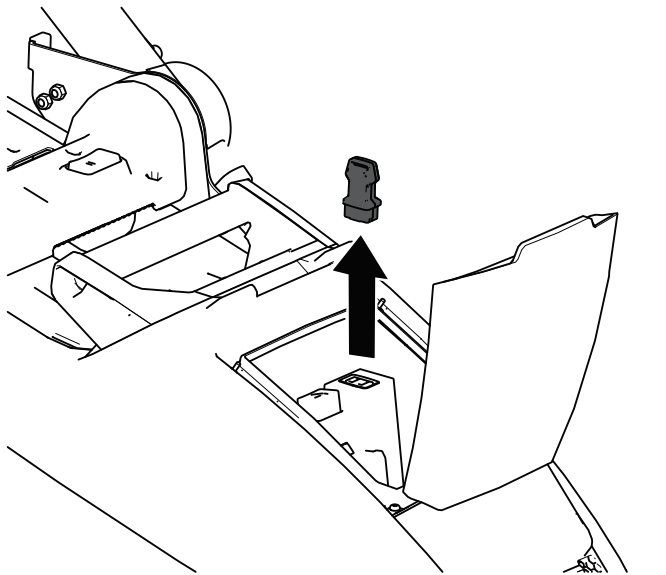

Figure 18

g344533

3. Remove the battery pack; refer to [Removing the Battery Pack from the Machine](#) (page 17).

**Note:** Whenever you are not using the machine, remove the battery pack.

# Operating Tips

## General Mowing Tips

- Avoid striking solid objects with the blade. Never deliberately mow over any object.
- For best performance, install a new Toro blade before the cutting season begins or when necessary.

## Cutting Grass

- Cut only about a third of the grass blade at a time. For improved quality of cut, runtime, and bagging, cut grass at a higher height of cut.
- Do not cut at the lowest height-of-cut setting unless the grass is sparse or it is late fall when grass growth begins to slow down.
- When cutting tall grass, mow at the highest cutting height setting and walk slower; then mow again at a lower setting for the best lawn appearance. If the grass is too long, the machine may plug and cause the motor to stall.
- Wet grass and leaves tend to clump on the yard and can cause the machine to plug or the motor to stall. Avoid mowing in wet conditions.
- Be aware of a potential fire hazard in very dry conditions, follow all local fire warnings, and keep the machine free of dry grass and leaf debris.
- Alternate the mowing direction. This helps disperse the clippings over the lawn for even fertilization.
- If the finished lawn appearance is unsatisfactory, try 1 or more of the following:
  - Replace the blade or have it sharpened.
  - Walk at a slower pace while mowing.
  - Raise the cutting height on your machine.
  - Cut the grass more frequently.
  - Overlap cutting swaths instead of cutting a full swath with each pass.

## Cutting Leaves

- After cutting the lawn, ensure that half of the lawn shows through the cut leaf cover. You may need to make more than a single pass over the leaves.
- Remove excessive quantities of leaves from the ground before cutting the leaves. If the machine is not cutting leaves finely enough, slow down your mowing speed, or mow at a higher cutting height and then again at the desired cutting height.

# After Operation

## Charging the Battery Pack

**Important:** The battery pack is not fully charged when you purchase it. Before using the tool for the first time, place the battery pack in the charger and charge it until the LED display indicates the battery pack is fully charged. Read all safety precautions.

**Important:** Charge the battery pack only in temperatures that are within the appropriate range; refer to [Specifications \(page 10\)](#).

**Note:** At any time, press the battery-charge-indicator button on the battery pack to display the current charge (LED indicators).

1. Ensure that the vents on the battery and charger are clear of any dust and debris.

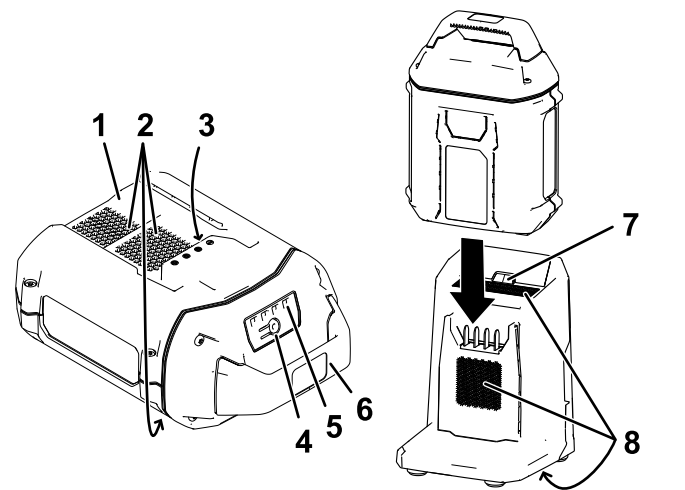

Figure 20

- |                                    |                                    |
|------------------------------------|------------------------------------|
| 1. Battery pack cavity             | 5. LED indicators (current charge) |
| 2. Battery pack venting areas      | 6. Handle                          |
| 3. Battery pack terminals          | 7. Charger LED indicator light     |
| 4. Battery-charge-indicator button | 8. Charger venting areas           |
2. Line up the cavity in the battery pack (Figure 20) with the tongue on the charger.
  3. Slide the battery pack into the charger until it is fully seated (Figure 20).
  4. To remove the battery pack, slide the battery backward out of the charger.

- Refer to the following table to interpret the LED indicator light on the battery charger.

Indicator light	Indicates
Off	No battery pack inserted
Green blinking	Battery pack is charging
Green	Battery pack is charged
Red	Battery pack and/or battery charger is over or under the appropriate temperature range
Red blinking	Battery pack charging fault*

\*Refer to [Troubleshooting \(page 23\)](#) for more information.

**Important:** The battery can be left on the charger for short periods between uses.

If the battery will not be used for longer periods, remove the battery from the charger; refer to [Service \(page 22\)](#).

## Cleaning the Machine

### Cleaning under the Machine

**Service Interval:** After each use

For best results, clean under the machine soon after you have completed mowing.

- Shut off the machine and remove the battery pack and the safety key.
- Lower the machine to its lowest cutting-height setting.
- Set the machine in the vertical-stow position; refer to [Storing the Machine in the Vertical-Stow Position \(page 20\)](#).
- Using a brush or broom, clean any debris away from the underside of the machine.

**Important:** Do not use water to clean the machine; water may damage electrical components.

- Clean the grass box.

### Cleaning the Grass Box

**Service Interval:** After each use

Frequently clean the grass box to ensure maximum collection capability. Brush away any debris.

## Folding the Handle

### ⚠ WARNING

Folding or unfolding the handle improperly can damage the cables, causing an unsafe operating condition.

- Do not damage the cables when folding or unfolding the handle.
- If a cable is damaged, contact an Authorized Service Dealer.

### ⚠ WARNING

Ensure that the handle is in the operating position prior to starting the machine to prevent thrown object related injuries.

- Shut off the machine, remove the safety key, and remove the battery pack; refer to [Shutting Off the Machine \(page 17\)](#).
- Pull the handlebar release brace toward the upper handle to release the handle lock ([Figure 21](#)).
- Fold the handle halfway forward to the upright position, or fully forward to the vertical-stow position as shown in [Figure 21](#).

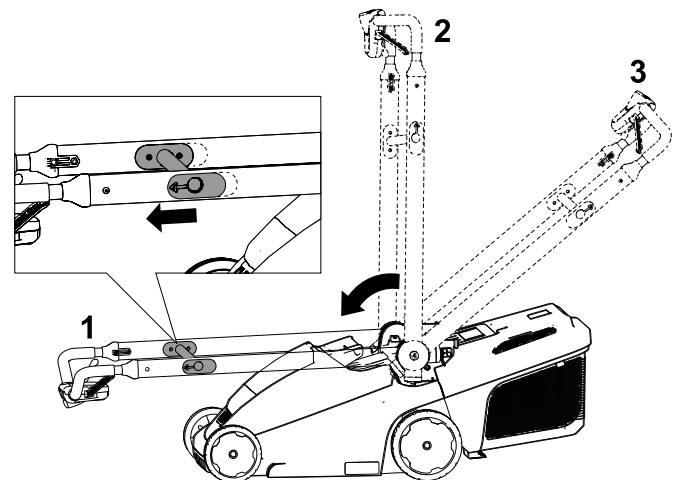

Figure 21

- Vertical-stow position
- Upright position
- Operating position

- To unfold the handle, refer to [2 Assembling the Handle \(page 9\)](#).

g342175

# Storing the Machine in the Vertical-Stow Position

You can store your machine in the vertical position to minimize storage space.

## ⚠ WARNING

Folding or unfolding the handle improperly can damage the cables, causing an unsafe operating condition.

- Do not damage the cables when folding or unfolding the handle.
- If a cable is damaged, contact an Authorized Service Dealer.

1. Shut off the machine, remove the safety key, and remove the battery pack; refer to [Shutting Off the Machine \(page 17\)](#).
2. Fold the handle all the way forward until it clicks into position; refer to [Folding the Handle \(page 19\)](#).
3. Ensure that the grass box is not installed to the machine; if it is, remove it. Refer to [Removing the Grass Box \(page 16\)](#).
4. Ensure that the cutting-height on the machine is set to the highest setting (setting 6); if it is not, raise it. Refer to [Adjusting the Cutting Height \(page 12\)](#).
5. Tilt the machine back and roll it by the handle into a storage space ([Figure 22](#)).

## ⚠ WARNING

Pulling the handlebar release brace unlocks the handlebar, which may cause the mower to suddenly drop to the ground.

Do not pull the handlebar release brace to move the machine.

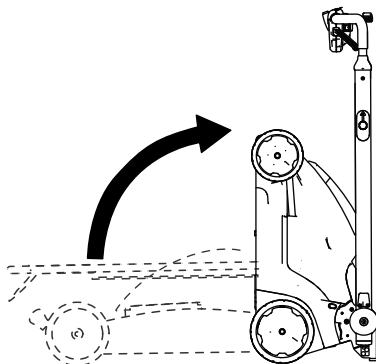

Figure 22

g342176

**Note:** You can hook the grass box onto the handlebar release brace in this position ([Figure 23](#)).

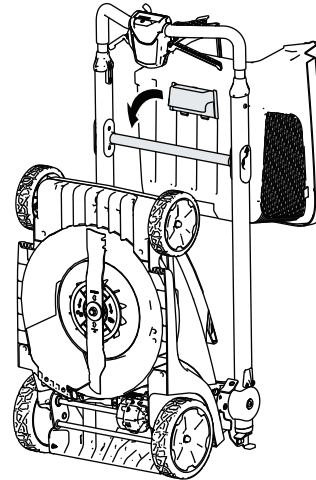

Figure 23

g356985

# Maintenance

Remove the safety key and battery pack from the machine before maintaining or cleaning the machine.

Use only the manufacturer's recommended replacement parts and accessories.

Inspect and maintain the machine regularly. Have the machine repaired only by an Authorized Service Dealer.

## Lubricating the Machine

You do not need to lubricate the machine; all the bearings have been lubricated at the factory for the life of the machine.

## Replacing the Blade

**Service Interval:** Yearly

**Important:** You will need a torque wrench to install the blade properly. If you do not have a torque wrench or are uncomfortable performing this procedure, contact an Authorized Service Dealer.

If the blade is damaged or cracked, replace it immediately. If the blade edge is dull or nicked, have it sharpened and balanced, or replace it.

### ⚠ WARNING

When servicing the blade, be aware that the blade can still move even though the power source is off. The blade is sharp; contacting the blade can result in serious personal injury.

**Wear gloves when servicing the blade.**

1. Remove the safety key and battery pack from the machine.
2. Use a block of wood to hold the blade steady (Figure 24).
3. Remove the blade bolt, washer, and blade; save the washer and blade bolt (Figure 24).
4. Install the new blade, washer, and blade bolt (Figure 25).

**Important:** Position the curved ends of the blade facing up toward the machine housing.

5. Use a torque wrench to tighten the blade bolt to 35 N·m (26 ft-lb).

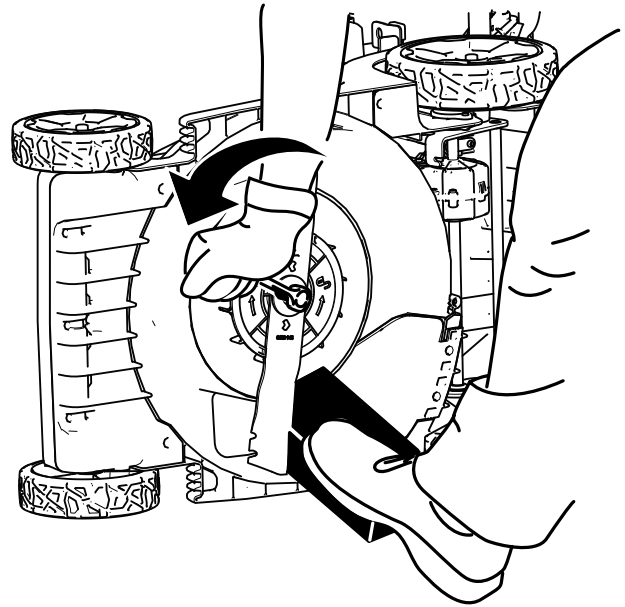

Figure 24

g357349

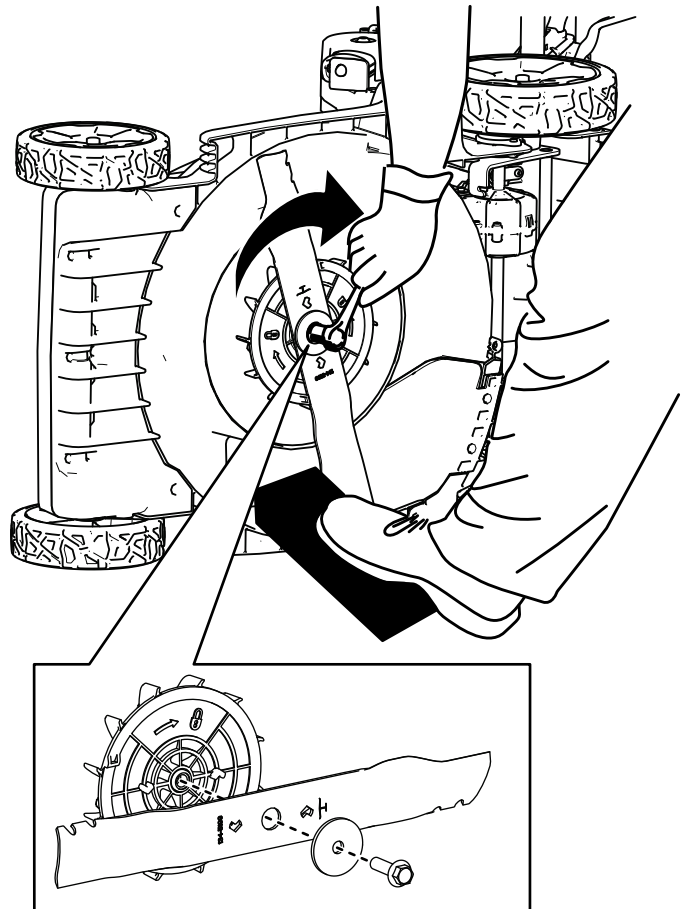

Figure 25

g357350

# Preparing the Battery Pack for Recycling

**Important:** Upon removal, cover the terminals of the battery pack with heavy-duty adhesive tape. Do not attempt to destroy or disassemble the battery pack or remove any of its components.

Contact your local municipality or your authorized Toro distributor for more information on how to responsibly recycle the battery.

# Storage

**Important:** Store the machine, battery pack, and charger only in temperatures that are within the appropriate range; refer to [Specifications \(page 10\)](#).

**Important:** If you are storing the battery pack for the off-season, charge it until 2 or 3 LED indicators turn green on the battery. Do not store a fully charged or fully depleted battery. When you are ready to use the machine again, charge the battery pack until the left indicator light turns green on the charger or all 4 LED indicators turn green on the battery.

- Disconnect the product from the power supply (i.e., remove the battery pack and the safety key) and check for damage after use.
- Do not store the machine or charger with the battery pack installed.
- Clean all foreign material from the product.
- When not in use, store the machine, safety key, battery pack, and battery charger out of the reach of children.
- Keep the machine, battery pack, and battery charger away from corrosive agents, such as garden chemicals and de-icing salts.
- To reduce the risk of serious personal injury, do not store the battery pack outside or in vehicles.
- Tighten all fasteners.
- Store the machine, battery pack, and battery charger in an enclosed clean, dry area.

# Service

**Service Interval:** Yearly

Should this machine need service, contact your Authorized Service Dealer.

# Troubleshooting

Perform only the steps described in these instructions. All further inspection, maintenance, and repair work must be performed by an authorized service center or a similarly qualified specialist if you cannot solve the problem yourself.

Problem	Possible Cause	Corrective Action
The machine does not start.	<ol style="list-style-type: none"> <li>1. The battery is not fully installed in the machine.</li> <li>2. The battery pack is not charged.</li> <li>3. The battery pack is damaged.</li> <li>4. There is another electrical problem with the machine.</li> </ol>	<ol style="list-style-type: none"> <li>1. Remove and then replace the battery into the machine, making sure that it is fully installed and latched.</li> <li>2. Remove the battery pack from the machine and charge it.</li> <li>3. Replace the battery pack.</li> <li>4. Contact an Authorized Service Dealer.</li> </ol>
The machine does not run or does not run continuously.	<ol style="list-style-type: none"> <li>1. There is moisture on the leads of the battery pack.</li> <li>2. The battery is not fully installed into the tool.</li> </ol>	<ol style="list-style-type: none"> <li>1. Allow the battery pack to dry or wipe it dry.</li> <li>2. Remove and then replace the battery into the tool making sure that it is fully installed and latched.</li> </ol>
The machine does not reach full power.	<ol style="list-style-type: none"> <li>1. The battery pack charge capacity is too low.</li> <li>2. The air vents are blocked.</li> </ol>	<ol style="list-style-type: none"> <li>1. Remove the battery pack from the machine and fully charge the battery pack.</li> <li>2. Clean the air vents.</li> </ol>
The battery pack loses charge quickly.	<ol style="list-style-type: none"> <li>1. The battery pack is over or under the appropriate temperature range.</li> <li>2. The machine is overloaded</li> </ol>	<ol style="list-style-type: none"> <li>1. Move the battery pack to a place where it is dry and the temperature is between 5°C (41°F) and 40°C (104°F).</li> <li>2. Cut the grass at a higher height of cut or walk at a slower pace while mowing.</li> </ol>
The battery charger is not working.	<ol style="list-style-type: none"> <li>1. The battery charger is over or under the appropriate temperature range.</li> <li>2. The outlet that the battery charger is plugged into does not have power.</li> </ol>	<ol style="list-style-type: none"> <li>1. Unplug the battery charger and move it to a place where it is dry and the temperature is between 5°C (41°F) and 40°C (104°F).</li> <li>2. Contact your licensed electrician to repair the outlet.</li> </ol>
The machine does not self-propel.	<ol style="list-style-type: none"> <li>1. The self propel drive system or power cable is damaged.</li> </ol>	<ol style="list-style-type: none"> <li>1. Contact an Authorized Service Dealer.</li> </ol>
The LED indicator light on the battery charger is red.	<ol style="list-style-type: none"> <li>1. The battery charger and/or battery pack is over or under the appropriate temperature range.</li> </ol>	<ol style="list-style-type: none"> <li>1. Unplug the battery charger and move the battery charger and battery pack to a place where it is dry and the temperature is between 5°C (41°F) and 40°C (104°F).</li> </ol>

Problem	Possible Cause	Corrective Action
The LED indicator light on the battery charger is blinking red.	<ol style="list-style-type: none"> <li>1. There is an error in the communication between the battery pack and the charger.</li> <li>2. The battery pack is weak.</li> </ol>	<ol style="list-style-type: none"> <li>1. Remove the battery pack from the battery charger, unplug the battery charger from the outlet, and wait 10 seconds. Plug the battery charger into the outlet again and place the battery pack on the battery charger. If the LED indicator light on the battery charger is still blinking red, repeat this procedure again. If the LED indicator light on the battery charger is still blinking red after 2 attempts, properly dispose of the battery pack at a battery recycling facility.</li> <li>2. Contact your authorized service dealer if the battery is in warranty, or properly dispose of the battery pack at a battery recycling facility.</li> </ol>
The machine is producing a beeping sound.	<ol style="list-style-type: none"> <li>1. The battery pack is not charged.</li> <li>2. The machine is in an unsafe position for operation.</li> <li>3. The machine is overloaded.</li> <li>4. There is another electrical problem with the machine.</li> </ol>	<ol style="list-style-type: none"> <li>1. Remove the battery pack from the machine and charge it.</li> <li>2. Ensure that the machine is not at an extreme angle while operating.</li> <li>3. Cut the grass at a higher height of cut or walk at a slower pace while mowing.</li> <li>4. Attempt the other troubleshooting actions, if the alarm still sounds, contact an Authorized Service Dealer.</li> </ol>
The quality of cut is decreased or unsatisfactory.	<ol style="list-style-type: none"> <li>1. The blade is dull.</li> <li>2. The cutting deck has debris buildup.</li> </ol>	<ol style="list-style-type: none"> <li>1. Have the blade sharpened or replaced.</li> <li>2. Clean under the machine.</li> </ol>
The bagging is decreased or unsatisfactory.	<ol style="list-style-type: none"> <li>1. The machine is overloaded.</li> <li>2. The grass box vents are blocked.</li> </ol>	<ol style="list-style-type: none"> <li>1. Cut the grass at a higher height of cut.</li> <li>2. Clean the grass box with water and a soft brush.</li> </ol>
The machine is cutting unevenly.	<ol style="list-style-type: none"> <li>1. The blade is dull.</li> <li>2. The cutting deck is damaged.</li> </ol>	<ol style="list-style-type: none"> <li>1. Have the blade sharpened or replaced.</li> <li>2. Contact an Authorized Service Dealer.</li> </ol>
The machine is vibrating.	<ol style="list-style-type: none"> <li>1. The blade is bent or damaged.</li> </ol>	<ol style="list-style-type: none"> <li>1. Inspect the blade and replace if necessary.</li> </ol>



**Notes:**

**Notes:**

## EEA/UK Privacy Notice

### **Toro's Use of Your Personal Information**

The Toro Company ("Toro") respects your privacy. When you purchase our products, we may collect certain personal information about you, either directly from you or through your local Toro company or dealer. Toro uses this information to fulfil contractual obligations - such as to register your warranty, process your warranty claim or to contact you in the event of a product recall - and for legitimate business purposes - such as to gauge customer satisfaction, improve our products or provide you with product information which may be of interest. Toro may share your information with our subsidiaries, affiliates, dealers or other business partners in connection these activities. We may also disclose personal information when required by law or in connection with the sale, purchase or merger of a business. We will never sell your personal information to any other company for marketing purposes.

### **Retention of your Personal Information**

Toro will keep your personal information as long as it is relevant for the above purposes and in accordance with legal requirements. For more information about applicable retention periods please contact [legal@toro.com](mailto:legal@toro.com).

### **Toro's Commitment to Security**

Your personal information may be processed in the US or another country which may have less strict data protection laws than your country of residence. Whenever we transfer your information outside of your country of residence, we will take legally required steps to ensure that appropriate safeguards are in place to protect your information and to make sure it is treated securely.

### **Access and Correction**

You may have the right to correct or review your personal data, or object to or restrict the processing of your data. To do so, please contact us by email at [legal@toro.com](mailto:legal@toro.com). If you have concerns about the way in which Toro has handled your information, we encourage you to raise this directly with us. Please note that European residents have the right to complain to your Data Protection Authority.



**Count on it.**