



# Operator Golf Ball Guard

Reelmaster® 3100/3500/5010/7000, Groundsmaster® 3500/4300/4500/4700, and Machines with a Straight Roll Bar

Model No. 03614

## Installation Instructions

### Preparing the Machine

Park the machine on a level surface, engage the parking brake, shut off the engine, and remove the key from the key switch (Figure 1).

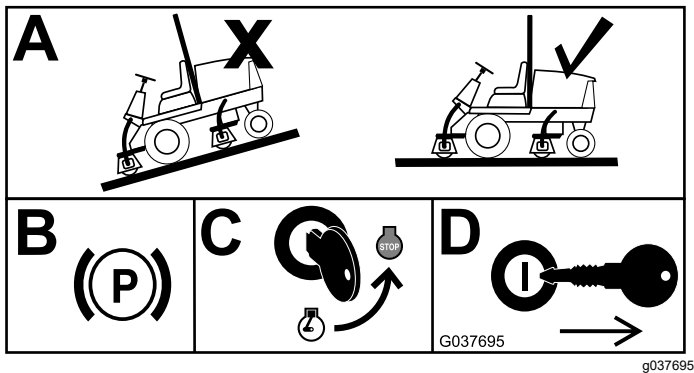

Figure 1

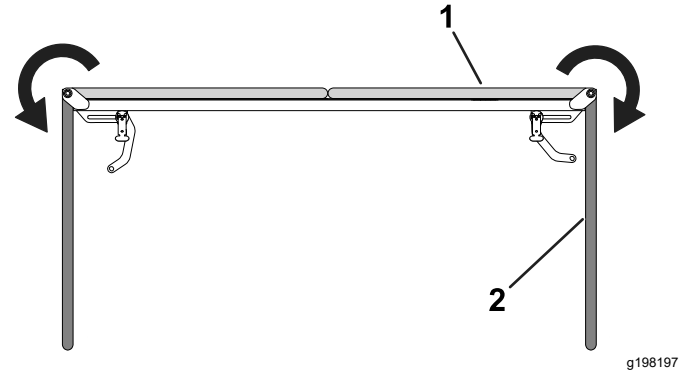

Figure 2

1. Guard wing—initial position
  2. Guard wing—final position
- 
2. Attach each latch-arm with 2 shoulder bolts, 2 spacers, and 2 nuts. Tighten the flange nuts and shoulder bolts.

### Assembling the Ball Guard

Parts needed for this procedure:

1	Guard assembly
2	Flange nut
2	Shoulder bolt
2	Spacer

1. Swing the guard wings closed to align perpendicular with the rear guard panel.

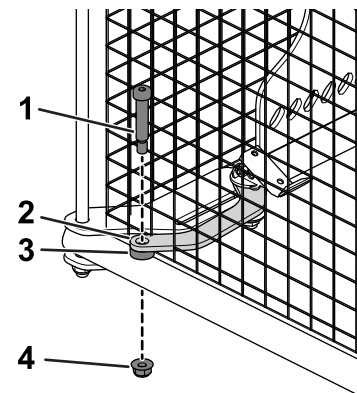

Figure 3

1. Shoulder bolt
2. Latch-arm link
3. Spacer
4. Flange nut



# Installing the Ball Guard Kit

## Installing the Guard

Reelmaster 3100/3500 or Groundsmaster 3500

### Parts needed for this procedure:

1	Guard assembly
1	Left mounting bracket
1	Right mounting bracket
4	Strap
4	Carriage bolt—3/8 x 3-1/2 inches
12	Flange nut
8	Carriage bolt—3/8 x 7/8 inch

- Loosely mount the 2 brackets to the roll bar with 4 straps, 4 carriage bolts, and 4 flange nuts.

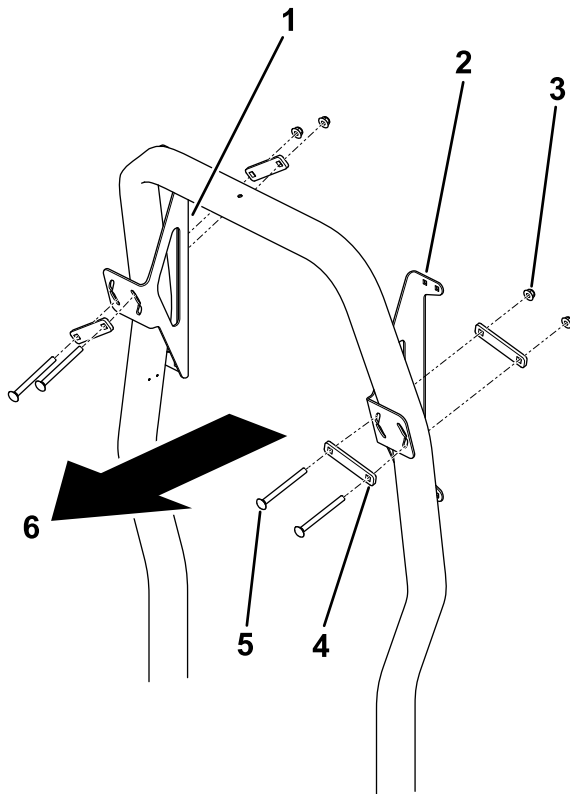
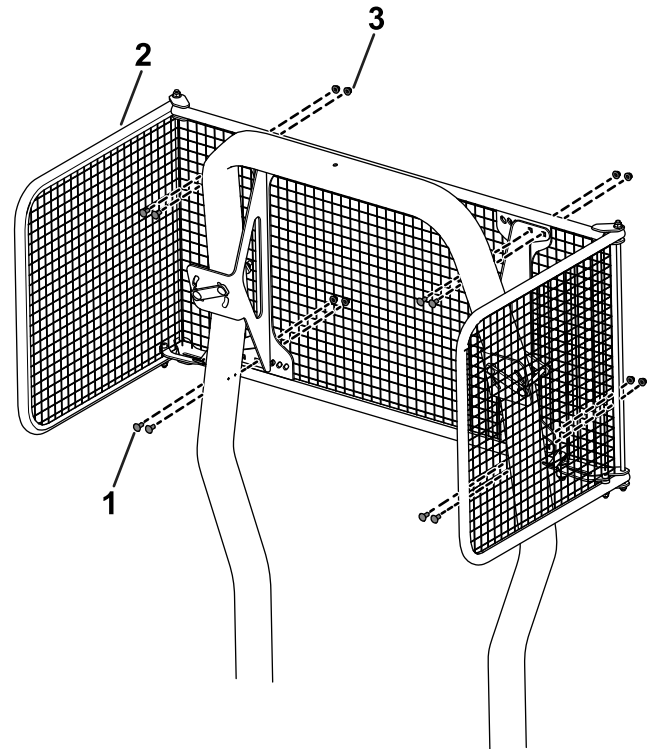

**Figure 4**

g198449

- |                           |   |
|---------------------------|---|
| 1. Right mounting bracket | 4. Mount strap (4)                      |
| 2. Left mounting bracket  | 5. Carriage bolt—3/8 x 3-1/2 inches (4) |
| 3. Flange nut (4)         | 6. Front of the machine                 |

- Make sure the two brackets are at an even height and tighten the flange nuts.
- Loosely install the ball guard to the brackets with 8 carriage bolts and 8 flange nuts.



**Figure 5**

g198626

- |                            |                   |
|----------------------------|-------------------|
| 1. Short carriage bolt (8) | 3. Flange nut (8) |
| 2. Guard assembly          |                   |

- Center the ball guard on the brackets and tighten the 8 flange nuts.

- Align the ball guard assembly with the brackets and verify there is enough clearance to open the hood without contacting the ball guard. Position the height of the brackets on the roll bar as needed.

# Installing the Guard

## Reelmaster 3555/3575

### Parts needed for this procedure:

1	Guard assembly
1	Left mounting bracket
1	Right mounting bracket
4	Strap
4	Carriage bolt—3/8 x 4-1/2 inches
12	Flange nut
8	Carriage bolt—3/8 x 7/8 inch

1. Loosely mount the 2 brackets to the roll bar with 4 straps, 4 carriage bolts, and 4 flange nuts.

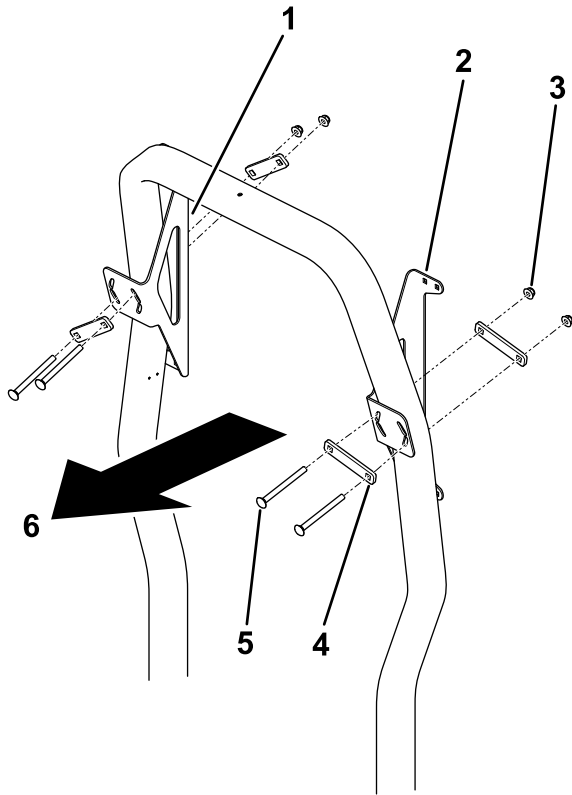

**Figure 6**

g198449

- |                           |   |
|---------------------------|---|
| 1. Right mounting bracket | 4. Mount strap (4)                      |
| 2. Left mounting bracket  | 5. Carriage bolt—3/8 x 4-1/2 inches (4) |
| 3. Flange nut (4)         | 6. Front of the machine                 |

2. Align the ball guard assembly with the brackets and verify there is enough clearance to open the hood without contacting the ball guard. Position the height of the brackets on the roll bar as needed.
3. Make sure the two brackets are at an even height and tighten the flange nuts.

4. Loosely install the ball guard to the brackets with 8 carriage bolts and 8 flange nuts.

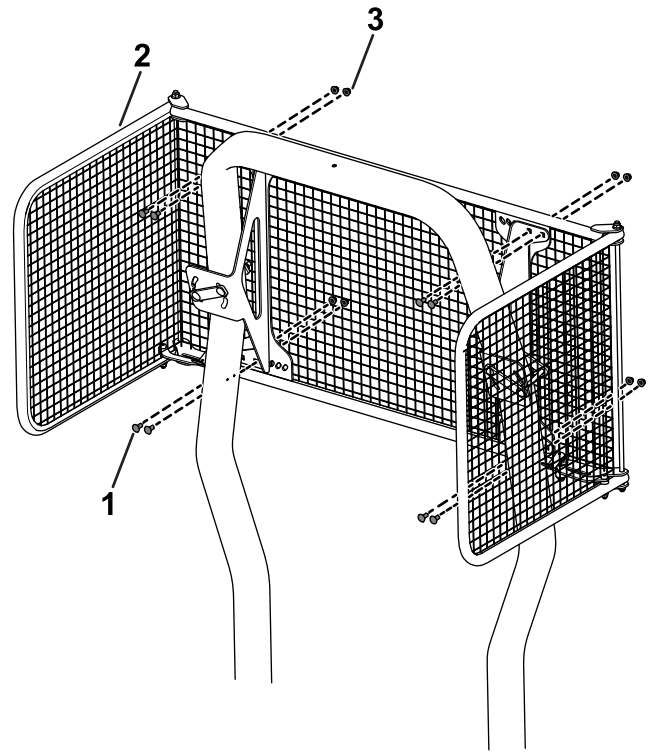

g198626

**Figure 7**

- |                            |                   |
|----------------------------|-------------------|
| 1. Short carriage bolt (8) | 3. Flange nut (8) |
| 2. Guard assembly          |                   |

5. Center the ball guard on the brackets and tighten the 8 flange nuts.

# Installing the Guard

## Reelmaster 5010 or Groundsmaster 4300-D

### Parts needed for this procedure:

1	Guard assembly
1	Left mounting bracket
1	Right mounting bracket
4	Strap
4	Carriage bolt—3/8 x 4-1/2 inches
12	Flange nut
8	Carriage bolt—3/8 x 7/8 inch

1. Loosely mount the 2 brackets to the roll bar with 4 straps, 4 carriage bolts, and 4 flange nuts.

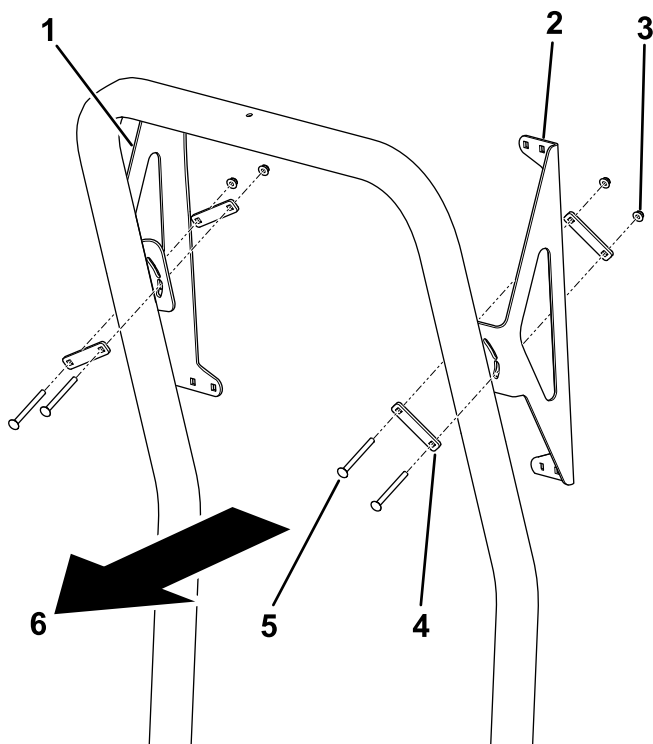

**Figure 8**

g211694

1. Right mounting bracket
2. Left mounting bracket
3. Flange nut (4)
4. Mount strap (4)
5. Carriage bolt—3/8 x 4-1/2 inches (4)
6. Front of the machine

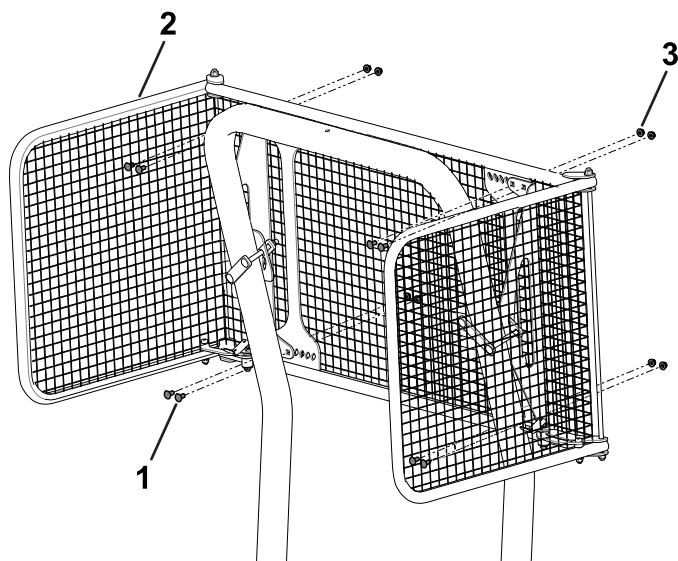

**Figure 9**

g211695

1. Short carriage bolt (8)
2. Guard assembly
3. Flange nut (8)

5. Center the ball guard on the brackets and tighten the 8 flange nuts.

2. Align the ball guard assembly with the brackets and verify there is enough clearance to open the hood without contacting the ball guard. Position the height of the brackets on the roll bar as needed.
3. Make sure the two brackets are at an even height and tighten the flange nuts.
4. Loosely install the ball guard to the brackets with 8 carriage bolts and 8 flange nuts.

# Installing the Guard

## Reelmaster 7000 or Groundsmaster 4500/4700

### Required Kit Parts

Kit Description	Toro Part No.	Quantity
Adapter-ball guard	137-1392	1

**Note:** Do not use the hardware provided with the adapter kit.

### Parts needed for this procedure:

1	Guard assembly
1	Left mounting bracket
1	Right mounting bracket
4	Strap
4	Carriage bolt—3/8 x 3-1/2 inches
12	Flange nut
8	Carriage bolt—3/8 x 7/8 inch

- Loosely mount the 2 brackets to the roll bar with 4 straps, 4 carriage bolts, and 4 flange nuts.

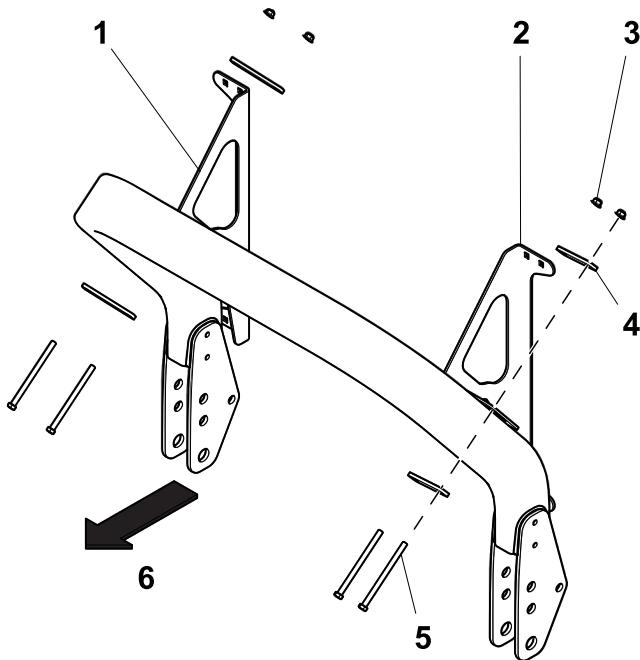

**Figure 10**

g372824

- |                           |   |
|---------------------------|---|
| 1. Right mounting bracket | 4. Mount strap (4)                      |
| 2. Left mounting bracket  | 5. Carriage bolt—3/8 x 3-1/2 inches (4) |
| 3. Flange nut (4)         | 6. Front of the machine                 |

- Align the ball guard assembly with the brackets and verify there is enough clearance to open the hood without contacting the ball guard. Position the height of the brackets on the roll bar as needed.

- Make sure the two brackets are at an even height and tighten the flange nuts.
- Loosely install the ball guard to the brackets with 8 carriage bolts and 8 flange nuts.

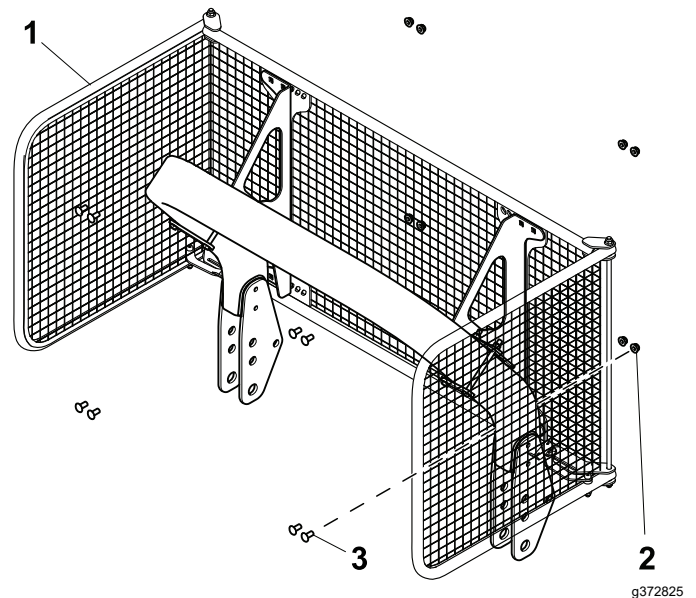

**Figure 11**

g372825

- |                            |                   |
|----------------------------|-------------------|
| 1. Short carriage bolt (8) | 3. Flange nut (8) |
| 2. Guard assembly          |                   |

- Center the ball guard on the brackets and tighten the 8 flange nuts.

# Installing the Guard

## Machines with a Straight Roll Bar

### Required Kit Parts

Kit Description	Toro Part No.	Quantity
Adapter-ball guard	137-1081	1

### Parts needed for this procedure:

1	Guard assembly
1	Left mounting bracket
1	Right mounting bracket
4	Strap
4	Carriage bolt—3/8 x 3-1/2 inches
12	Flange nut
8	Carriage bolt—3/8 x 7/8 inch

- Loosely mount the 2 brackets to the roll bar with 4 straps, 4 carriage bolts, and 4 flange nuts.

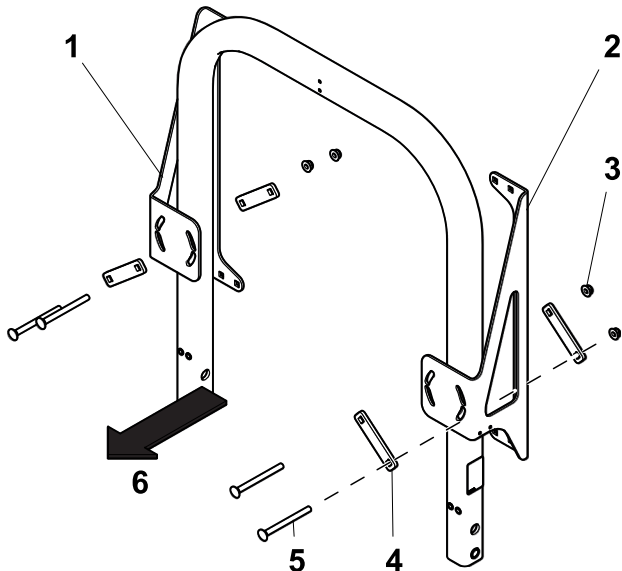

Figure 12

g372826

- Right mounting bracket
- Left mounting bracket
- Flange nut (4)
- Mount strap (4)
- Carriage bolt—3/8 x 3-1/2 inches (4)
- Front of the machine

- Align the ball guard assembly with the brackets and verify there is enough clearance to open the hood without contacting the ball guard. Position the height of the brackets on the roll bar as needed.
- Make sure the two brackets are at an even height and tighten the flange nuts.
- Loosely install the ball guard to the brackets with 8 carriage bolts and 8 flange nuts.

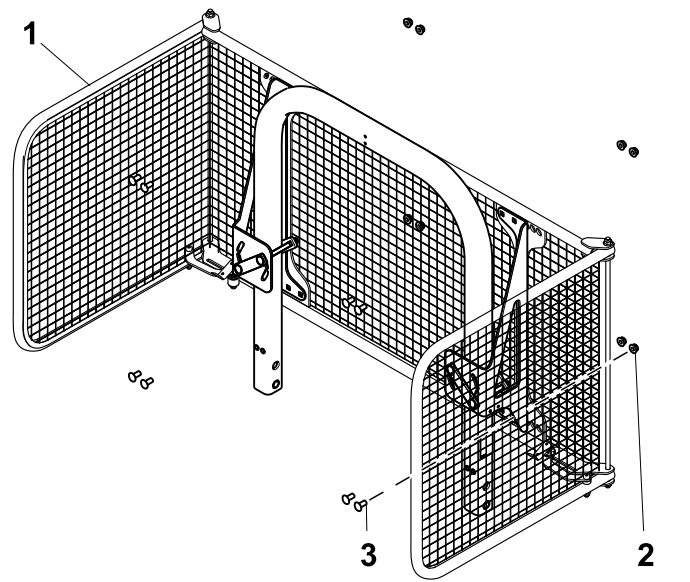

Figure 13

g372827

- Short carriage bolt (8)
- Guard assembly
- Flange nut (8)
- Center the ball guard on the brackets and tighten the 8 flange nuts.

# Operation

## Using the Guard

Open the guard wings to access the operator platform. Close the latch to secure the guard wings in the open or closed position (Figure 14).

**Note:** If the latch is not tight enough, tighten the nut on the latch (Figure 15).

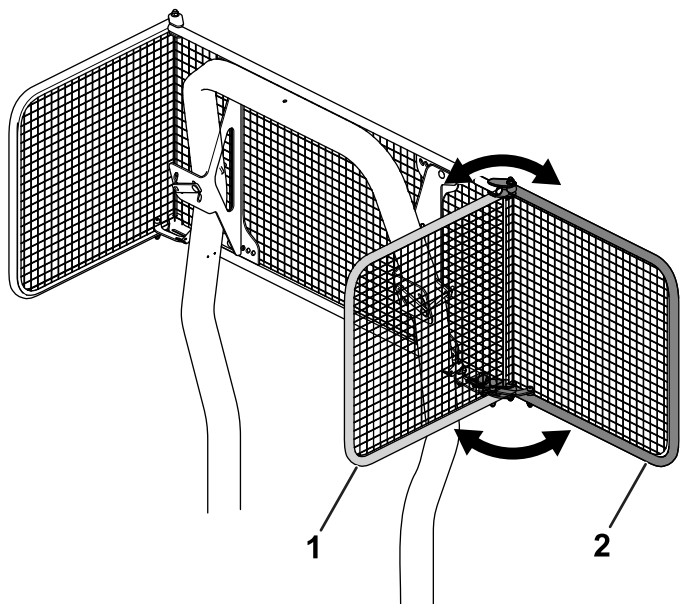

g198219

**Figure 14**

1. Guard wing—closed position
2. Guard wing—open position

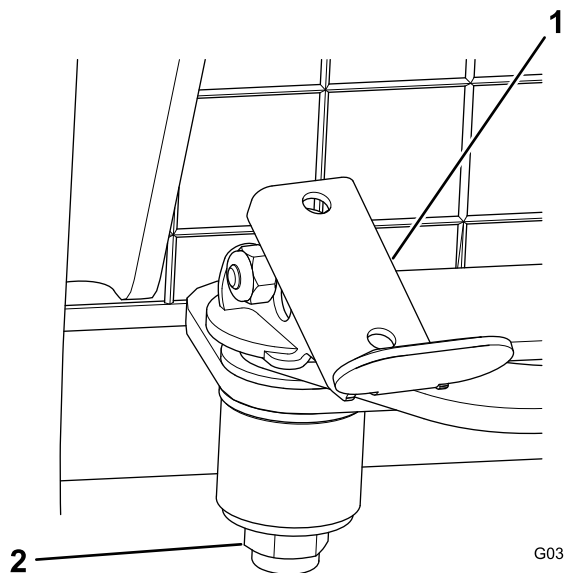

G037489

g037489

**Figure 15**

1. Latch
2. Nut

# Maintenance

## Checking the Mesh

**Service Interval:** Before each use or daily—Check the mesh for damage.



**Count on it.**