

# Caster Wheel Kit

Model No. 145-0475

Model No. 145-0488

Model No. 145-0489

## Installation Instructions

# Installation

## Preparing the Machine

1. Park the machine on a level surface.
2. Disengage the blade-control switch.
3. Move the motion-control levers outward to the PARK position.
4. Shut off the engine and remove the key.
5. Raise the front of the machine so that the casters are off the ground. Support the machine using jack stands.

**Note:** Use jack stands rated for your machine. Refer to the *Operator's Manual* for your machine to determine the weight.

### **⚠ WARNING**

**Mechanical or hydraulic jacks may fail to support the machine and cause serious injury.**

**Use jack stands when supporting the machine.**

## Installing the Kit

1. Remove the existing caster wheel from the fork.
2. Use the fasteners to install the new caster wheel. Ensure that the bolt head faces outward from the machine.

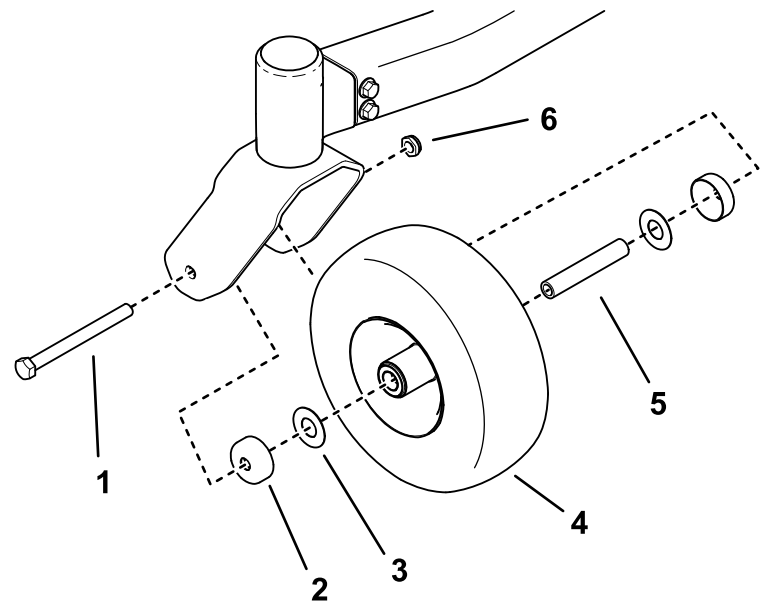

Figure 1

- |                   |                    |
|-------------------|--------------------|
| 1. Existing bolt  | 4. Caster wheel    |
| 2. Seal guard (2) | 5. Spanner bushing |
| 3. Washer (2)     | 6. Existing nut    |

3. Torque the nut to 37 to 50 N·m (27 to 37 ft·lb).
4. Repeat the procedure for the other caster wheel.

