



Exhaust Kit

Groundsmaster® 3200, 3300 or 3310 All-Wheel Drive Traction Units

Model No. 144-0487

Model No. 144-0488

Model No. 144-0489

Installation Instructions

Note: Determine the left and right sides of the machine from the normal operating position.

This kit is for models 31900, 31901, 31902, 31903, 31907, and 31909.

Loose Parts

Use the chart below to verify that all parts have been shipped.

Procedure	Description	Qty.	Use
1	No parts required	–	Prepare the machine.
2	Exhaust pipe Clamp Support assembly	1 1 1	Install the new exhaust pipe for 37hp engines with a DPF Filter.
3	Exhaust pipe Clamp Support assembly	1 1 1	Install the new exhaust pipe for 24hp engines.
4	Exhaust pipe Clamp Support assembly	1 1 1	Install the new exhaust pipe for 37hp engines without a DPF filter.

1

Preparing the Machine

No Parts Required

Preparing the Machine

1. Park the machine on a level surface.
2. Shift to the NEUTRAL position.
3. Lower all attachments (if equipped).
4. Engage the parking brake.
5. Shut off the engine and remove the key.
6. Disconnect the battery; refer to your machine *Operator's Manual*.
7. Allow the machine components to cool before installing this kit.

2

Installing the New Exhaust Pipe for 37hp Engines with a DPF Filter

Parts needed for this procedure:

1	Exhaust pipe
1	Clamp
1	Support assembly

Procedure

1. Raise the hood ([Figure 1](#)).



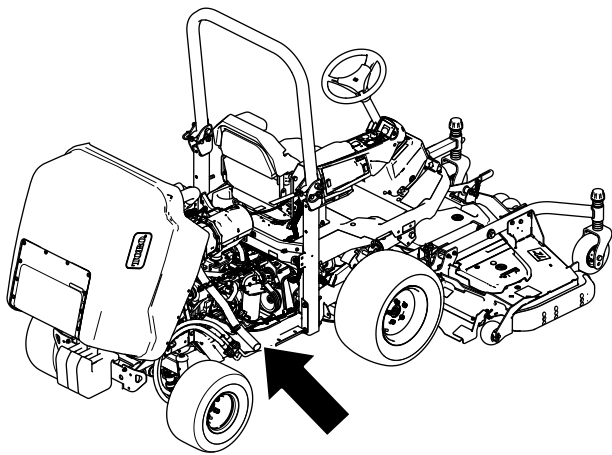

Figure 1

g330959

2. Loosen the clamp at the muffler (Figure 2).
3. Remove the engine bolts and washers from the existing exhaust pipe support (Figure 2) and remove the exhaust pipe.

Note: Retain the hardware and clamp.

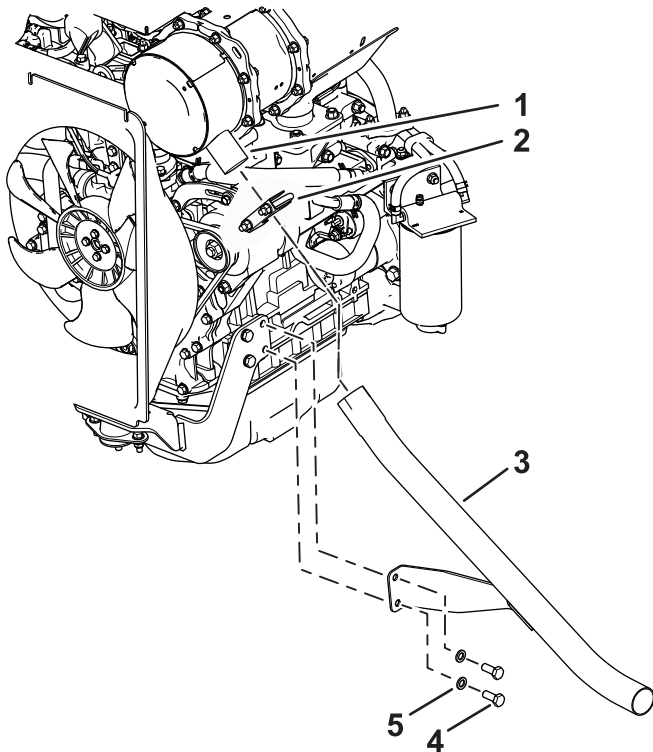

Figure 2

g330960

- | | |
|-----------------|----------------|
| 1. DPF outlet | 4. Engine bolt |
| 2. Clamp | 5. Washer |
| 3. Exhaust pipe | |

5. Slide the existing clamp over the new exhaust pipe and install the new exhaust pipe onto the DPF outlet (Figure 3).

Note: Do not fully tighten the bolts.

6. Install the new clamp around the new exhaust pipe and to the support assembly with the clamp hardware (Figure 3).

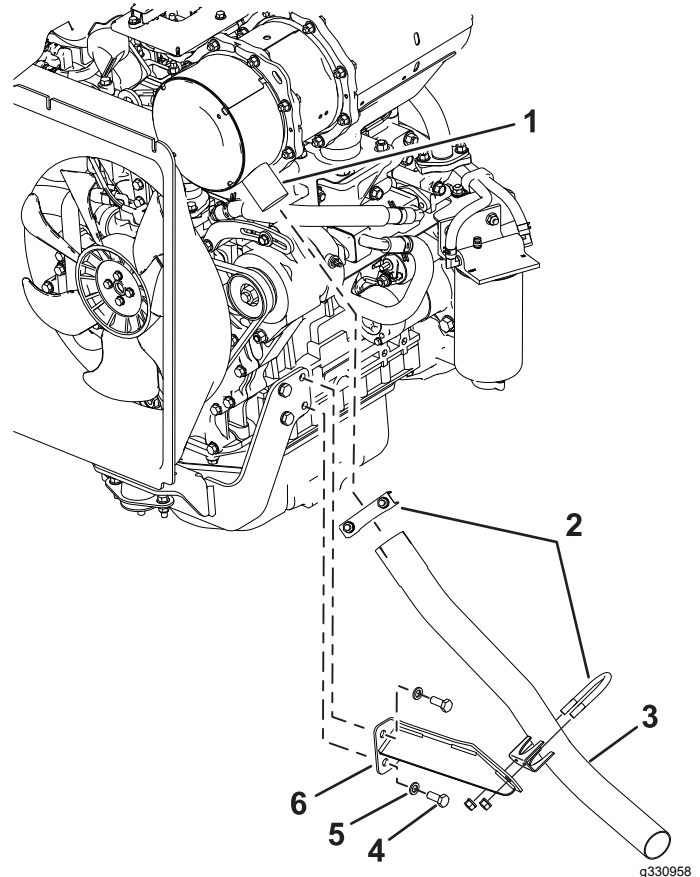

Figure 3

g330958

- | | |
|-----------------|---------------------|
| 1. DPF outlet | 4. Engine bolt |
| 2. Clamp | 5. Washer |
| 3. Exhaust pipe | 6. Support assembly |

4. Install the new support assembly to the side of the engine with the previously removed washers and engine bolts (Figure 3).

Note: Do not fully tighten the bolts.

- Align the clamp flush with the end of the exhaust pipe and rotate it as shown in [Figure 4](#).

Note: Ensure the clamping surface is parallel to the slots in the pipe ([Figure 4](#)).

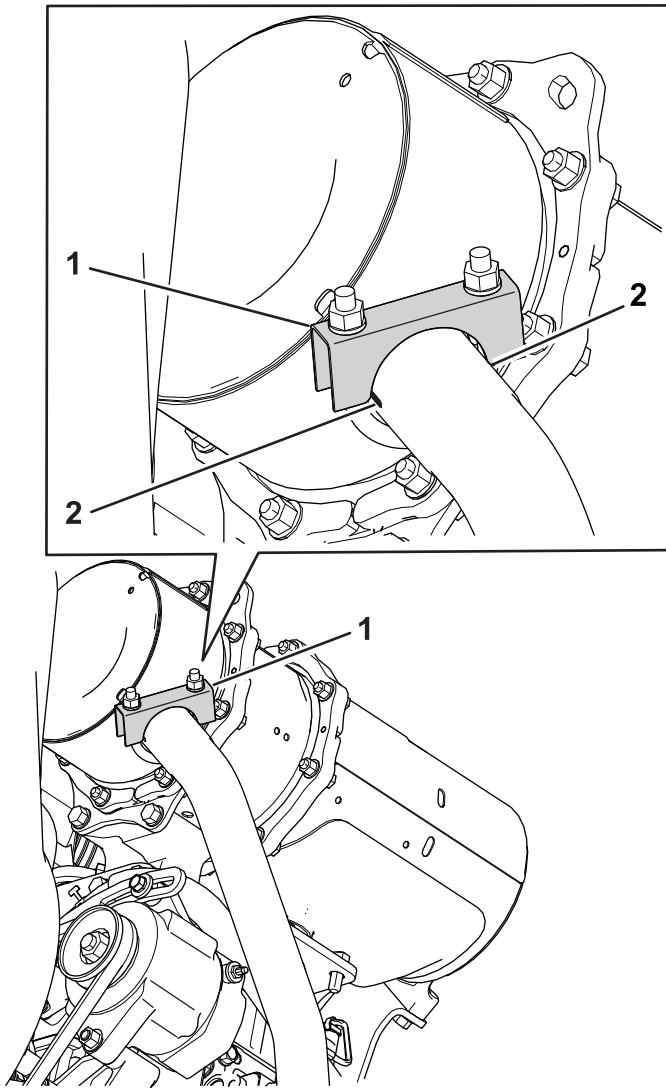

Figure 4

- Clamp in the correct position
- Slot

- Torque the engine bolts to 54 N·m (40 ft-lb) and then tighten all of the clamps ([Figure 3](#)).

3

Installing the New Exhaust Pipe for 24hp Engines

Parts needed for this procedure:

1	Exhaust pipe
1	Clamp
1	Support assembly

Procedure

- Raise the hood ([Figure 5](#)).

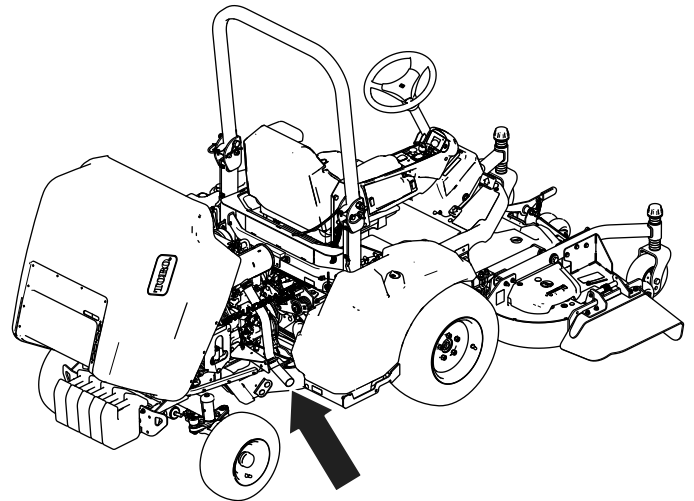

Figure 5

g344481

- Loosen the clamp at the muffler ([Figure 6](#)).
- Remove the engine bolts and washers from the existing exhaust pipe support ([Figure 6](#)) and remove the exhaust pipe.

Note: Retain the hardware and clamp.

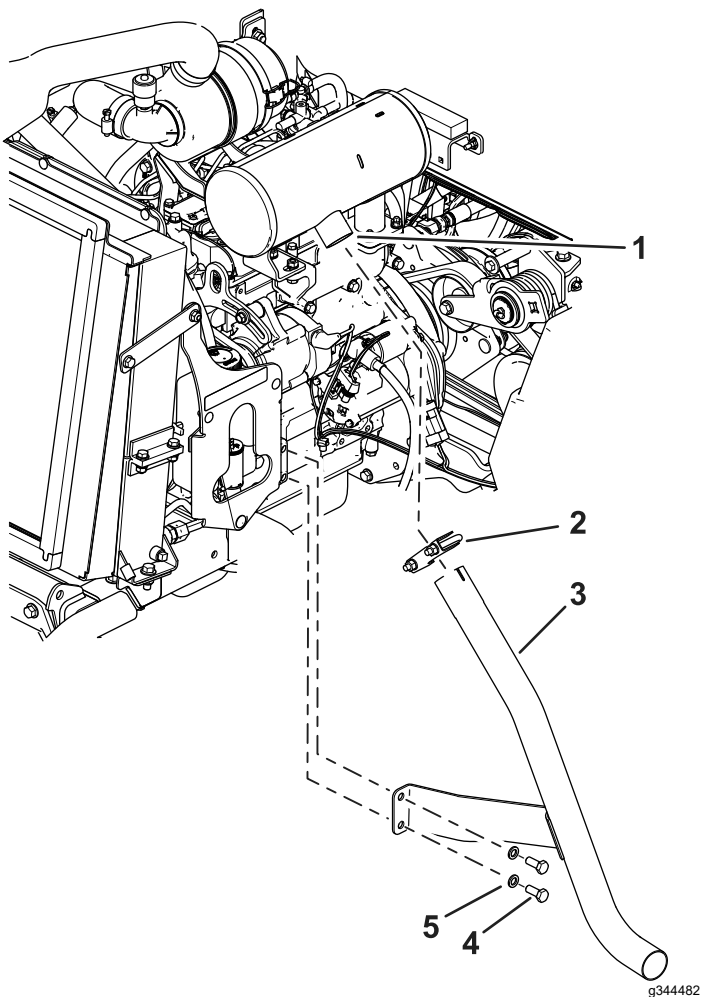

Figure 6

- | | |
|-------------------|----------------|
| 1. Muffler outlet | 4. Engine bolt |
| 2. Clamp | 5. Washer |
| 3. Exhaust pipe | |

-
4. Install the new support assembly to the side of the engine with the previously removed washers and engine bolts (Figure 7).

Note: Do not fully tighten the bolts.

5. Slide the existing clamp over the new exhaust pipe and install the new exhaust pipe onto the muffler outlet (Figure 7).

Note: Do not fully tighten the bolts.

6. Install the new clamp around the new exhaust pipe and to the support assembly with the clamp hardware (Figure 7).

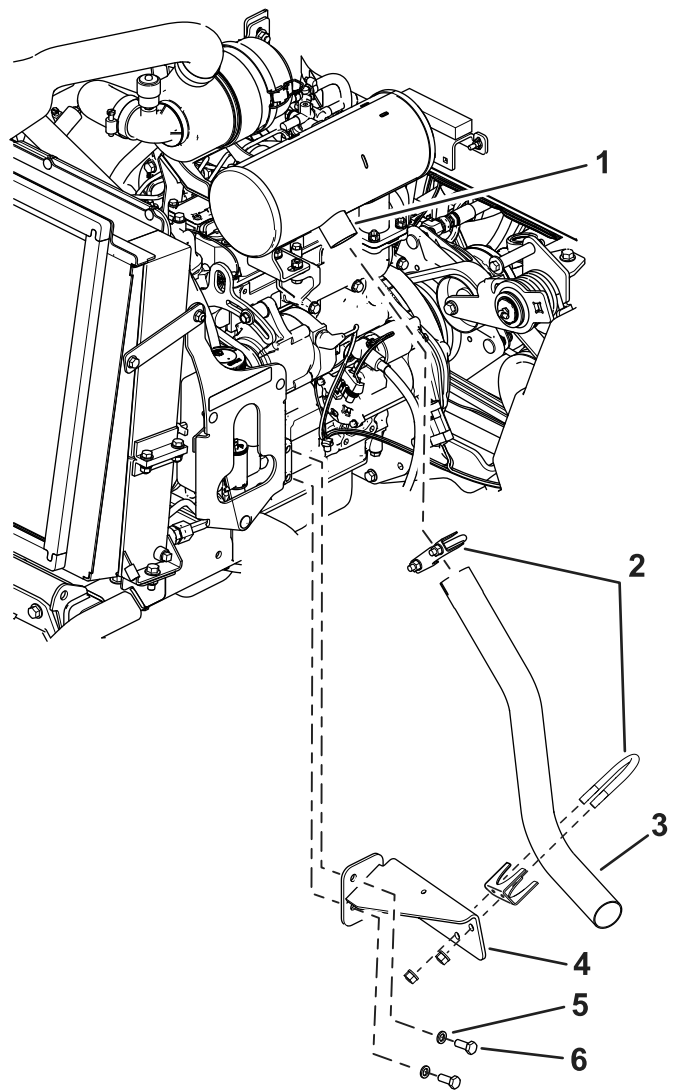

Figure 7

- | | |
|-------------------|---------------------|
| 1. Muffler outlet | 4. Support assembly |
| 2. Clamp | 5. Washer |
| 3. Exhaust pipe | 6. Engine bolt |

- Align the clamp flush with the end of the exhaust pipe and rotate it as shown in [Figure 8](#).

Note: Ensure the clamping surface is parallel to the slots in the pipe ([Figure 8](#)).

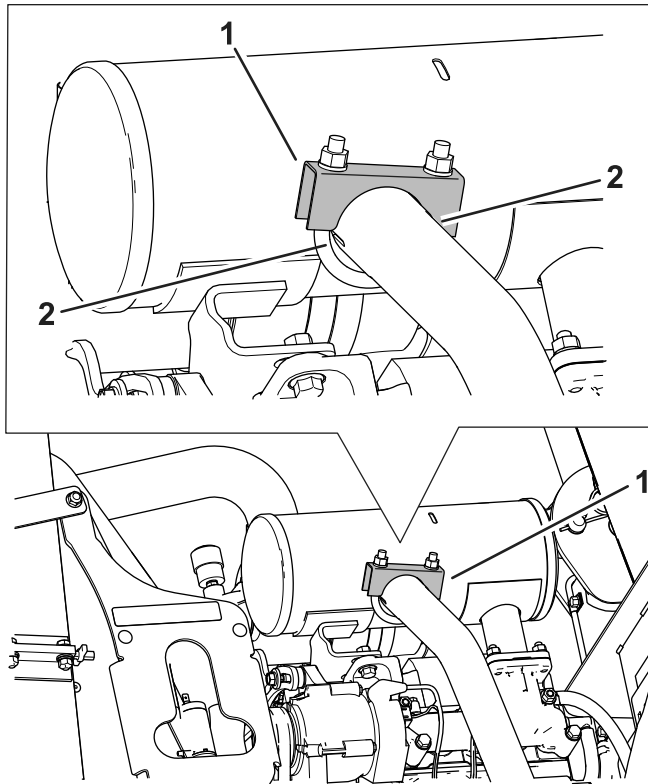

Figure 8

- Clamp in the correct position
- Slot

- Torque the engine bolts to 54 N·m (40 ft-lb) and then tighten all of the clamps ([Figure 7](#)).

4

Installing the New Exhaust Pipe for 37hp Engines without a DPF Filter

Parts needed for this procedure:

1	Exhaust pipe
1	Clamp
1	Support assembly

Procedure

- Raise the hood ([Figure 9](#)).

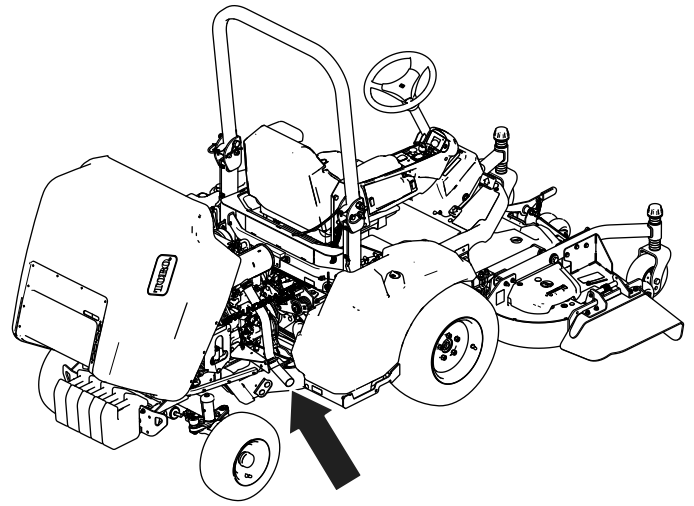

Figure 9

g344481

- Loosen the clamp at the muffler ([Figure 10](#)).
- Remove the engine bolts and washers from the existing exhaust pipe support ([Figure 10](#)) and remove the exhaust pipe.

Note: Retain the hardware and clamp.

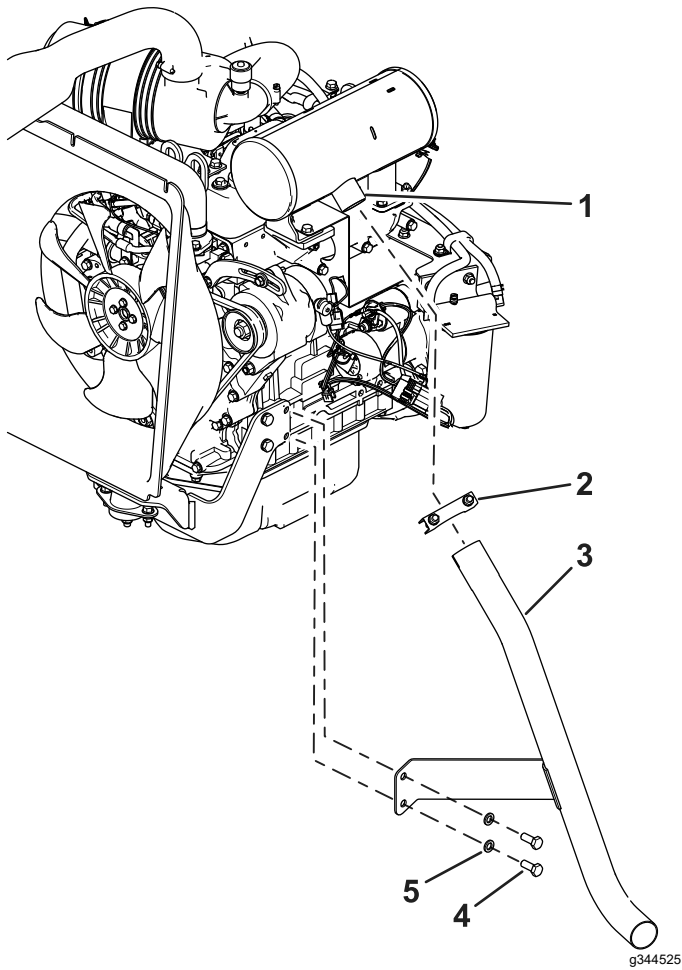

Figure 10

- | | |
|-------------------|----------------|
| 1. Muffler outlet | 4. Engine bolt |
| 2. Clamp | 5. Washer |
| 3. Exhaust pipe | |

-
4. Install the new support assembly to the side of the engine with the previously removed washers and engine bolts (Figure 11).

Note: Do not fully tighten the bolts.

5. Slide the existing clamp over the new exhaust pipe and install the new exhaust pipe onto the muffler outlet (Figure 11).

Note: Do not fully tighten the bolts.

6. Install the new clamp around the new exhaust pipe and to the support assembly with the clamp hardware (Figure 11).

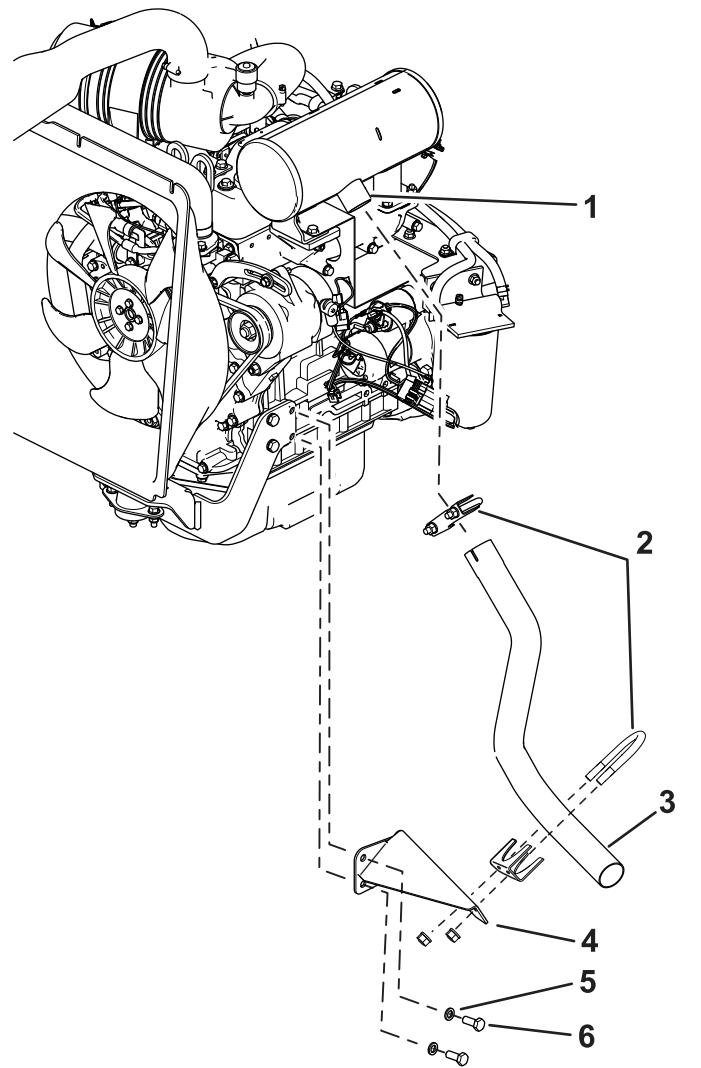

Figure 11

- | | |
|-------------------|---------------------|
| 1. Muffler outlet | 4. Support assembly |
| 2. Clamp | 5. Washer |
| 3. Exhaust pipe | 6. Engine bolt |

- Align the clamp flush with the end of the exhaust pipe and rotate it as shown in [Figure 12](#).

Note: Ensure the clamping surface is parallel to the slots in the pipe ([Figure 12](#)).

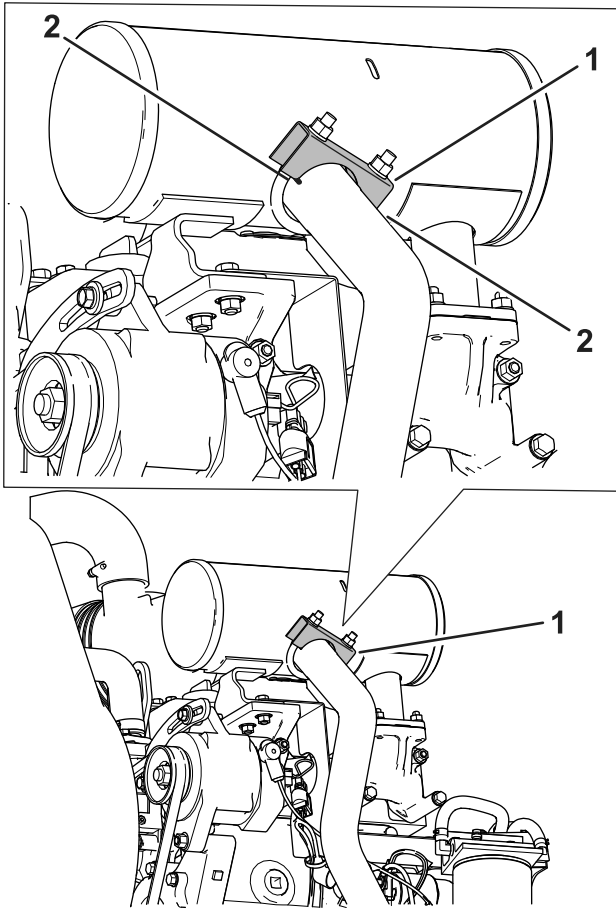

Figure 12

g344523

- Clamp in the correct position
- Slot position

-
- Torque the engine bolts to 54 N·m (40 ft-lb) and then tighten all of the clamps ([Figure 11](#)).



Count on it.