



# Traction Assist Handle Kit

Recycler® Lawn Mower

Model No. 144-6377

## Installation Instructions

### Preparing the Machine

1. Move the machine to a level surface.
2. Shut off the engine and wait for all moving parts to stop.
3. Remove the handle cover (Figure 1).

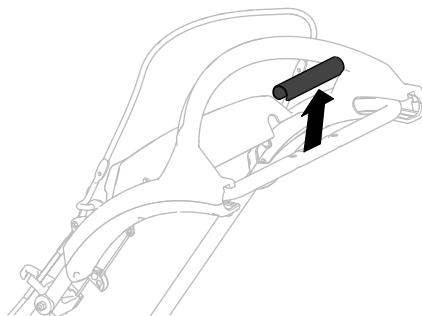

Figure 1

g346829

### Installing the Kit

Install the traction-assist handle on the machine as shown in Figure 2.

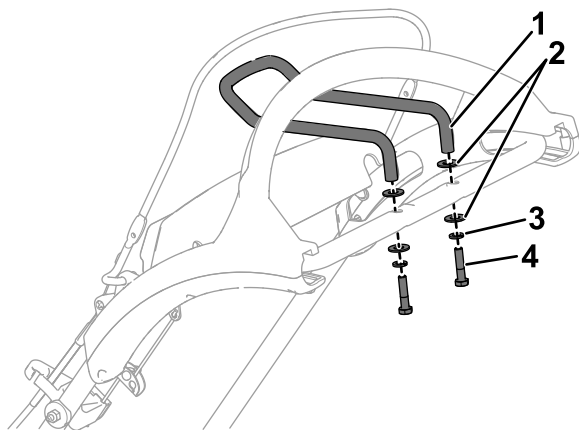

Figure 2

g346831

- |                           |                    |
|---------------------------|--------------------|
| 1. Traction-assist handle | 3. Lock washer (2) |
| 2. Flat washer (4)        | 4. Bolt (2)        |

### Operation

#### Using the Traction-Assist Handle

The traction-assist handle allows you to use your hands to control the speed of the machine instead of your walking speed. This is helpful for turning tight corners, going up hills, and mowing at maximum speed.

1. Reach forward with your fingertips and grasp the corners of the traction-assist handle (Figure 3).



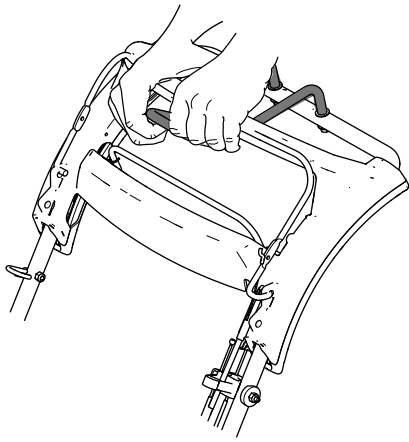

g346836

**Figure 3**

- 
2. Squeeze the 2 handles together until the machine moves at your desired ground speed.
  3. Release the traction-assist handle when you no longer need it.

***Important:*** The machine will continue to self-propel until you release the traction-assist handle and stop walking.