



# Bagger Enhancement Kit

## ProLine Commercial Walk-Behind Mower with 36in Floating Cutting Unit

Model No. 140-4321

### Installation Instructions

Determine the left and right sides of the machine from the normal operating position.

## Preparing the Machine

1. Park the machine on a level surface.
2. Disengage the blade-control switch.
3. Engage the parking brake.
4. Shut off the engine and remove the key.
5. For easier access, raise the front of the machine and support it using jackstands rated for your machine.

### **▲ WARNING**

**Mechanical or hydraulic jacks may fail to support the machine and cause serious injury. Use jack stands when supporting the machine.**

## Installing the Kit

Install the kit as shown in [Figure 1](#).

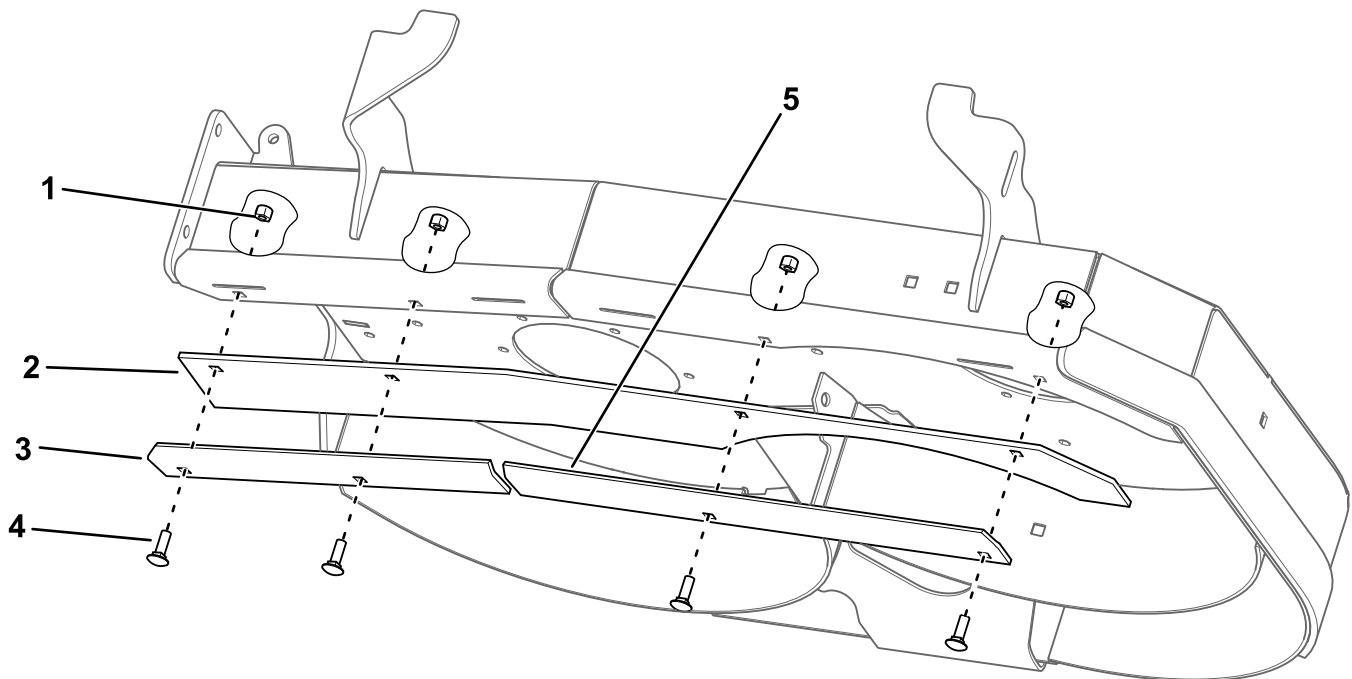

Figure 1

g319532

- |            |                        |                       |
|------------|------------------------|-----------------------|
| 1. Nut (4) | 3. Right skirt bracket | 5. Left skirt bracket |
| 2. Skirt   | 4. Bolt (4)            |                       |





**Count on it.**