



X25 GeoLink® Precision Spray System Kit

Software Version 4.04

Quick Start Guide

Contact Toro NSN at 1-844-GEOLINK (1-844-436-5465) or GeoLinkNSN@toro.com for customer service.

Note: The display is in STANDARD MODE after startup. To change modes, refer to the *GeoLink Operator's Manual*.

Note: Use the ignition key of the machine to run or shut off the display, receiver, and section controller.

Using the Touch Screen

Sprayer information displays on the screen when you touch and enable the individual icons.

- Press any icon on the screen to display what is shown on the screen.
- Press on an icon to select a function, and the related options display.
- Press the options as required, and press the green check box icon for the new display.



Figure 1

g294063



Figure 2

Standard-Mode Home Screen Shown

g294048

- | | | | |
|------------------------------|----------------------------|-------------------------------|-----------------------------|
| 1. System-information icon | 6. Sprayer-controller icon | 11. Receiver calibration icon | 16. Display-view icon |
| 2. Guidance icon | 7. Inventory-manager icon | 12. Job-menu icon | 17. Map-layers icon |
| 3. GPS icon | 8. Setup icon | 13. Field-menu icon | 18. Center-map view |
| 4. Job-information icon | 9. Display dashboard | 14. Quick-start icon | 19. Boundary-selection icon |
| 5. Auto-section control icon | 10. Master-switch icon | 15. Zoom-function icon | 20. Section-display icon |



Identifying the Software Version

Press the Toro icon at the top, left corner of the screen to display the software version.

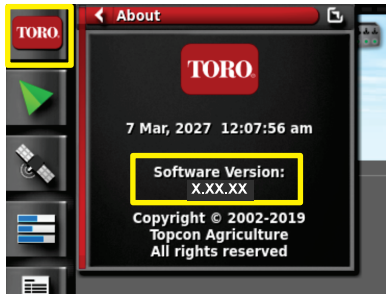

Figure 3

g294808

Using Quick Start

Press the quick-start icon (Figure 2) and a wizard walks you through the steps in this guide.

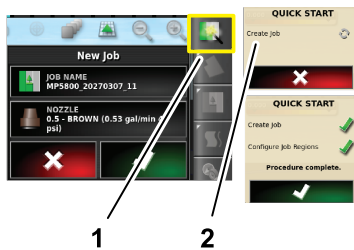

Figure 4

g294615

1. Quick-start icon
2. Wizard

Creating a Field

Note: Create a separate field for each property. Each field can contain multiple boundaries.

1. Press the field-menu icon.
2. Press the new-field icon.
3. Press the field name icon, type in the field name, and press the green check box icon (Figure 5).

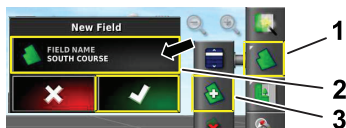

Figure 5

g294047

1. Field-menu icon
2. Field-name icon
3. New-field icon

Creating a New Field Boundary

Note: The boundary is created at the outside, center of the front, left tire.

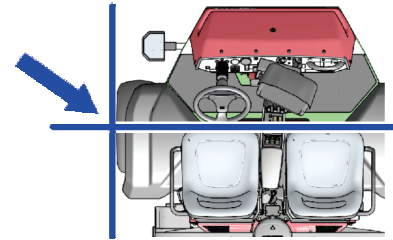

Figure 6

g294392

1. Drive to the field area of the job site.
2. Press the field-menu icon.

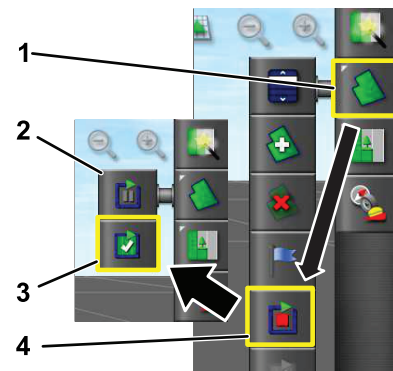

Figure 7

g294470

1. Field-menu icon
2. Pause recording icon
3. Complete recording icon
4. Record boundary icon
3. Press the record-field boundary icon.
4. Drive the machine around the perimeter of the boundary.
5. When you are close to the beginning of the boundary perimeter, press the complete boundary icon.

Naming and Categorizing a Field Boundary

Note: The boundaries that you create and save are accurate and repeatable only if the boundary is created using RTK correction.

1. After creating a boundary, hold your finger on the boundary line.
2. When the boundary line is highlighted, remove your finger from the screen and the edit boundary menu opens.
3. Press the name icon, type in the boundary name, and press the green check box icon.

- Press the region type icon, and select a categorized region, work region, exclude region, or disabled.
- Press the category icon and select a preset category or create a new category.
- Press the green check box icon

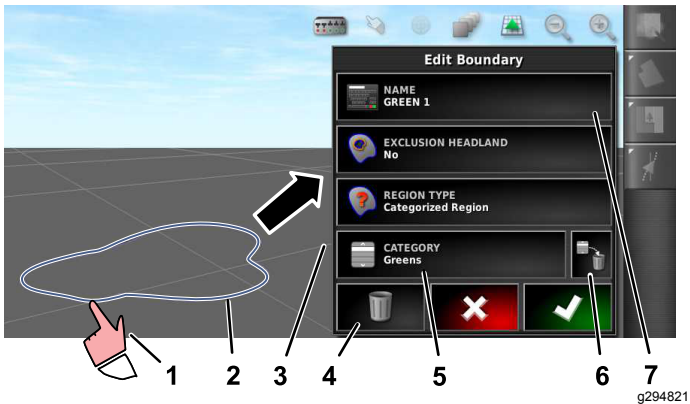

Figure 8

- Select the boundary with your finger
- Boundary
- Edit boundary menu
- Delete the boundary icon
- Category icon
- Delete the category icon
- Name of boundary icon

Creating a Product and Tank Volume

Note: Ensure that the units are correct for your use; refer to Selecting the Correct Units of Measure in the *GeoLink Operator's Manual*.

- Fill the sprayer tank with clean water.
- Press the sprayer-rate controller icon and expand the rate controller mini view (Figure 9).
- Press the select product icon.
- In the pop-up window, press the product name icon, and select a programmed product or a new product.
- Pressing the new product and green check box icons begin the new product setup wizard.
- In the new product setup window, press the custom product and right arrow icons.
- Press product name icon, type the new product name with the pop-up keyboard window, press the green check box icon and then the right arrow icon.
- Press the rate increments icon, type amount that you want to increment the application rate, and press the green check box icon.
- Press the product rate 1 or 2 icons, type application rate for the product, and press the

green check box icon and then the right arrow icon.

- In the save product setting pop-up window, press the green check box icon.
- In the fill tank pop up window, press the yes or no icon to select the new product for sprayer tank.

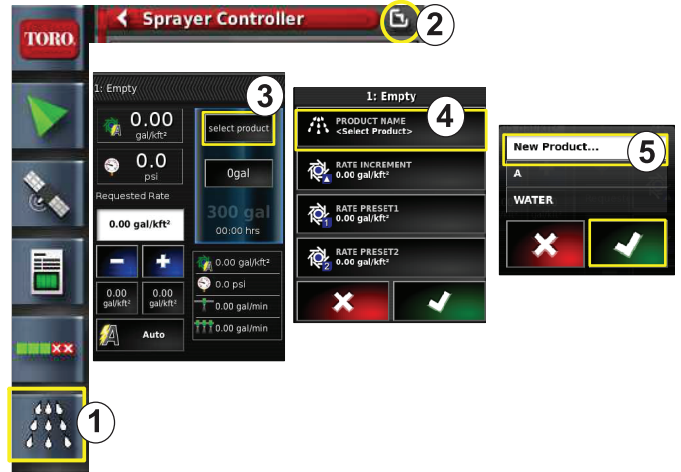

Figure 9

- Spray-rate controller icon
- Expand icon
- Select product icon
- Product name icon
- New product (setup) icon

Spraying a Boundary

- Press the job icon at the right side of the screen (Figure 11).
 - Press the name for the job (Figure 11).
- Note:** For the 1750 sprayers only, run the valve-balance wizard before selecting a nozzle.
- Press the correct nozzle (Figure 12).
 - Expand the Auto Section Control (ASC) Configuration screen and press ASC ON (Figure 13).
 - Select the work region (Figure 10) that you are spraying (i.e. fairways, greens, tees, etc.).
 - Select the excluded region(s) that you are not spraying (bunkers, trees, hazards, etc.), as shown in Figure 10.

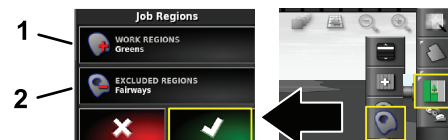

Figure 10

- Select the work regions
- Select the excluded regions
- Press the master switch icon (Multi Pro 5800 only).

- To start spraying, press the master switch to the ON position (Figure 16).
- Press the section switches (located between the seats) to the ON position (Figure 16).

Note: The machine starts spraying when the sprayer crosses into the correct spray area.

Note: Spray at the appropriate speed based on the desired application rate and nozzles on the machine; refer to the *Nozzle Selection Guide*.

Note: The display shows spray active areas in light gray shading and non-spray areas in dark gray shading. If the display shows all light gray, you can spray the entire area.

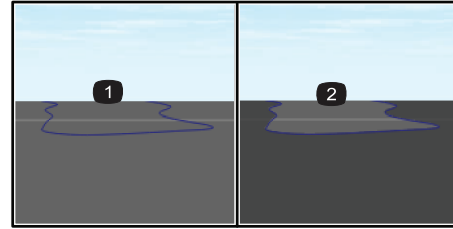

Figure 14

g294061

- ASC OFF
- ASC ON
- Expand the sprayer controller mini view, press the manual speed icon, and enter your test speed.



Figure 15

g294468

- Press the master switch icon (Multi Pro 5800 only), shown in Figure 2.
- To start spraying, press the section switches (located between the seats) to the ON position (Figure 16).

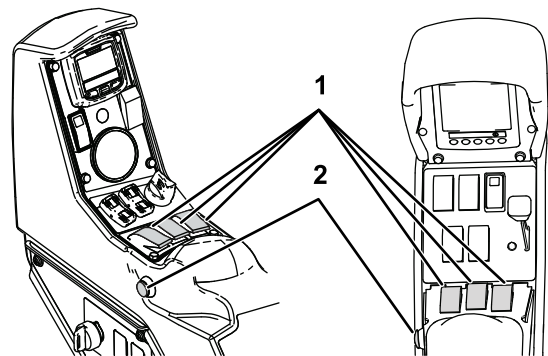

Figure 16

g294087

- Section switches
- Master switch

Note: Spray at the appropriate speed based on the desired application rate and installed nozzles on the machine; refer to the *Nozzle Selection Guide*.

Spraying While Stationary

- Press the job icon in the upper right of the screen (Figure 11).
- Press the new job icon.

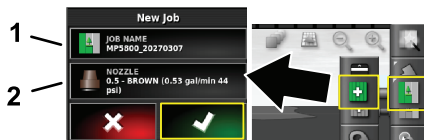

Figure 11

g294394

- Enter a new name
- Select the nozzle

- Type a new name for the job.

Note: For the 1750 sprayers only, run the valve-balance wizard before selecting a nozzle; refer to the *GeoLink Operator's Manual*.

- Select the correct nozzle.

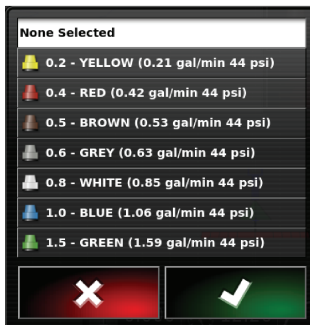

Figure 12

g294466

- Expand the Auto Section Control Configuration (ASC) mini view and press ASC OFF icon.

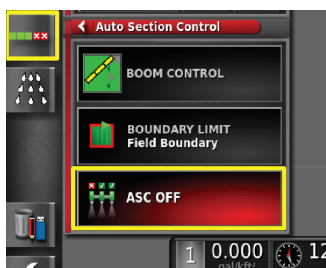

Figure 13

g294467