



Pneumatic Caster Kit

GrandStand® Mower

Model No. 137-4136

Model No. 140-4311

Installation Instructions

⚠ WARNING

CALIFORNIA Proposition 65 Warning

Use of this product may cause exposure to chemicals known to the State of California to cause cancer, birth defects, or other reproductive harm.

Installation

Preparing the Machine

1. Park the machine on a level surface.
2. Disengage the PTO, engage the parking brake, and move the motion-control levers outward to the NEUTRAL-LOCK position.
3. Shut off the engine and remove the key.
4. Raise the front of the machine so that the casters are off the ground. Support the machine using jack stands.

Note: Use jack stands rated for your machine. Refer to the *Operator's Manual* for your machine to determine the weight.

⚠ WARNING

Mechanical or hydraulic jacks may fail to support the machine and cause serious injury.

Use jack stands when supporting the machine.

Installing the Kit

1. Remove the locknut and bolt holding the caster wheel to the caster fork (Figure 1). Remove the wheel.

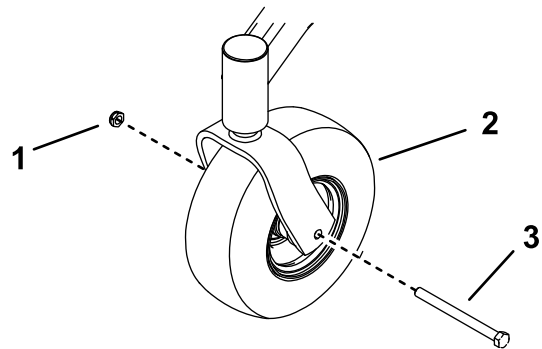

Figure 1

g220556

1. Locknut
2. Wheel
3. Bolt

2. Use the locknut and bolt to install the pneumatic caster wheel (Figure 1). Ensure that the valve stem faces outward from the machine. Torque the bolt to 91 to 113 N·m (67 to 83 ft-lb).
3. Repeat the procedure for the other caster wheel.
4. Inflate the caster wheels to 483 to 552 kPa (70 to 80 psi).

