



Deluxe Seat Kit

TimeCutter® Riding Mower

Model No. 140-2057

Installation Instructions

Installation

Loose Parts

Use the chart below to verify that all parts have been shipped.

Procedure	Description	Qty.	Use
1	No parts required	–	Prepare the machine.
2	No parts required	–	Remove the existing seat.
3	Seat back Bolt (5/16 x 1–1/2 inches) Nut (5/16 inch) Seat-base assembly	1 2 2 1	Install the deluxe seat kit.
4	No parts required	–	Test the safety-interlock system.

1

Preparing the Machine

No Parts Required

Procedure

1. Park the machine on a level surface.
2. Disengage the blade-control switch.
3. Move the motion-control levers outward to the NEUTRAL-LOCK position to engage the parking brake.
4. Shut off the engine and remove the key.



2

Removing the Existing Seat Assembly

No Parts Required

Procedure

1. Tilt the seat up as shown in [Figure 1](#).
2. Unhook the tilt cable from the seat pan ([Figure 1](#)).

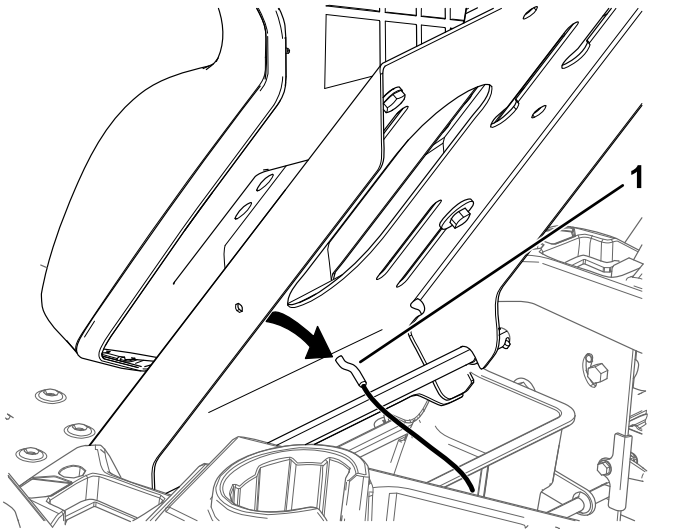

Figure 1

g313311

1. Tilt cable

3. Disconnect the harness from the seat switch ([Figure 2](#)).

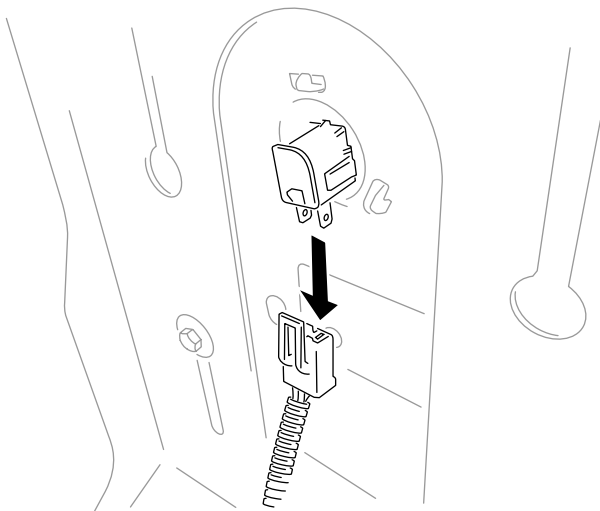

Figure 2

g308594

4. Tilt the seat down.
5. Remove the 2 bolts holding the existing seat assembly on the pivot rod ([Figure 3](#)).

Note: Retain the 2 bolts for installation of the deluxe seat assembly.

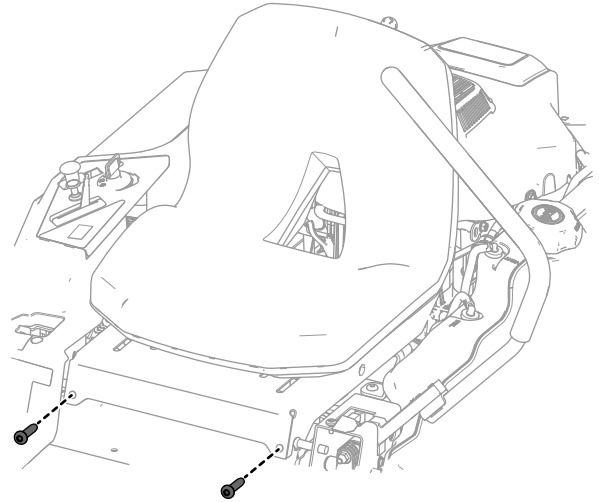

Figure 3

g308596

6. Remove the seat assembly from the machine ([Figure 4](#)).

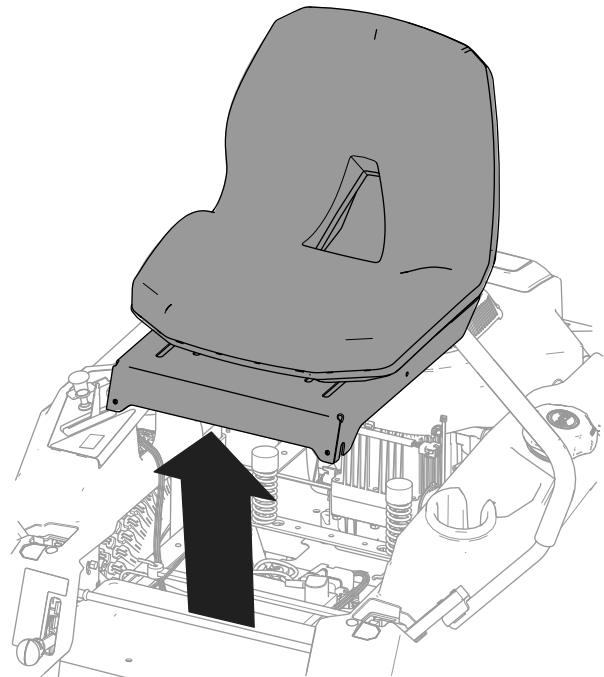

Figure 4

g308665

3

Installing the Deluxe Seat Kit

Parts needed for this procedure:

1	Seat back
2	Bolt (5/16 x 1-1/2 inches)
2	Nut (5/16 inch)
1	Seat-base assembly

Procedure

1. Secure the seat-base assembly onto the pivot rod with the 2 bolts previously removed (Figure 5).

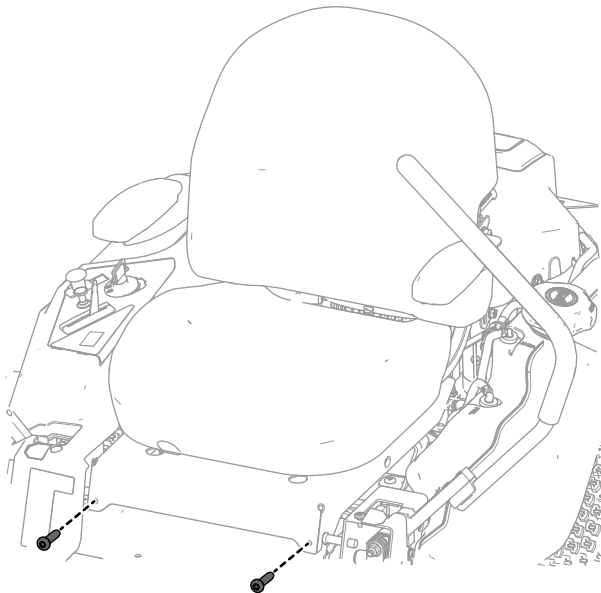

Figure 5

g308748

2. Slide the seat back onto the seat-base posts and align the holes (Figure 6).
3. Secure the seat back using 2 bolts (5/16 x 1-1/2 inches) and 2 nuts (5/16 inch); refer to Figure 6. Torque the bolts to 24 N·m (18 ft-lb).

Note: Insert the bolts from back to front. You may need to shift the seat fabric to install the nuts.

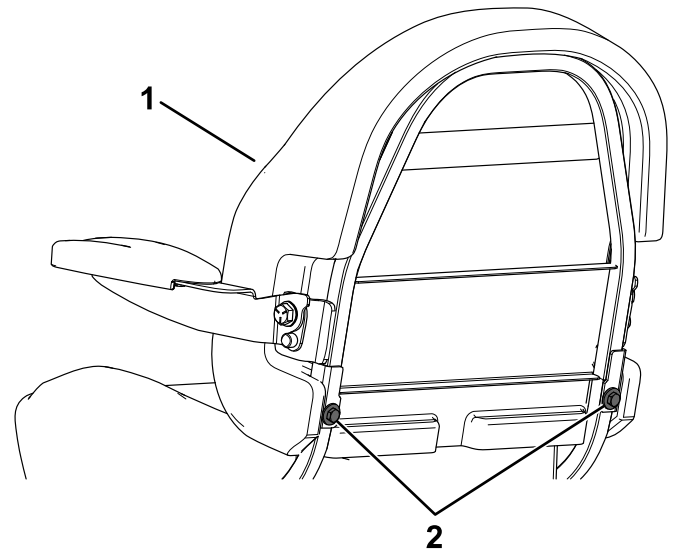

Figure 6

g298473

1. Seat back
2. Bolts and nuts

4. Tilt the seat assembly up.
5. Connect the seat switch (Figure 7).

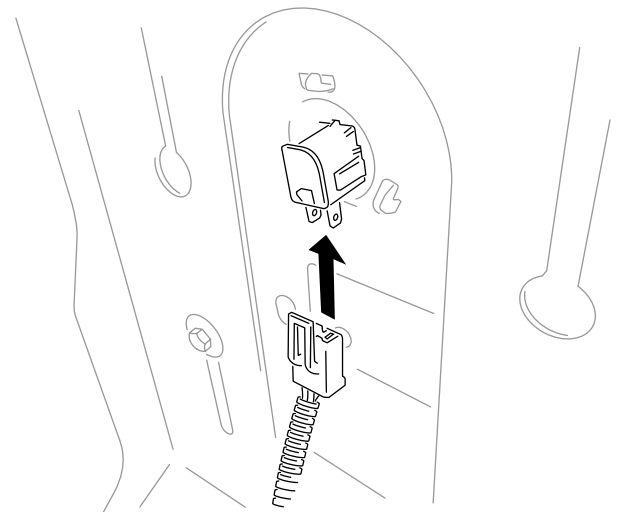

Figure 7

g308749

6. Tilt the seat back partway.
7. Attach the seat-tilt cable from inside the seat pan (Figure 8).

Product Overview

Controls

Fore/Aft Adjustment Lever

The seat can move forward and backward. Position the seat where you have the best control of the machine and are most comfortable (Figure 9).

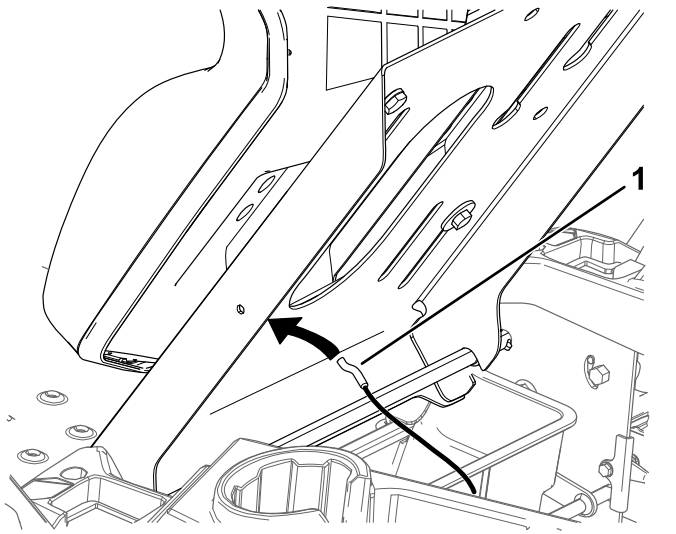
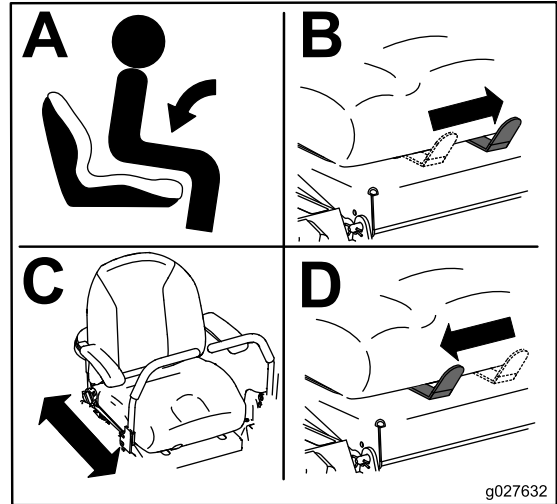

Figure 8

g313032

1. Seat-tilt cable



g027632

g027632

Figure 9

4

Testing the Safety-Interlock System

No Parts Required

Procedure

⚠ CAUTION

If safety interlock switches are disconnected or damaged the machine could operate unexpectedly causing personal injury.

- Do not tamper with the interlock switches.
- Check the operation of the interlock switches daily and replace any damaged switches before operating the machine.

Refer to your *Operator's Manual* for the correct procedure to check the safety-interlock system.

Test the safety-interlock system before you use the machine each time. If the safety system does not operate as described in your *Operator's Manual*, have an Authorized Service Dealer repair the safety system immediately.