



# Wheel Tooth Kit

## STX-26/38 Stump Grinder

Model No. 137-4608

Model No. 137-4609

Model No. 137-4610

### Installation Instructions

## Preparing the Machine

1. Park the machine on a level surface.
2. Lower the grinder head.
3. Engage the parking brake.
4. Shut off the engine and remove the key.
5. Wait for all moving parts to stop before leaving the operating position.

## Installing the Kit

Due to the high amount of wear placed on the teeth, rotate and replace them periodically. Before you rotate or replace them, inspect each tooth holder on each pocket, including the flat lands that prevent the teeth from rotating. If the tooth holder is damaged, replace the pocket.

To install a tooth, align 1 of the 3 flat sides with the flat side on the pocket. Secure the tooth with a washer and nut and torque the nut to 68 N·m (50 ft-lb).

Each tooth is indexed with 3 positions so that you can rotate it twice, exposing a new sharp edge before replacing the tooth. To rotate a tooth, loosen the nut securing the tooth ([Figure 1](#)). Push the tooth forward and rotate it 1/3 of a turn, bringing an unused edge to the outside. Torque the nut securing the tooth to 68 N·m (50 ft-lb).

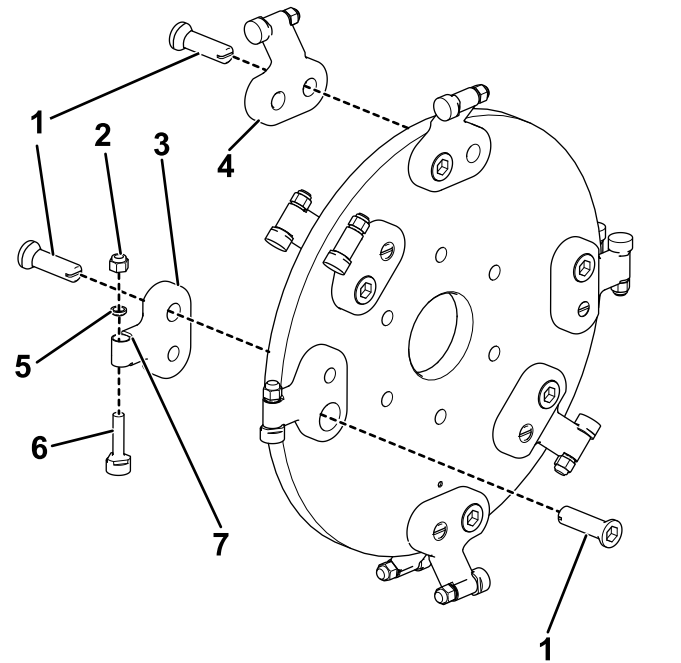

**Figure 1**

- |                    |              |
|--------------------|--------------|
| 1. Hex bolt        | 5. Washer    |
| 2. Nut             | 6. Tooth     |
| 3. Straight pocket | 7. Flat land |
| 4. Angled pocket   |              |

g312440

