

**TORO**

PART NO. 100-6421

**INSTALLATION  
INSTRUCTIONS****RADIATOR KIT**

For Greensmaster® 3200 &amp; 3200-D

**REMOVE OLD RADIATOR****CAUTION**

Before servicing or making adjustments to the machine, stop engine and remove key from the switch.

1. Carefully remove radiator cap from radiator elbow assembly to release any pressure in system (Fig. 1).

**CAUTION**

If engine has been running, pressurized hot coolant can escape when radiator cap is removed and cause burns.

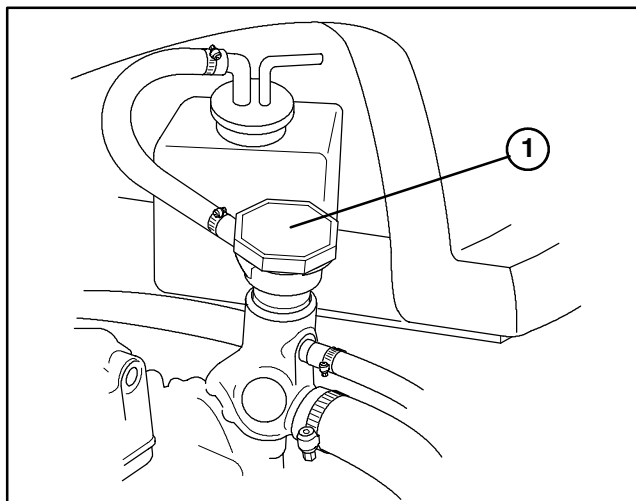
**Figure 1**

1. Radiator cap

2. Drain coolant from radiator.
3. Remove clamp securing lower radiator hose to radiator. Disconnect hose from radiator. Retain clamp for re-installation.
4. Disconnect upper radiator hose and clamp from radiator (Fig. 2). Retain clamp for re-installation.
5. Disconnect air cleaner hose and clamp from radiator support (Fig. 2). Retain clamp for re-installation.
6. Remove radiator screen. Retain for re-installation (Fig. 2).

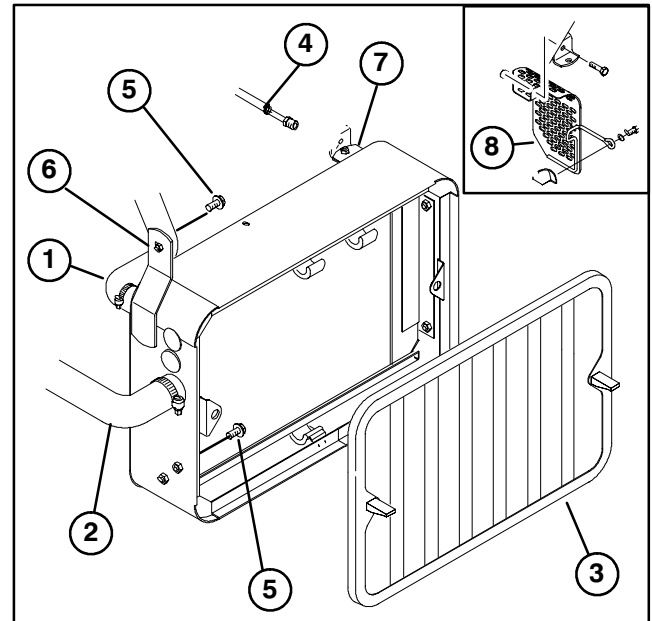
**Figure 2**

- |                        |                            |
|------------------------|----------------------------|
| 1. Upper radiator hose | 5. Thread forming screw    |
| 2. Air cleaner hose    | 6. Top front support strap |
| 3. Radiator screen     | 7. Top rear support strap  |
| 4. Breather hose       | 8. Alternator guard        |

7. Disconnect breather hose fitting from radiator (Fig. 2). Retain all breather hose components for re-installation.

**Note:** If machine is equipped with an oil cooler, disconnect oil cooler tubes and replace with new tubes, Toro Part No. 100-3167 & 100-3168. (Tube not supplied with kit).

8. Remove the flange head thread forming screw securing side of radiator support to traction unit frame (Fig. 2). Retain screw for re-installation.

9. Remove the flange head thread forming screw securing top front radiator support strap to traction unit frame (Fig. 2). Retain screw for re-installation.

10. Remove capscrew and nut securing rear of alternator guard to traction unit frame (Fig. 2, inset). Retain capscrew and nut for re-installation.

11. Remove capscrew, flat washer and nut securing top rear radiator support strap to traction unit frame (Fig. 2). Retain capscrew, flat washer and nut for re-installation.

12. Remove radiator assembly.

## MOUNT NEW RADIATOR

1. Mount top of new radiator to traction unit frame with fasteners previously removed.
2. Determine which new alternator guard is required by comparing to old guard.
3. Mount guard to radiator support with a capscrew, flatwasher and nut supplied in kit.
4. Mount guard to traction unit frame with fasteners previously removed.

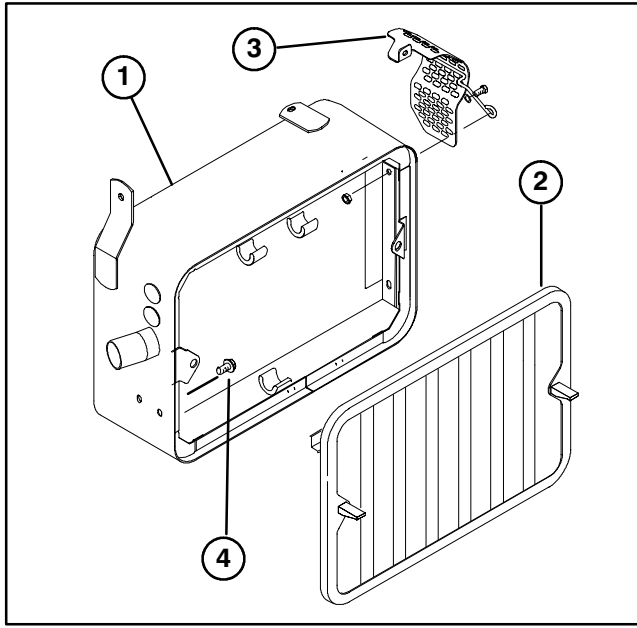

**Figure 3**

1. Radiator
2. Radiator screen
3. Alternator guard
4. Thread forming screw

5. Make sure radiator is positioned straight and vertical in traction unit. Use the hole in each side of radiator support as a guide to locate, mark and drill a .281" dia. mounting hole in step support of traction unit frame.

6. Mount side of radiator support to frame with the thread forming screw previously removed.

7. Connect breather hose to radiator.

8. Install radiator screen.

9. Connect air cleaner hose to radiator support with clamp previously removed.

10. Connect upper and lower radiator hoses to radiator with clamps previously removed.

11. Fill radiator with a 50/50 mixture of water and permanent ethylene glycol anti-freeze. Install radiator cap.

12. Remove reserve tank cap and add coolant until level is between lines on reserve tank. **DO NOT OVERFILL.**

13. Install reserve tank cap.

14. Start engine. Check for leaks and coolant level. Add coolant as required.