



**Count on it.**

**Operator's Manual**

**Z Master® 8000 Series Riding  
Mower**

**with 122cm Cutting Unit**

Model No. 74311TE—Serial No. 405700000 and Up

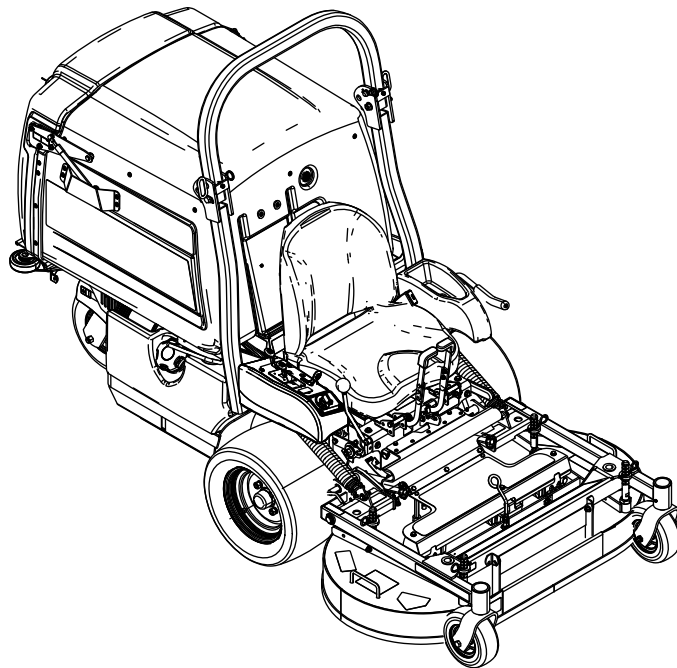

This product complies with all relevant European directives; for details, please see the separate product specific Declaration of Conformity (DOC) sheet.

Please refer to the engine manufacturer's information included with the machine.

**Gross or Net Torque:** The gross or net torque of this engine was laboratory rated by the engine manufacturer in accordance with the Society of Automotive Engineers (SAE) J1940 or J2723. As configured to meet safety, emission, and operating requirements, the actual engine torque on this class of mower will be significantly lower. Please refer to the engine manufacturer's information included with the machine.

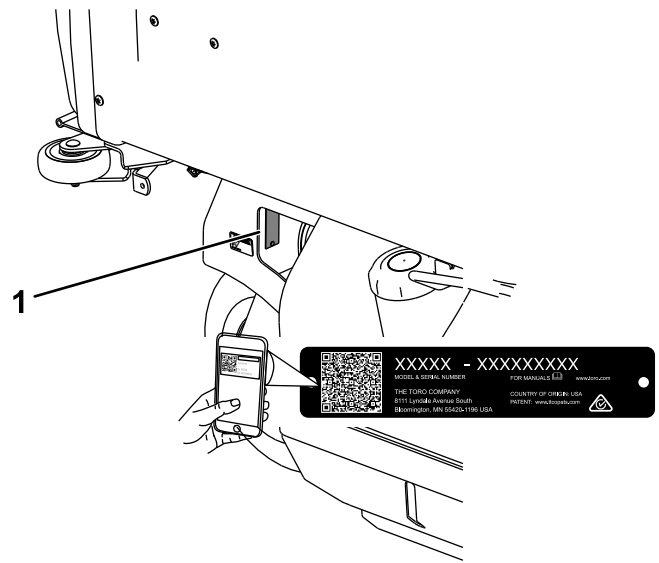

Figure 1

g310514

## Introduction

This rotary-blade, riding lawn mower is intended to be used by professional, hired operators. It is designed primarily for cutting grass on well-maintained lawns on residential or commercial properties. Using this product for purposes other than its intended use could prove dangerous to you and bystanders.

Read this information carefully to learn how to operate and maintain your product properly and to avoid injury and product damage. You are responsible for operating the product properly and safely.

Visit [www.Toro.com](http://www.Toro.com) for product safety and operation training materials, accessory information, help finding a dealer, or to register your product.

Whenever you need service, genuine Toro parts, or additional information, contact an Authorized Service Dealer or Toro Customer Service and have the model and serial numbers of your product ready. [Figure 1](#) identifies the location of the model and serial numbers on the product. Write the numbers in the space provided.

**Important:** With your mobile device, you can scan the QR code on the serial number decal (if equipped) to access warranty, parts, and other product information.

1. Model and serial number location

|                  |
|------------------|
| Model No. _____  |
| Serial No. _____ |

This manual uses 2 words to highlight information. **Important** calls attention to special mechanical information and **Note** emphasizes general information worthy of special attention.

The safety-alert symbol ([Figure 2](#)) appears both in this manual and on the machine to identify important safety messages that you must follow to avoid accidents. This symbol will appear with the word **Danger**, **Warning**, or **Caution**.

- **Danger** indicates an imminently hazardous situation which, if not avoided, **will** result in death or serious injury.
- **Warning** indicates a potentially hazardous situation which, if not avoided, **could** result in death or serious injury.
- **Caution** indicates a potentially hazardous situation which, if not avoided, **may** result in minor or moderate injury.



Figure 2  
Safety-alert symbol

g000502

# Contents

|   |    |   |    |
|---|----|---|----|
| Safety .....                              | 4  | Replacing the Fuel Filter .....             | 40 |
| General Safety .....                      | 4  | Servicing the Fuel Tank.....                | 40 |
| Slope Indicator .....                     | 5  | Electrical System Maintenance .....         | 41 |
| Safety and Instructional Decals .....     | 6  | Electrical System Safety .....              | 41 |
| Product Overview .....                    | 12 | Servicing the Battery.....                  | 41 |
| Controls .....                            | 12 | Adjusting the Safety Switches.....          | 42 |
| Specifications .....                      | 13 | Servicing the Fuses .....                   | 42 |
| Attachments/Accessories .....             | 13 | Jump-Starting the Machine.....              | 43 |
| Before Operation .....                    | 14 | Drive System Maintenance .....              | 44 |
| Before Operation Safety .....             | 14 | Adjusting the Tracking .....                | 44 |
| Adding Fuel .....                         | 15 | Checking the Tire Pressure.....             | 45 |
| Performing Daily Maintenance.....         | 15 | Checking the Wheel Lug Nuts.....            | 45 |
| Breaking in a New Machine .....           | 15 | Checking the Wheel-Hub Slotted Nuts .....   | 45 |
| Raising the Mower Deck into the Service   |    | Adjusting the Caster-Pivot Bearings .....   | 45 |
| Position .....                            | 16 | Cooling System Maintenance .....            | 46 |
| Lowering the Mower Deck to the Operating  |    | Cooling System Safety .....                 | 46 |
| Position .....                            | 16 | Cleaning the Engine Screen and Engine-Oil   |    |
| Adjusting the Fill Reduction System (FRS) |    | Cooler .....                                | 46 |
| Baffles.....                              | 17 | Servicing the Engine-Oil Cooler .....       | 47 |
| Using the Safety-Interlock System .....   | 18 | Cleaning the Engine Cooling Fins and        |    |
| Unlatching the Seat .....                 | 19 | Shrouds .....                               | 47 |
| During Operation .....                    | 19 | Brake Maintenance .....                     | 47 |
| During Operation Safety .....             | 19 | Adjusting the Parking Brake.....            | 47 |
| Operating the Parking Brake.....          | 21 | Belt Maintenance .....                      | 49 |
| Operating the PTO-Engagement Lever.....   | 22 | Inspecting the Belts .....                  | 49 |
| Operating the Throttle.....               | 22 | Replacing the PTO Belts.....                | 49 |
| Operating the Choke .....                 | 22 | Replacing the Pump-Drive Belt.....          | 50 |
| Starting the Engine .....                 | 22 | Adjusting the Belt Guides.....              | 50 |
| Shutting Off the Engine.....              | 23 | Controls System Maintenance .....           | 51 |
| Driving the Machine.....                  | 24 | Adjusting the Reverse-Stop Rod.....         | 51 |
| Adjusting the Height of Cut .....         | 24 | Adjusting the Speed-Control Lever           |    |
| Emptying the Hopper .....                 | 25 | Tension .....                               | 51 |
| Operating Tips .....                      | 25 | Adjusting the Speed-Control Linkage.....    | 52 |
| After Operation .....                     | 26 | Aligning the PTO-Drive Pulley.....          | 52 |
| After Operation Safety .....              | 26 | Aligning the Pump-Drive Pulley.....         | 53 |
| Clearing the Hopper Screen .....          | 26 | Adjusting the PTO Brake Spring .....        | 54 |
| Using the Drive-Wheel Release Valves..... | 26 | Adjusting the Hopper Door.....              | 54 |
| Transporting the Machine .....            | 27 | Adjusting the Locking-Pin Stop on the Mower |    |
| Maintenance .....                         | 29 | Deck.....                                   | 55 |
| Maintenance Safety.....                   | 29 | Hydraulic System Maintenance .....          | 55 |
| Recommended Maintenance Schedule(s) ..... | 29 | Hydraulic System Safety.....                | 55 |
| Lubrication .....                         | 31 | Hydraulic-Fluid Specifications .....        | 55 |
| Greasing the Machine.....                 | 31 | Checking the Hydraulic Fluid .....          | 55 |
| Greasing the Pump-Belt Idler Arm .....    | 31 | Changing the Hydraulic Fluid and            |    |
| Lubricating the Brake-Handle Pivot.....   | 32 | Filter.....                                 | 56 |
| Lubricating the Brake-Rod Bushings and    |    | Checking and Cleaning the Hydraulic         |    |
| Steering-Linkage Rod Ends .....           | 33 | Pumps.....                                  | 56 |
| Changing the Gearbox Oil .....            | 33 | Blade Maintenance .....                     | 57 |
| Greasing the Caster Pivots .....          | 34 | Blade Safety .....                          | 57 |
| Greasing the Caster-Wheel Hubs .....      | 35 | Servicing the Cutting Blades .....          | 57 |
| Engine Maintenance .....                  | 36 | Leveling the Mower Deck.....                | 59 |
| Engine Safety .....                       | 36 | Removing the Mower Deck .....               | 59 |
| Servicing the Air Cleaner .....           | 36 | Installing the Mower Deck.....              | 61 |
| Servicing the Engine Oil.....             | 37 | Adjusting the Locking-Pin Stop on the Mower |    |
| Servicing the Spark Plug.....             | 39 | Deck.....                                   | 61 |
| Fuel System Maintenance .....             | 40 | Cleaning .....                              | 62 |
|   |    | Cleaning under the Mower Deck.....          | 62 |
|   |    | Cleaning Debris from the Machine .....      | 62 |

|                            |    |
|----------------------------|----|
| Disposing of Waste .....   | 62 |
| Storage .....              | 63 |
| Storage Safety .....       | 63 |
| Cleaning and Storage ..... | 63 |
| Troubleshooting .....      | 64 |
| Schematics .....           | 66 |

# Safety

This machine has been designed in accordance with EN ISO 5395.

## General Safety

This product is capable of amputating hands and feet and of throwing objects. Always follow all safety instructions to avoid serious personal injury.

- Read and understand the contents of this *Operator's Manual* before starting the engine.
- Keep bystanders and children away.
- Do not allow children or untrained people to operate or service the machine. Allow only people who are responsible, trained, familiar with the instructions, and physically capable to operate or service the machine.
- Always keep the roll bar in the fully raised and locked position and use the seat belt.
- Do not operate the machine near drop-offs, ditches, embankments, water, or other hazards, or on slopes greater than 15°.
- Do not put your hands or feet near moving components of the machine.
- Do not operate the machine without all guards, safety switches, and other safety protective devices in place and functioning properly.
- Shut off the engine, remove the key, and wait for all moving parts to stop before leaving the operator's position. Allow the machine to cool before servicing, adjusting, fueling, cleaning, or storing it.

# Slope Indicator

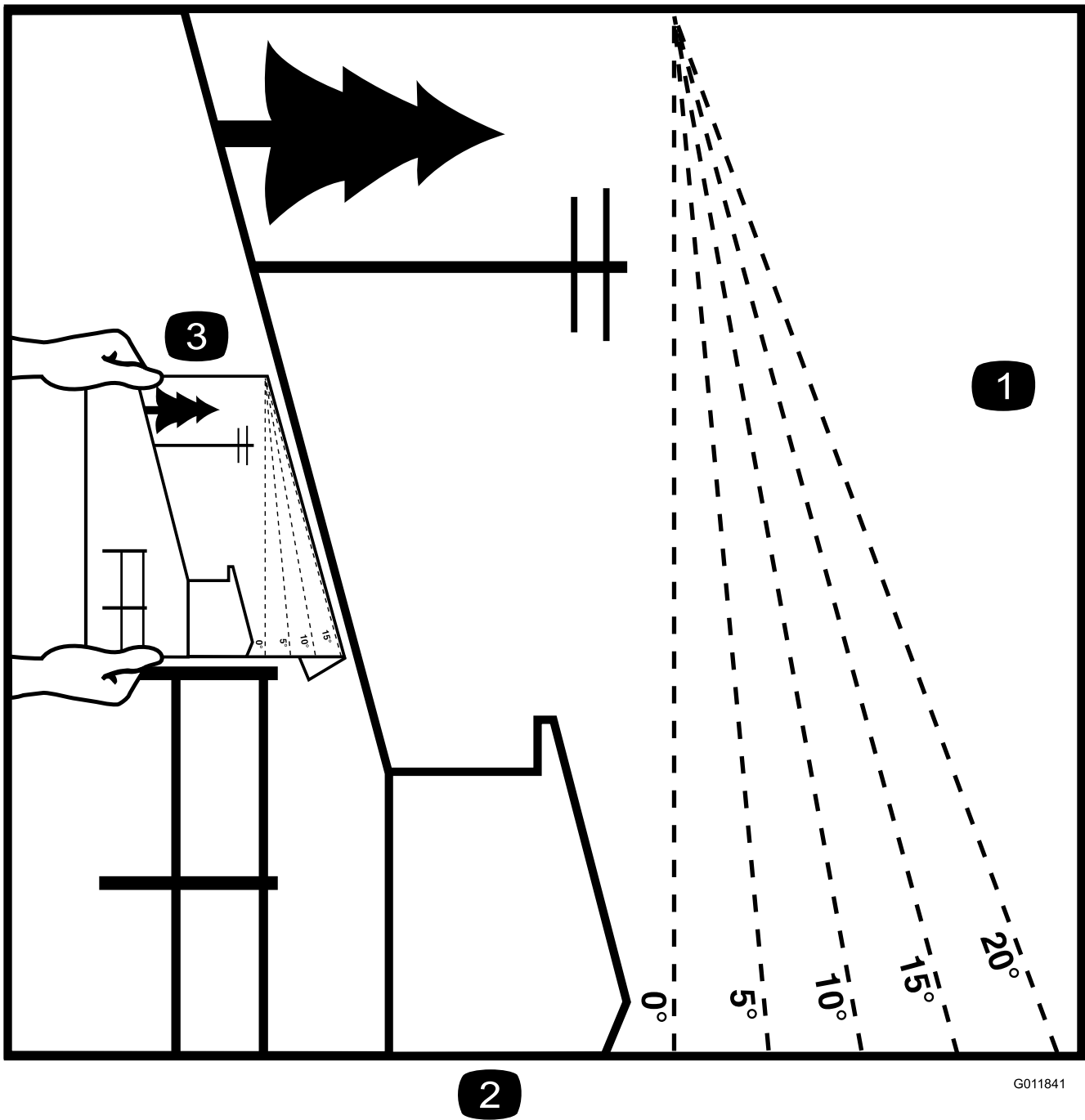

G011841

g011841

**Figure 3**

You may copy this page for personal use.

1. The maximum slope you can operate the machine on is **15 degrees**. Use the slope chart to determine the degree of slope of hills before operating. **Do not operate this machine on a slope greater than 15 degrees**. Fold along the appropriate line to match the recommended slope.
2. Align this edge with a vertical surface, a tree, building, fence pole, etc.
3. Example of how to compare slope with folded edge

# Safety and Instructional Decals



Safety decals and instructions are easily visible to the operator and are located near any area of potential danger. Replace any decal that is damaged or missing.



## Battery Symbols

Some or all of these symbols are on your battery.

- |  |   |
|--|---|
| 1. Explosion hazard                    | 6. Keep bystanders away from the battery.                                       |
| 2. No fire, open flame, or smoking     | 7. Wear eye protection; explosive gases can cause blindness and other injuries. |
| 3. Caustic liquid/chemical burn hazard | 8. Battery acid can cause blindness or severe burns.                            |
| 4. Wear eye protection.                | 9. Flush eyes immediately with water and get medical help fast.                 |
| 5. Read the <i>Operator's Manual</i> . | 10. Contains lead; do not discard   |

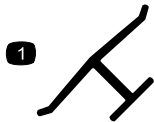

## Manufacturer's Mark

- This mark indicates that the blade is identified as a part from the original machine manufacturer.

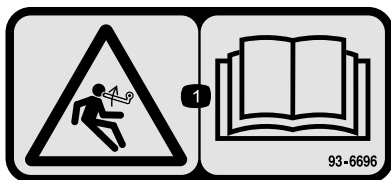

93-6696

- Stored energy hazard—read the *Operator's Manual*.

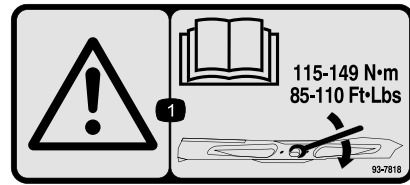

93-7818

- Warning—read the *Operator's Manual* for instructions on torquing the blade bolt/nut to 115 to 149 N•m (85 to 110 ft-lb).

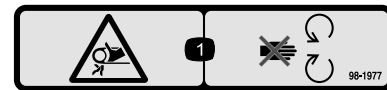

98-1977

- Entanglement hazard, belt—stay away from moving parts.



106-5517

- Warning—do not touch the hot surface.

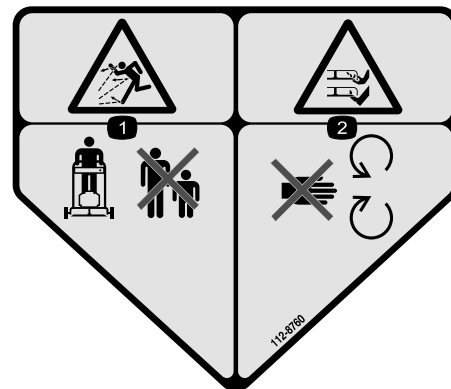

112-8760

- Thrown object hazard—keep bystanders away.
- Cutting/dismemberment hazard of hand or foot, mower blade—stay away from moving parts.

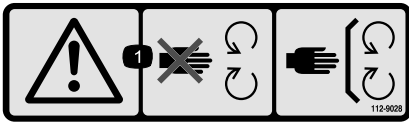

112-9028

decal112-9028

1. Warning—stay away from moving parts; keep all guards and shields in place.



115-4212

decal115-4212

1. Hydraulic fluid level
2. Read the *Operator's Manual*.
3. Warning—do not touch the hot surface.

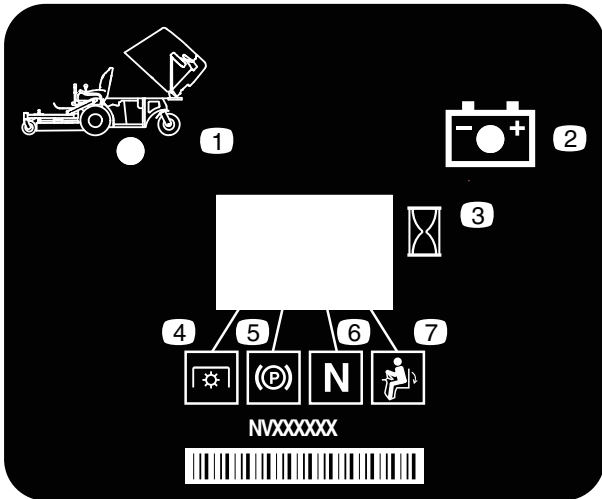

116-8813

decal116-8813

1. Hopper up indicator
2. Battery
3. Hour meter
4. PTO
5. Parking brake
6. Neutral
7. Operator-presence switch

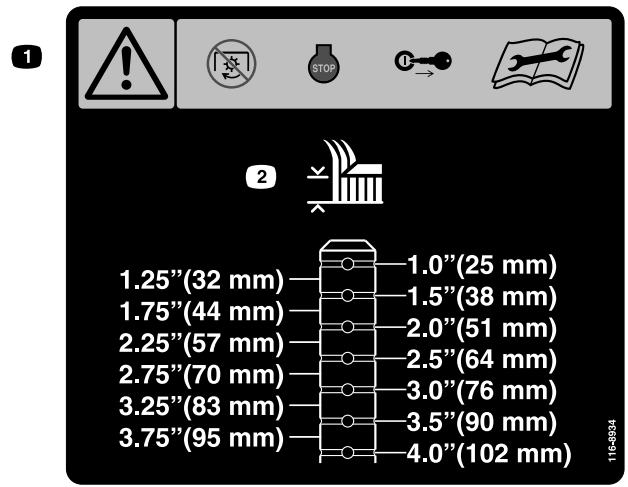

116-8934

decal116-8934

1. Warning—disengage the blade clutch, shut off the engine, and remove the key before making adjustments, servicing, or cleaning the deck.
2. Height of cut

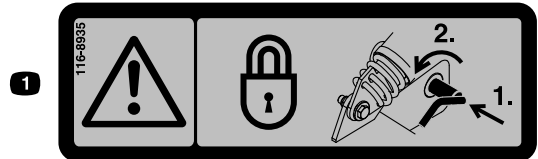

116-8935

decal116-8935

1. Warning folding deck hazard—lock the pivot joint by pushing inward and rotating toward the front of the deck.

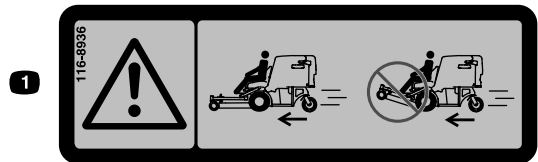

116-8936

decal116-8936

1. Danger—do not operate the machine with the deck in the tilt-up position.

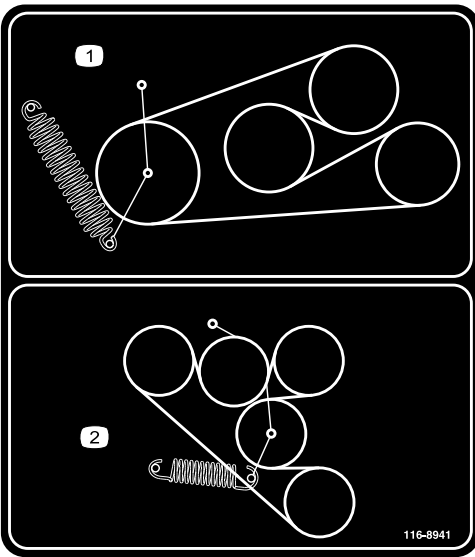

**116-8941**

decal116-8941

1. 1. PTO belt routing
2. 2. Pump-drive belt routing

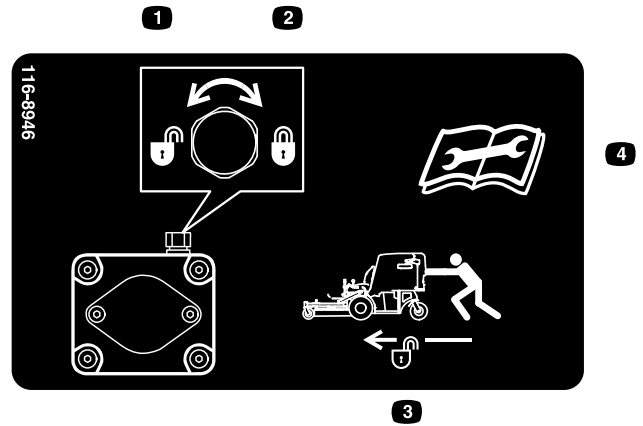

**116-8946**

decal116-8946

1. Rotate counterclockwise to release.
2. Rotate clockwise to lock.
3. Unlock to push the machine.
4. Read the *Operator's Manual* before servicing or performing maintenance.

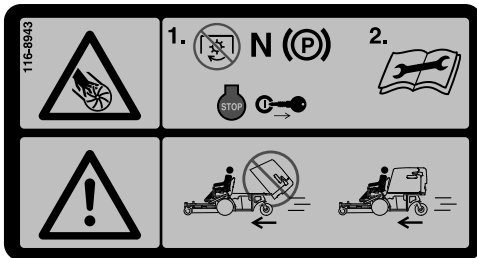

**116-8943**

decal116-8943

1. Rotating blades hazard—disengage the PTO, move the speed-control lever to neutral, engage the parking brake, shut off the engine, and remove the key before leaving the operator's position. Read the *Operator's Manual* before servicing or performing maintenance.
2. Danger—do not operate the machine with mower hopper in the raised position.

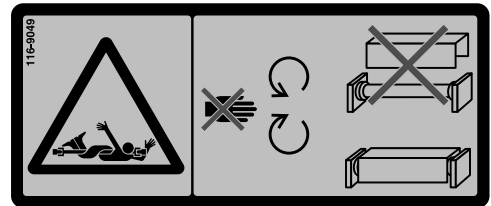

**116-9049**

decal116-9049

1. Rotating driveline hazard—keep all driveline shields in place. Securely attach both ends of the driveline.



**119-0217**

decal119-0217

1. Warning—stop the engine; stay away from moving parts; keep all guards and shields in place.

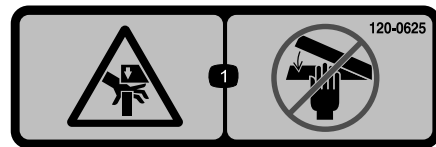

**120-0625**

decal120-0625

1. Pinch point, hand—keep hands away.



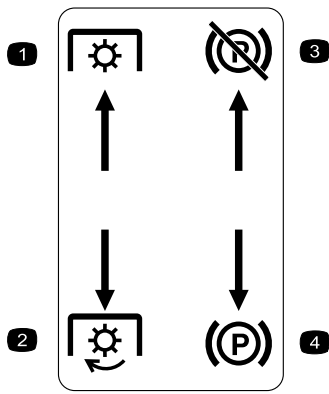

decal126-4159

**Molded in Left Console**

- |                  |                       |
|------------------|-----------------------|
| 1. PTO—disengage | 3. Park brake—release |
| 2. PTO—engage    | 4. Park brake—engage  |

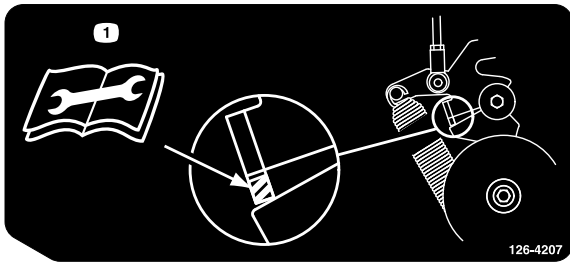

126-4207

decal126-4207

**126-4207**

1. Refer to the *Operator's Manual* for adjustment procedure. When PTO is engaged, the idler arm position must be in hatched area or an adjustment is required.

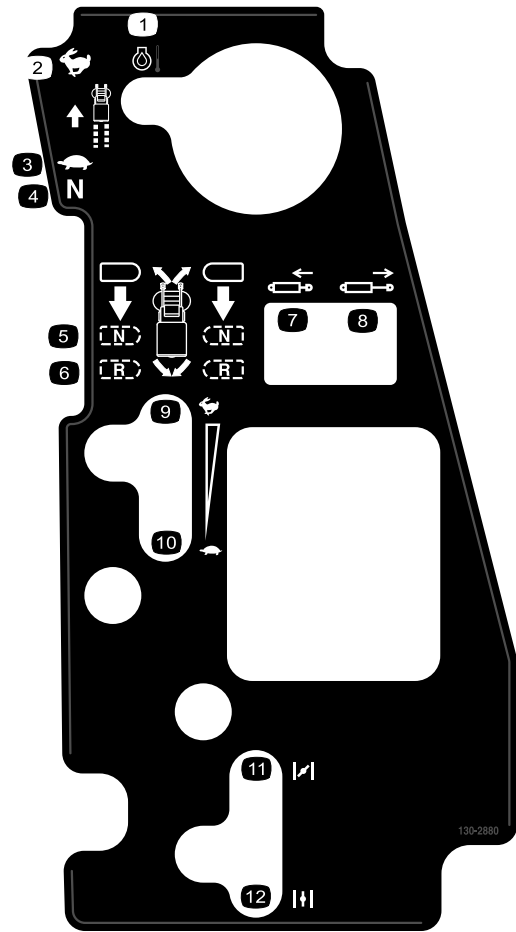

130-2880

decal130-2880

**130-2880**

- |                       |                       |
|-----------------------|-----------------------|
| 1. Engine temperature | 7. Retract the piston |
| 2. Fast               | 8. Extend the piston  |
| 3. Slow               | 9. Fast               |
| 4. Neutral            | 10. Slow              |
| 5. Neutral            | 11. Choke—closed/on   |
| 6. Reverse            | 12. Choke—open/off    |

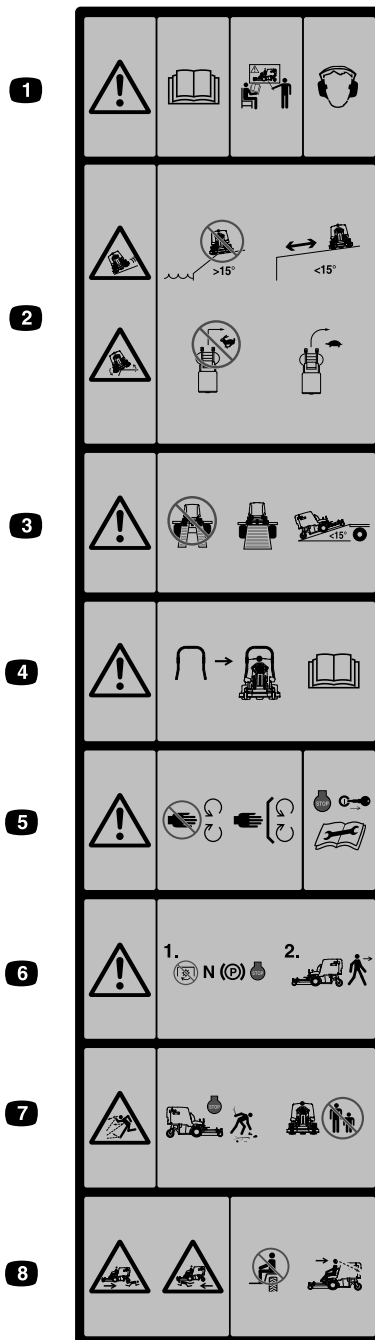

**Molded into Front of Hopper**

decal126-4158

**Note:** This machine complies with the industry standard stability test in the static lateral and longitudinal tests with the maximum recommended slope indicated on the decal. Review the instructions for operating the machine on slopes in the *Operator's Manual* and review the conditions in which you will use the machine to determine whether you can operate the machine in the conditions on that day and at that site. Changes in the terrain can result in a change in slope operation for the machine. If possible, keep the cutting units lowered to the ground while operating the machine on slopes. Raising the cutting units while operating on slopes can cause the machine to become unstable.

1. Warning—Read the *Operator's Manual*. Do not operate this machine unless you are trained. Wear hearing protection.
2. Sliding, tipping hazard—Do not use the machine near drop-offs with slopes greater than 15 degrees; use the machine a safe distance away from drop-offs on slopes less than 15 degrees; do not turn sharply while traveling fast; drive slowly when turning.
3. Warning—Do not use dual ramps; use a singular ramp when transporting the machine; do not use ramps with an incline greater than 15 degrees.
4. A roll bar is available and its use is recommended for areas where there are slopes, drop-offs, or water
5. Warning—Stay away from moving parts; keep all guards in place. Shut off the engine and remove the key before adjusting, servicing, or cleaning the machine.
6. Warning—Disengage the PTO, move the speed-control lever to the neutral position, engage the parking brake, and shut off the engine before leaving the operator's position.
7. Thrown object hazard—Pick up objects that could be thrown by the mower. Do not operate the machine when people and pets are in the area. Keep the deflector in place.
8. Crushing/dismemberment hazard of bystanders—Do not carry passengers; look forward and down when operating the machine; look behind and down when reversing.

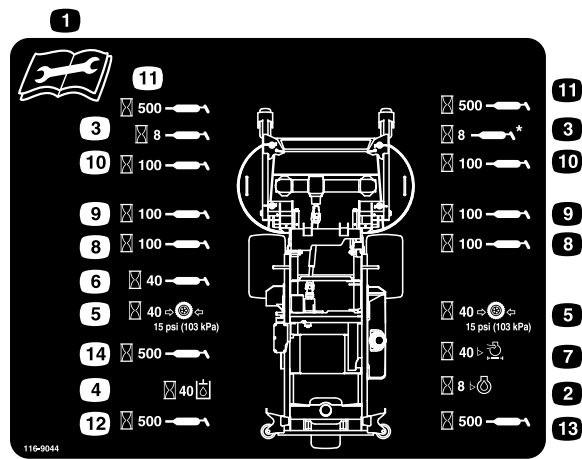

**116-9044**

decal116-9044

1. Read the *Operator's Manual* before performing any maintenance.
2. Check the engine oil every 8 hours.
3. Grease the front caster wheel bearings every 8 hours.
4. Check the hydraulic fluid level every 40 hours (only use recommended hydraulic fluid).
5. Check the tire pressure every 40 hours.
6. Grease the deck drive PTO every 40 hours.
7. Check the air cleaner every 40 hours.
8. Grease the deck lock mechanism every 100 hours.
9. Grease the deck pivots every 100 hours.
10. Check the gearbox oil every 100 hours (use only Mobil 1 75W-90 gear oil).
11. Grease the front caster pivots every 500 hours.
12. Grease the rear caster pivot every 500 hours.
13. Grease the rear caster wheel every 500 hours.
14. Grease the belt idlers every 500 hours.

# Product Overview

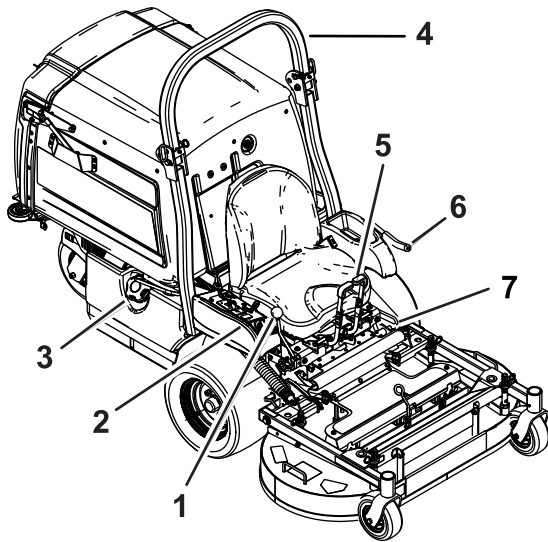

**Figure 4**

g233918

- |                        |                          |
|------------------------|--------------------------|
| 1. Speed-control lever | 5. Motion-control levers |
| 2. Controls            | 6. PTO-engagement lever  |
| 3. Fuel cap            | 7. Parking-brake lever   |
| 4. Roll bar            |                          |

## Controls

Become familiar with all the controls before you start the engine and operate the machine.

### Control Panel

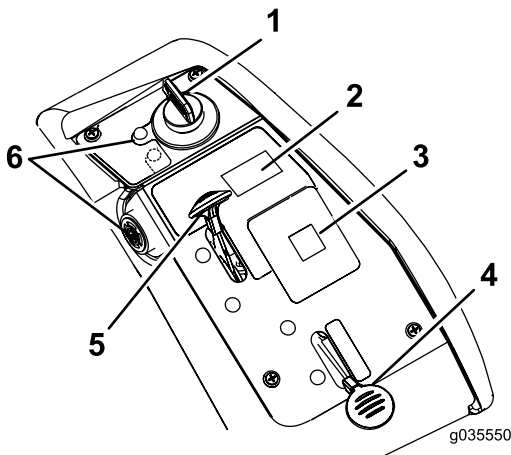

**Figure 5**

g035550

- |                    |  |
|--------------------|--|
| 1. Key switch      | 4. Choke control                           |
| 2. Hopper switch   | 5. Throttle control                        |
| 3. Message display | 6. Engine-oil temperature light and buzzer |

## Key Switch

The key switch, used to start and shut off the engine, has 3 positions: OFF, RUN, and START. Refer to [Starting the Engine \(page 22\)](#).

## Throttle Control

The throttle controls the engine speed, and it has a continuous-variable setting from the SLOW to FAST position ([Figure 5](#)).

## Choke Control

Use the choke control to start a cold engine.

## PTO-Engagement Lever

Use the PTO-engagement lever to engage the blades and the blower.

## Speed-Control Lever

The speed-control lever sets maximum forward speed of the machine ([Figure 4](#)). Moving the speed-control lever rearward to the NEUTRAL position places the drive system into neutral.

## Hour Meter

The hour meter records the number of hours the engine has operated. The hour meter is recording when the decimal point is flashing in the Hour/Voltage display. Use these times for scheduling regular maintenance (Figure 6).

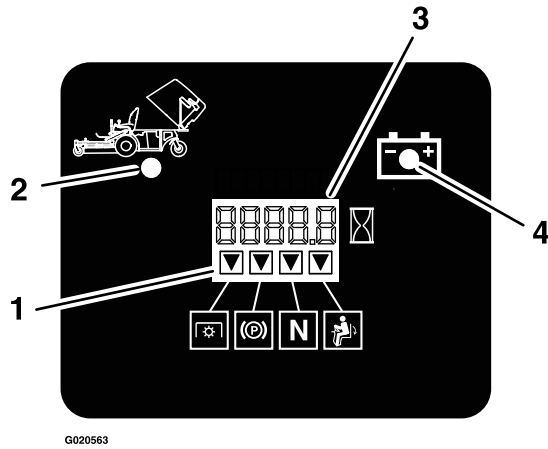

Figure 6

1. Safety-interlock indicators
2. Hopper up
3. Hour/Voltage display
4. Low-voltage indicator light

## Battery-Indicator Light

If you turn the key switch to the ON position for a few seconds, the battery voltage displays in the area where the hours are normally displayed.

The battery light turns on when the key switch is turned on and when the charge is below the correct operating level (Figure 6).

## Safety-Interlock Indicators

There are symbols on the hour meter that indicate with a black triangle that the interlock component is positioned correctly (Figure 6).

## Engine-Oil-Temperature Light and Buzzer

The engine-oil-temperature light monitors the temperature of the engine oil. An illuminated engine-oil-temperature light and intermittent buzzing sound signals that the engine is overheating.

## Motion-Control Levers

Use the motion-control levers to drive the machine forward, reverse, and turn either direction (Figure 4).

## Parking-Brake Lever

Whenever you shut off the engine, engage the parking brake to prevent accidental movement of the machine.

## Fuel-Shutoff Valve

Close the fuel-shutoff valve when transporting or storing the machine.

## Specifications

**Note:** Specifications and design are subject to change without notice.

### Width

|                    | 122 cm Mower Deck  |
|--------------------|--------------------|
| Without Mower Deck | 108 cm (43 inches) |
| With Mower Deck    | 125 cm (49 inches) |

### Length

|                    | 122 cm Mower Deck  |
|--------------------|--------------------|
| Without Mower Deck | 171 cm (67 inches) |
| Mower Deck—Up      | 208 cm (82 inches) |
| Mower Deck—Down    | 240 (95 inches)    |

### Height

| 122 cm Mower Deck  |
|--------------------|
| 130 cm (51 inches) |

### Weight

| 122 cm Mower Deck |
|-------------------|
| 538 kg (1,185 lb) |

## Attachments/Accessories

A selection of Toro approved attachments and accessories is available for use with the machine to enhance and expand its capabilities. Contact your Authorized Service Dealer or authorized Toro distributor or go to [www.Toro.com](http://www.Toro.com) for a list of all approved attachments and accessories.

To ensure optimum performance and continued safety certification of the machine, use only genuine Toro replacement parts and accessories. Replacement parts and accessories made by other manufacturers could be dangerous, and such use could void the product warranty.

# Operation

**Note:** Determine the left and right sides of the machine from the normal operating position.

## *Before Operation*

## Before Operation Safety

### General Safety

- Do not allow children or untrained people to operate or service the machine. Local regulations may restrict the age of the operator. The owner is responsible for training all operators and mechanics.
  - Inspect the area where you will use the machine, and remove all objects that could interfere with the operation of the machine or that the machine could throw.
  - Become familiar with the safe operation of the equipment, operator controls, and safety signs.
  - Check that operator-presence controls, safety switches, and guards are attached and working properly. Do not operate the machine unless they are functioning properly.
  - Shut off the engine, remove the key, and wait for all moving parts to stop before leaving the operator's position. Allow the machine to cool before servicing, adjusting, fueling, cleaning, or storing it.
  - Before mowing, inspect the machine to ensure that the cutting assemblies are working properly.
  - Evaluate the terrain to determine the appropriate equipment and any attachments or accessories required to operate the machine properly and safely.
  - Wear appropriate clothing, including eye protection; long pants; substantial, slip-resistant footwear; and hearing protection. Tie back long hair and do not wear loose clothing or loose jewelry.
  - Do not carry passengers on the machine.
  - Keep bystanders and pets away from the machine during operation. Shut off the machine and attachment(s) if anyone enters the area.
  - Do not operate the machine unless all guards and safety devices, such as the deflectors and the entire grass catcher, are in place and functioning properly. Replace worn or deteriorated parts when necessary.
- ## Fuel Safety
- Fuel is extremely flammable and highly explosive. A fire or explosion from fuel can burn you and others and can damage property.
    - To prevent a static charge from igniting the fuel, place the container and/or machine directly on the ground before filling, not in a vehicle or on an object.
    - Fill the fuel tank outdoors on level ground, in an open area, and when the engine is cold. Wipe up any fuel that spills.
    - Do not handle fuel when smoking or around an open flame or sparks.
    - Do not remove the fuel cap or add fuel to the tank while the engine is running or hot.
    - If you spill fuel, do not attempt to start the engine. Avoid creating a source of ignition until the fuel vapors have dissipated.
    - Store fuel in an approved container and keep it out of the reach of children.
  - Fuel is harmful or fatal if swallowed. Long-term exposure to vapors can cause serious injury and illness.
    - Avoid prolonged breathing of vapors.
    - Keep your hands and face away from the nozzle and the fuel-tank opening.
    - Keep fuel away from your eyes and skin.
  - Do not store the machine or fuel container where there is an open flame, spark, or pilot light, such as on a water heater or on other appliances.
  - Do not fill containers inside a vehicle or on a truck or trailer bed with a plastic liner. Always place containers on the ground and away from your vehicle before filling.
  - Remove the equipment from the truck or trailer and refuel it while it is on the ground. If this is not possible, then refuel from a portable container rather than from a fuel-dispenser nozzle.
  - Do not operate the machine without the entire exhaust system in place and in proper working condition.
  - Keep the fuel-dispenser nozzle in contact with the rim of the fuel tank or container opening at all times until fueling is complete. Do not use a nozzle lock-open device.
  - If you spill fuel on your clothing, change your clothing immediately.
  - Do not overfill the fuel tank. Replace the fuel cap and tighten it securely.
  - Clean grass and debris from the cutting unit, muffler, drives, grass catcher, and engine compartment to help prevent fires. Clean up oil or fuel spills.

# Adding Fuel

## Recommended Fuel

- For best results, use only clean, fresh (less than 30 days old), unleaded gasoline with an octane rating of 87 or higher ((R+M)/2 rating method).
- **Ethanol:** Gasoline with up to 10% ethanol (gasohol) or 15% MTBE (methyl tertiary butyl ether) by volume is acceptable. Ethanol and MTBE are not the same. Gasoline with 15% ethanol (E15) by volume is not approved for use. **Never use gasoline that contains more than 10% ethanol by volume**, such as E15 (contains 15% ethanol), E20 (contains 20% ethanol), or E85 (contains up to 85% ethanol). Using unapproved gasoline may cause performance problems and/or engine damage which may not be covered under warranty.
- **Do not** use gasoline containing methanol.
- **Do not** store fuel either in the fuel tank or fuel containers over the winter unless you use a fuel stabilizer.
- **Do not** add oil to gasoline.

## Using Stabilizer/Conditioner

Use a fuel stabilizer/conditioner in the machine to provide the following benefits:

- Keeps fuel fresh longer when used as directed by the fuel-stabilizer manufacturer
- Cleans the engine while it runs
- Eliminates gum-like varnish buildup in the fuel system, which causes hard starting

**Important:** Do not use fuel additives containing methanol or ethanol.

Add the correct amount of fuel stabilizer/conditioner to the fuel.

**Note:** A fuel stabilizer/conditioner is most effective when mixed with fresh fuel. To minimize the chance of varnish deposits in the fuel system, use fuel stabilizer at all times.

## Filling the Fuel Tank

1. Park the machine on a level surface.
2. Engage the parking brake.
3. Shut off the engine and remove the key.
4. Clean around the fuel-tank cap.
5. Fill the fuel tank to the bottom of the filler neck (Figure 7).

**Note:** Do not fill the fuel tank completely full. The empty space in the tank allows the fuel to expand.

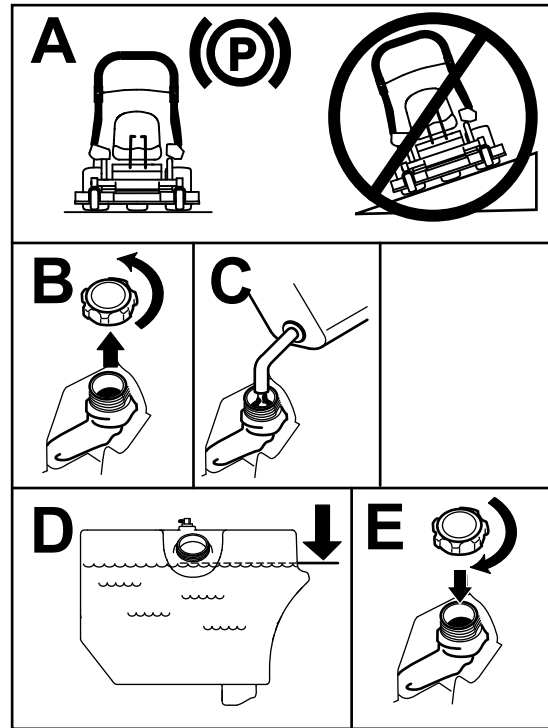

Figure 7

g233737

## Performing Daily Maintenance

Before starting the machine each day, perform the Each Use/Daily procedures listed in [Maintenance \(page 29\)](#).

## Breaking in a New Machine

New engines take time to develop full power. Mower decks and drive systems have higher friction when new, placing additional load on the engine. Allow 40 to 50 hours of break-in time for new machines to develop full power and best performance.

# Raising the Mower Deck into the Service Position

1. Park the machine on a level surface, disengage the PTO, and engage the parking brake.
2. Shut off the engine, remove the key, and wait for all moving parts to stop before leaving the operating position.
3. Release the mower deck locking pins on each side (Figure 8).

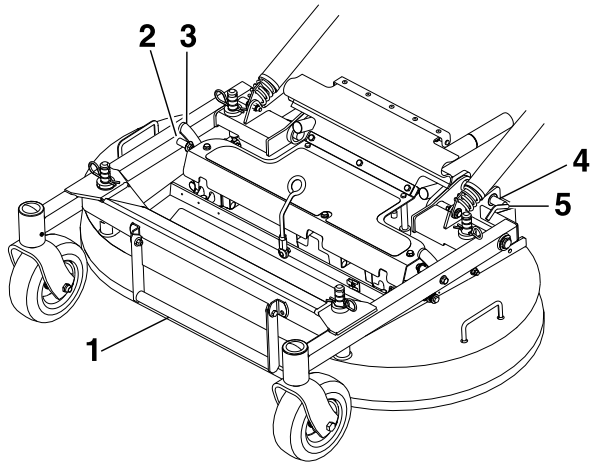
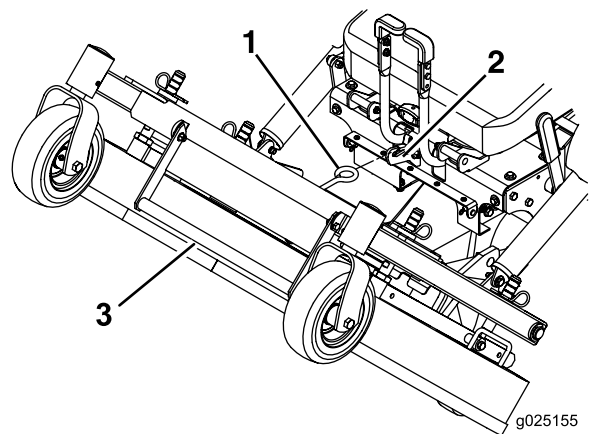

Figure 8

g304824

1. Deck-lift handle
2. Pin
3. Deck-support latch
4. Using the deck-lift handle, lift the deck and latch it in the raised position (latch is located at front center of seat) as shown in Figure 9.
4. Rotate the deck-locking pin toward the rear and pull it outward to unlock.
5. Push the deck-locking pin in and rotate it toward the front to lock.



g025155

g025155

Figure 9

1. Secure the mower deck in the raised position by securing the mower deck latch onto the hook.
2. Hook
3. Deck-lift handle

## **⚠ WARNING**

Engaging the PTO with a deck in the raised position can result in a serious injury or property damage.

**Always lower and lock the mower deck in the operation position before engaging the PTO.**

# Lowering the Mower Deck to the Operating Position

1. While firmly holding onto deck-lift handle, unhook the mower-deck latch from the machine and slowly lower the mower deck to the ground (Figure 9).
2. Push the deck-locking pins inward and rotate them forward to securely lock the mower deck in the lowered position (Figure 8).

## **⚠ WARNING**

Operating the machine without the locking pins securely latched can result in the mower deck folding up unexpectedly, causing serious injury.

**Always operate the machine with the locking pins securely latched.**



# Adjusting the Fill Reduction System (FRS) Baffles

The fill reduction system has been designed to allow you to reduce the amount of clippings collected by varying degrees. The advantages include less frequent emptying of the hopper and the return of nutrients to the soil.

The following are possible configurations:

- Baffles open with standard blades—maximum collection
- Baffles closed with standard blades—partial mulching
- Baffles closed with mulch blades—intermediate mulching
- Mulch plug installed with mulch blades—complete mulching (requires mulch kit)

Adjust the FRS baffles as follows:

1. Park the machine on a level surface, disengage the PTO, and engage the parking brake.
2. Shut off the engine, remove the key, and wait for all moving parts to stop before leaving the operating position.
3. Loosen the bolts attached to the rubber guard ([Figure 10](#)).
4. Fold the guard forward.

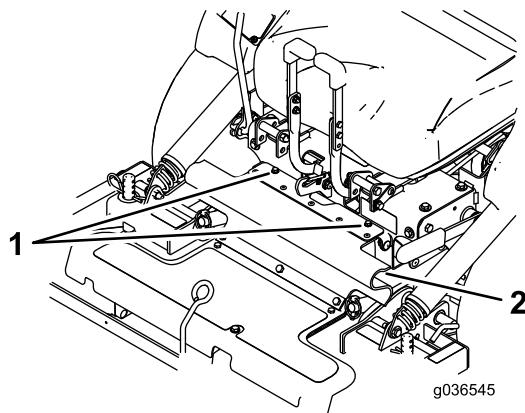

**Figure 10**

1. Bolts
2. Rubber guard

5. Loosen the locknuts on the rear studs of the FRS baffles.

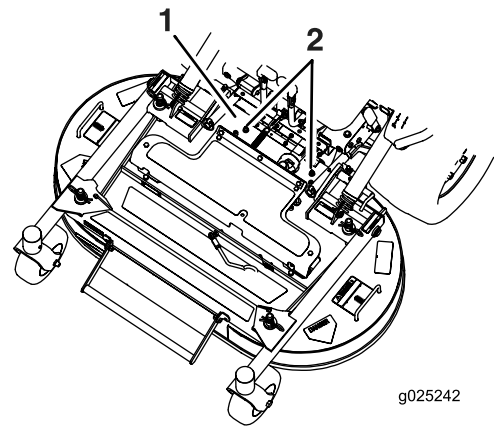

**Figure 11**

1. PTO guard removed for clarity
2. Loosen the locknuts.

6. Raise the mower deck; refer to [Raising the Mower Deck into the Service Position \(page 16\)](#).
7. Remove the bolt and washer at the front of each FRS baffle ([Figure 12](#)).
8. Rotate the baffles into the desired position and install the bolt and washer.

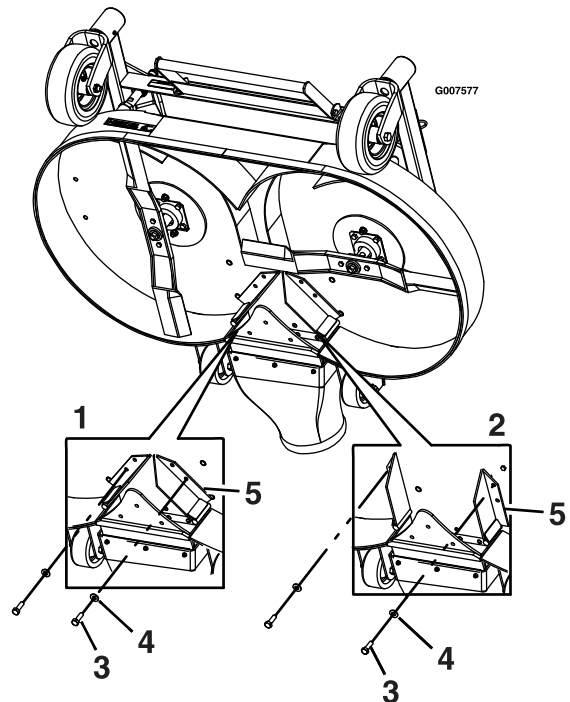

**Figure 12**

1. Baffles—closed position
2. Baffles—open position
3. Bolt
4. Washer
5. Baffles

9. Lower the mower deck; refer to [Lowering the Mower Deck to the Operating Position \(page 16\)](#).

10. Slightly tighten the locknuts on the rear studs of the FRS baffles.
- Note:** The locknuts on the rear studs may be left slightly loose if you anticipate adjusting the baffle frequently.
11. Install the rubber guard using the attached bolts.

## Using the Safety-Interlock System

### **⚠ WARNING**

If the safety-interlock switches are disconnected or damaged, the machine could operate unexpectedly, causing personal injury.

- Do not tamper with the interlock switches.
- Check the operation of the interlock switches daily and replace any damaged switches before operating the machine.

## Understanding the Safety-Interlock System

The safety-interlock system is designed to prevent the engine from starting unless:

- The parking brake is engaged.
- The PTO-engagement lever is disengaged.
- The speed-control lever is in the NEUTRAL position

The safety-interlock system is designed to shut off the engine when you rise from the seat when the PTO is engaged.

The hour meter has indicators to notify the user when the interlock component is in the correct position. When the component is in the correct position, an indicator displays on the screen.

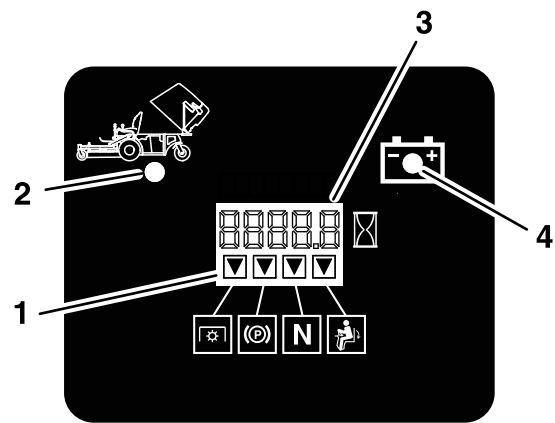

g020563

g020563

**Figure 13**

1. Indicators display when the interlock components are in the correct position
2. Hopper up
3. Hour/Voltage display
4. Low-voltage indicator light

## Testing the Safety-Interlock System

**Service Interval:** Before each use or daily

Test the safety-interlock system before you use the machine each time. If the safety system does not operate as described below, have an Authorized Service Dealer repair the safety system immediately.

1. Sit on the seat, engage the parking brake, move the PTO-engagement lever to the ON position, and move the speed-control lever to the NEUTRAL position. Try starting the engine; the engine should not start.
2. Sit on the seat, engage the parking brake, and move the PTO-engagement lever to the OFF position. Move the speed-control lever out of the NEUTRAL position. Try starting the engine; the engine should not start.
3. Sit on the seat, disengage the parking brake, move the PTO-engagement lever to the OFF position, and move the speed-control lever to the NEUTRAL position. Try starting the engine; the engine should not start.
4. Sit on the seat, engage the parking brake, move the PTO-engagement lever to the OFF position, and move the speed-control lever to the NEUTRAL position. Now start the engine. While the engine is running, release the parking brake, engage the PTO-engagement lever, and rise slightly from the seat; the engine should shut off.
5. Sit on the seat, engage the parking brake, move the PTO-engagement lever to the OFF position, and move the speed-control lever to the NEUTRAL position. Now start the engine.

Move the speed-control lever forward; the engine should shut off.

## Unlatching the Seat

To unlatch the seat, remove the bolt and the pin on the left side of the seat (Figure 14).

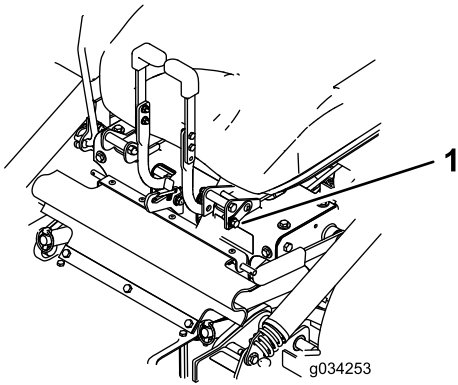

Figure 14

1. Bolt and pin

## During Operation

### During Operation Safety

#### General Safety

- The owner/operator can prevent and is responsible for accidents that may cause personal injury or property damage.
- Use your full attention while operating the machine. Do not engage in any activity that causes distractions; otherwise, injury or property damage may occur.
- Do not operate the machine while ill, tired, or under the influence of alcohol or drugs.
- Contacting the blade can result in serious personal injury. Shut off the engine, remove the key, and wait for all moving parts to stop before leaving the operating position. When you turn the key to the OFF position, the engine should shut off and the blade should stop. If not, stop using your machine immediately and contact an Authorized Service Dealer.
- Operate the machine only in good visibility and appropriate weather conditions. Do not operate the machine when there is the risk of lightning.
- Keep your hands and feet away from the cutting units. Keep clear of the discharge opening.
- Do not mow with the discharge door raised, removed, or altered unless there is a grass-collection system or mulch kit in place and working properly.
- Do not mow in reverse unless it is absolutely necessary. Always look down and behind you before moving the machine in reverse.
- Use extreme care when approaching blind corners, shrubs, trees, or other objects that may block your view.
- Stop the blades whenever you are not mowing.
- If the machine strikes an object or starts to vibrate, immediately shut off the engine, remove the key (if equipped), and wait for all moving parts to stop before examining the machine for damage. Make all necessary repairs before resuming operation.
- Slow down and use caution when making turns and crossing roads and sidewalks with the machine. Always yield the right-of-way.
- Before you leave the operating position, do the following:
  - Park the machine on a level surface.
  - Disengage the power takeoff and lower the attachments.
  - Engage the parking brake.
  - Shut off the engine and remove the key.
  - Wait for all moving parts to stop.
- Operate the engine only in well-ventilated areas. Exhaust gases contain carbon monoxide, which is lethal if inhaled.
- Never leave a running machine unattended.
- Attach towed equipment to the machine only at the hitch point.
- Do not operate the machine unless all guards and safety devices, such as the deflectors and the entire grass catcher, are in place and functioning properly. Replace worn or deteriorated parts when necessary. Do not operate the machine unless all guards and safety devices, such as the deflectors and the entire grass catcher, are in place and functioning properly. Replace worn or deteriorated parts when necessary.
- Use only accessories and attachments approved by Toro.
- This machine produces sound levels in excess of 85 dBA at the operator's ear and can cause hearing loss through extended periods of exposure.

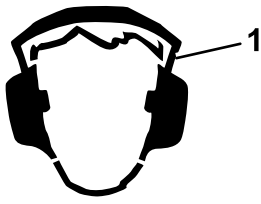

**Figure 15**

g229846

1. Wear hearing protection.

- 
- Clean grass and debris from the cutting unit, drives, muffler, and engine to help prevent fires.
  - Start the engine with your feet well away from the blades.
  - Never raise the mower deck while the blades are moving.
  - Be aware of the mower discharge path and direct the discharge away from others. Avoid discharging material against a wall or obstruction because the material may ricochet back toward you.
  - Stop the blades, slow down the machine, and use caution when crossing surfaces other than grass or when transporting the machine to and from the operating area.
  - Do not change the engine governor speed or overspeed the engine.
  - Children are often attracted to the machine and the mowing activity. Never assume that children will remain where you last saw them.
  - Keep children out of the operating area and under the watchful care of a responsible adult other than the operator.
  - Be alert and shut off the machine if children enter the operating area.
  - Before backing up or turning the machine, look down and all around for small children.
  - Do not carry children on the machine, even when the blades are not moving. Children could fall off and be seriously injured or prevent you from safely operating the machine. Children who have been given rides in the past could appear in the operating area without warning and be run over or backed over by the machine.

## Rollover Protection System (ROPS) Safety

- The ROPS is an integral safety device. Do not remove any of the ROPS components from the machine.
- Ensure that the seat belt is attached and that you can release it quickly in an emergency.
- Keep the roll bar in the fully raised and locked position and always wear your seat belt whenever the roll bar is up.

- Check carefully for overhead objects before you drive under them, and do not contact them.
- Replace damaged ROPS components. Do not repair or alter them.
- There is no rollover protection when the roll bar is down.
- Wheels dropping over edges, over steep banks, or into water can cause a rollover, which may result in serious injury or death.
- Do not wear the seat belt when the roll bar is down.
- Lower the roll bar only when absolutely necessary; raise it as soon as clearance permits.
- In the event of a rollover, take the machine to an Authorized Service Dealer to inspect the ROPS.
- Use only Toro approved accessories and attachments for the ROPS.

## Slope Safety

- Slopes are a major factor related to loss of control and rollover accidents, which can result in severe injury or death. The operator is responsible for safe slope operation. Operating the machine on any slope requires extra caution. Before using the machine on a slope, do the following:
  - Review and understand the slope instructions in the manual and on the machine.
  - Use an angle indicator to determine the approximate slope angle of the area.
  - Never operate on slopes greater than 15°.
  - Evaluate the site conditions of the day to determine if the slope is safe for machine operation. Use common sense and good judgment when performing this evaluation. Changes in the terrain, such as moisture, can quickly affect the operation of the machine on a slope.
- Identify hazards at the base of the slope. Do not operate the machine near drop-offs, ditches, embankments, water, or other hazards. The machine could suddenly roll over if a wheel goes over the edge or the edge collapses. Keep a safe distance (twice the width of the machine) between the machine and any hazard. Use a walk-behind machine or a hand trimmer to mow the grass in these areas.
- Avoid starting, stopping, or turning the machine on slopes. Avoid making sudden changes in speed or direction; turn slowly and gradually.
- Do not operate a machine under any conditions where traction, steering, or stability is in question. Be aware that operating the machine on wet grass, across slopes, or downhill may cause the machine to lose traction. Loss of traction to the drive wheels may result in sliding and a loss of

braking and steering. The machine can slide even if the drive wheels are stopped.

- Remove or mark obstacles such as ditches, holes, ruts, bumps, rocks, or other hidden hazards. Tall grass can hide obstacles. Uneven terrain could overturn the machine.
- Use extra care while operating with accessories or attachments, such as grass-collection systems. These can change the stability of the machine and cause a loss of control. Follow directions for counterweights.
- If possible, keep the deck lowered to the ground while operating on slopes. Raising the deck while operating on slopes can cause the machine to become unstable.

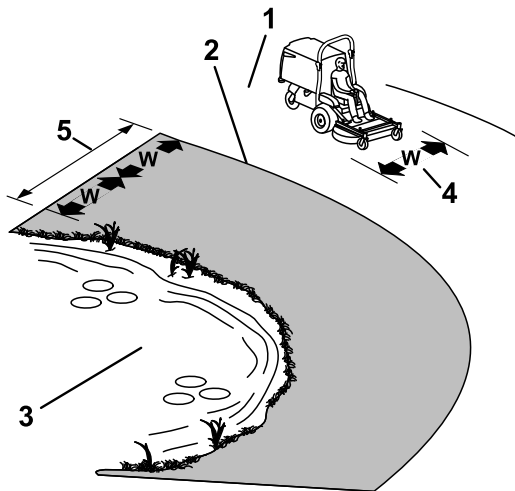

Figure 16

g233738

1. Safe Zone—use the machine here on slopes less than 15° or flat areas.
2. Danger Zone—use a walk-behind mower and/or a hand trimmer on slopes greater than 15° and near drop-offs or water.
3. Water
4. W = Width of the machine
5. Keep a safe distance (twice the width of the machine) between the machine and any hazard.

## Operating the Parking Brake

Always engage the parking brake when you stop the machine or leave it unattended.

### Engaging the Parking Brake

Park the machine on a level surface.

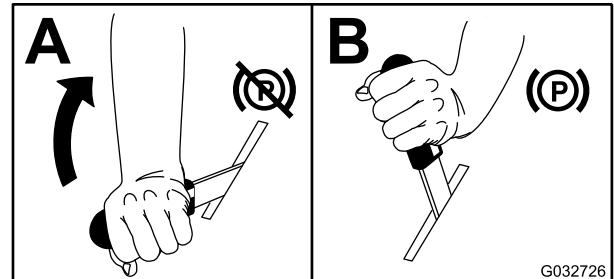

G032726

g032726

Figure 17

### Disengaging the Parking Brake

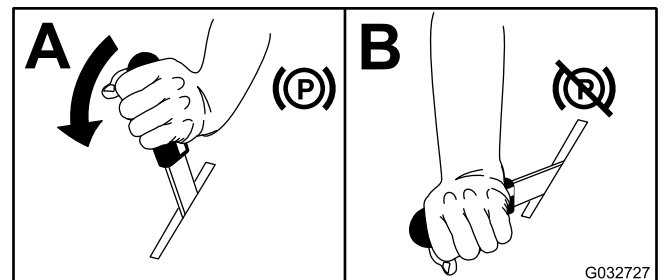

G032727

g032727

Figure 18

# Operating the PTO-Engagement Lever

The PTO-engagement lever starts and stops the mower blades and blower.

## Engaging the PTO-Engagement Lever

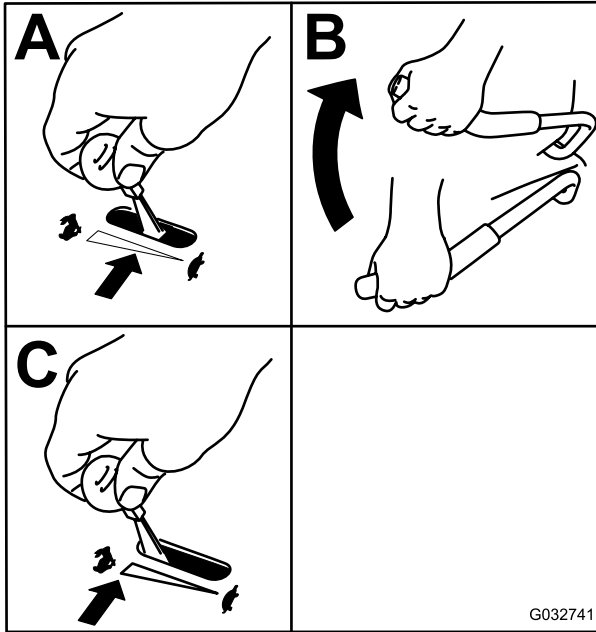

Figure 19

## Disengaging the PTO-Engagement Lever

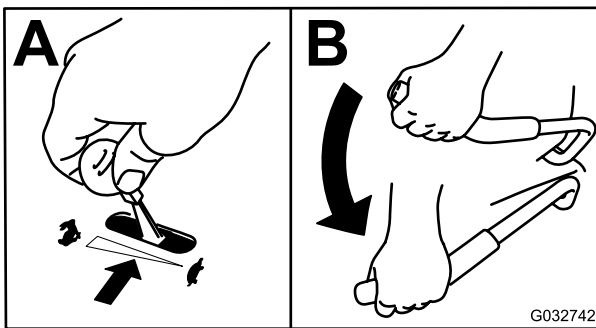

Figure 20

# Operating the Throttle

You can move the throttle control between FAST and SLOW positions (Figure 21).

Always use the FAST position when engaging the PTO.

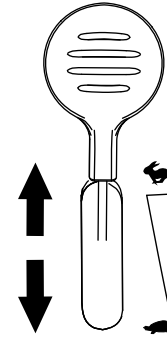

Figure 21

# Operating the Choke

Use the choke to start a cold engine.

1. Pull up the choke knob to engage the choke before using the key switch (Figure 22).
2. Push down the choke knob to disengage the choke after the engine has started (Figure 22).

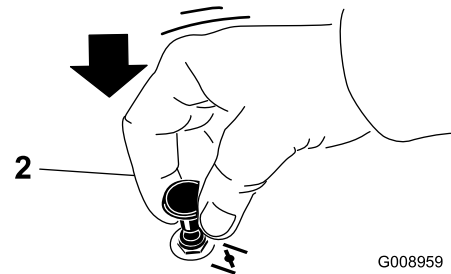
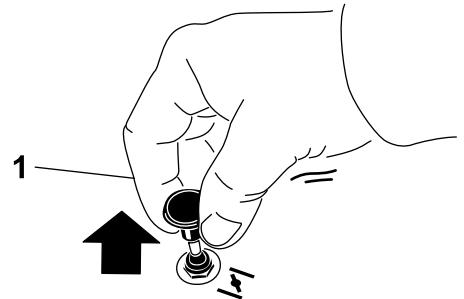

Figure 22

1. ON position

2. OFF position

# Starting the Engine

1. Move the speed-control lever to the NEUTRAL position.

- Engage the parking brake; refer to [Engaging the Parking Brake \(page 21\)](#).
- Move the PTO-engagement lever to the OFF position ([Figure 23](#)).
- Move the throttle lever midway between the SLOW and FAST positions.
- For EFI machines: Move the choke control to the CLOSED/ON position. On a warm engine, leave the choke in the OPEN/OFF position.

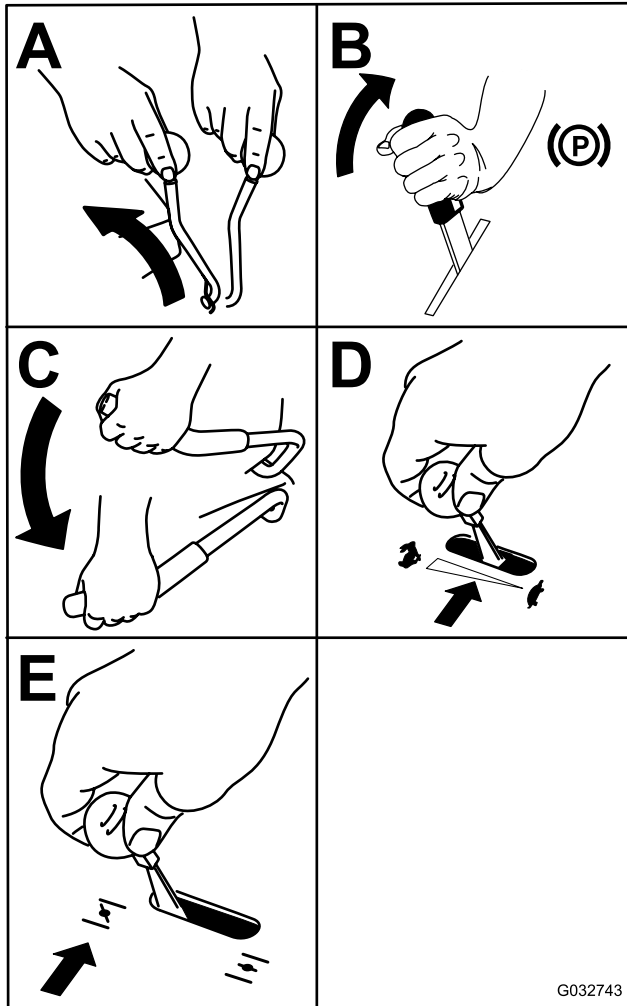

Figure 23

- Turn the key to the START position ([Figure 23](#)). When the engine starts, release the key.

**Important:** Do not engage starter for more than 5 seconds at a time. If the engine fails to start, wait 15 seconds between attempts. Failure to follow these instructions can burn out the starter motor.

**Note:** You may need multiple attempts to start the engine the first time after adding fuel to an empty fuel system.

- If the choke is in the CLOSED/ON position, gradually return choke to the OPEN/OFF position as the engine warms up.

## Shutting Off the Engine

### ⚠ CAUTION

Children or bystanders may be injured if they move or attempt to operate the machine while it is unattended.

Always remove the key and engage the parking brake when leaving the machine unattended.

- Disengage the PTO.
- Move the speed-control lever to the NEUTRAL position.
- Engage the parking brake.
- Place the throttle in the middle position.
- Let the engine idle for 15 seconds, then turn the key switch to the OFF position and remove the key.

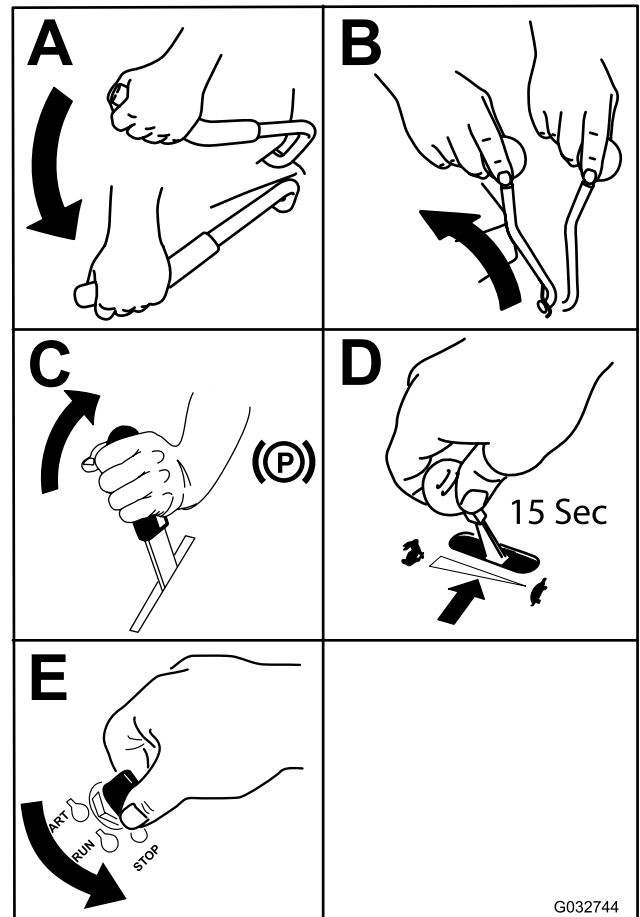

Figure 24

# Driving the Machine

The throttle control regulates the engine speed as measured in rpm (revolutions per minute). Place the throttle control in the FAST position for best performance. Always operate in the full throttle position when mowing.

## ⚠ WARNING

**The machine can spin very rapidly. You may lose control of the machine and cause personal injury or damage to the machine.**

- Use caution when making turns.
- Slow the machine down before making sharp turns.

## Driving Forward

**Note:** To begin movement (forward or backward), sit on the seat and disengage the parking-brake lever before you move the speed-control lever forward, otherwise the engine shuts off.

To stop the machine, pull the speed control lever to the NEUTRAL position.

1. Start the engine.
2. Disengage the parking brake; refer to [Disengaging the Parking Brake \(page 21\)](#).
3. To move forward in a straight line move the speed control lever forward.

**Note:** The machine moves faster the farther that you move the speed control lever away from the NEUTRAL position.

4. To turn left or right, pull 1 of the steering levers back toward neutral in the direction desired.
5. To stop the machine, pull the speed control lever back to the NEUTRAL position.

## Driving Backward

1. To move rearward in a straight line, pull both steering levers rearward equally.  
To turn left or right, release pressure on the steering lever toward the direction desired.
2. To stop the machine, release the steering levers to the neutral position.

# Adjusting the Height of Cut

The cutting height of the mower deck is adjusted from 2.5 to 10.2 cm (1 to 4 inches) in 6.3 mm (1/4 inch) increments.

1. Park the machine on a level surface, move the speed-control lever to the NEUTRAL position, disengage the PTO, and engage the parking brake.
2. Shut off the engine, remove the key, and wait for all moving parts to stop before leaving the operating position.
3. While keeping the front frame down, lift the deck on 1 side so that the deck-support latch engages the fixed pin in the front frame ([Figure 25](#)).

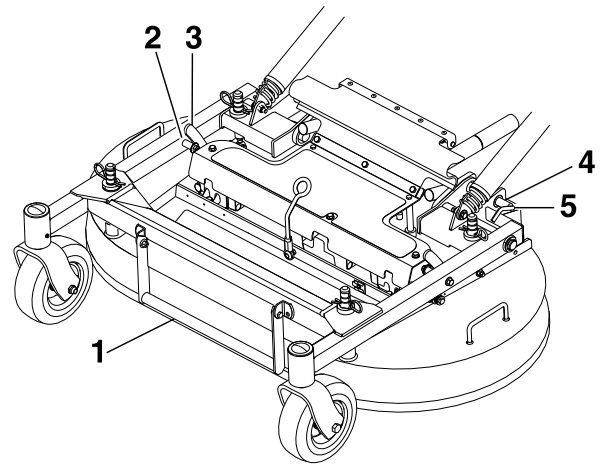

**Figure 25**

g304824

1. Deck-lift handle
  2. Pin
  3. Deck-support latch
  4. Rotate the deck-locking pin toward the rear and pull it outward to unlock.
  5. Push the deck-locking pin in and rotate it toward the front to lock.
- 
4. Move the cotter pins on the deck-support pins to the proper hole for the desired height of cut.
  5. Lift the deck enough to raise and release the deck-support latch and lower the deck.
  6. Repeat this procedure on the other side of the mower deck.



## Emptying the Hopper

A full hopper is indicated by a buzzer located behind the seat, in the hopper. Empty the hopper when the buzzer sounds to prevent clogging of the blower or the mower deck.

1. Park the machine on a level surface, move the speed-control lever to the NEUTRAL position, disengage the PTO, and engage the parking brake.
2. Shut off the engine, remove the key, and wait for all moving parts to stop before leaving the operating position.
3. Lift the rear door up and allow it to rest on top of the hopper.
4. Using the handles at the lower front of the hopper, raise the hopper to dump the contents.
5. Lower the hopper and close the hopper door.

## Operating Tips

### Using the Fast Throttle Setting

For best mowing and maximum air circulation, operate the engine at the FAST position. Air is required to thoroughly cut grass clippings, so do not set the height-of-cut so low as to totally surround the mower deck in uncut grass. Always try to have 1 side of the mower deck free from uncut grass, which allows air to be drawn into the mower deck.

### Cutting a Lawn for the First Time

Cut grass slightly longer than normal to ensure that the cutting height of the mower deck does not scalp any uneven ground. However, the cutting height used in the past is generally the best one to use. When cutting grass longer than 15 cm (6 inches) tall, you may want to cut the lawn twice to ensure an acceptable quality of cut.

### Cutting a Third of the Grass Blade

It is best to cut only about a third of the grass blade. Cutting more than that is not recommended unless grass is sparse, or it is late fall when grass grows more slowly.

### Alternating the Mowing Direction

Alternate the mowing direction to keep the grass standing straight. This also helps disperse clippings, which enhances decomposition and fertilization.

## Mowing at Correct Intervals

Grass grows at different rates at different times of the year. To maintain the same cutting height, mow more often in early spring. As the grass growth rate slows in mid summer, mow less frequently. If you cannot mow for an extended period, first mow at a high cutting height, then mow again 2 days later at a lower height setting.

## Using a Slower Cutting Speed

To improve cut quality, use a slower ground speed in certain conditions.

## Avoiding Cutting Too Low

When mowing uneven turf, raise the cutting height to avoid scalping the turf.

## Stopping the Machine

If you must stop the forward motion of the machine while mowing, a clump of grass clippings may drop onto your lawn. To avoid this, move onto a previously cut area with the blades engaged or you can disengage the mower deck while moving forward.

## Keeping the Underside of the Mower Deck Clean

Clean clippings and dirt from the underside of the mower deck after each use. If grass and dirt build up inside the mower deck, cutting quality will eventually become unsatisfactory.

## Maintaining the Blade(s)

Maintain a sharp blade throughout the cutting season because a sharp blade cuts cleanly without tearing or shredding the grass blades. Tearing and shredding turns grass brown at the edges, which slows growth and increases the chance of disease. Check the mower blades after each use for sharpness, and for any wear or damage. File down any nicks and sharpen the blades as necessary. If a blade is damaged or worn, replace it immediately with a genuine Toro replacement blade.

# After Operation

## After Operation Safety

### General Safety

- Shut off the engine, remove the key, and wait for all moving parts to stop before leaving the operator's position. Allow the machine to cool before servicing, adjusting, fueling, cleaning, or storing it.
- Clean grass and debris from the cutting unit, muffler, drives, grass catcher, and engine compartment to help prevent fires. Clean up oil or fuel spills.
- Shut off the fuel and remove the key before storing or transporting the machine.

## Clearing the Hopper Screen

Remove the screen by firmly lifting the screen handles (Figure 26).

Pull the screen toward the back to remove it. As needed, gently tap the screen to remove debris.

**Note:** Excessive buildup on the screen can cause the blower to plug.

**Note:** In conditions where the screen clogs quickly, you can turn and install the front removable screen panel under the primary screen to allow free air flow from the hopper.

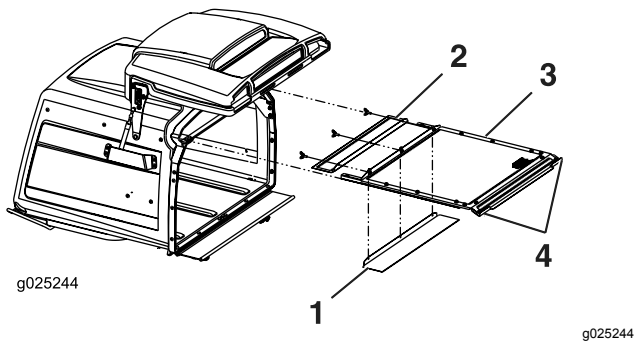

Figure 26

- |   |                   |
|---|-------------------|
| 1. Front removable screen can be rotated and stored for wet conditions. | 3. Primary screen |
| 2. Front removable screen   | 4. Handles        |

## Using the Drive-Wheel Release Valves

### ⚠ WARNING

Hands may become entangled in the rotating drive components below the engine deck, which could result in serious injury.

**Shut off the engine, remove the key, and allow all moving parts to stop before accessing the drive-wheel-release valves.**

### ⚠ WARNING

The engine and hydraulic-drive units can become very hot. Touching a hot engine or hydraulic-drive units can cause severe burns.

**Allow the engine and hydraulic-drive units to cool completely before accessing the drive-wheel-release valves.**

The drive-wheel release valves are located on the top, left, front corner of the hydrostatic pumps.

1. Move the speed-control lever to the NEUTRAL position to stop the machine.
2. Disengage the PTO lever, engage the parking brake, shut off the engine, and wait for all moving parts to stop.
3. Tilt the seat up to gain access to the pumps.
4. Rotate both release valves 1 turn counterclockwise to release the drive system.

**Note:** This allows the hydraulic fluid to bypass the pump, enabling the wheels to turn.

5. Disengage the parking brake before pushing the machine.

**Note:** Do not tow the machine.

6. Rotate the valves clockwise to run the machine.

**Note:** Do not overtighten the valves.

# Transporting the Machine

Use a heavy-duty trailer or truck to transport the machine. Use a full-width ramp. Ensure that the trailer or truck has all the necessary brakes, lighting, and marking as required by law. Please carefully read all the safety instructions. Knowing this information could help you or bystanders avoid injury. Refer to your local ordinances for trailer and tie-down requirements.

## ⚠ WARNING

Driving on the street or roadway without turn signals, lights, reflective markings, or a slow-moving-vehicle emblem is dangerous and can lead to accidents, causing personal injury.

Do not drive the machine on a public street or roadway.

## Selecting a Trailer

## ⚠ WARNING

Loading a machine onto a trailer or truck increases the possibility of tip-over and could cause serious injury or death (Figure 27).

- Use only a full-width ramp; do not use individual ramps for each side of the machine.
- Do not exceed a 15-degree angle between the ramp and the ground or between the ramp and the trailer or truck.
- Ensure that the length of the ramp is at least 4 times as long as the height of the trailer or truck bed to the ground. This ensures that the ramp angle does not exceed 15 degrees on flat ground.

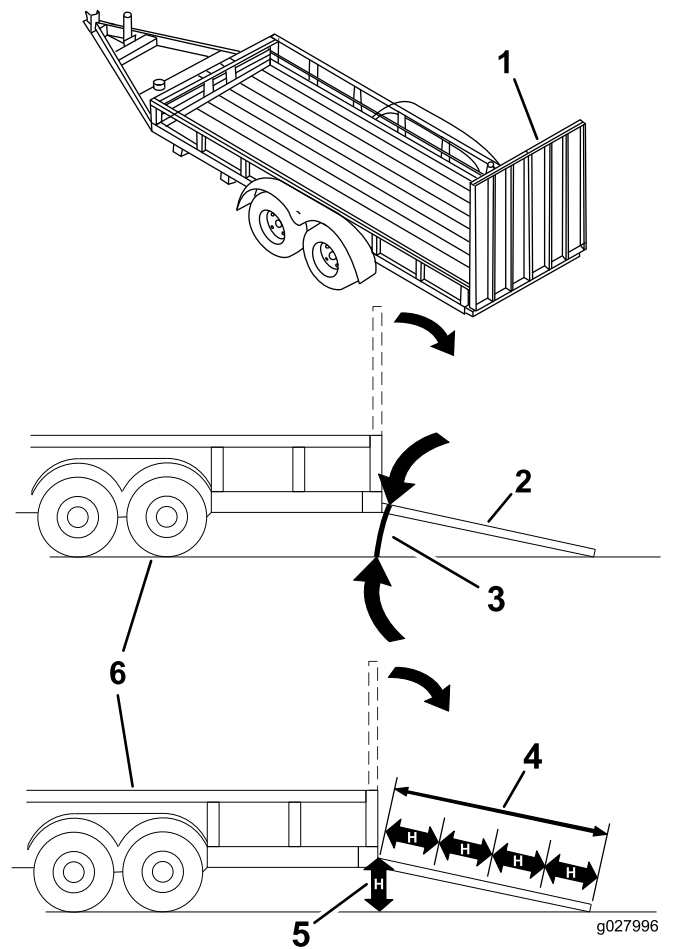

Figure 27

1. Full-width ramp in stowed position
2. Side view of full-width ramp in loading position
3. Not greater than 15 degrees
4. Ramp is at least 4 times as long as the height of the trailer or truck bed to the ground
5. H=height of the trailer or truck bed to the ground
6. Trailer

## Loading the Machine

### **⚠ WARNING**

Loading a machine onto a trailer or truck increases the possibility of tip-over and could cause serious injury or death.

- Use extreme caution when operating a machine on a ramp.
  - Back the machine up the ramp and drive it forward down the ramp.
  - Avoid sudden acceleration or deceleration while driving the machine on a ramp as this could cause a loss of control or a tip-over situation.
1. If using a trailer, connect it to the towing vehicle and connect the safety chains.
  2. If applicable, connect the trailer brakes and lights.
  3. Lower the ramp, ensuring that the angle between the ramp and the ground does not exceed 15 degrees (Figure 27).
  4. Back the machine up the ramp (Figure 28).

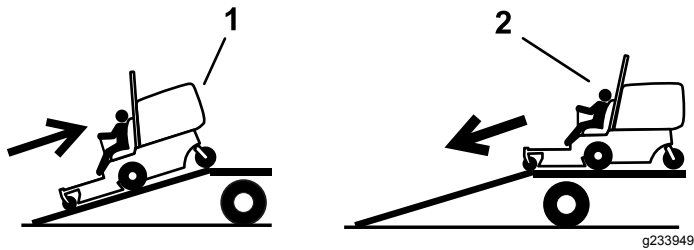

Figure 28

1. Back the machine up the ramp.
  2. Drive the machine forward down the ramp.
- 
5. Shut off the engine, remove the key, and engage the parking brake.
  6. Securely fasten the machine to the trailer or truck with straps, chains, cable, or ropes down and outward from the machine. Refer to local regulations for tie-down requirements.

## Unloading the Machine

1. Lower the ramp, ensuring that the angle between the ramp and the ground does not exceed 15 degrees (Figure 27).
2. Drive the machine forward down the ramp (Figure 28).

# Maintenance

## Maintenance Safety

- If you leave the key in the switch, someone could accidentally start the engine and seriously injure you or other bystanders. Remove the key from the switch before you perform any maintenance.
- Before you leave the operator's position, do the following:
  - Park the machine on a level surface.
  - Disengage the drives.
  - Engage the parking brake.
  - Shut off the engine and remove the key.
  - Allow machine components to cool before performing maintenance.
- Do not allow untrained personnel to service the machine.
- Keep your hands and feet away from moving parts or hot surfaces. If possible, do not make adjustments with the engine running.
- Carefully release pressure from components with stored energy.
- Check the parking brake operation frequently. Adjust and service it as required.
- Never tamper with safety devices. Check their proper operation regularly.
- Clean grass and debris from the cutting unit, muffler, drives, grass catcher, and engine compartment to prevent fires.
- Clean up oil or fuel spills and remove fuel-soaked debris.
- Do not rely on hydraulic or mechanical jacks to support the machine; support the machine with jack stands whenever you raise the machine.
- Keep all parts in good working condition and all hardware tightened, especially the blade-attachment hardware. Replace all worn or damaged decals.
- Disconnect the battery before repairing the machine. Disconnect the negative terminal first and the positive last. Connect the positive terminal first and the negative last.
- To ensure optimum performance, use only genuine Toro replacement parts and accessories. Replacement parts and accessories made by other manufacturers could be dangerous, and such use could void the product warranty.

## Recommended Maintenance Schedule(s)

| Maintenance Service Interval | Maintenance Procedure   |
|------------------------------|---|
| After the first 50 hours     | <ul style="list-style-type: none"> <li>• Change the oil in all 3 gearbox housings and add oil as needed.</li> </ul>   |
| After the first 100 hours    | <ul style="list-style-type: none"> <li>• Check the wheel lug-nut torque.</li> <li>• Check the wheel-hub nut torque.</li> <li>• Check the parking-brake adjustment.</li> <li>• Change the hydraulic filter and reservoir hydraulic fluid when using any type of fluid.</li> </ul>  |
| Before each use or daily     | <ul style="list-style-type: none"> <li>• Check the safety-interlock system.</li> <li>• Grease the front caster wheel hubs (more often in dirty or dusty conditions).</li> <li>• Check the air cleaner for dirty, loose or damaged parts.</li> <li>• Check the engine-oil level.</li> <li>• Clean the engine screen and the oil cooler.</li> <li>• Clean the hydraulic pumps.</li> <li>• Inspect the blades.</li> <li>• Clean the mower deck.</li> <li>• Clean debris from the machine.</li> </ul> |
| Every 40 hours               | <ul style="list-style-type: none"> <li>• Grease the drive shaft (more often in dirty or dusty conditions).</li> <li>• Check the tire pressure.</li> <li>• Inspect the belts for cracks and wear.</li> <li>• Check the hydraulic fluid level.</li> </ul>   |
| Every 100 hours              | <ul style="list-style-type: none"> <li>• Grease the mower-deck flip-up pivot (more often in dirty or dusty conditions).</li> <li>• Grease the mower-deck push-arm tubes (more often in dirty or dusty conditions).</li> <li>• Check the oil in all 3 gearbox housings and add oil as needed.</li> <li>• Change the engine oil (more often in dirty or dusty conditions).</li> <li>• Clean the engine-oil cooler.</li> <li>• Check and clean engine cooling fins and shrouds.</li> </ul>           |

| Maintenance Service Interval | Maintenance Procedure  |
|------------------------------|--|
| Every 160 hours              | <ul style="list-style-type: none"> <li>• Lubricate the brake-handle pivot.</li> <li>• Lubricating the brake-rod bushings and steering linkage rod ends.</li> </ul>   |
| Every 200 hours              | <ul style="list-style-type: none"> <li>• Change the engine-oil filter (more often in dirty or dusty conditions).</li> <li>• Check the spark plug(s).</li> <li>• Replace the fuel filter (more often in dirty or dusty conditions).</li> </ul>  |
| Every 250 hours              | <ul style="list-style-type: none"> <li>• Service or replace the air-cleaner foam element (more often under dusty, dirty conditions).</li> <li>• Change the hydraulic filter and reservoir hydraulic fluid when using Mobil® 1 fluid (more often in dirty or dusty conditions).</li> </ul>  |
| Every 400 hours              | <ul style="list-style-type: none"> <li>• Grease the caster pivots (more often in dirty or dusty conditions).</li> </ul>  |
| Every 500 hours              | <ul style="list-style-type: none"> <li>• Replace the air-cleaner paper element (more often under dusty, dirty conditions).</li> <li>• Replace the spark plug(s).</li> <li>• Check the wheel lug-nut torque.</li> <li>• Check the wheel-hub nut torque.</li> <li>• Adjust the caster-pivot bearings.</li> <li>• Check the parking-brake adjustment.</li> <li>• Change the hydraulic filter and reservoir hydraulic fluid when using Toro® HYPR-OIL™ 500 hydraulic fluid (more often in dirty or dusty conditions).</li> </ul> |
| Every 2,000 hours            | <ul style="list-style-type: none"> <li>• Change the oil in all 3 gearbox housings and add oil as needed.</li> </ul>  |
| Monthly                      | <ul style="list-style-type: none"> <li>• Check the battery.</li> </ul>   |
| Yearly                       | <ul style="list-style-type: none"> <li>• Grease the PTO-belt idler arm (more often in dirty or dusty conditions).</li> <li>• Grease the pump-belt idler arm (more often in dirty or dusty conditions).</li> <li>• Repack the caster-wheel bearings (more often in dirty or dusty conditions).</li> <li>• Grease the rear caster wheel hubs (more often in dirty or dusty conditions).</li> </ul>   |
| Yearly or before storage     | <ul style="list-style-type: none"> <li>• Paint chipped surfaces.</li> <li>• Check all maintenance procedures listed above before storage.</li> </ul>   |

**Important:** Refer to your engine owner's manual for additional maintenance procedures.

### **▲ CAUTION**

If you leave the key in the switch, someone could accidentally start the engine and seriously injure you or other bystanders.

Shut off the engine and remove the key from the switch before you perform any maintenance.

# Lubrication

## Greasing the Machine

**Service Interval:** Every 40 hours—Grease the drive shaft (more often in dirty or dusty conditions).

Every 100 hours—Grease the mower-deck flip-up pivot (more often in dirty or dusty conditions).

Every 100 hours—Grease the mower-deck push-arm tubes (more often in dirty or dusty conditions).

Yearly—Grease the PTO-belt idler arm (more often in dirty or dusty conditions).

Grease the machine more often in dirty or dusty conditions.

**Grease Type:** No. 2 lithium or molybdenum grease

1. Park the machine on a level surface, disengage the PTO, and engage the parking brake.
2. Shut off the engine, remove the key, and wait for all moving parts to stop before leaving the operating position.
3. Clean the grease fittings with a rag.  
**Note:** Scrape any paint off the front of the fitting(s).
4. Connect a grease gun to the fitting.
5. Pump grease into the fittings until grease begins to ooze out of the bearings.
6. Wipe up any excess grease.

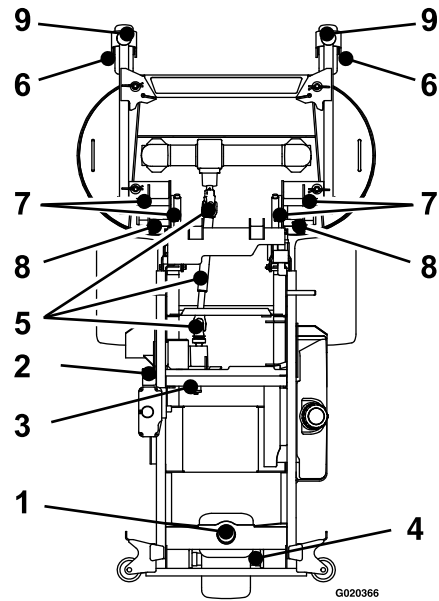

**Figure 29**

- |                        |                           |
|------------------------|---------------------------|
| 1. Rear caster pivot   | 6. Front caster wheel hub |
| 2. PTO-belt idler arm  | 7. Deck flip-up pivot     |
| 3. Pump-belt idler arm | 8. Push-arm tubes         |
| 4. Rear caster hub     | 9. Front caster pivots    |
| 5. Drive shaft         |                           |

## Greasing the Pump-Belt Idler Arm

**Service Interval:** Yearly—Grease the pump-belt idler arm (more often in dirty or dusty conditions).

1. Park the machine on a level surface, disengage the PTO, and engage the parking brake.
2. Raise up the hopper ([Figure 30](#)).

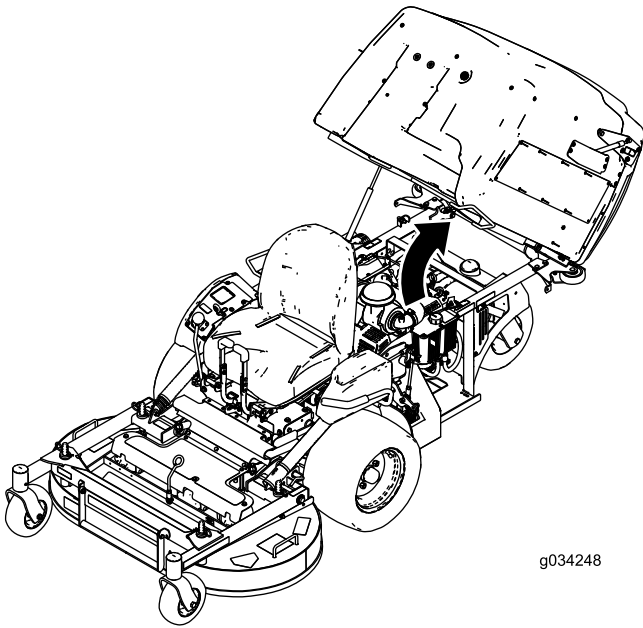

Figure 30

g034248

g034248

3. Shut off the engine, remove the key, and wait for all moving parts to stop before leaving the operating position.
4. Loosen the bolt holding the air cleaner (Figure 31).
5. Loosen the clamp holding the hose and remove the air cleaner (Figure 31).

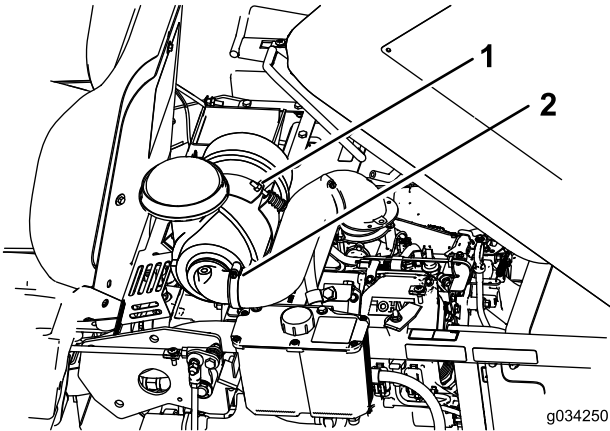

Figure 31

g034250

g034250

1. Bolt
2. Clamp

6. Remove the bolts and the plate below the air cleaner.

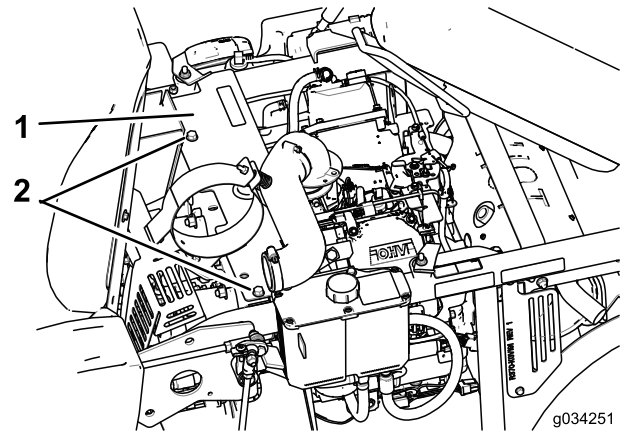

Figure 32

g034251

g034251

1. Plate
2. Bolts

7. Lubricate the pump-belt idler arm (Figure 32).
8. Install the plate and the air cleaner.

## Lubricating the Brake-Handle Pivot

**Service Interval:** Every 160 hours

1. Park the machine on a level surface, disengage the PTO, and engage the parking brake.
2. Shut off the engine, remove the key, and wait for all moving parts to stop before leaving the operating position.
3. Lubricate the bronze bushings on the brake-handle pivot with a spray type lubricant or light oil (Figure 33).

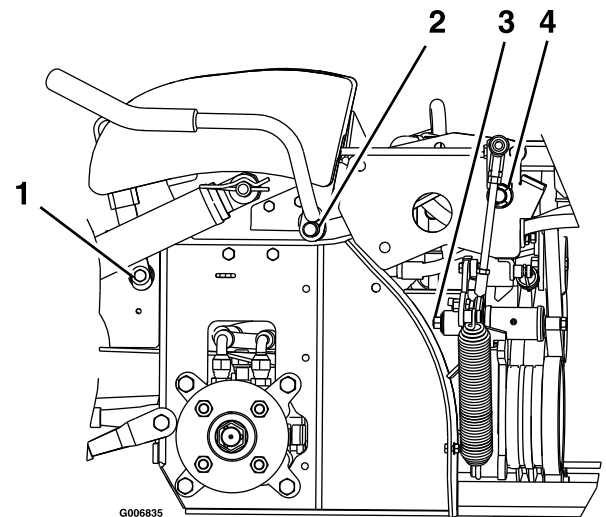

Figure 33

G006835

g006835

Left Side of Machine Shown

1. Brake-handle pivot
2. PTO-handle pivot
3. Spring-arm pivot
4. Toggle pivot



# Lubricating the Brake-Rod Bushings and Steering-Linkage Rod Ends

**Service Interval:** Every 160 hours

1. Park the machine on a level surface, disengage the PTO, and engage the parking brake.
  2. Shut off the engine, remove the key, and wait for all moving parts to stop before leaving the operating position.
  3. Unlatch the seat latch and tilt the seat up; refer to [Unlatching the Seat \(page 19\)](#).
  4. Lubricate the bronze bushings on each end of the brake rod shaft with a spray type lubricant or a light oil.
- Note:** The bushings are located to the inside of the flange bearings.
5. Lubricate each end of both steering linkage rods with a spray lubricant or a light oil.

# Changing the Gearbox Oil

**Service Interval:** After the first 50 hours—Change the oil in all 3 gearbox housings and add oil as needed.

Every 100 hours—Check the oil in all 3 gearbox housings and add oil as needed.

Every 2,000 hours—Change the oil in all 3 gearbox housings and add oil as needed.

1. Park the machine on a level surface, disengage the PTO, and engage the parking brake.
2. Shut off the engine, remove the key, and wait for all moving parts to stop before leaving the operating position.
3. Remove the guard to access the gearbox ([Figure 34](#))

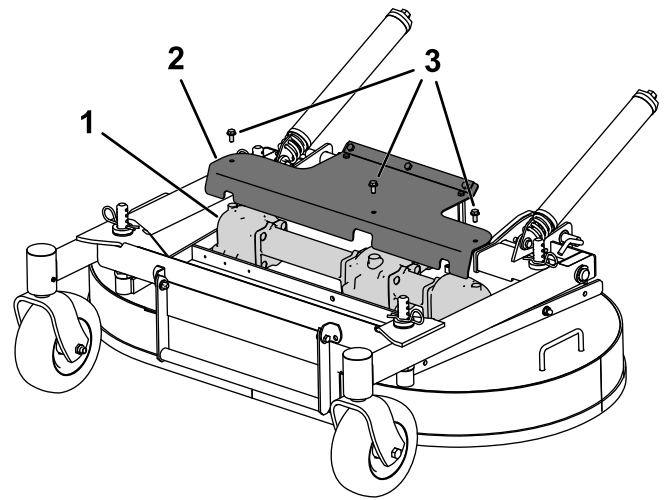
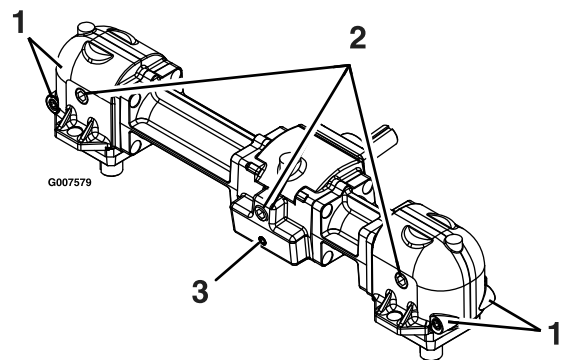

**Figure 34**

g209995

- |            |             |
|------------|-------------|
| 1. Gearbox | 3. Bolt (3) |
| 2. Guard   |             |

4. Remove the blades that are attached to the gearbox; refer to [Removing the Blades \(page 58\)](#).
5. Remove the gearbox and drive-shaft assembly from the mower deck. Retain the hardware for use later.
6. Remove the large oil drain plug on the front of each of the 3 gearbox sections and drain the oil ([Figure 35](#)).



**Figure 35**

g007579

- |  |                                     |
|--|-------------------------------------|
| 1. Small magnetic plugs (front and back) | 3. Small magnetic plug (front only) |
| 2. Large oil drain/fill plug             |                                     |

7. Remove the small magnetic plugs and wipe away any material accumulated on the plugs.
8. Apply a Teflon® pipe sealant to all small magnetic plugs and install them into the gearbox.
9. Install the gearbox and drive-shaft assembly to the mower deck.
10. Fill the gearbox with Mobil® SHC (synthetic) 75W-90 gear lube oil until level with oil drain/fill plug.

**Note:** Each of the gearbox sections must be filled separately.

**Note:** Keep the mower deck level to the ground when filling the gearbox with oil. Do not fill the gearbox with the mower deck raised in the service position.

11. Apply a Teflon pipe sealant to the 3 large oil plugs and install them into the gearbox.

## Greasing the Caster Pivots

**Service Interval:** Every 400 hours/Yearly (whichever comes first) (more often in dirty or dusty conditions).

Yearly—Repack the caster-wheel bearings (more often in dirty or dusty conditions).

1. Park the machine on a level surface, disengage the blade-control switch, and engage the parking brake.
2. Shut off the engine, remove the key, and wait for all moving parts to stop before leaving the operating position.
3. Remove the dust cap and adjust the caster pivots and keep the dust cap off until greasing is done; refer to [Greasing the Caster-Wheel Hubs \(page 35\)](#).
4. Remove the hex plug.
5. Thread a grease fitting into the hole.
6. Pump grease into the fitting until it oozes out around the top bearing.
7. Remove the grease fitting from the hole. Install the hex plug and cap.

# Greasing the Caster-Wheel Hubs

**Service Interval:** Before each use or daily—Grease the front caster wheel hubs (more often in dirty or dusty conditions).

Yearly—Grease the rear caster wheel hubs (more often in dirty or dusty conditions).

1. Park the machine on a level surface, disengage the blade-control switch, and engage the parking brake.
2. Shut off the engine, remove the key, and wait for all moving parts to stop before leaving the operating position.
3. Raise the mower for access.
4. Remove the caster wheel from the caster forks.
5. Remove the seal guards from the wheel hub.

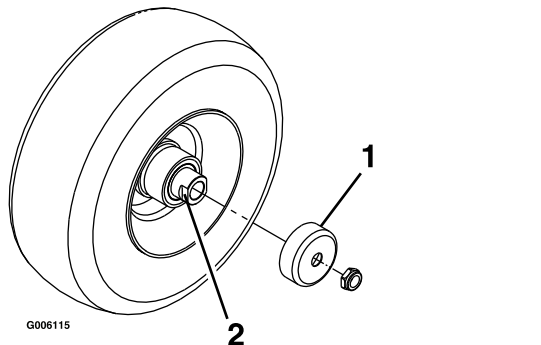

**Figure 36**

1. Seal guard
2. Spacer nut with wrench flats

6. Remove a spacer nut from the axle assembly in the caster wheel.

**Note:** Thread-locking compound has been applied to lock the spacer nuts to the axle.

7. Remove the axle (with the other spacer nut still assembled to it) from the wheel assembly.
8. Pry out seals and inspect bearings for wear or damage and replace if necessary.
9. Pack the bearings with a general-purpose grease.
10. Insert 1 bearing and 1 new seal into the wheel.
11. If the axle assembly is missing both spacer nuts, apply a thread-locking compound to 1 spacer nut and thread it onto the axle with the wrench flats facing outward.

**Note:** Do not thread the spacer nut all of the way onto the end of the axle. Leave approximately 3 mm (1/8 inch) from the outer

surface of the spacer nut to the end of the axle inside the nut.

12. Insert the assembled nut and axle into the wheel on the side with the new seal and bearing.
13. With the open end of the wheel facing up, fill the area inside the wheel around the axle full of general-purpose grease.
14. Insert the second bearing and new seal into the wheel.
15. Apply a thread-locking compound to the second spacer nut, and thread it onto the axle with the wrench flats facing outward.
16. Torque the nut to 8 to 9 N·m (75 to 80 in-lb), loosen the nut, then torque it to 2 to 3 N·m (20 to 25 in-lb).
17. Install the seal guards over the wheel hub, and insert the wheel into the caster fork.
18. Install the caster bolt and tighten the nut fully.

**Note:** Make sure that the axle does not extend beyond either nut.

**Important:** To prevent seal and bearing damage, check the bearing adjustment often. Spin the caster tire. The tire should not spin freely (more than 1 or 2 revolutions) or have any side play. If the wheel spins freely, adjust the torque on the spacer nut until there is a slight amount of drag. Apply another layer of thread-locking compound.

# Engine Maintenance

## Engine Safety

- Keep your hands, feet, face, clothing, and other body parts away from the muffler and other hot surfaces. Allow engine components to cool before performing maintenance.
- Do not change the engine governor speed or overspeed the engine.

## Servicing the Air Cleaner

**Service Interval:** Before each use or daily—Check the air cleaner for dirty, loose or damaged parts.

Every 250 hours—Service or replace the air-cleaner foam element (more often under dusty, dirty conditions).

Every 500 hours—Replace the air-cleaner paper element (more often under dusty, dirty conditions).

**Note:** Service the air cleaner more frequently if operating conditions are extremely dusty or sandy.

## Removing the Filters

1. Park the machine on a level surface, disengage the blade-control switch (PTO), and engage the parking brake.
2. Shut off the engine, remove the key, and wait for all moving parts to stop before leaving the operating position.
3. Release the latches on the air cleaner and pull the air-inlet cover off the air-cleaner body (Figure 37).
4. Clean the air-inlet screen and cover.
5. Install the air-inlet cover and secure it with the latches (Figure 37).

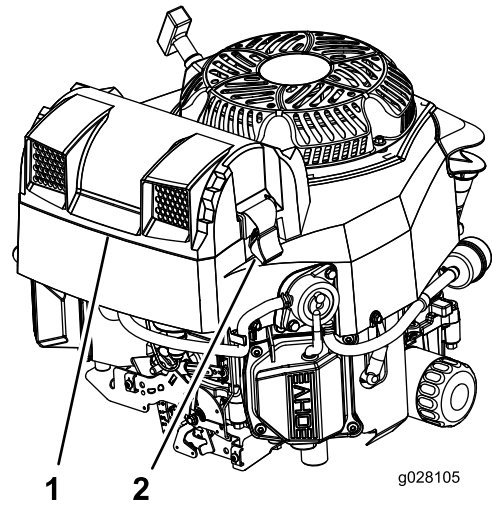

Figure 37

1. Air-inlet screen and cover
2. Latches

6. Release the latches on the air cleaner and pull the air-cleaner cover off the air-cleaner body (Figure 38).
7. Clean the inside of the air-cleaner cover with compressed air.
8. Gently slide the primary filter out of the air-cleaner body (Figure 38).

**Note:** Avoid knocking the filter into the side of the body.

9. Remove the inner filter only if you intend to replace it.

**Important:** Never attempt to clean the inner filter. If the safety filter is dirty, then the primary filter is damaged. Replace both filters.

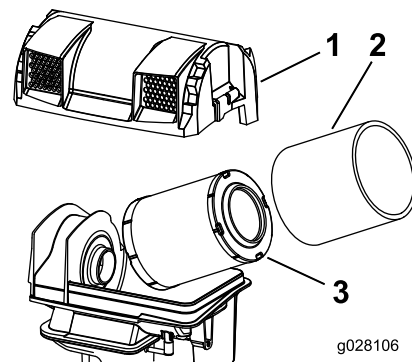

Figure 38

1. Air-cleaner cover
2. Air-cleaner body
3. Primary filter

10. Inspect the primary filter for damage by looking into the filter, while shining a bright light on the outside of the filter.

**Note:** Holes in the filter will appear as bright spots. If the filter is damaged, discard it.

## Servicing the Engine Oil

**Service Interval:** Before each use or daily

Every 100 hours (more often in dirty or dusty conditions).

Every 200 hours—Change the engine-oil filter (more often in dirty or dusty conditions).

## Engine Oil Specifications

**Oil Capacity:** with a filter change—1.8 L (61 fl oz); without a filter change—1.6 L (54 fl oz)

**Viscosity:** See the table below.

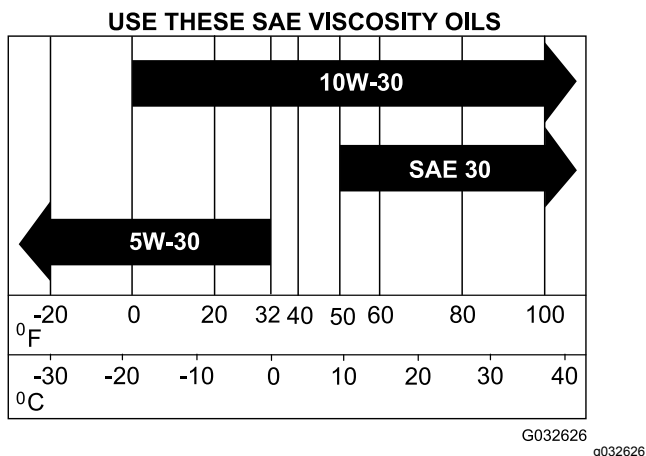

Figure 39

5. Remove the dipstick and wipe the oil off.
6. Insert the dipstick and push it all the way down into the tube.
7. Remove the dipstick and read the oil level.
8. If the oil level is low, wipe off the area around the oil-fill cap, remove cap and fill to the **full** mark on the dipstick (Figure 40).

**Important:** Do not operate the engine with the oil level below the low (or add) mark on the dipstick or over the full mark.

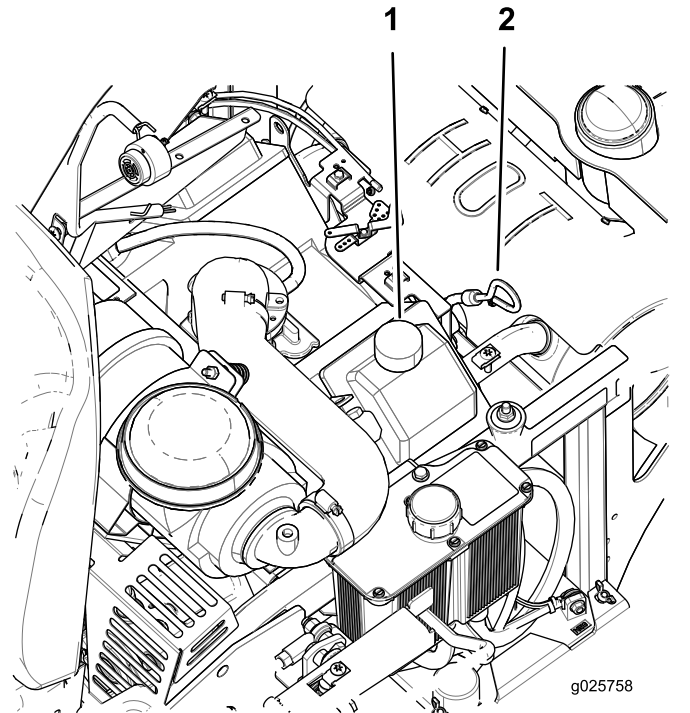

Figure 40

1. Oil-fill cap
2. Oil dipstick

## Checking the Engine-Oil Level

**Note:** Check the oil when the engine is cold.

**Important:** Do not overfill the crankcase with oil because damage to the engine may result. Do not run engine with oil below the low mark because the engine may be damaged.

1. Park the machine on a level surface, move the speed-control lever to the NEUTRAL position, disengage the PTO, and engage the parking brake.
2. Shut off the engine, remove the key, and wait for all moving parts to stop before leaving the operating position.

**Note:** Ensure that the engine is cool so that the oil has had time to drain into the sump.

3. Raise the hopper
4. To keep dirt, grass clippings, etc., out of the engine, clean the area around the oil-fill cap and dipstick before removing it (Figure 40).

## Changing the Engine Oil

**Note:** Dispose of the used oil at a recycling center.

1. Park the machine so that the rear is slightly lower than the front to ensure that the oil drains completely.
2. Move the speed-control lever to the NEUTRAL position to stop the machine.
3. Move the speed-control lever to the NEUTRAL position, disengage the PTO, and engage the parking brake.
4. Shut off the engine, remove the key, and wait for all moving parts to stop before leaving the operating position.

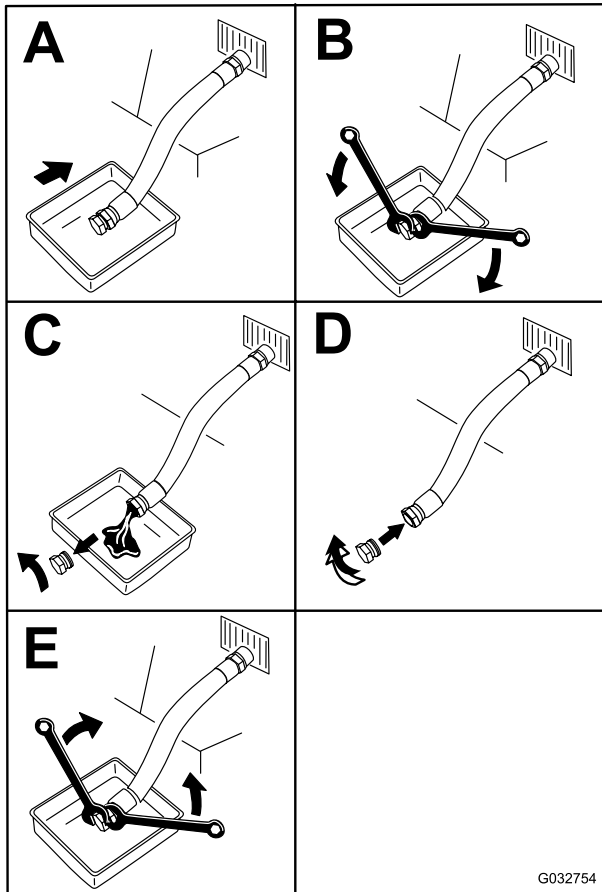

Figure 41

## Changing the Engine-Oil Filter

1. Drain the oil from the engine; refer to [Changing the Engine Oil \(page 38\)](#).
2. Change the engine-oil filter ([Figure 42](#)).

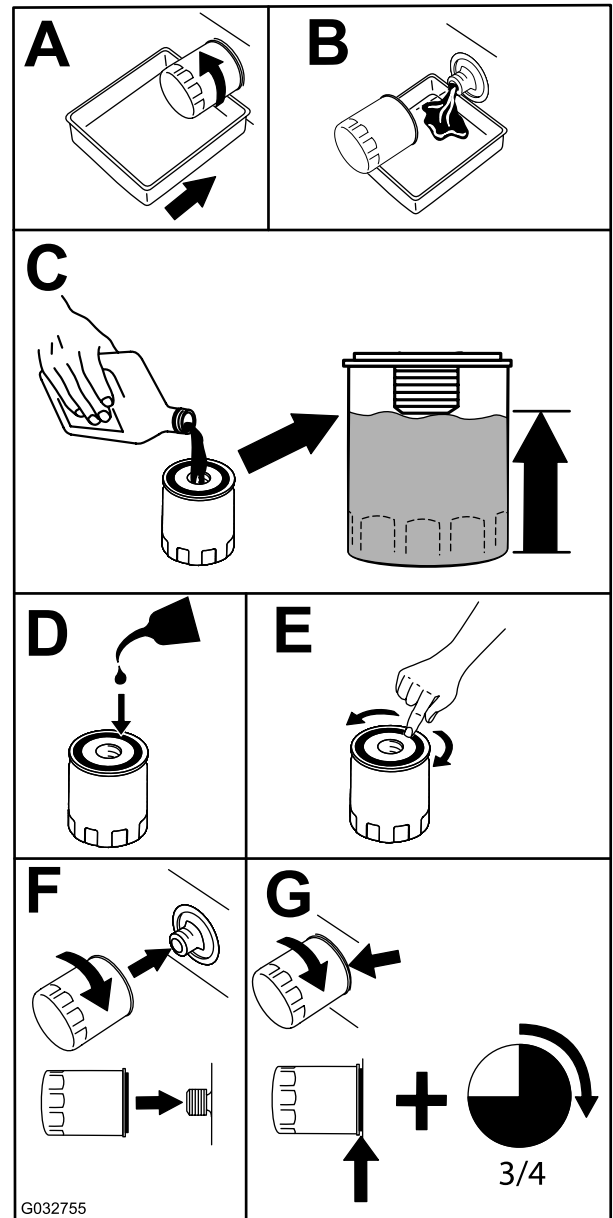

Figure 42

5. Slowly pour approximately 80% of the specified oil into the filler tube and slowly add the additional oil to bring it to the **full** mark on the dipstick ([Figure 40](#)).
6. Start the engine and drive to a flat area. Check the oil level again ([Figure 40](#)).
7. If needed, add oil to the **full** mark on the dipstick.

**Note:** Ensure that the oil-filter gasket touches the engine, and then turn the oil filter an extra 3/4 turn.

3. Fill the crankcase with the proper type of new oil; refer to [Engine Oil Specifications \(page 37\)](#).

# Servicing the Spark Plug

**Service Interval:** Every 200 hours—Check the spark plug(s).  
Every 500 hours—Replace the spark plug(s).

**Type:** Champion XC12YC

**Air Gap:** 0.76 mm (0.03 inch)

## Removing the Spark Plug

1. Park the machine on a level surface, disengage the blade-control switch (PTO), and engage the parking brake.
2. Shut off the engine, remove the key, and wait for all moving parts to stop before leaving the operating position.
3. Clean the area around the base of the plug(s) to keep dirt and debris out of the engine.
4. Locate and remove the spark plug(s) as shown in [Figure 43](#).

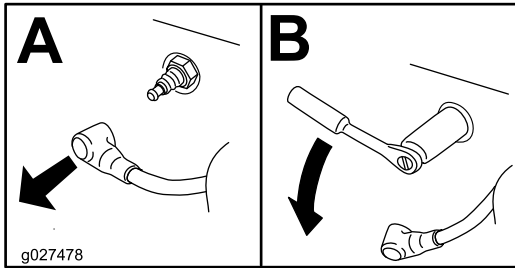

Figure 43

## Installing the Spark Plug

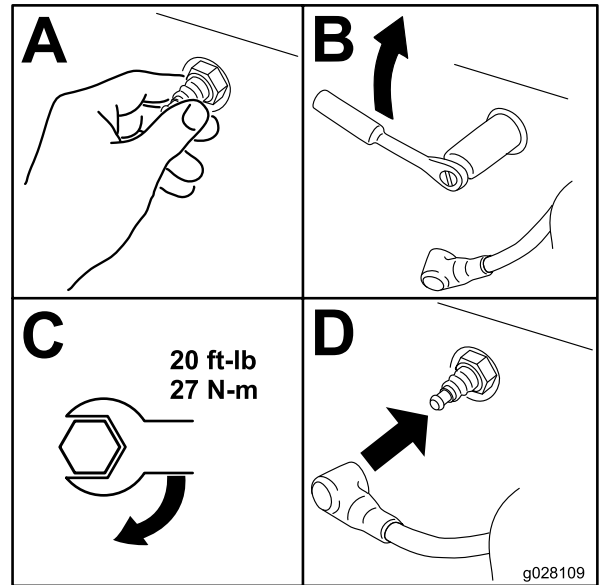

Figure 45

g028109

## Checking the Spark Plug

**Important:** Do not clean the spark plug(s). Always replace the spark plug(s) when it has a black coating, worn electrodes, an oily film, or cracks.

If you see light brown or gray on the insulator, the engine is operating properly. A black coating on the insulator usually means the air cleaner is dirty.

Set the gap to 0.76 mm (0.03 inch).

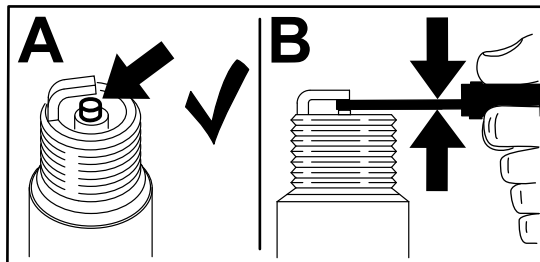

Figure 44

g206628

# Fuel System Maintenance

## ⚠ DANGER

In certain conditions, fuel is extremely flammable and highly explosive. A fire or explosion from fuel can burn you and others and can damage property.

Refer to [Fuel Safety \(page 14\)](#) for a complete list of fuel related precautions.

## Replacing the Fuel Filter

**Service Interval:** Every 200 hours/Yearly (whichever comes first) (more often in dirty or dusty conditions).

The fuel filter is located near the engine on the front or rear side of the engine.

1. Park the machine on a level surface, move the speed-control lever to the NEUTRAL position, disengage the blade-control switch (PTO), and engage the parking brake.
2. Shut off the engine, remove the key, and wait for all moving parts to stop before leaving the operating position.
3. Allow the machine to cool down.
4. Clamp the hose on the fuel tank side of the fuel filter.
5. Replace the fuel filter ([Figure 46](#)).

**Note:** Ensure that the markings on the filter follow the fuel flow direction.

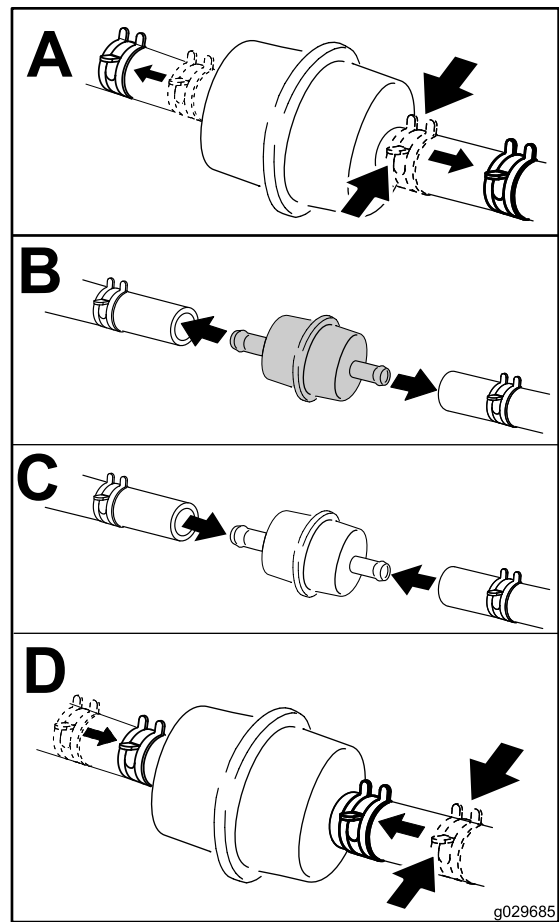

Figure 46

g029685

**Note:** Install the fuel-line hoses and secure them with plastic ties the same as they were originally installed at the factory to keep the fuel line away from components that could cause fuel line damage.

## Servicing the Fuel Tank

Do not attempt to drain the fuel tank. Ensure that an Authorized Service Dealer drains the fuel tank and services any components of the fuel system.



# Electrical System Maintenance

## Electrical System Safety

- Disconnect the battery before repairing the machine. Disconnect the negative terminal first and the positive last. Connect the positive terminal first and the negative last.
- Charge the battery in an open, well-ventilated area, away from sparks and flames. Unplug the charger before connecting or disconnecting the battery. Wear protective clothing and use insulated tools.

## Servicing the Battery

Service Interval: Monthly

### **⚠ DANGER**

**Battery electrolyte contains sulfuric acid which is fatal if consumed and causes severe burns.**

**Do not drink electrolyte and avoid contact with skin, eyes or clothing. Wear safety glasses to shield your eyes and rubber gloves to protect your hands.**

## Removing the Battery

### **⚠ WARNING**

**Incorrectly removing the cables from battery could damage the machine and cables, causing sparks. Sparks can cause the battery gasses to explode, resulting in personal injury.**

- **Always disconnect the negative (black) battery cable before disconnecting the positive (red) cable.**
  - **Always connect the positive (red) battery cable before connecting the negative (black) cable.**
1. Park the machine on a level surface, move the speed-control lever to the NEUTRAL position, disengage the blade-control switch (PTO), and engage the parking brake.
  2. Shut off the engine, remove the key, and wait for all moving parts to stop before leaving the operating position.
  3. Disconnect the negative battery cable (black) from the negative (-) battery terminal ([Figure 47](#)).

4. Slide the red terminal boot off the positive (red) battery terminal and remove the positive (+) battery cable ([Figure 47](#)).
5. Remove the wing nuts securing the J-hooks ([Figure 47](#)).
6. Remove the clamp ([Figure 47](#)).
7. Remove the battery.

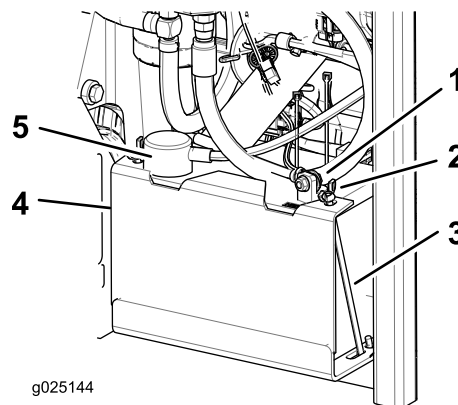

Figure 47

- |                                   |                                 |
|-----------------------------------|---------------------------------|
| 1. Negative (black) battery cable | 4. Clamp                        |
| 2. Wing nut                       | 5. Positive (red) battery cable |
| 3. J-hook                         |                                 |

## Charging the Battery

### **⚠ WARNING**

**Charging the battery produces gasses that can explode.**

**Never smoke near the battery and keep sparks and flames away from the battery.**

**Important:** Always keep the battery fully charged (1.265 specific gravity). This is especially important to prevent battery damage when the temperature is below 0°C (32°F).

1. Remove the battery from the chassis; refer to [Removing the Battery](#) (page 41).
2. Charge the battery for 10 to 15 minutes at 25 to 30 A or for 30 minutes at 10 A.

**Note:** Do not overcharge the battery.

3. When the battery is fully charged, unplug the charger from the electrical outlet, then disconnect the charger leads from the battery posts ([Figure 48](#)).
4. Install the battery in the machine and connect the battery cables; refer to [Installing the Battery](#) (page 42).

**Note:** Do not run the machine with the battery disconnected; electrical damage may occur.

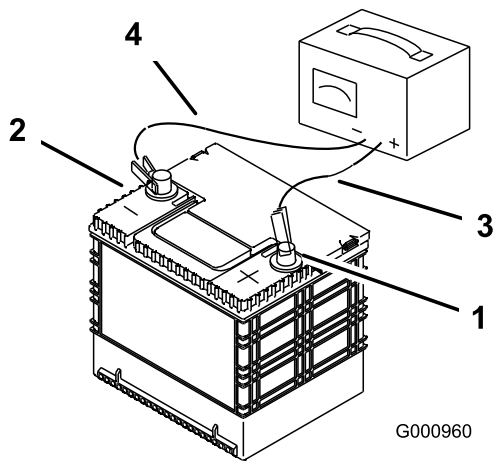

**Figure 48**

- |                              |                           |
|------------------------------|---------------------------|
| 1. Positive (+) battery post | 3. Red (+) charger lead   |
| 2. Negative (-) battery post | 4. Black (-) charger lead |

## Installing the Battery

1. Position the battery in the tray with the terminal posts opposite from the hydraulic tank (Figure 47).
2. Install the positive (red) battery cable to the positive (+) battery terminal.
3. Install the negative (black) battery cable and ground wire to the negative (-) battery terminal.
4. Secure the cables with 2 bolts, 2 washers, and 2 locknuts (Figure 47).
5. Slide the red terminal boot onto the positive (red) battery post.
6. Install the clamp and secure it with the wing nuts and J-hooks (Figure 47).

## Adjusting the Safety Switches

Adjust all safety switches so that the plunger extends 4.8 mm to 6.4 mm (3/16 inch to 1/4 inch) from the switch body when the plunger is compressed (Figure 49).

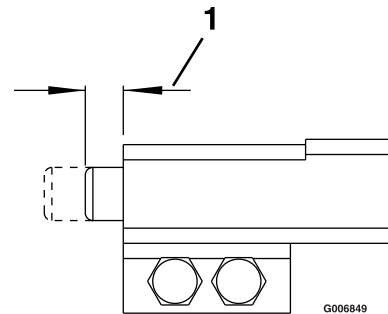

**Figure 49**

1. 4.8 to 6.4 mm (3/16 to 1/4 inch)

## Servicing the Fuses

The electrical system is protected by fuses. It requires no maintenance; however, if a fuse blows check the component/circuit for a malfunction or short.

1. The fuses are located on right side behind the seat.
2. To replace the fuses, pull out on the fuse to remove it.
3. Install a new fuse.

# Jump-Starting the Machine

1. Check and clean corrosion from the battery terminals before jump-starting. Ensure that the connections are tight.

## ⚠ CAUTION

Corrosion or loose connections can cause unwanted electrical voltage spikes at any time during the jump-starting procedure.

Do not attempt to jump-start the machine with loose or corroded battery terminals, or damage to the engine or EFI may occur.

## ⚠ DANGER

Jump-starting a weak battery that is cracked or frozen or has a low electrolyte level or an open/shorted battery cell can cause an explosion, resulting in serious personal injury.

Do not jump-start a weak battery if these conditions exist.

2. Make sure that the booster battery is a good and fully charged lead-acid battery at 12.6 V or greater.

**Note:** Use properly sized jumper cables with short lengths to reduce voltage drop between systems. Make sure that the cables are color coded or labeled for the correct polarity.

## ⚠ CAUTION

Connecting the jumper cables incorrectly (wrong polarity) can immediately damage the EFI system.

Be certain of battery-terminal polarity and jumper-cable polarity when hooking up the batteries.

## ⚠ WARNING

Batteries contain acid and produce explosive gases.

- Shield your eyes and face from the batteries at all times.
- Do not lean over the batteries.

**Note:** Ensure that the vent caps are tight and level. Place a damp cloth, if available, over any

vent caps on both batteries. Also ensure that the machines do not touch and that both electrical systems are off and at the same rated system voltage. These instructions are for negative ground systems only.

3. Connect the positive (+) cable to the positive (+) terminal of the discharged battery that is wired to the starter or solenoid as shown in [Figure 50](#).

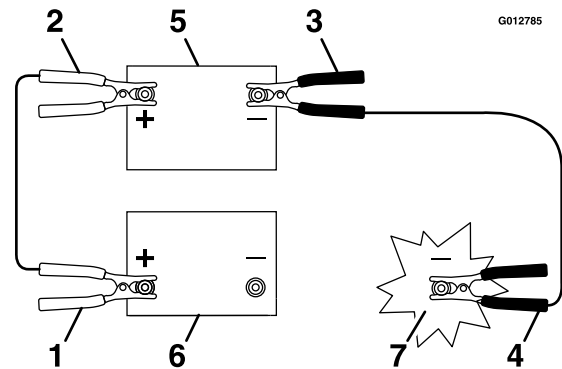

Figure 50

- |  |                       |
|--|-----------------------|
| 1. Positive (+) cable on discharged battery  | 5. Booster battery    |
| 2. Positive (+) cable on booster battery     | 6. Discharged battery |
| 3. Negative (-) cable on the booster battery | 7. Engine block       |
| 4. Negative (-) cable on the engine block    |                       |

4. Connect the other end of the positive cable to the positive terminal of the booster battery.
5. Connect the black negative (-) cable to the other terminal (negative) of the booster battery.
6. Make the final connection on the engine block of the stalled machine (not to the negative battery post), away from the battery, and stand back ([Figure 51](#)).

# Drive System Maintenance

## Adjusting the Tracking

**Note:** The tracking knob is located under the seat.

**Note:** Rotating this knob allows fine tuning adjustments so that the machine tracks straight with the drive levers in the full forward position.

1. Run the machine at 3/4 speed for at least 5 minutes to bring hydraulic fluid up to operating temperature.
2. Park the machine on a level surface, move the speed-control lever to the NEUTRAL position, disengage the blade-control switch (PTO), and engage the parking brake.
3. Shut off the engine, remove the key, and wait for all moving parts to stop before leaving the operating position.
4. Tilt the seat forward to gain access to the tracking knob.
5. Rotate the knob toward the right to steer right and rotate it toward the left to steer left.
6. Adjust in 1/8 turn increments until the machine tracks straight.
7. Check and ensure that the machine does not creep when in neutral with the parking brakes disengaged (Figure 52).

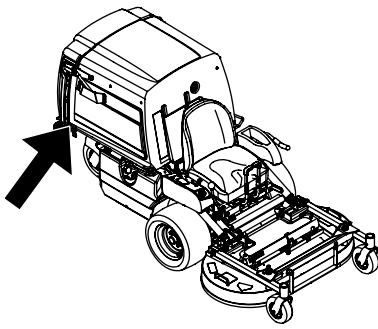

g209397

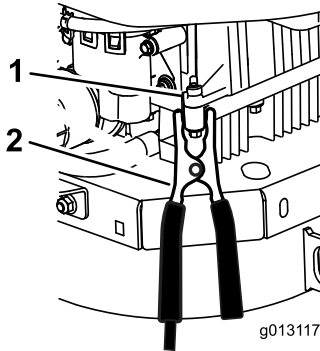

g013117

**Figure 51**

g013117

1. Engine block
2. Negative (-) cable

7. Start the machine and remove the cables in the reverse order of connection (disconnect the negative cable from the engine block first).

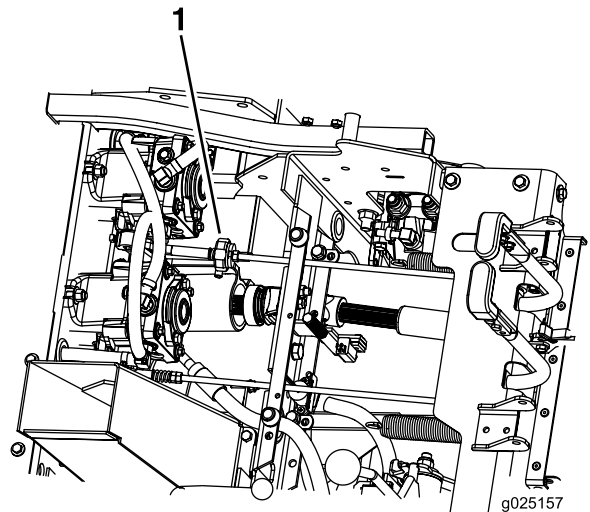

g025157

g025157

**Figure 52**

1. Tracking knob

# Checking the Tire Pressure

**Service Interval:** Every 40 hours

Maintain the air pressure in the rear tires at 103 kPa (15 psi). Uneven tire pressure can cause uneven cut. Check the tires when they are cold, to get the most accurate pressure reading.

**Note:** The front tires are semi-pneumatic tires and does not require air pressure maintenance.

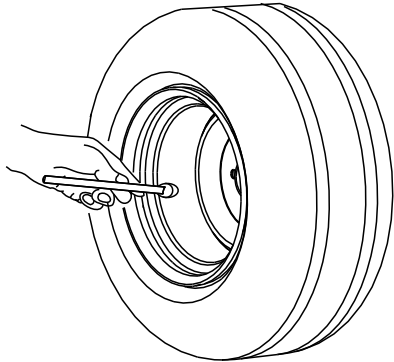

G001055

g001055

**Figure 53**

---

**Note:** Do not add any type of tire liner or foam fill material to the tires.

# Checking the Wheel Lug Nuts

Check and torque the wheel lug nuts to 122 to 129 N·m (90 to 95 ft-lb).

# Checking the Wheel-Hub Slotted Nuts

**Service Interval:** After the first 100 hours  
Every 500 hours

Check and ensure that the torque of the slotted nut is 373 to 475 N·m (275 to 350 ft-lb).

# Adjusting the Caster-Pivot Bearings

**Service Interval:** Every 500 hours/Yearly (whichever comes first)

1. Park the machine on a level surface, move the speed-control lever to the NEUTRAL position, disengage the blade-control switch (PTO), and engage the parking brake.
2. Shut off the engine, remove the key, and wait for all moving parts to stop before leaving the operating position.
3. Remove the dust cap from the caster and tighten the locknut until the spring washers are flat, then back off 1/4 turn to properly set the pre-load on the bearings (Figure 54 and Figure 55).

**Important:** Make sure that the spring washers are installed correctly as shown in Figure 54 and Figure 55.

4. Install the dust cap.

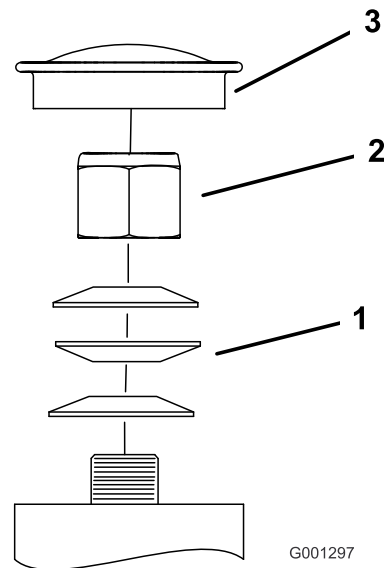

G001297

g001297

**Figure 54**  
Front Caster

1. Spring washers
2. Locknut
3. Dust cap

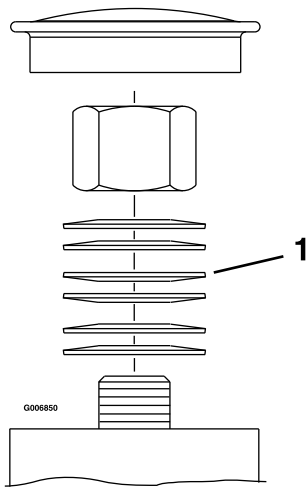

**Figure 55**  
Rear Caster

G006850

1. Spring washers

# Cooling System Maintenance

## Cooling System Safety

- Swallowing engine coolant can cause poisoning; keep out of reach from children and pets.
- Discharge of hot, pressurized coolant or touching a hot radiator and surrounding parts can cause severe burns.
  - Always allow the engine to cool at least 15 minutes before removing the radiator cap.
  - Use a rag when opening the radiator cap, and open the cap slowly to allow steam to escape.

## Cleaning the Engine Screen and Engine-Oil Cooler

**Service Interval:** Before each use or daily

Remove any buildup of grass, dirt, or other debris from the oil cooler and the engine screen (Figure 56).

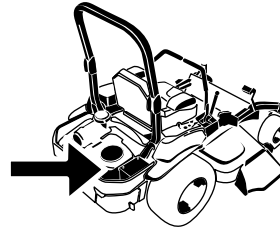

G008804  
g008804

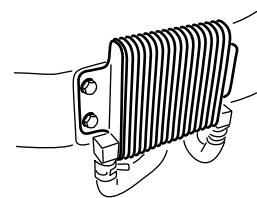

G009191

g009191

**Figure 56**

Remove any buildup of grass, dirt, or other debris from the engine screen. This helps ensure adequate cooling and correct engine speed and reduces the possibility of overheating and mechanical damage to the engine (Figure 56).

# Servicing the Engine-Oil Cooler

**Service Interval:** Every 100 hours

1. Park the machine on a level surface, move the speed-control lever to the NEUTRAL position, disengage the PTO, and engage the parking brake.
2. Shut off the engine, remove the key, and wait for all moving parts to stop before leaving the operating position.
3. Remove the fuel-tank mounting nuts and swing out the fuel tank.
4. Keep the oil-cooler free of debris by cleaning the fins with a brush.
5. Swing the fuel tank in and secure it with the mounting nuts.
6. Back the mounting nuts off 1/2 turn to allow for tank expansion.

# Cleaning the Engine Cooling Fins and Shrouds

**Service Interval:** Every 100 hours/Yearly (whichever comes first)

1. Park the machine on a level surface, move the speed-control lever to the NEUTRAL position, disengage the PTO, and engage the parking brake.
2. Shut off the engine, remove the key, and wait for all moving parts to stop before leaving the operating position.
3. Remove the air-intake screen and fan housing.
4. Clean the debris and grass from the engine parts.
5. Install air-intake screen and fan housing.

# Brake Maintenance

## Adjusting the Parking Brake

**Service Interval:** After the first 100 hours

Every 500 hours thereafter

Make sure that the brake is adjusted properly. Follow this procedure when you remove or replace a brake component.

1. Park the machine on a level surface, move the speed-control lever to the NEUTRAL position, disengage the PTO, and engage the parking brake.
2. Shut off the engine, remove the key, and wait for all moving parts to stop before leaving the operating position.
3. Release the parking brake.
4. Tilt the seat forward.
5. Check and ensure that there is no slack between the parking-brake handle and the linkage.
6. If an adjustment is necessary, remove the clevis pin and rotate the linkage counterclockwise to lengthen it or clockwise to shorten it.

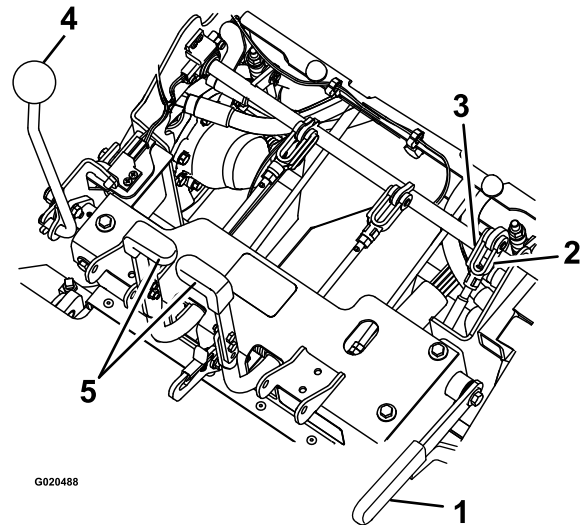
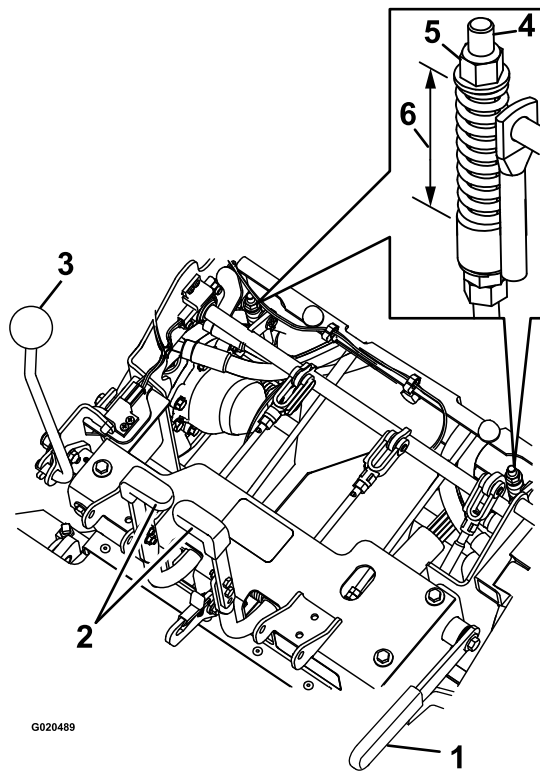

**Figure 57**

- |                  |                        |
|------------------|------------------------|
| 1. Parking brake | 4. Speed-control lever |
| 2. Rotate yoke   | 5. Steering levers     |
| 3. Clevis pin    |                        |

7. Measure the compressed spring length on both vertical spring assemblies.

**Note:** The spring should measure between 6 to 7 cm (2.35 to 2.85 inches). If necessary, adjust the nut at the top of the vertical spring assembly to achieve this distance.

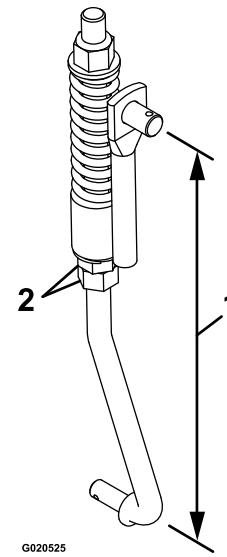

**Figure 58**

- |                        |                                    |
|------------------------|------------------------------------|
| 1. Parking brake       | 4. Vertical spring assembly        |
| 2. Steering lever      | 5. Nut                             |
| 3. Speed-control lever | 6. 6 to 7 cm (2.35 to 2.85 inches) |

- 
8. Adjust the linkage length with the 2 nuts at the bottom of the vertical spring assembly (Figure 59).

**Note:** The linkage should measure 22.7 to 23.3 cm (8.92 to 9.16 inches).



**Figure 59**

- |  |         |
|--|---------|
| 1. 22.7 to 23.3 cm (8.92 to 9.16 inches) | 2. Nuts |
|--|---------|

- 
9. Engage and disengage the brakes to check for proper engagement and disengagement. Adjust if necessary.

**Note:** When the brakes are disengaged, there should be little to no free play in the brake linkage with no dragging in the brakes.



# Belt Maintenance

## Inspecting the Belts

**Service Interval:** Every 40 hours

Replace the belt if it is worn. The signs of a worn belt include squealing while the belt is rotating; the blades slipping while cutting grass; and frayed edges, burn marks, and cracks on the belt.

1. Park the machine on a level surface, move the speed-control lever to the NEUTRAL position, disengage the PTO, and engage the parking brake.
2. Shut off the engine, remove the key, and wait for all moving parts to stop before leaving the operating position.
3. Tilt the hopper up and check the pump and PTO drive belts for wear, cracking, or contamination.

**Note:** The belts are spring tensioned and no adjustment is necessary unless the belts are replaced.

## Replacing the PTO Belts

1. Park the machine on a level surface, move the speed-control lever to the NEUTRAL position, disengage the PTO, and engage the parking brake.
2. Shut off the engine, remove the key, and wait for all moving parts to stop before leaving the operating position.
3. With the engine off, engage the PTO lever, then remove the hairpin cotter and clevis pin at the bottom of the PTO-brake band.
4. Rotate the brake band upward and out of the way of the belts keeping clear of the belt drive.
5. Disengage the PTO lever.
6. Loosen belt guides **A** and **B** (Figure 60).
7. Remove the belts.
8. Route the new belts onto the pulleys as shown in Figure 60.

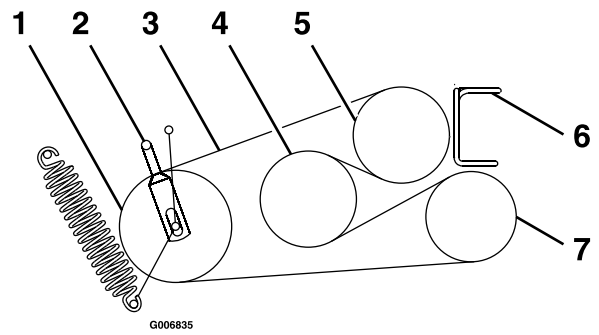

**Figure 60**

- |                 |                 |
|-----------------|-----------------|
| 1. Idler        | 5. Engine       |
| 2. Belt guide B | 6. Belt guide A |
| 3. PTO belt     | 7. Blower       |
| 4. Jackshaft    |                 |

9. Engage the PTO lever.
10. Rotate the brake band down into the original position.
11. Install the clevis pin and hairpin cotter to secure the brake band.
12. Loosen the jam nuts and adjust the linkage until the top of the idler arm is aligned with the bottom of the notch on the tension arm as shown in Figure 61.

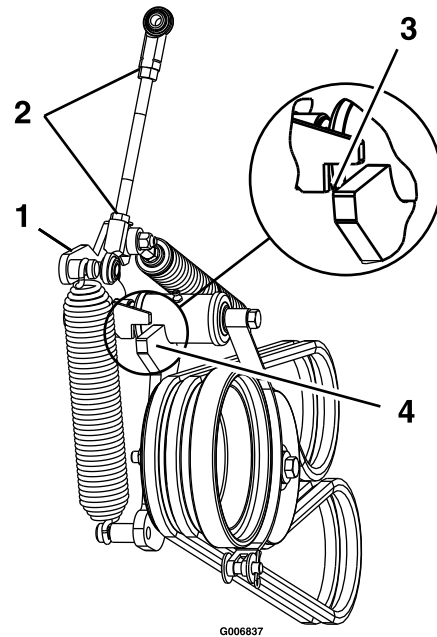

**Figure 61**

1. Tension arm
2. Loosen the jam nuts.
3. When PTO is engaged, align top of idler arm with bottom of notch on tension arm, as shown.
4. Idler arm

13. Tighten the jam nuts and disengage the PTO lever.

14. Engage the PTO lever and check the alignment.
15. Check and adjust the belt guides as stated in [Adjusting the Belt Guides \(page 50\)](#).

## Replacing the Pump-Drive Belt

1. Park the machine on a level surface, move the speed-control lever to the NEUTRAL position, disengage the PTO, and engage the parking brake.
2. Shut off the engine, remove the key, and wait for all moving parts to stop before leaving the operating position.
3. Remove the PTO Belts; refer to [Replacing the PTO Belts \(page 49\)](#).
4. Pull the spring idler or remove the spring to relieve the tension of the pump-drive belt.
5. Remove the old belt.
6. Route the new belt onto the sheaves as shown in the decal located on the back of the left drive shield ([Figure 62](#)).

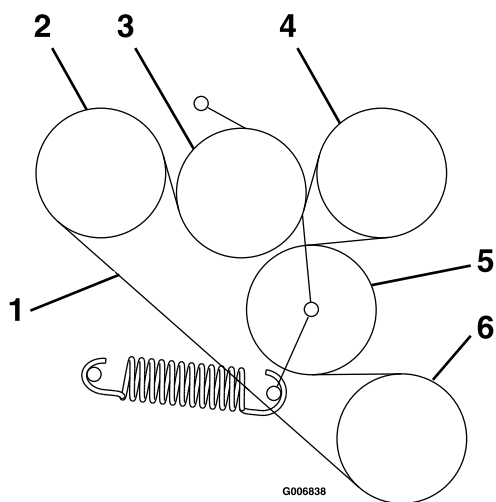
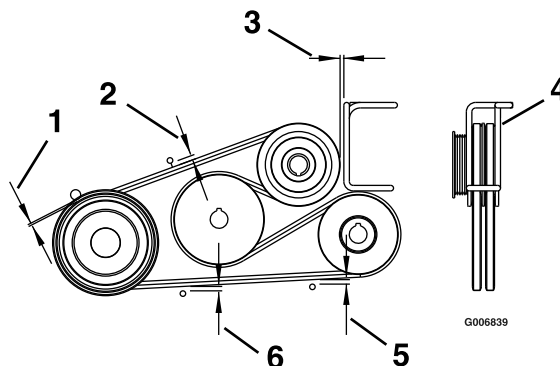

**Figure 62**

- |                    |           |
|--------------------|-----------|
| 1. Pump-drive belt | 4. Pump   |
| 2. Pump            | 5. Idler  |
| 3. Idler           | 6. Engine |

## Adjusting the Belt Guides

1. Park the machine on a level surface, move the speed-control lever to the NEUTRAL position, disengage the PTO, and engage the parking brake.
2. Shut off the engine, remove the key, and wait for all moving parts to stop before leaving the operating position.
3. With the engine off, engage the PTO lever.
4. Adjust the belt guides as shown in [Figure 63](#).



**Figure 63**

- |                              |  |
|------------------------------|--|
| 1. 3 mm (1/8 inch)           | 4. Rotate the wireform guide to center the belts in the guide. |
| 2. 11 mm (7/16 inch)         | 5. 6 mm (1/4 inch)   |
| 3. 3 mm (1/8 inch) clearance | 6. 8 mm (5/16 inch)  |

7. Install the PTO belts; refer to [Replacing the PTO Belts \(page 49\)](#).

# Controls System Maintenance

## Adjusting the Reverse-Stop Rod

1. Park the machine on a level surface, move the speed-control lever to the NEUTRAL position, disengage the blade-control switch (PTO), and engage the parking brake.
2. Shut off the engine, remove the key, and wait for all moving parts to stop before leaving the operating position.
3. Check the movement of the steering levers as follows:
  - If the levers move slightly forward up to 3 mm (1/8 inch) then no adjustment is necessary.
  - If the levers do not move, then proceed with the following steps:
    - A. Flip the seat up or remove the seat-frame assembly (with the seat attached) to obtain a clear view of the steering-control shaft to complete this adjustment.
    - B. Place the speed-control lever in the NEUTRAL position.
    - C. Release the parking brake.
    - D. Slightly adjust the length of the rod by loosening the jam nut and by rotating the rod.

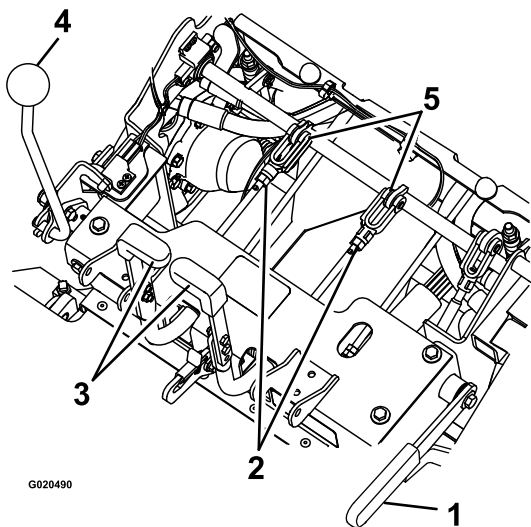

Figure 64

- |                   |                            |
|-------------------|----------------------------|
| 1. Parking brake  | 4. Speed-control lever     |
| 2. Nut            | 5. Clevis pin and stop rod |
| 3. Steering lever |                            |

- E. Engage the parking brake and check the steering levers.
- F. Repeat steps C through E until you achieve up to 3 mm (1/8 inch) movement.
- G. Install the seat frame assembly, if removed in step A.

## Adjusting the Speed-Control Lever Tension

1. Park the machine on a level surface, move the speed-control lever to the NEUTRAL position, disengage the blade-control switch (PTO), and engage the parking brake.
2. Shut off the engine, remove the key, and wait for all moving parts to stop before leaving the operating position.
3. Adjust the pivot nut, which is located at the end of the motion-control shaft in front of the right console (Figure 65).

**Note:** Set the tension high enough that the speed-control lever position is maintained during operation and loose enough to be moved comfortably.

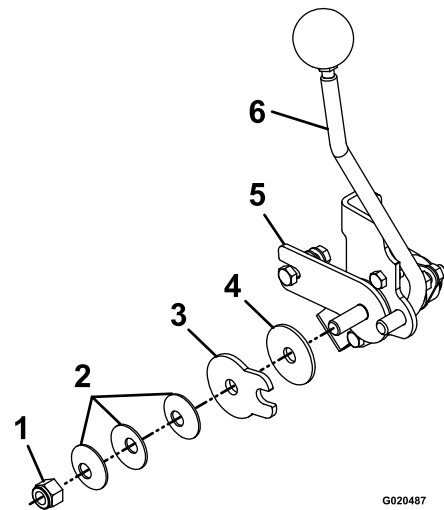

Figure 65

- |                                 |                                   |
|---------------------------------|-----------------------------------|
| 1. Pivot nut                    | 4. Friction disc                  |
| 2. Spring-disc washers          | 5. Speed-control friction bracket |
| 3. Speed-control friction plate | 6. Speed-control lever            |

# Adjusting the Speed-Control Linkage

## ⚠ WARNING

The engine must be running and the drive wheels must be turning to adjust the motion controls. Contact with moving parts or hot surfaces may cause personal injury.

Keep your fingers, hands, and clothing clear of rotating components and hot surfaces.

## ⚠ CAUTION

Raising the mower deck for service or maintenance relying solely on mechanical or hydraulic jacks could be dangerous. The mechanical or hydraulic jacks may not be enough support or may malfunction allowing the unit to fall, which could cause injury.

Do not rely solely on mechanical or hydraulic jacks for support. Use adequate jack stands or equivalent support.

1. Park the machine on a level surface, move the speed-control lever to the NEUTRAL position, disengage the blade-control switch (PTO), and engage the parking brake.
2. Shut off the engine, remove the key, and wait for all moving parts to stop before leaving the operating position.
3. Remove the electrical connection from the seat safety switch, located directly in front of the seat-switch assembly.
4. Raise the frame and place on jack stands so that drive wheels can rotate freely.  
**Note:** You must make the neutral adjustment with the drive wheels turning.
5. Temporarily install a jumper wire across the terminals in the seat safety switch connector of the wire harness.
6. Start the engine.
7. Run the machine at least 5 minutes with the speed-control lever at full forward speed to bring the hydraulic system fluid up to operating temperature.
8. Return the speed-control lever to the NEUTRAL position.
9. To obtain the NEUTRAL position, adjust the left and right pump-control-rod linkages that connect the steering control to the pump-control arms

until the wheels stop or creep slightly in reverse (Figure 66).

10. Adjust the left pump linkage by rotating the tracking-adjustment knob.
11. Adjust the right pump linkage by using a wrench to turn the double nuts on the assembly (Figure 66).

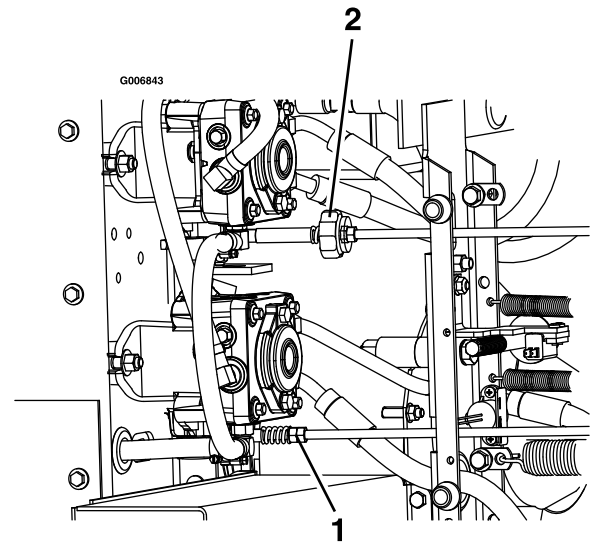

Figure 66

1. Rotate the tracking knob
  2. Rotate the double nuts on right side.
- 
12. Move the steering levers to the reverse position. While applying slight pressure to the levers, allow the steering levers to return to NEUTRAL.  
**Note:** The wheels must stop turning or slightly creep in reverse.
  13. Shut off the engine and wait for all moving parts to stop.
  14. Remove the jumper wire from the wire-harness connector and plug the connector into the seat switch.
  15. Lower the machine from the jack stands.

## Aligning the PTO-Drive Pulley

Align the PTO-drive pulley for any of the following conditions:

- The blower has been removed or replaced.
  - The engine mounting bolts have been loosened or the engine has been moved or replaced.
  - The jackshaft mounting bolts have been loosened or the jackshaft has been moved or replaced.
1. Park the machine on a level surface, move the speed-control lever to the NEUTRAL position,

disengage the blade-control switch (PTO), and engage the parking brake.

2. Shut off the engine, remove the key, and wait for all moving parts to stop before leaving the operating position.
3. Remove the fuel-tank mounting nuts and swing out the fuel tank.
4. Verify that the blower is installed and tightly secured.
5. Loosen the 4 engine mounting bolts.
6. Unhook the pump-belt tension spring.
7. Loosen the 4 jackshaft mounting bolts.
8. Measuring from the blower pulley as a baseline, move the engine and jackshaft until the rear surface of all 3 pulleys are aligned within 0.8 to 1.6 mm (1/32 inch to 1/16 inch) (Figure 67).

**Note:** Use a straight edge to align all 3 surfaces.

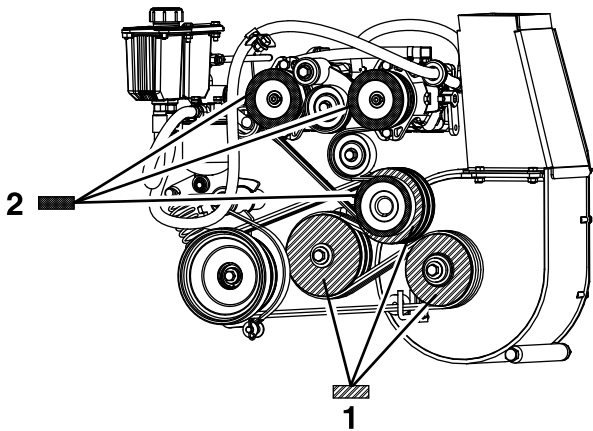

**Figure 67**

1. Align the 3 pump-drive pulley surfaces shown with this pattern within 0.8 to 1.6 mm (1/32 inch to 1/16 inch).
2. Align the 3 PTO-drive pulley surfaces shown with this pattern within 0.8 to 1.6 mm (1/32 inch to 1/16 inch).

## Aligning the Pump-Drive Pulley

The pump-drive-pulley alignment is necessary for any of the following conditions:

- The engine mounting bolts have been loosened or the engine has been moved or replaced.
  - The pump pulleys have been loosened, moved, or replaced.
  - The PTO pulley has been aligned; refer to [Aligning the PTO-Drive Pulley \(page 52\)](#).
1. Park the machine on a level surface, move the speed-control lever to the NEUTRAL position, disengage the blade-control switch (PTO), and engage the parking brake.
  2. Shut off the engine, remove the key, and wait for all moving parts to stop before leaving the operating position.
  3. Loosen the set screws on both pump pulleys.
  4. Using a straight edge, align each pump pulley with the engine pulley by sliding it along the pump shaft (Figure 67).
  5. Tighten the pulley set screws and check the alignment.

9. Tighten the 4 engine mounting bolts and 4 jackshaft mounting bolts. Check the alignment after tightening.
10. Install the pump-belt tension spring.
11. Swing the fuel tank in and install the tank mounting nuts.
12. Align the pump-drive pulley; [Aligning the Pump-Drive Pulley \(page 53\)](#).

# Adjusting the PTO Brake Spring

Adjust the PTO brake spring only if the blower has been removed or replaced or if the PTO drive idler arm has been disassembled.

1. Park the machine on a level surface, move the speed-control lever to the NEUTRAL position, disengage the blade-control switch (PTO), and engage the parking brake.
2. Shut off the engine, remove the key, and wait for all moving parts to stop before leaving the operating position.
3. Locate the brake spring and thread the 2 jam nuts out to the end of the brake-spring rod (Figure 68).
4. Tighten the jam nuts together at end of the brake-spring rod.

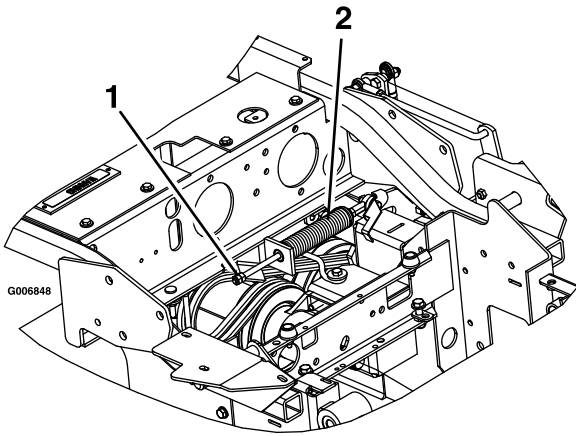
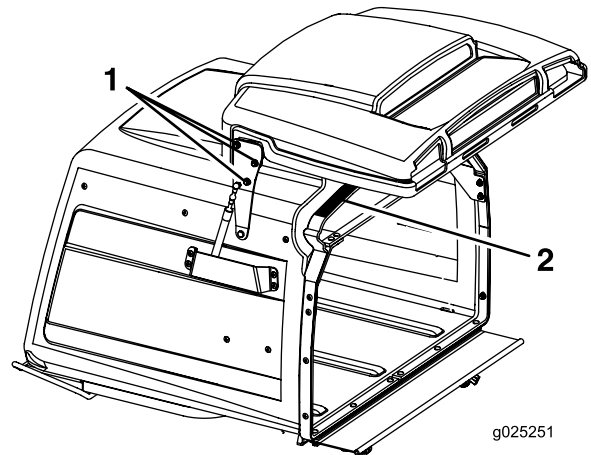

**Figure 68**

1. Tighten the jam nuts here.
2. PTO brake-spring assembly

# Adjusting the Hopper Door

1. Park the machine on a level surface, move the speed-control lever to the NEUTRAL position, disengage the blade-control switch (PTO), and engage the parking brake.
2. Shut off the engine, remove the key, and wait for all moving parts to stop before leaving the operating position.
3. Loosen the 6 door hinge nuts (Figure 69).
4. Open the door and place a 3/8 inch (9.5 mm) rubber strip or 3/8 inch (9.5 mm) diameter hose between the hopper and the hopper door (Figure 69).
5. Close the door and push it tight against the hopper.
6. Tighten the hinge hardware.
7. Open the hopper door and remove the rubber strip.



**Figure 69**

1. Loosen the door hinge nuts—3 per side.
2. Place a piece of 9.5 mm (3/8 inch) rubber on this surface.

# Adjusting the Locking-Pin Stop on the Mower Deck

1. Slide the mower-deck locking pins in on both sides of the mower deck and rotate them to lock the mower deck in the operating position.
2. Loosen the jam nut and turn the stop screw clockwise until the locking pin is tight and cannot be rotated by hand (Figure 70).

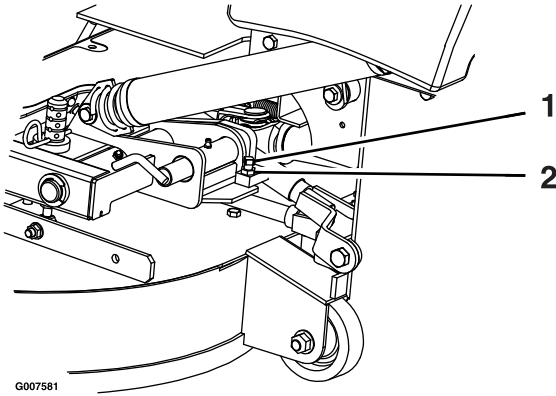

Figure 70

1. Rotate the stop screw clockwise until the locking pin is tight, then back off 1/2 turn.
  2. Loosen the jam nut.
- 
3. Loosen the stop screw counter clockwise 1/2 turn and tighten the jam nut.
  4. Test the locking pin to make sure that it slides freely. Adjust if necessary.

# Hydraulic System Maintenance

## Hydraulic System Safety

- Seek immediate medical attention if fluid is injected into skin. Injected fluid must be surgically removed within a few hours by a doctor.
- Ensure that all hydraulic-fluid hoses and lines are in good condition and all hydraulic connections and fittings are tight before applying pressure to the hydraulic system.
- Keep your body and hands away from pinhole leaks or nozzles that eject high-pressure hydraulic fluid.
- Use cardboard or paper to find hydraulic leaks.
- Safely relieve all pressure in the hydraulic system before performing any work on the hydraulic system.

## Hydraulic-Fluid Specifications

**Hydraulic Fluid Type:** Toro® HYPR-OIL™ 500 hydraulic oil or Mobil® 1 15W-50.

**Important:** Use the fluid specified. Other fluids could cause system damage.

**Hydraulic-tank capacity:** 5.7 L (6 US qt)

## Checking the Hydraulic Fluid

**Service Interval:** Every 40 hours—Check the hydraulic fluid level.

1. Park the machine on a level surface, move the speed-control lever to the NEUTRAL position, disengage the blade-control switch (PTO), and engage the parking brake.
2. Shut off the engine, remove the key, and wait for all moving parts to stop before leaving the operating position.
3. Allow the engine and the hydraulic system to cool for 10 minutes.

**Note:** To get the correct reading, check the hydraulic fluid level when the machine is cool.

4. Raise the seat up; refer to [Unlatching the Seat \(page 19\)](#).
5. Clean the area around the dipstick of the hydraulic-system reservoir ([Figure 71](#)).

6. Remove the dipstick from the hydraulic reservoir (Figure 71).
7. Wipe the dipstick off and thread the dipstick into the reservoir.
8. Remove the dipstick and look at the end (Figure 71). If the fluid level is at the add mark, slowly pour only enough fluid into the hydraulic reservoir to raise the level to the full line.

**Important:** Do not overfill the hydraulic units with fluid, as damage may occur. Do not run the machine with the fluid below the add mark.

9. Install the dipstick.

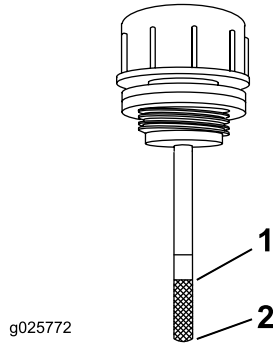

Figure 71

1. Full

2. Add

## Changing the Hydraulic Fluid and Filter

**Service Interval:** After the first 100 hours—Change the hydraulic filter and reservoir hydraulic fluid when using any type of fluid.

Every 250 hours—Change the hydraulic filter and reservoir hydraulic fluid when using Mobil® 1 fluid (more often in dirty or dusty conditions).

Every 500 hours—Change the hydraulic filter and reservoir hydraulic fluid when using Toro® HYPR-OIL™ 500 hydraulic fluid (more often in dirty or dusty conditions).

**Note:** Use a summer filter when the temperature is 0°C (32°F) and above. Use a winter filter when the temperature is 0°C (32°F) and below.

1. Park the machine on a level surface, move the speed-control lever to the NEUTRAL position, disengage the blade-control switch (PTO), and engage the parking brake.
2. Shut off the engine, remove the key, and wait for all moving parts to stop before leaving the operating position.

3. Carefully clean the area around the filter.

**Important:** Ensure that no dirt or contamination enter the hydraulic system.

4. Unscrew and remove the filter and allow the fluid to drain from the reservoir.

**Important:** Do not change the hydraulic system fluid (except for what can be drained when changing the filter), unless the fluid has been contaminated or been extremely hot. Changing the hydraulic fluid unnecessarily could damage the hydraulic system by introducing contaminants into the system.

5. Before installing the new filter, fill it with Toro® HYPR-OIL™ 500 hydraulic fluid and apply a thin coat of fluid on the surface of the rubber seal.
6. Turn the filter clockwise until the rubber seal contacts the filter adapter, then tighten the filter an additional 2/3 to 3/4 turn.
7. Fill the reservoir as stated in [Checking the Hydraulic Fluid \(page 55\)](#).
8. Raise the rear of the machine up and support it with jack stands (or equivalent support) just high enough to allow drive wheels to turn freely.
9. Start the engine and move the throttle control to the FULL-THROTTLE position.
10. Move the speed-control levers to the full-speed position and run the machine for several minutes.
11. Shut off the machine and check the fluid level.

## Checking and Cleaning the Hydraulic Pumps

**Service Interval:** Before each use or daily

1. Park the machine on a level surface, move the speed-control lever to the NEUTRAL position, disengage the PTO, and engage the parking brake.
2. Shut off the engine, remove the key, and wait for all moving parts to stop before leaving the operating position.
3. Raise the seat.
4. Clean the debris and grass from the hydraulic pumps.
5. Lower the seat.



# Blade Maintenance

## Blade Safety

- Inspect the blades periodically for wear or damage.
- Use care when checking the blades. Wrap the blades or wear gloves, and use caution when servicing the blades. Only replace or sharpen the blades; never straighten or weld them.
- On multi-bladed machines, take care as rotating one blade can cause other blades to rotate.
- Replace worn or damaged blades and bolts in sets to preserve balance.

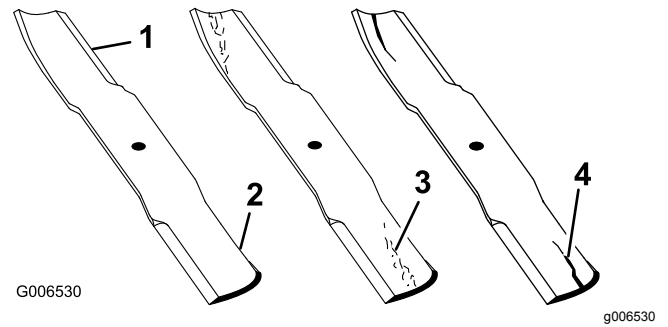

Figure 72

1. Cutting edge
2. Curved area
3. Wear/slot forming
4. Crack

## Servicing the Cutting Blades

To ensure a superior quality of cut, keep the blades sharp. For convenient sharpening and replacement, you may want to keep extra blades on hand.

## Before Inspecting or Servicing the Blades

1. Park the machine on a level surface, disengage the blade-control switch (PTO), and engage the parking brake.
2. Shut off the engine, remove the key, and disconnect the spark-plug wires from the spark plugs.

## Inspecting the Blades

**Service Interval:** Before each use or daily

1. Inspect the cutting edges (Figure 72).
2. If the edges are not sharp or have nicks, remove and sharpen the blade; refer to [Sharpening the Blades \(page 58\)](#).
3. Inspect the blades, especially in the curved area.
4. If you notice any cracks, wear, or a slot forming in this area, immediately install a new blade (Figure 72).

## Checking for Bent Blades

1. Rotate the blades until the ends face forward and backward.
2. Measure from a level surface to the cutting edge, position A, of the blades (Figure 73).

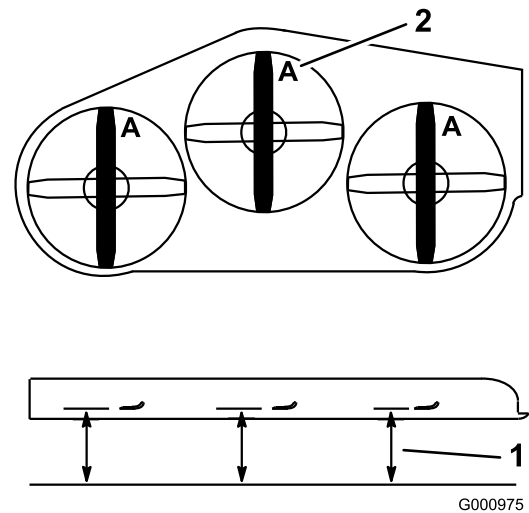

Figure 73

1. Measure here from blade to hard surface
2. Position A

3. Rotate the opposite ends of the blades forward.
4. Measure from a level surface to the cutting edge of the blades at the same position as in step 2 above.

**Note:** The difference between the dimensions obtained in steps 2 and 4 must not exceed 3 mm (1/8 inch).

**Note:** If this dimension exceeds 3 mm (1/8 inch), the blade is bent and must be replaced.

## Removing the Blades

Replace the blades if they hit a solid object, or if the blade is out of balance or bent.

**Note:** Make note of the red-colored blade position. From the normal user position, it is located on the right side.

1. Lift the mower deck and secure in the raised position. Refer to [Raising the Mower Deck into the Service Position](#) (page 16).
2. Hold the blade end using a rag or thickly padded glove.
3. Remove the blade, washer, and blade bolt that secures the blade and blade driver ([Figure 74](#)).

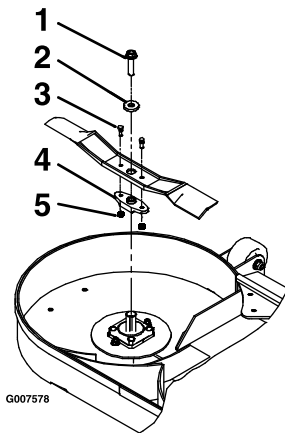

Figure 74

- |                |                 |
|----------------|-----------------|
| 1. Blade bolt  | 4. Blade driver |
| 2. Washer      | 5. Lock nuts    |
| 3. Shear bolts |                 |

4. Remove the blade driver from the existing blade ([Figure 74](#)).

## Sharpening the Blades

1. Use a file to sharpen the cutting edge at both ends of the blade ([Figure 75](#)).

**Note:** Maintain the original angle.

**Note:** The blade retains its balance if the same amount of material is removed from both cutting edges.

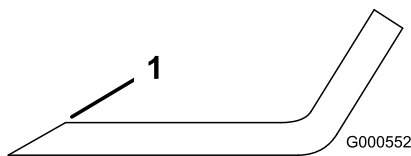

Figure 75

1. Sharpen at original angle.

2. Check the balance of the blade by putting it on a blade balancer ([Figure 76](#)).

**Note:** If the blade stays in a horizontal position, the blade is balanced and can be used.

**Note:** If the blade is not balanced, file some metal off the end of the sail area only ([Figure 75](#)).

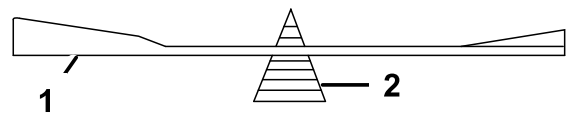

Figure 76

- |          |             |
|----------|-------------|
| 1. Blade | 2. Balancer |
|----------|-------------|

3. Repeat this procedure until the blade is balanced.

## Installing the Blades

**Note:** Ensure that you install the red-colored blade on the right side.

1. Install the blade driver to the new blades with the shear bolts and locknuts ([Figure 74](#)).
2. Torque the shear bolts to 922 to 1130 N·m (80 to 100 in·lb).

**Note:** Align the blade-driver flats with the flats on the shaft when installing the blade on the mower deck.

3. Install the blade, washer, and blade bolt to the spindle shaft ([Figure 74](#)).
4. Torque the blade bolt to 115 to 149 N·m (85-110 ft·lb).
5. Lower the mower deck to the operating position. Refer to [Lowering the Mower Deck to the Operating Position](#) (page 16).

### ⚠ WARNING

**Operating a mower deck with loose or weakened blade bolts can be dangerous. A loose or weakened blade bolt could allow a blade rotating at a high speed to come out from under the mower deck, causing serious injury or property damage.**

- Replace the blade bolt after striking a foreign object.
- Use only genuine Toro replacement parts.
- Do not lubricate the threads of the bolt or spindle before assembly.

# Leveling the Mower Deck

1. Park the machine on a level surface, move the speed-control lever to the NEUTRAL position, disengage the blade-control switch (PTO), and engage the parking brake.
2. Shut off the engine, remove the key, and wait for all moving parts to stop before leaving the operating position.
3. Check the tire pressure in the drive tires; refer to [Checking the Tire Pressure \(page 45\)](#).
4. Verify that all hairpin cotters are in the 7.62 cm (3 inch) mower-deck-height holes with the spacers under the hairpin cotters ([Figure 77](#)).

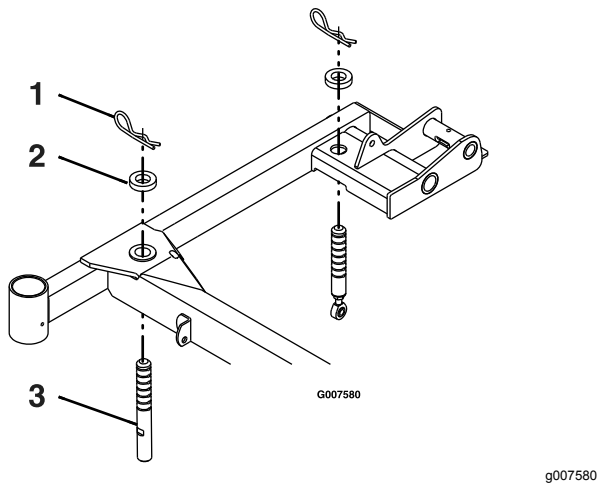

**Figure 77**  
Right Side Shown

- |                   |                           |
|-------------------|---------------------------|
| 1. Hairpin cotter | 3. Mower-deck support pin |
| 2. Spacer         |                           |

5. Shorten or lengthen each mower deck support pin to obtain blade tip height of 7.62 cm (3 inches) at the front of the deck and 8.26 cm (3 1/4 inches) at the rear of the deck ([Figure 77](#)).

**Note:** The front pins are thread into the mower deck and have a jam nut. The rear pins have a rod end threaded into them with a jam nut.

# Removing the Mower Deck

## **⚠ WARNING**

**Operating this machine without an approved Toro front mount attachment increases the possibility of operator entanglement in the drive wheels or forward tip-over. Entanglement or tip-over could cause serious injury or death.**

**When operating this machine without an approved Toro front mount attachment, observe the following:**

- Keep feet and clothing away from tires.
- Limit operation to minimum required to install a different front mount attachment.
- Minimize speed and use extreme caution.
- Only operate on a flat level surface.
- Do not operate up or down a trailer ramp.
- Avoid sudden acceleration or deceleration.

**Important:** Do not transport this machine without an approved Toro front mount attachment.

1. Park the machine on a level surface, move the speed-control lever to the NEUTRAL position, disengage the blade-control switch (PTO), and engage the parking brake.
2. Shut off the engine, remove the key, and wait for all moving parts to stop before leaving the operating position.
3. Raise mower deck up and latch with deck-locking pins. Refer to [Raising the Mower Deck into the Service Position \(page 16\)](#).
4. Remove the hairpin cotters and washers at the top of the deck-lift-assist spring on each side of the machine ([Figure 78](#)).

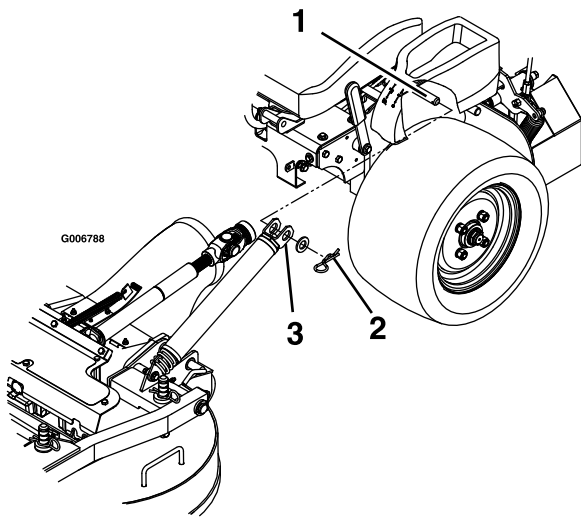

**Figure 78**

G006788

1. Spring anchor pin under console
2. Secure springs with a washer and hairpin cotter
3. Slide the spring onto the spring-anchor pin

- 
5. Remove the spring from the spring anchor. Repeat for other side of the machine.
  6. Unlatch the mower deck from the raised position and slowly lower the mower deck to ground; refer to [Lowering the Mower Deck to the Operating Position](#) (page 16).

**Note:** The mower deck becomes heavier when you remove the springs from the anchors. Lower the mower deck carefully.

7. Remove the lynch pins at the front of the push arms on both sides of the machine ([Figure 79](#)).

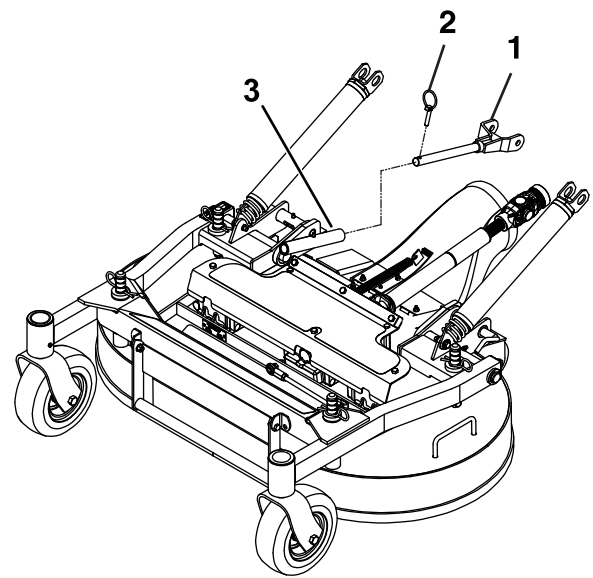
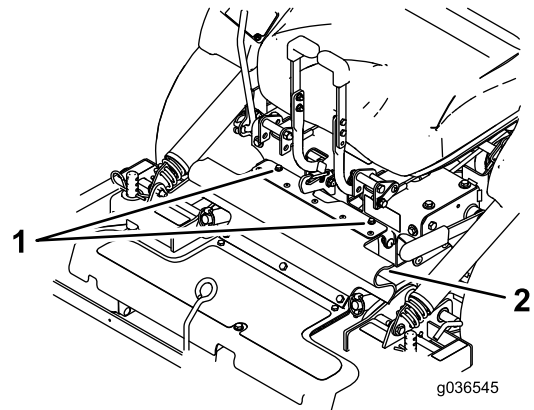

**Figure 79**

g233982

1. Push arm
2. Lynch pin
3. Push-arm tube

- 
8. Loosen the bolts attached to the rubber guard ([Figure 80](#)).

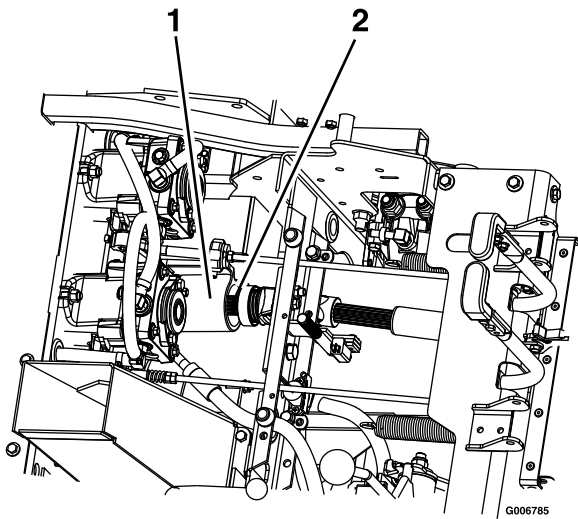

**Figure 80**

g036545

1. Bolts
2. Rubber guard

- 
9. Unlatch the seat and disconnect the drive shaft using the quick coupler at the jackshaft ([Figure 81](#)). Refer to [Unlatching the Seat](#) (page 19)



**Figure 81**

g006785

1. Jackshaft
2. Drive shaft

10. Pull the mower deck forward to remove it from the machine.

## Installing the Mower Deck

**Important:** Do not transport the machine without an approved Toro front mount attachment.

1. Park the machine on a level surface, move the speed-control lever to the NEUTRAL position, disengage the blade-control switch (PTO), and engage the parking brake.
2. Shut off the engine, remove the key, and wait for all moving parts to stop before leaving the operating position.
3. Roll the mower deck up to the machine with the discharge tube down, making sure that the deck springs are located above the drive wheel and below the console on each side.
4. Unlatch the seat and tilt the seat forward.
5. Install the drive shaft onto the jackshaft (Figure 81).
6. Align the mower-deck push-arm tubes to the machine push-arms and push the mower deck rearward.
7. Secure the push arms with the lynch pins on the left and right sides of the machine (Figure 79).
8. Align the upper portion of the rubber guard and secure it with the attached bolts (Figure 80).
9. Release the mower-deck-locking pins on each side, raise the mower deck to the service position and secure the deck latch onto the hook. Refer to Raising the Mower Deck into the Service Position (page 16).

10. Install the springs onto the spring anchor pins under the left and right consoles and secure it with a washer and hairpin cotter (Figure 78).
11. Unlatch the mower deck from the raised position, slowly lower the mower deck to ground, and lock the deck-locking pins on each side. Refer to Lowering the Mower Deck to the Operating Position (page 16).

## Adjusting the Locking-Pin Stop on the Mower Deck

1. Slide the mower-deck locking pins in on both sides and rotate to lock the deck in the operating position.
2. Loosen the jam nut and turn the stop screw clockwise until the locking pin is tight and cannot be rotated by hand (Figure 82).

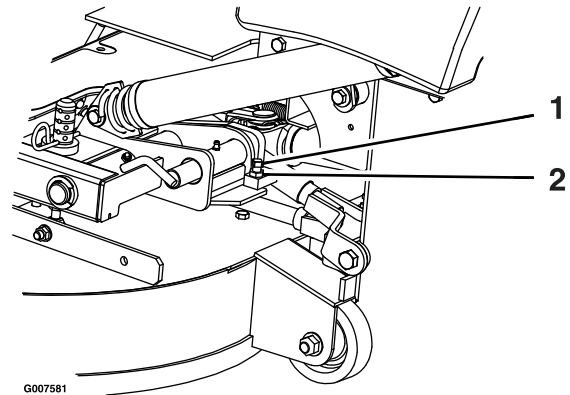

**Figure 82**

G007581

g007581

1. Rotate the stop screw clockwise until locking pin is tight, then back off 1/2 turn.
  2. Loosen the jam nut
- 
3. Loosen the stop screw counter clockwise 1/2 turn and tighten the jam nut.
  4. Test the locking pin to make sure it slides freely. Adjust it if necessary.

# Cleaning

## Cleaning under the Mower Deck

**Service Interval:** Before each use or daily

1. Park the machine on a level surface, move the speed-control lever to the NEUTRAL position, disengage the blade-control switch (PTO), and engage the parking brake.
2. Shut off the engine, remove the key, and wait for all moving parts to stop before leaving the operating position.
3. Lift the mower deck and secure it in the raised position. Refer to [Raising the Mower Deck into the Service Position \(page 16\)](#).
4. Clean any grass buildup under the mower deck.
5. Lower the mower deck to the operating position. Refer to [Lowering the Mower Deck to the Operating Position \(page 16\)](#).

## Cleaning Debris from the Machine

**Service Interval:** Before each use or daily

1. Park the machine on a level surface, move the speed-control lever to the NEUTRAL position, disengage the blade-control switch (PTO), and engage the parking brake.
2. Shut off the engine, remove the key, and wait for all moving parts to stop before leaving the operating position.
3. Clean off any oil, debris, or grass buildup on the machine, especially around the fuel tank, engine, and exhaust area.

## Disposing of Waste

Engine oil, batteries, hydraulic fluid, and engine coolant are pollutants to the environment. Dispose of these according to your state and local regulations.

# Storage

## Storage Safety

- Shut off the engine, remove the key, and wait for all moving parts to stop before you leave the operator's position. Allow the machine to cool before adjusting, servicing, cleaning, or storing it.
- Do not store the machine or fuel near flames or drain the fuel indoors or inside an enclosed trailer.
- Do not store the machine or fuel container where there is an open flame, spark, or pilot light, such as on a water heater or on other appliances.

## Cleaning and Storage

1. Disengage the blade-control switch (PTO), and engage the parking brake.
2. Shut off the engine, remove the key, and wait for all moving parts to stop before leaving the operating position.
3. Remove grass clippings, dirt, and grime from the external parts of the entire machine, especially the engine and hydraulic system. Clean dirt and chaff from the outside of the engine cylinder head fins and blower housing.

**Important:** You can wash the machine with mild detergent and water. Do not pressure wash the machine. Avoid excessive use of water, especially near the control panel, engine, hydraulic pumps, and motors.

4. Check the parking brake operation; refer to [Adjusting the Parking Brake \(page 47\)](#).
5. Service the air cleaner; refer to [Servicing the Air Cleaner \(page 36\)](#).
6. Grease the machine; refer to [Lubrication \(page 31\)](#).
7. Change the crankcase oil; refer to [Servicing the Engine Oil \(page 37\)](#).
8. Check the tire pressure; refer to [Checking the Tire Pressure \(page 45\)](#).
9. Change the hydraulic filters; refer to [Changing the Hydraulic Fluid and Filter \(page 56\)](#).
10. Charge the battery; refer to [Charging the Battery \(page 41\)](#).
11. Scrape any heavy buildup of grass and dirt from the underside of the mower, then wash the mower with a garden hose.

**Note:** Run the machine with the blade-control switch (PTO) engaged and the engine at high idle for 2 to 5 minutes after washing.

12. Check the condition of the blades; refer to [Servicing the Cutting Blades \(page 57\)](#).
  13. Prepare the machine for storage when non-use occurs over 30 days. Prepare the machine for storage as follows:
    - A. Add a petroleum-based stabilizer/conditioner to fuel in the tank. Follow mixing instructions from the stabilizer manufacturer. Do not use an alcohol-based stabilizer (ethanol or methanol).
- Note:** A fuel stabilizer/conditioner is most effective when mixed with fresh fuel and used at all times.
- B. Run the engine to distribute conditioned fuel through the fuel system for 5 minutes.
  - C. Shut off the engine, allow it to cool, and drain the fuel tank.
  - D. Start the engine and run it until it stops.
  - E. Dispose of fuel properly. Recycle the fuel according to local codes.

**Important:** Do not store fuel containing stabilizer/conditioner longer than the duration recommended by the fuel-stabilizer manufacturer.

14. Remove and check the condition of the spark plug(s); refer to [Servicing the Spark Plug \(page 39\)](#). With the spark plug(s) removed from the engine, pour 30 ml (2 tablespoons) of engine oil into the spark plug hole. Use the starter to crank the engine and distribute the oil inside the cylinder. Install the spark plug(s). Do not install the wire on the spark plug(s).
15. Check and tighten all bolts, nuts, and screws. Repair or replace any part that is damaged.
16. Paint all scratched or bare metal surfaces. Paint is available from your Authorized Service Dealer.
17. Store the machine in a clean, dry garage or storage area. Remove the key from the switch and keep it out of reach of children or other unauthorized users. Cover the machine to protect it and keep it clean.

# Troubleshooting

| Problem   | Possible Cause  | Corrective Action  |
|---|---|--|
| The starter does not crank.                                       | <ol style="list-style-type: none"> <li>1. The blade-control switch is engaged.</li> <li>2. The parking brake is disengaged.</li> <li>3. The motion-control levers are not in the NEUTRAL-LOCK position.</li> <li>4. You are not sitting in the operator's seat.</li> <li>5. The battery is dead.</li> <li>6. The electrical connections are corroded or loose.</li> <li>7. A fuse is blown.</li> <li>8. A relay or switch is damaged.</li> </ol>  | <ol style="list-style-type: none"> <li>1. Disengage the blade-control switch.</li> <li>2. Engage the parking brake.</li> <li>3. Move the motion-control levers outward to the NEUTRAL-LOCK position.</li> <li>4. Sit on the operator's seat.</li> <li>5. Charge the battery.</li> <li>6. Check the electrical connections for good contact.</li> <li>7. Replace the fuse.</li> <li>8. Contact an Authorized Service Dealer.</li> </ol>   |
| The engine does not start, starts hard, or fails to keep running. | <ol style="list-style-type: none"> <li>1. The fuel tank is empty.</li> <li>2. The fuel-shutoff valve is closed.</li> <li>3. The oil level in the crankcase is low.</li> <li>4. The throttle is not in the correct position.</li> <li>5. There is dirt in the fuel filter.</li> <li>6. There is dirt, water, or stale fuel in the fuel system.</li> <li>7. The air cleaner is dirty.</li> <li>8. The seat switch is not functioning properly.</li> <li>9. The electrical connections are corroded, loose, or damaged.</li> <li>10. The relay or switch is worn or damaged.</li> <li>11. The spark plug is fouled or improperly gapped.</li> <li>12. The spark-plug wire is not connected.</li> </ol> | <ol style="list-style-type: none"> <li>1. Fill the fuel tank.</li> <li>2. Open the fuel-shutoff valve.</li> <li>3. Add oil to the crankcase.</li> <li>4. Be sure that the throttle control is midway between the SLOW and FAST positions.</li> <li>5. Replace the fuel filter.</li> <li>6. Contact an Authorized Service Dealer.</li> <li>7. Clean or replace the air-cleaner element.</li> <li>8. Check the seat-switch indicator. Replace the seat if necessary.</li> <li>9. Check the electrical connections for good contact. Clean the connector terminals thoroughly with electrical-contact cleaner, apply dielectric grease, and make the appropriate connections.</li> <li>10. Contact an Authorized Service Dealer.</li> <li>11. Adjust or replace the spark plug.</li> <li>12. Check the spark-plug wire connection.</li> </ol> |
| The engine loses power.   | <ol style="list-style-type: none"> <li>1. The engine load is excessive.</li> <li>2. The air cleaner is dirty.</li> <li>3. The oil level in the crankcase is low.</li> <li>4. The cooling fins and the air passages above the engine are plugged.</li> <li>5. The vent hole in the fuel cap is plugged.</li> <li>6. There is dirt in the fuel filter.</li> <li>7. There is dirt, water, or stale fuel in the fuel system.</li> </ol>   | <ol style="list-style-type: none"> <li>1. Reduce the ground speed.</li> <li>2. Clean the air-cleaner element.</li> <li>3. Add oil to the crankcase.</li> <li>4. Remove the obstruction from the cooling fins and the air passages.</li> <li>5. Clean or replace the fuel cap.</li> <li>6. Replace the fuel filter.</li> <li>7. Contact an Authorized Service Dealer.</li> </ol>  |
| The engine overheats.   | <ol style="list-style-type: none"> <li>1. The engine load is excessive.</li> <li>2. The oil level in the crankcase is low.</li> <li>3. The cooling fins and air passages under the engine-blower housing are plugged.</li> <li>4. The air cleaner is dirty.</li> <li>5. Dirt, water, or stale fuel is in the fuel system.</li> </ol>  | <ol style="list-style-type: none"> <li>1. Reduce the ground speed.</li> <li>2. Add oil to the crankcase.</li> <li>3. Remove the obstruction from the cooling fins and air passages.</li> <li>4. Clean or replace the air-cleaner element.</li> <li>5. Contact an Authorized Service Dealer</li> </ol>  |



| <b>Problem</b>   | <b>Possible Cause</b>   | <b>Corrective Action</b>   |
|--|---|--|
| The machine pulls to the left or right (with the motion-control levers fully forward). | <ol style="list-style-type: none"> <li>1. The tracking needs adjustment</li> <li>2. The tire pressure in the drive tires is not correct.</li> </ol>   | <ol style="list-style-type: none"> <li>1. Adjust the tracking.</li> <li>2. Adjust the tire pressure in the drive tires.</li> </ol>   |
| The machine does not drive.  | <ol style="list-style-type: none"> <li>1. The bypass valves are not closed tight.</li> <li>2. The pump belt is worn, loose, or broken.</li> <li>3. The pump belt is off a pulley.</li> <li>4. The idler spring is broken or missing.</li> <li>5. The hydraulic fluid level is low or too hot.</li> </ol>  | <ol style="list-style-type: none"> <li>1. Tighten the bypass valves.</li> <li>2. Change the belt.</li> <li>3. Change the belt.</li> <li>4. Replace the spring.</li> <li>5. Add hydraulic fluid to the reservoirs or let it cool down.</li> </ol>   |
| The machine vibrates abnormally.   | <ol style="list-style-type: none"> <li>1. The cutting blade(s) is/are bent or unbalanced.</li> <li>2. The blade mounting bolt is loose.</li> <li>3. The engine mounting bolts are loose.</li> <li>4. The engine pulley, idler pulley, or blade pulley is loose.</li> <li>5. The engine pulley is damaged.</li> <li>6. The blade spindle is bent.</li> <li>7. The motor mount is loose or worn.</li> </ol> | <ol style="list-style-type: none"> <li>1. Install new cutting blade(s).</li> <li>2. Tighten the blade mounting bolt.</li> <li>3. Tighten the engine mounting bolts.</li> <li>4. Tighten the appropriate pulley.</li> <li>5. Contact an Authorized Service Dealer.</li> <li>6. Contact an Authorized Service Dealer.</li> <li>7. Contact an Authorized Service Dealer.</li> </ol>   |
| The cutting height is uneven.  | <ol style="list-style-type: none"> <li>1. The blade(s) is not sharp.</li> <li>2. A cutting blade(s) is/are bent.</li> <li>3. The mower is not level.</li> <li>4. The underside of the mower deck is dirty.</li> <li>5. The tire pressure is incorrect.</li> <li>6. The spacers are in the wrong location.</li> <li>7. The tips of adjacent blades are at an uneven cutting height.</li> </ol>             | <ol style="list-style-type: none"> <li>1. Sharpen the blade(s).</li> <li>2. Install a new cutting blade(s).</li> <li>3. Level the mower from side-to-side and front-to-rear.</li> <li>4. Clean the underside of the mower deck.</li> <li>5. Adjust the tire pressure.</li> <li>6. Position the spacers under hairpin cotters.</li> <li>7. Replace the blades or spindles and/or check for damage to mower deck.</li> </ol> |
| The blades do not rotate.  | <ol style="list-style-type: none"> <li>1. The PTO belt is worn, loose, or broken.</li> <li>2. The PTO shaft is not connected.</li> <li>3. The PTO belt is off the pulley.</li> </ol>  | <ol style="list-style-type: none"> <li>1. Check the belt tension or replace belt</li> <li>2. Connect the PTO shaft.</li> <li>3. Check the belt for damage. Install the belt and check adjusting shafts and belt guides for correct position.</li> </ol>  |

# Schematics

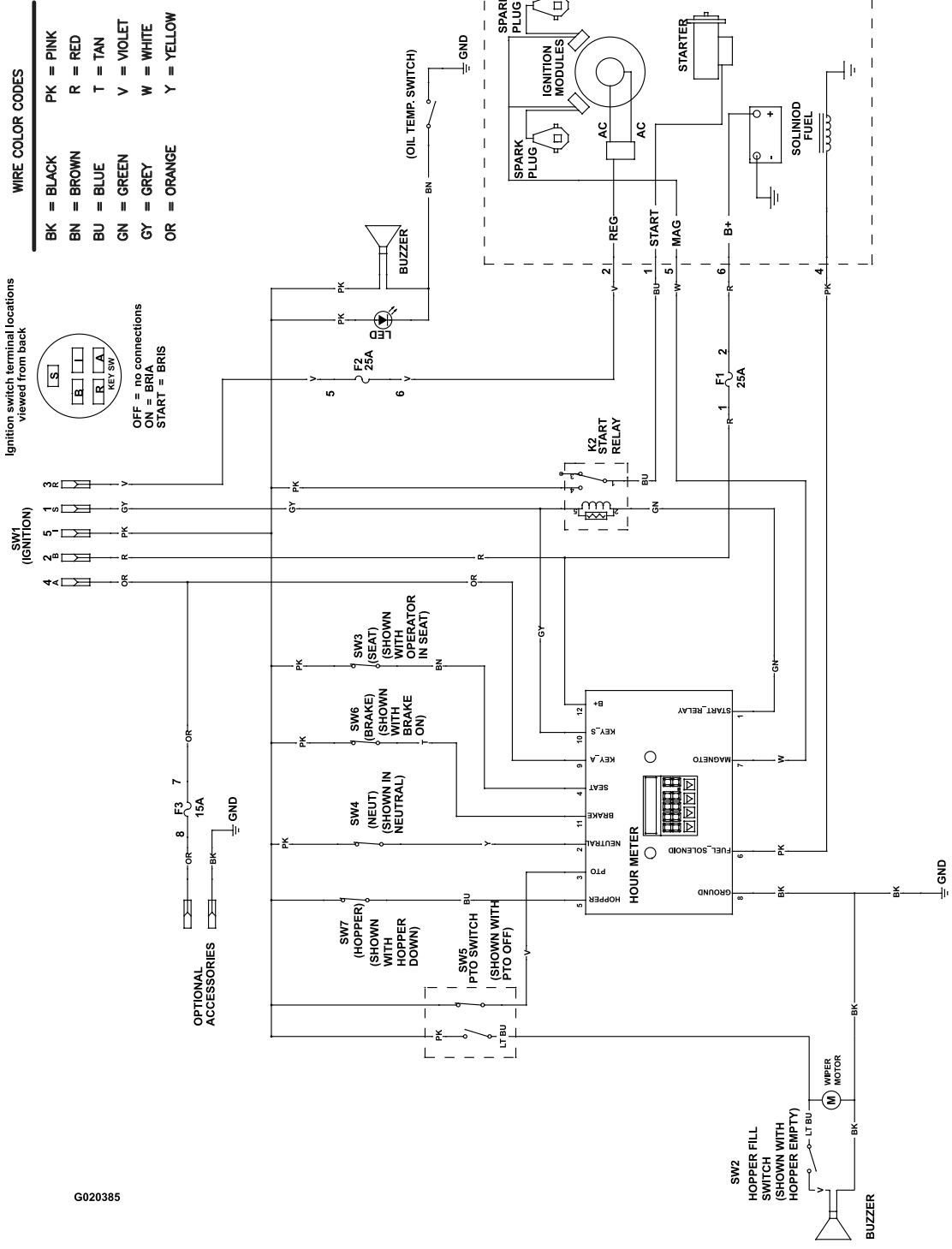

G020385

Wire Diagram (Rev. A)

g020385

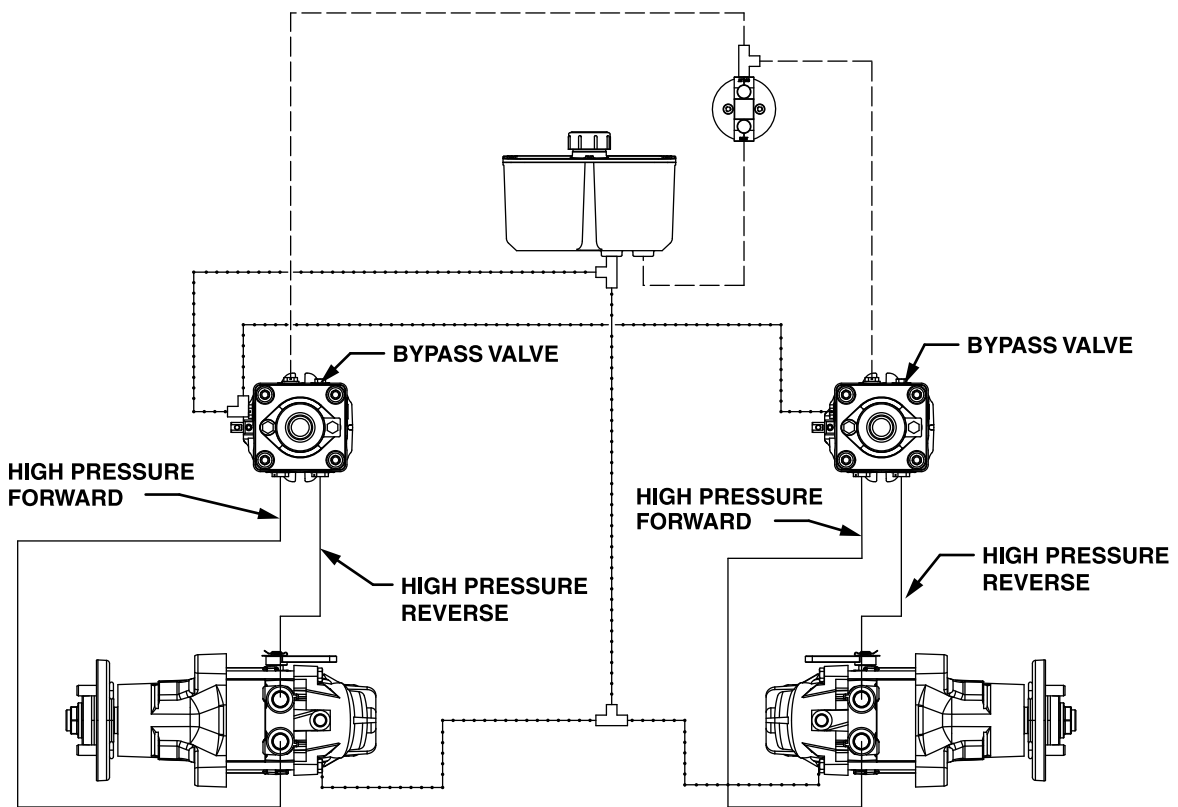

G020536

- HIGH PRESSURE
- - - - CHARGE PUMP
- · - · - CASE DRAIN

Hydraulic Diagram (Rev. A)

g020536

## EEA/UK Privacy Notice

### **Toro's Use of Your Personal Information**

The Toro Company ("Toro") respects your privacy. When you purchase our products, we may collect certain personal information about you, either directly from you or through your local Toro company or dealer. Toro uses this information to fulfil contractual obligations - such as to register your warranty, process your warranty claim or to contact you in the event of a product recall - and for legitimate business purposes - such as to gauge customer satisfaction, improve our products or provide you with product information which may be of interest. Toro may share your information with our subsidiaries, affiliates, dealers or other business partners in connection these activities. We may also disclose personal information when required by law or in connection with the sale, purchase or merger of a business. We will never sell your personal information to any other company for marketing purposes.

### **Retention of your Personal Information**

Toro will keep your personal information as long as it is relevant for the above purposes and in accordance with legal requirements. For more information about applicable retention periods please contact [legal@toro.com](mailto:legal@toro.com).

### **Toro's Commitment to Security**

Your personal information may be processed in the US or another country which may have less strict data protection laws than your country of residence. Whenever we transfer your information outside of your country of residence, we will take legally required steps to ensure that appropriate safeguards are in place to protect your information and to make sure it is treated securely.

### **Access and Correction**

You may have the right to correct or review your personal data, or object to or restrict the processing of your data. To do so, please contact us by email at [legal@toro.com](mailto:legal@toro.com). If you have concerns about the way in which Toro has handled your information, we encourage you to raise this directly with us. Please note that European residents have the right to complain to your Data Protection Authority.