



# Assist Bar Kit

## TimeCutter® Riding Mower

Model No. 140-2052

### Installation Instructions

# Installation

## Loose Parts

Use the chart below to verify that all parts have been shipped.

Description	Qty.	Use
No parts required	–	Prepare the machine.
Assist handle	1	Assemble the assist handle.
Pin (grooved)	1	
Washer—6 x 19 mm (3/8 x 3/4 inch)	1	
Retaining ring	1	
Support spacer	1	Install the support spacer.
Assist handle bracket	1	Install the assist handle bracket.
Capscrew (1/4 x 4 inches)	1	
Washer (1/4 x 5/8 inch)	1	
Flange-head screw (thread forming—5/16 x 3/4 inch)	1	
Flange locknut (1/4 inch)	1	
Pin (grooved)	1	Install the assist handle.
Washer—6 x 19 mm (3/8 x 3/4 inch)	1	
Retaining ring	1	
No parts required	–	Install the rail guard.
Handle retainer	1	Install the handle retainer.
Shoulder screw (1/4 x 1-5/8 inch)	1	

## Preparing the Machine

1. Moving the blade-control switch to the OFF position.
2. Park the machine on a level surface.
3. Move the motion control levers to the PARK position.
4. Move the throttle control to the FAST position.
5. Shut off the engine.

## Assembling the Assist Handle

1. Assemble the grooved pin through the hole in the assist handle as shown in [Figure 1](#).



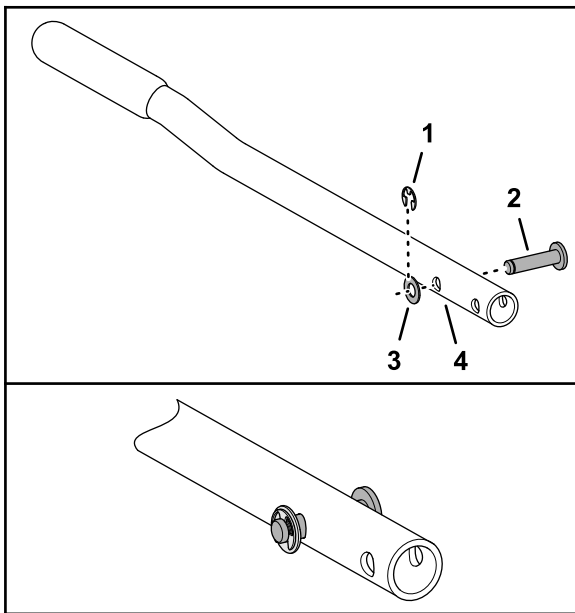
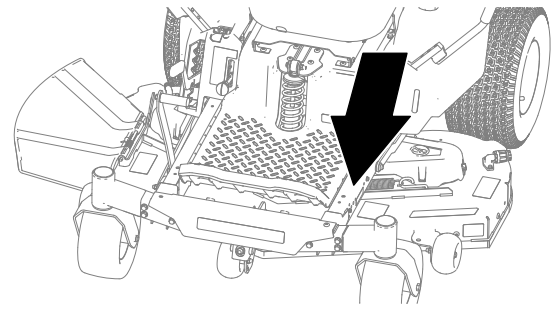

**Figure 1**

g307205

- |                   |                                      |
|-------------------|--------------------------------------|
| 1. Retaining ring | 3. Washer—6 x 19 mm (3/8 x 3/4 inch) |
| 2. Pin (grooved)  | 4. Assist handle                     |

- Secure the pin to the handle with the washer—6 x 19 mm (3/8 x 3/4 inch) and the retaining ring (Figure 1).



g307248

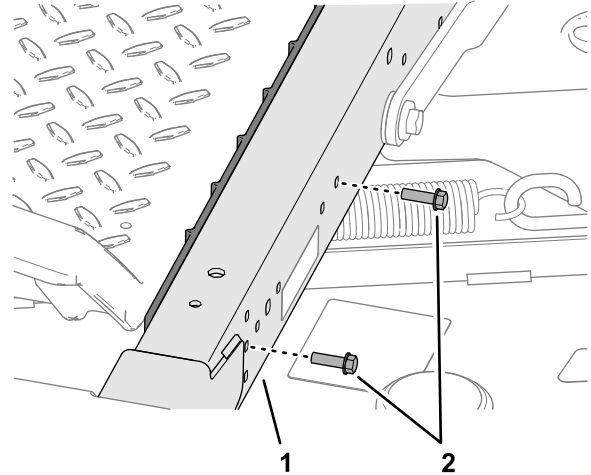

g307250

**Figure 2**

- |                    |                               |
|--------------------|-------------------------------|
| 1. Left frame rail | 2. Capscrews (1/4 x 5/8 inch) |
|--------------------|-------------------------------|

- At the bottom of the platform, slide the rail guard forward, rotate the bottom of it inward, and remove the guard from the machine (Figure 3).

## Installing the Support Spacer

### Removing the Rail Guard

#### Machines with the MyRide Suspension System

- At the left frame rail, remove the 2 capscrews (1/4 x 5/8 inch) that secure the rail guard to the frame rail (Figure 2).

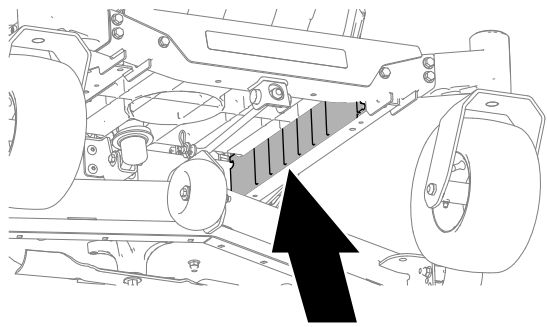

g307206

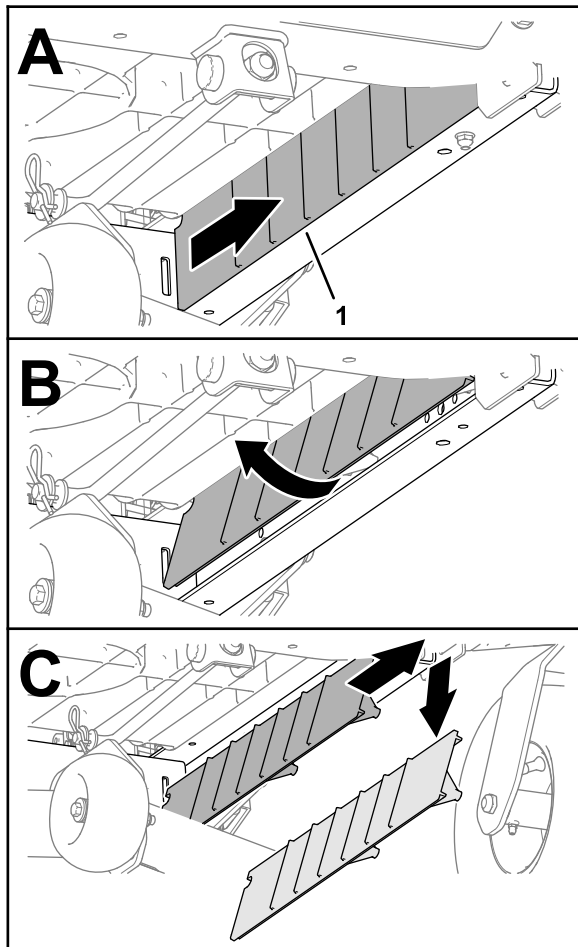

g307210

**Figure 3**

1. Rail guard

## Removing the Floor Pan Screw

### Machines without MyRide Suspension System

Remove the forward button-head screw that secures the flange of the floor pan to the left frame rail ([Figure 4](#)).

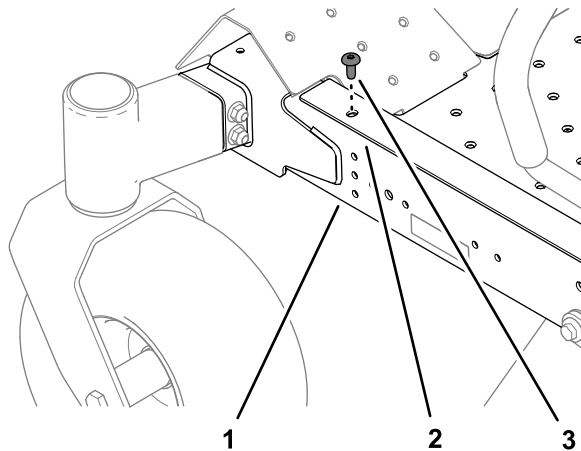

g307223

**Figure 4**

1. Left frame rail
2. Flange (floor pan)
3. Button-head screw

## Inserting the Support Spacer into the Frame Rail

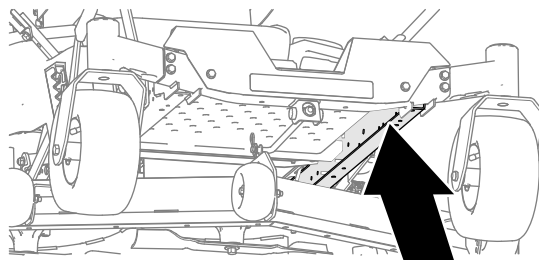

g307222

**Figure 5**

1. Insert the support spacer to the frame rail as shown in [Figure 6](#) or [Figure 7](#).

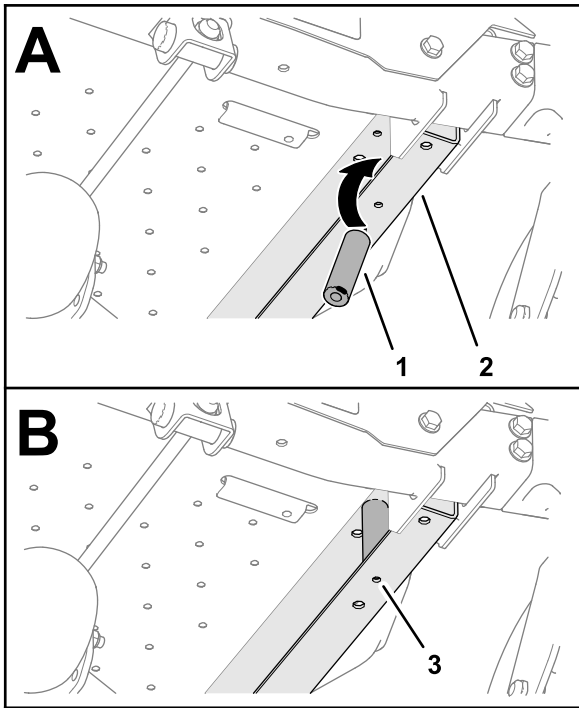

g307221

**Figure 6**

Machines without MyRide Suspension System

- |                    |                               |
|--------------------|-------------------------------|
| 1. Support spacer  | 3. Frame hole 6 mm (1/4 inch) |
| 2. Left frame rail |                               |

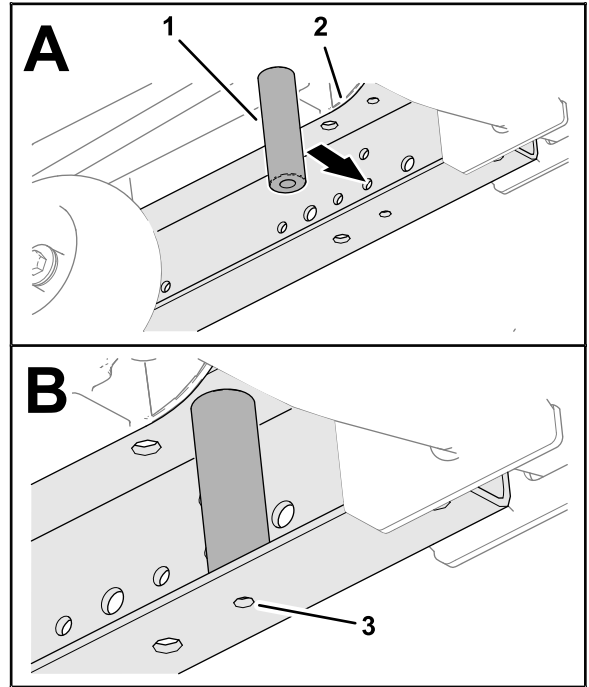

g307207

**Figure 7**

Machines with the MyRide Suspension System

- |                    |                               |
|--------------------|-------------------------------|
| 1. Left frame rail | 3. Frame hole 6 mm (1/4 inch) |
| 2. Support spacer  |                               |

- 
2. Align the hole in the space with the 6 mm (1/4 inch) hole in the frame.

# Installing the Assist Handle Bracket

1. Assemble the assist handle bracket to the left frame rail with the capscrew (1/4 x 4 inches) and washer (1/4 x 5/8 inch) as shown in [Figure 8](#).

**Note:** Ensure that the capscrew passes through both holes in the frame rail and the hole in the support spacer.

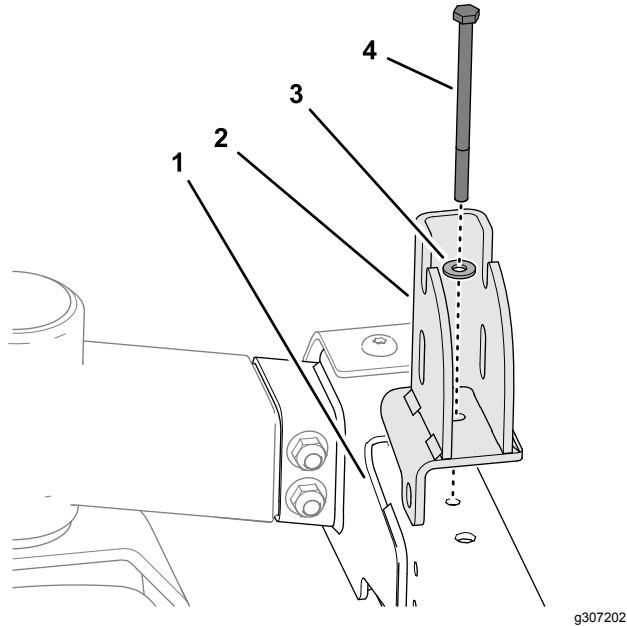

**Figure 8**

- |                          |                              |
|--------------------------|------------------------------|
| 1. Left frame rail       | 3. Washer (1/4 x 5/8 inch)   |
| 2. Assist handle bracket | 4. Capscrew (1/4 x 4 inches) |

2. Secure the bracket to the side of the left frame rail ([Figure 9](#)) with a flange-head screw ( 5/16 x 3/4 inch).

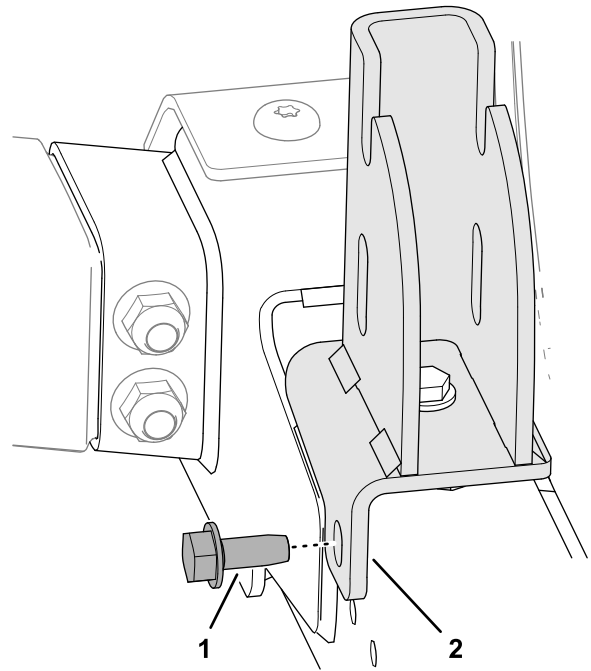

**Figure 9**

- |   |                          |
|---|--------------------------|
| 1. Flange-head screw (thread forming—5/16 x 3/4 inch) | 2. Assist handle bracket |
|---|--------------------------|

3. Thread the flange locknut (1/4 inch) onto the capscrew (1/4 x 4 inches), and tighten the nut ([Figure 10](#)).

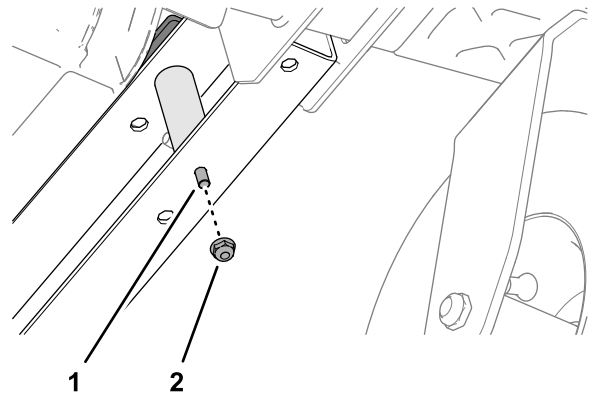
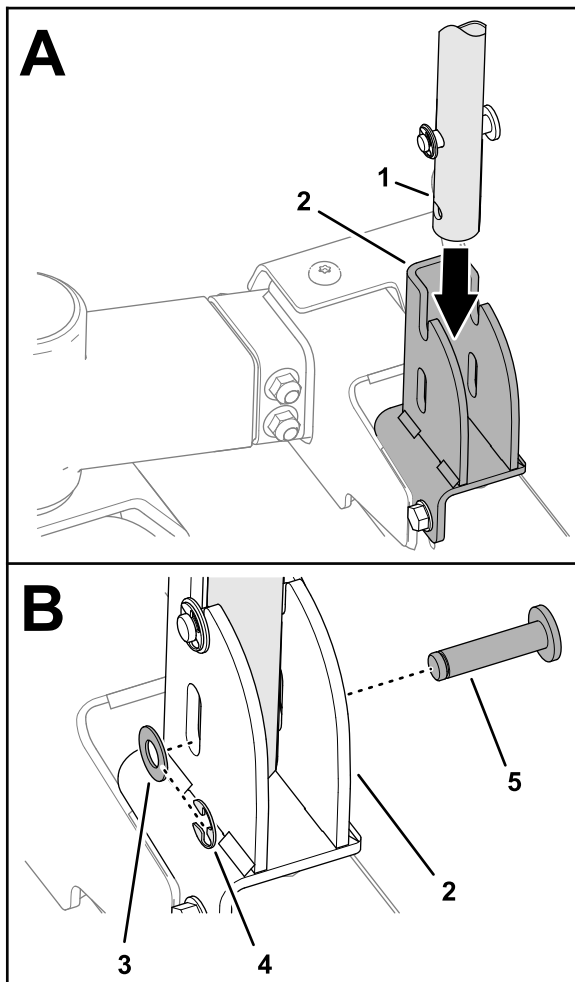

**Figure 10**

- |                              |                              |
|------------------------------|------------------------------|
| 1. Capscrew (1/4 x 4 inches) | 2. Flange locknut (1/4 inch) |
|------------------------------|------------------------------|

# Installing the Assist Handle

1. Align the lower hole in the assist handle with the closed slot in the assist handle bracket as shown in [Figure 11](#).



**Figure 11**

g307203

- |                                      |                   |
|--------------------------------------|-------------------|
| 1. Assist handle                     | 4. Retaining Ring |
| 2. Assist handle bracket             | 5. Pin (grooved)  |
| 3. Washer—6 x 19 mm (3/8 x 3/4 inch) |                   |

2. Assemble the grooved pin through the slot in the bracket and the hole in the assist handle ([Figure 11](#)).
3. Secure the pin to the bracket and handle with the washer—6 x 19 mm (3/8 x 3/4 inch) and the retaining ring ([Figure 11](#)).

# Installing the Rail Guard

## Machines with MyRide Suspension System

1. At the bottom of the machine, align the rail guard to the left frame rail, rotate it toward the frame rail, and slide the guard rearward until the tab is fully seated in the slot in the cross brace of the frame ([Figure 12](#)).

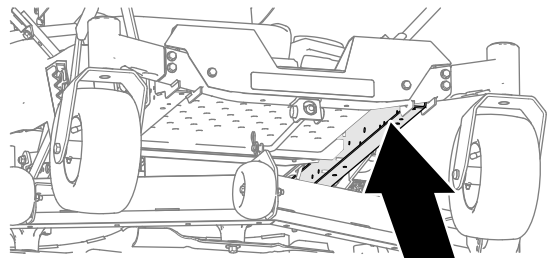

g307222

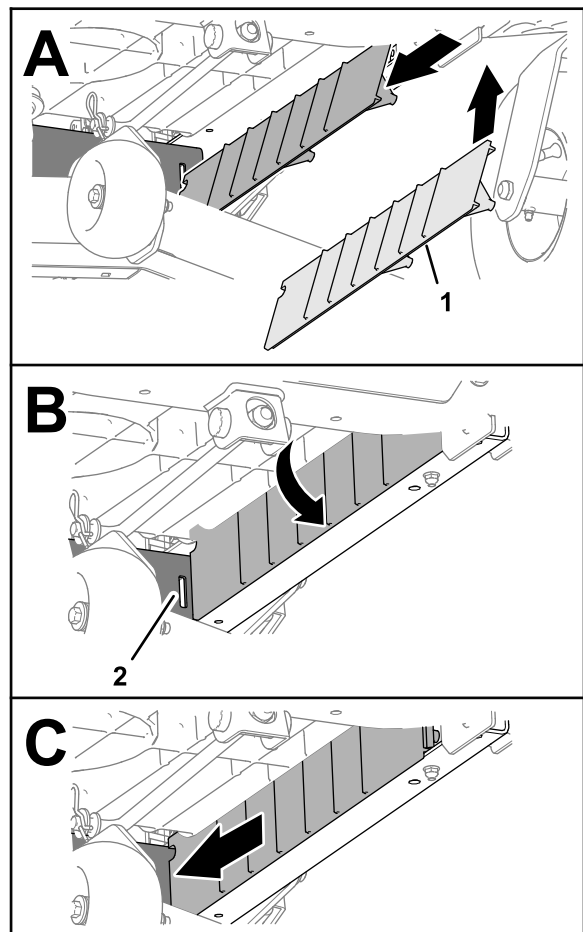
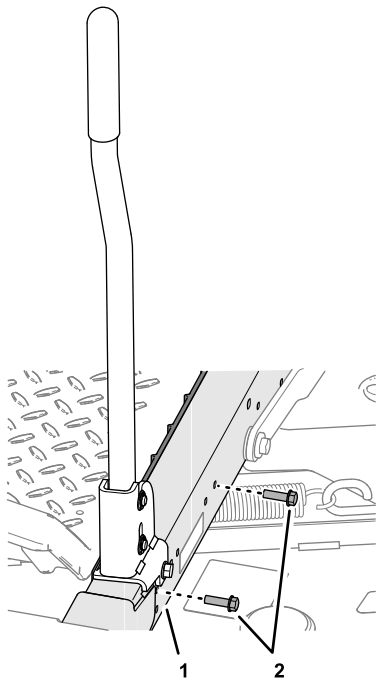

**Figure 12**

g307204

- |               |                             |
|---------------|-----------------------------|
| 1. Rail guard | 2. Slot (frame cross brace) |
|---------------|-----------------------------|

2. Secure the rail guard to the left frame rail ([Figure 13](#)) with the 2 capscrews (1/4 x 5/8 inch).



**Figure 13**

g307249

1. Left frame rail
2. Capscrews (1/4 x 5/8 inch)

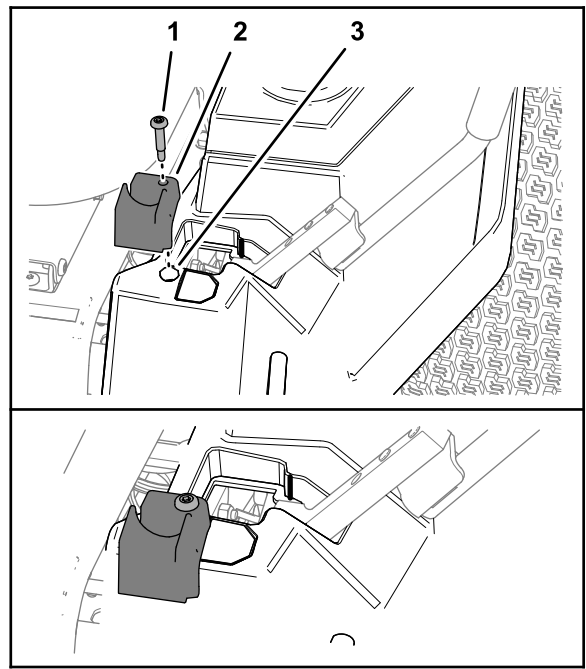

**Figure 15**

g307265

1. Shoulder screw (1/4 x 1-5/8 inches)
  2. Retainer
  3. Pod
3. Secure the retainer to the pod (Figure 15) with the shoulder screw (1/4 x 1-5/8 inches).

## Installing the Handle Retainer

1. Remove the shoulder screw (1/4 x 5/16 inch) that secures the left pod the machine (Figure 14).

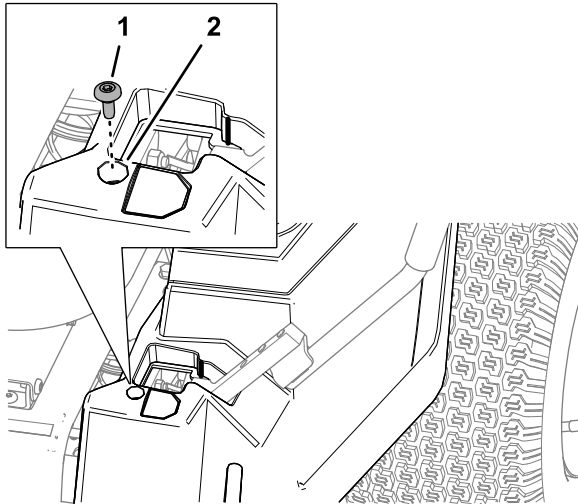

**Figure 14**

g307266

1. Shoulder screw (1/4 x 5/16 inch)
2. Left pod

2. Align the handle retainer to the left pod as shown in Figure 15.

## Operation

### Extending the Assist Handle

**Note:** Rotate the assist handle to the extend position when the machine is stationary and you are getting on and off the machine.

1. Rotate the assist handle as shown in Figure 16.

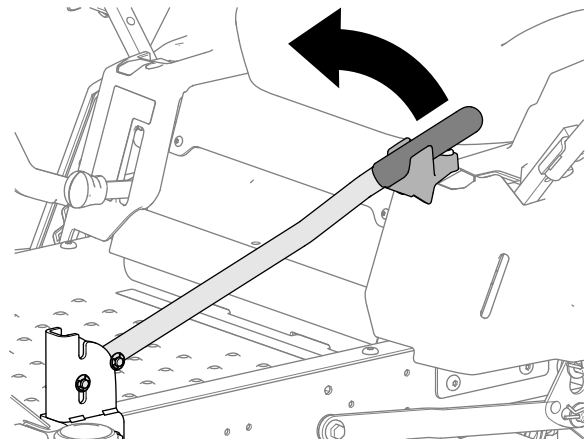

**Figure 16**

g307302

2. Lower the assist handle as shown in [Figure 17](#).

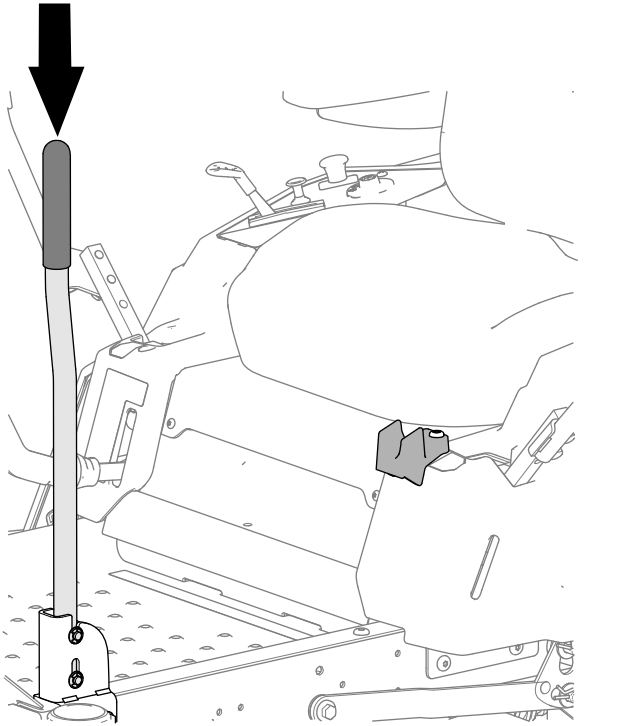

**Figure 17**

g307298

## Stowing the Assist Handle

**Important:** Rotate the assist handle to the stow position when operating the machine.

1. Lift the assist handle as show in [Figure 19](#).

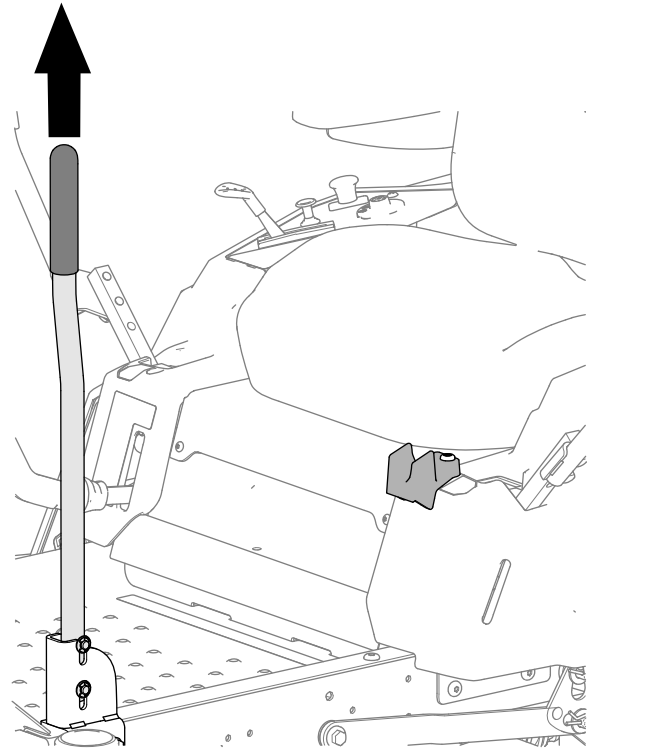

**Figure 19**

g307301

3. Ensure that the is fully seated in the bracket slots as shown in [Figure 18](#).

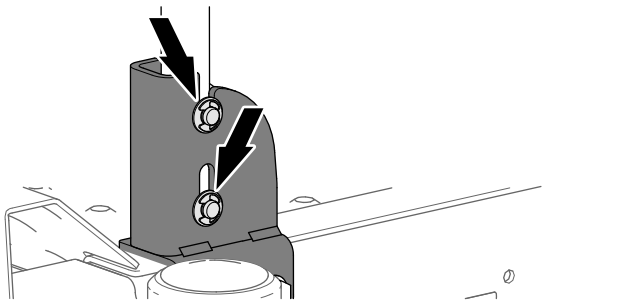

**Figure 18**

g307300

2. Fully rotate the assist handle as shown in [Figure 20](#).

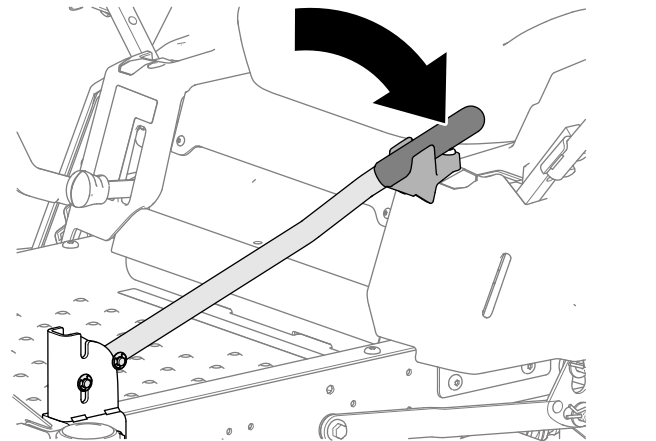

**Figure 20**

g307299