



LED Work Light Kit

Groundsmaster® 3200 or 3300 Series Traction Unit

Model No. 31993

Installation Instructions

Installation

Loose Parts

Use the chart below to verify that all parts have been shipped.

Procedure	Description	Qty.	Use
1	Work light	4	Prepare for installation.
	Work light mount	4	
	Hex-head screw	4	
	Washer	8	
	Lock washer	4	
	Nut	4	
2	Work light wire harness	1	Install the work lights.
	Work light assembly	4	

1

Preparing for Installation

Parts needed for this procedure:

4	Work light
4	Work light mount
4	Hex-head screw
8	Washer
4	Lock washer
4	Nut

Procedure

Important: This kit requires the installation of a cab and either a Road Light Kit or the Light Adapter Kit before installing the LED Work Light Kit. Contact your authorized Toro distributor for more information.

Note: Retain all removed parts for later installation unless otherwise noted.

1. Park the machine on a level surface, lower the attachment, shut off the engine, engage the parking brake, and remove the key.
2. Disconnect the negative (-) battery cable from the battery; refer to the electrical system maintenance section of the traction unit *Operator's Manual*.
3. Remove the cab roof as shown in [Figure 1](#).

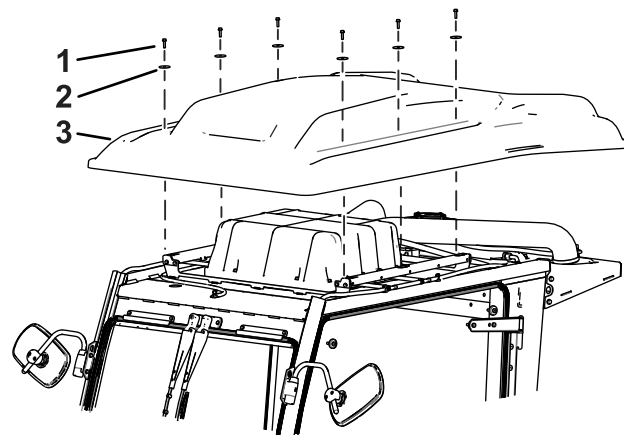

Figure 1

g302035

1. Bolt
2. Washer
3. Cab roof



- Remove the small mounting brackets from the work lights [Figure 2](#).

Note: You may discard the small mounting brackets.

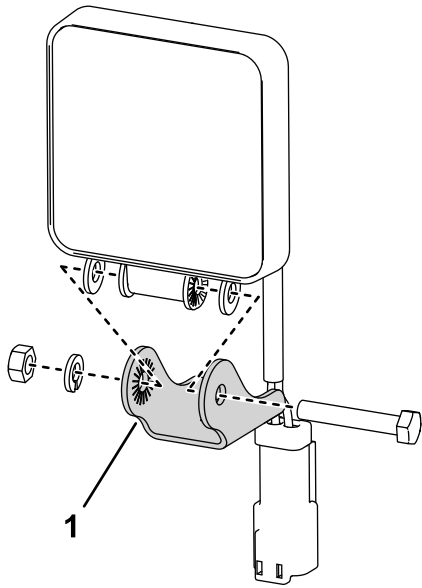

Figure 2

g304596

- Small mounting bracket

- Assemble the work lights as shown in [Figure 3](#).

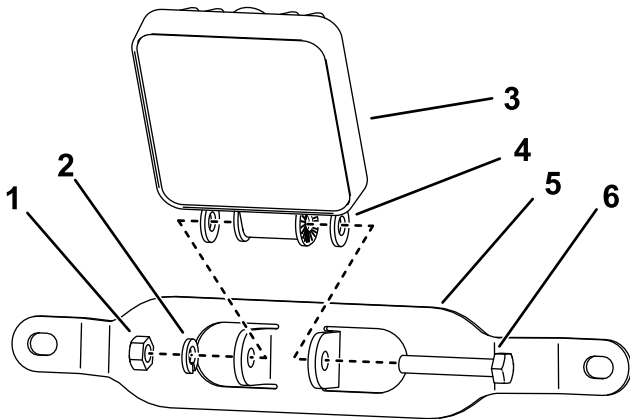

Figure 3

g303439

- | | |
|----------------|---------------------|
| 1. Nut | 4. Washer |
| 2. Lock washer | 5. Work light mount |
| 3. Work light | 6. Bolt |

2

Installing the Work Lights

Parts needed for this procedure:

1	Work light wire harness
4	Work light assembly

Procedure

- On top of the cab, locate the loose 2-pin socket on the cab wire harness and connect the work light harness power connector ([Figure 4](#)).

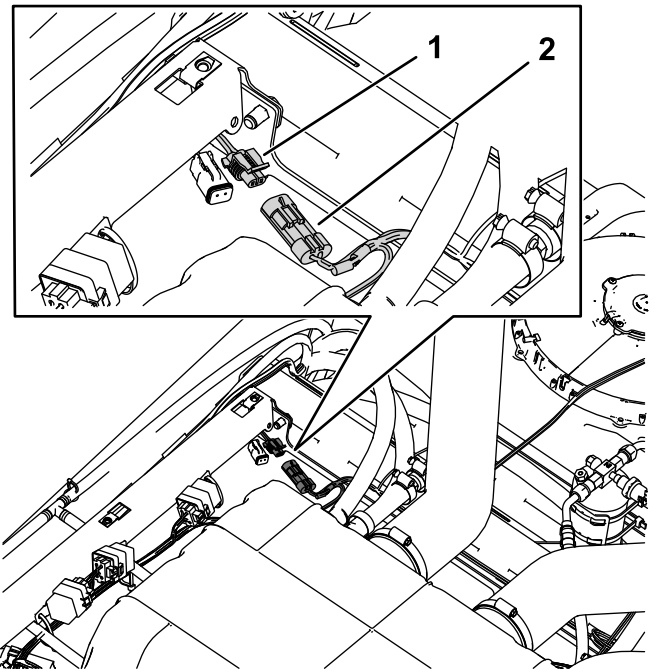
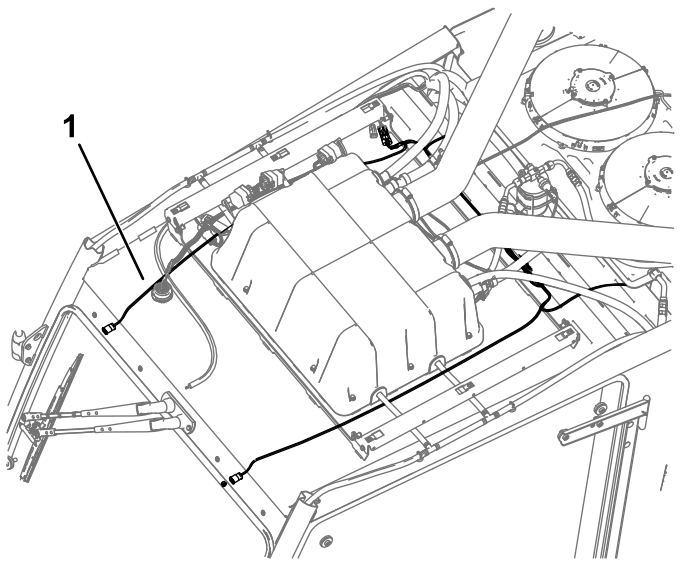

Figure 4

g303391

- | | |
|-----------------|---------------------------------------|
| 1. 2-pin socket | 2. Work light harness power connector |
|-----------------|---------------------------------------|
- Route the work light harness and connectors as shown in [Figure 5](#).



g303416

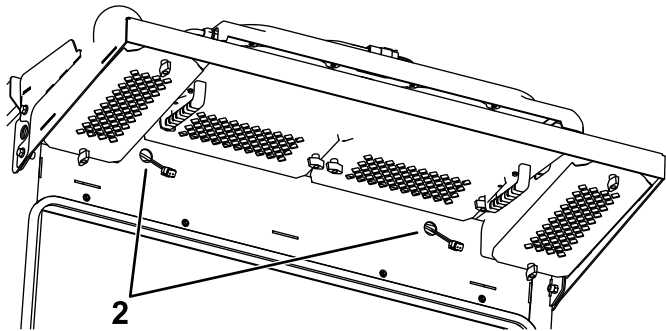

g303427

Figure 5

1. Work light harness
2. Route the rear connectors through these holes.

3. Remove the retainer brackets from the top of the front windshield ([Figure 6](#)).

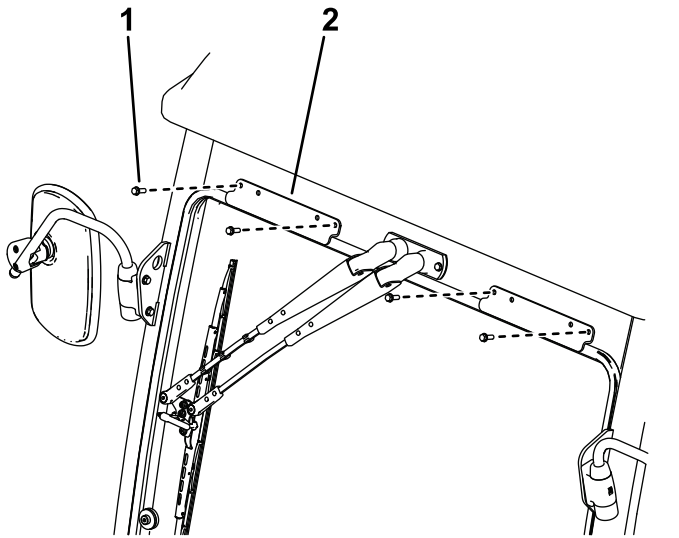

g303359

Figure 6

1. Screw
2. Retainer bracket

4. Connect the work light assemblies and retainer brackets to the front of the machine as shown in [Figure 7](#) using the screws and retainer brackets removed in step 3.

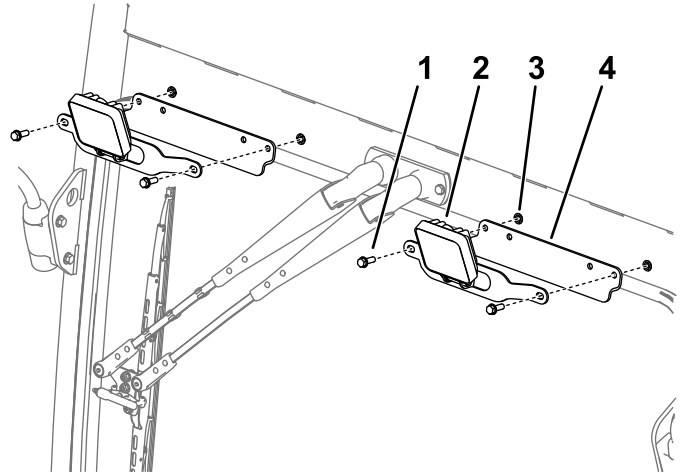

g303440

Figure 7

1. Screw
2. Work light assembly
3. Install a work light assembly in each retainer bracket location.
4. Retainer bracket

5. Remove the retainer brackets from the top of the rear windshield ([Figure 8](#)).

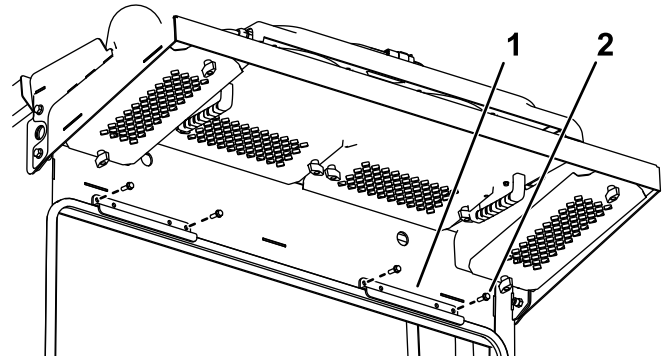

g303360

Figure 8

1. Retainer bracket
2. Screw

6. Connect the work light assemblies and retainer brackets to the rear of the machine as shown in [Figure 7](#) using the screws and retainer brackets removed in step 5.

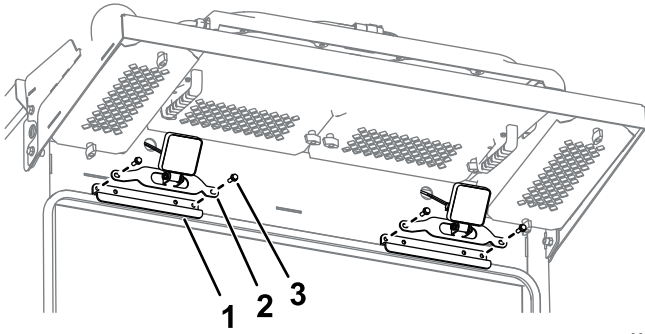

Figure 9

g304598

1. Retainer bracket
2. Work light assembly
3. Screw

7. Connect the work light connectors to the work lights ([Figure 10](#)).

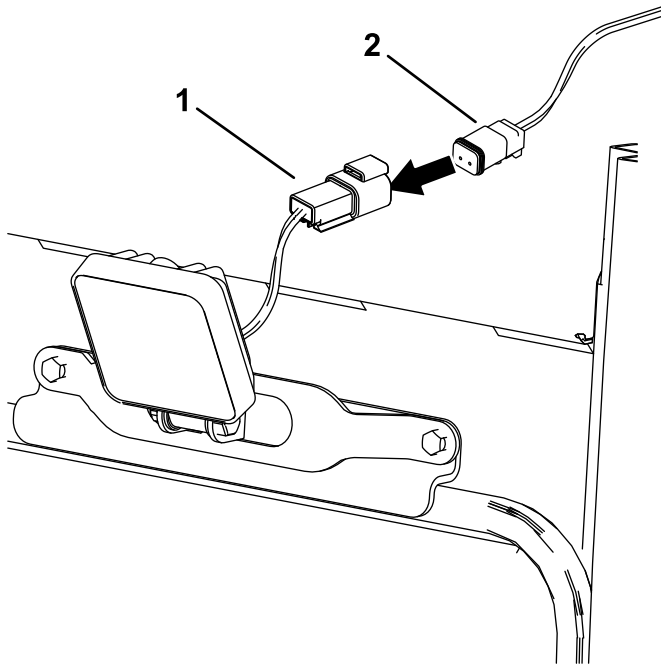

Figure 10

g303441

1. Plug on work light
2. Socket on work light harness

8. Install the cab roof as shown in [1 Preparing for Installation \(page 1\)](#).
9. Connect the battery; refer to the electrical system maintenance section of the traction unit *Operator's Manual*.

Operation

Using the Lights

To illuminate the work lights, press the light switch on the steering column switch mount; refer to your Road Light Kit or Light Adapter Kit *Installation Instructions*.