

# Weight Kit

## Zero-Turn Radius Riding Mower

Model No. 140-5084

### Installation Instructions

# Installation

## Loose Parts

Use the chart below to verify that all parts have been shipped.

Description	Qty.	Use
No parts required	–	Prepare the machine.
Weight tray	1	Install the weight kit.
Left weight-tray mount	1	
Right weight-tray mount	1	
Suitcase weight—16 kg (35 lb)	1	
Retaining rod	1	
Bolt (3/8 x 1-1/4 inches)	2	
Flange nut (3/8 inch)	4	
Carriage bolt (3/8 x 1 inch)	2	
Self-tapping bolt (5/16 x 3/4 inch)	2	

## Preparing the Machine

1. Park the machine on a level surface.
2. Disengage the blade-control switch.
3. Engage the parking brake.
4. Move the motion-control levers outward to the NEUTRAL-LOCK position.
5. Shut off the engine and remove the key.



# Installing the Weight Kit

## ⚠ CAUTION

The bagger changes the weight distribution of the machine. Operating the machine without the front weights may cause an unstable condition, which could result in a loss of control.

Ensure that the front weights are properly installed before operating the machine with the bagger attachment.

1. Remove the existing bolt and nut from the left and right side of the platform where you will install the weight-tray mounts.
2. Use the 2 self-tapping bolts (5/16 x 3/4 inch), 2 bolts (3/8 x 1-1/4 inches), and flange nuts (3/8 inch) to secure the left and right weight-tray mounts to the machine (Figure 1).

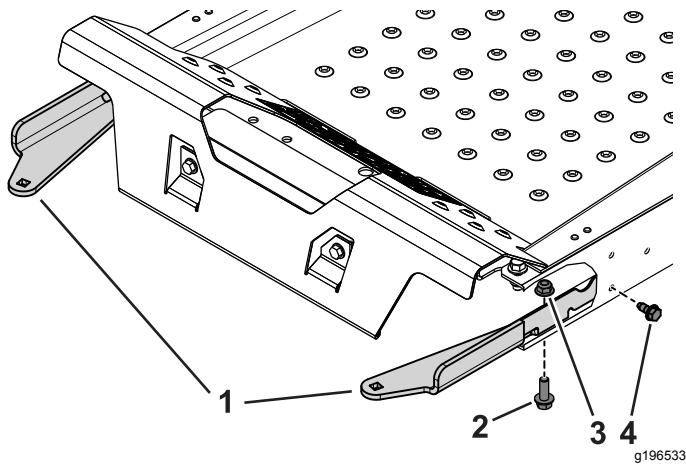

**Figure 1**  
Cutaway view

- |                              |                                        |
|------------------------------|----------------------------------------|
| 1. Weight-tray mounts        | 3. Flange nut (3/8 inch)               |
| 2. Bolt (3/8 x 1-1/4 inches) | 4. Self-tapping bolt (5/16 x 3/4 inch) |

3. Use the 2 carriage bolts (3/8 x 1 inch) and flange nuts to secure the weight tray to the mounts (Figure 2).

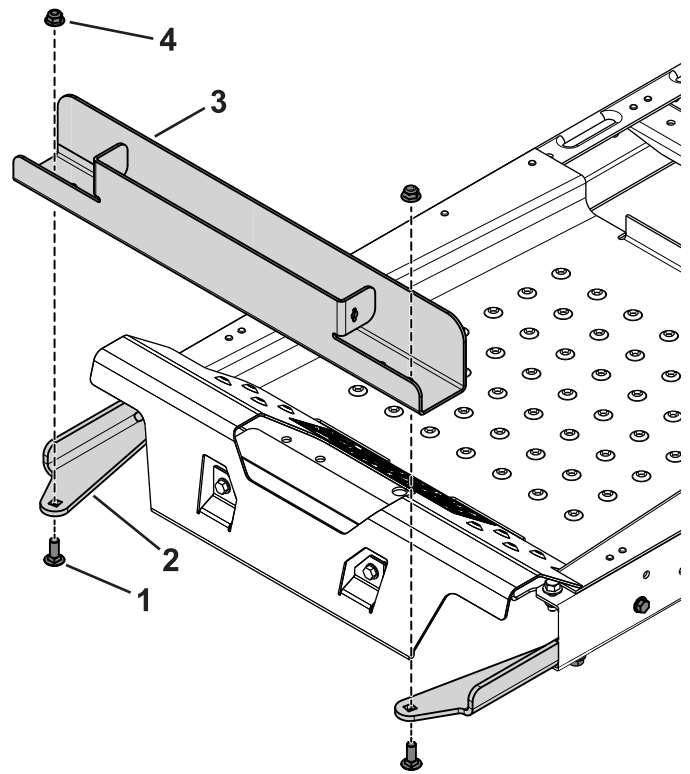

**Figure 2**

- |                                 |                          |
|---------------------------------|--------------------------|
| 1. Carriage bolt (3/8 x 1 inch) | 3. Weight tray           |
| 2. Weight-tray mount            | 4. Flange nut (3/8 inch) |

4. Insert the suitcase weight into the weight tray with the groove side facing toward the front of the machine (Figure 3).

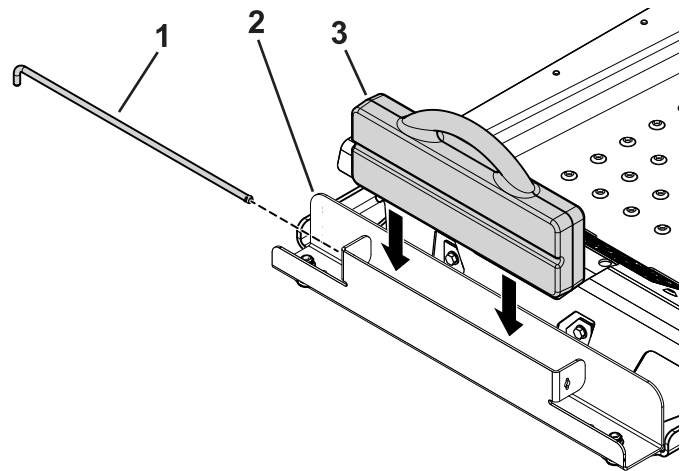

**Figure 3**

- |                  |                    |
|------------------|--------------------|
| 1. Retaining rod | 3. Suitcase weight |
| 2. Weight tray   |                    |

5. Insert the retaining rod into the tray and rotate it into the locked position (Figure 3).